

LINE "A-1"

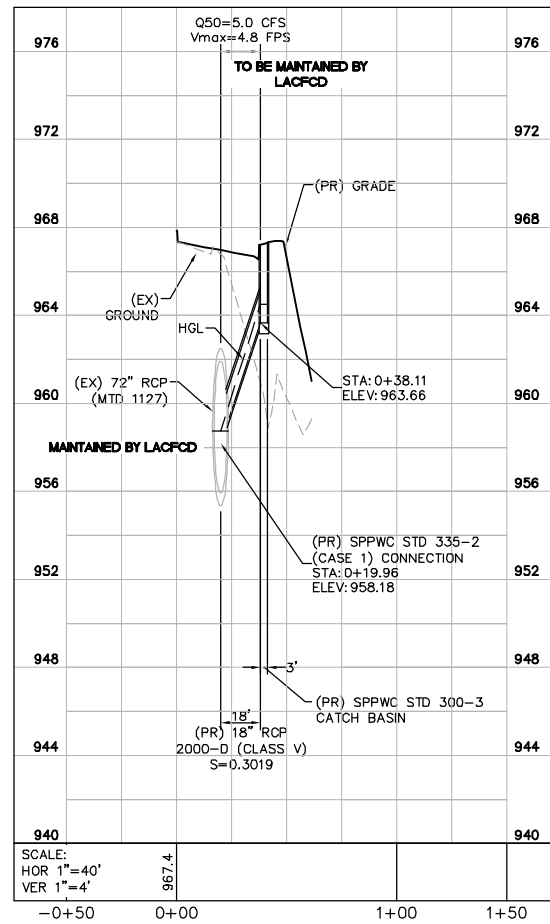

LINE "A-2"

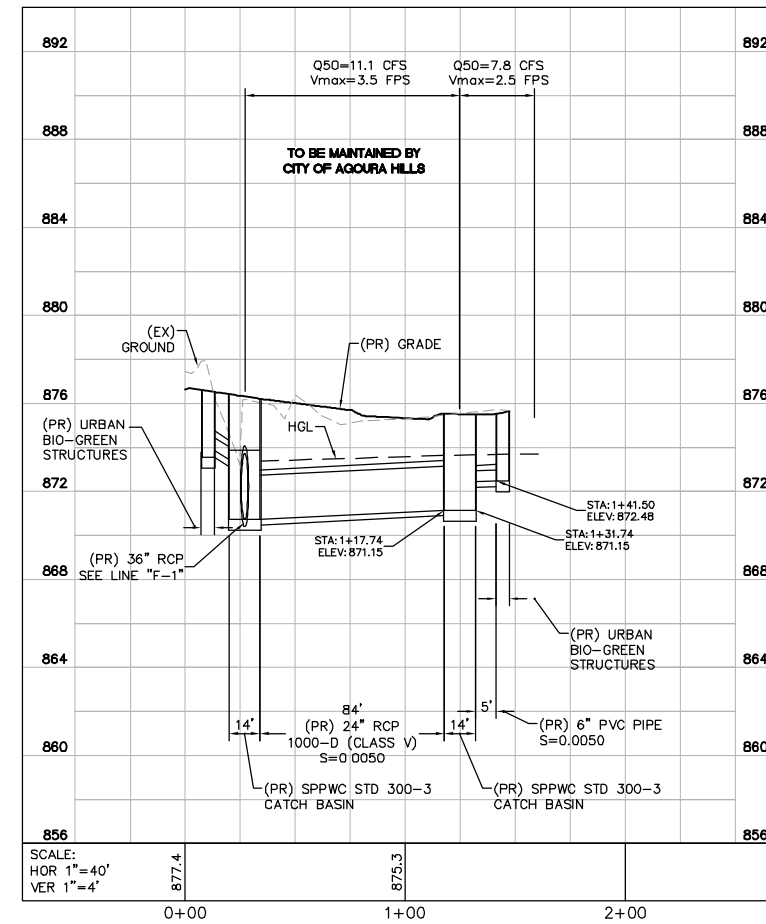

LINE "E-1"

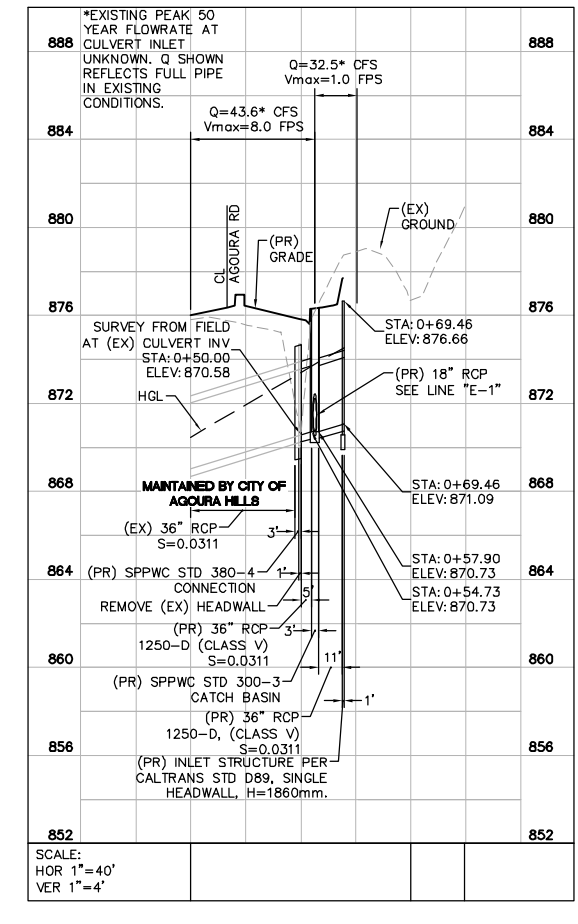

LINE "F-1"

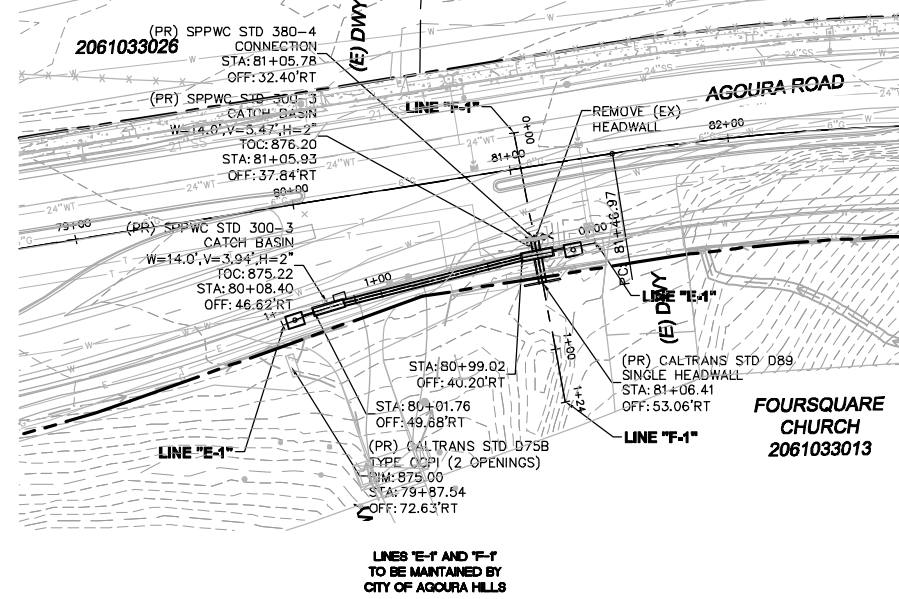
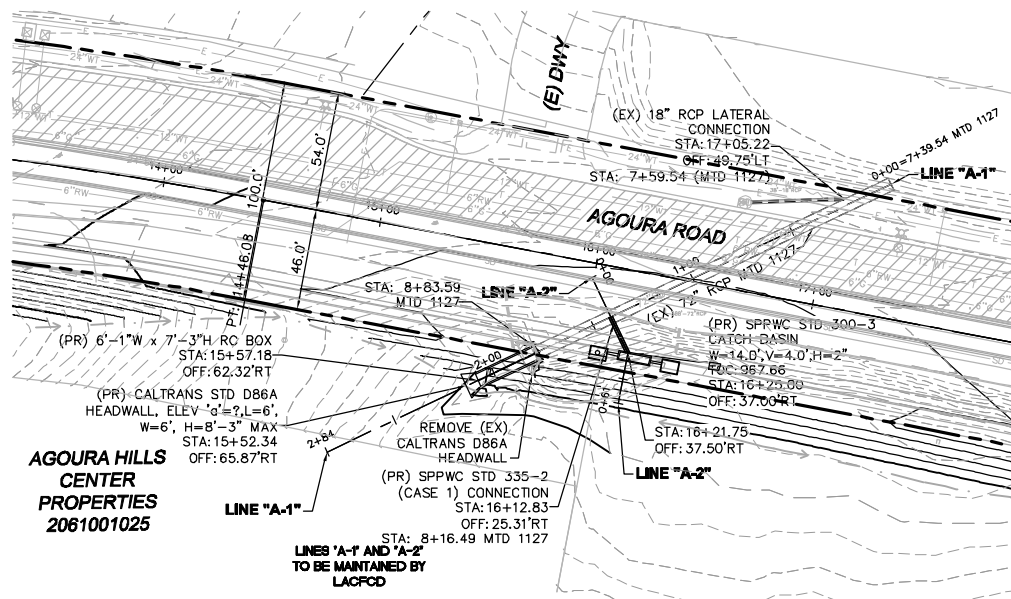

NOTES  
 1. ALL CATCH BASIN STATION AND OFFSET LOCATIONS ARE BASED ON THE CENTER OF THE CB AT THE FACE OF CURB.  
 2. ALL STATION AND OFFSETS SHOWN IN PROFILE ARE BASED ON INDIVIDUAL PIPE ALIGNMENT.  
 3. ALL STATION AND OFFSETS SHOWN IN PLAN ARE BASED ON AGOURA ROAD ALIGNMENT

GRAPHIC SCALE IN FEET  
 0 20 40 80

1		50% PS&E		9/9/11
2		75% PS&E		2/28/12
3		90% PS&E		6/8/12
4		100% PS&E		10/5/12
REV	SYMBOL	DESCRIPTION OF CHANGE	RCE	DATE

PREPARED BY:  
  
 © 2012 KIMLEY-HORN AND ASSOCIATES, INC.  
 6800 Owensmouth Avenue, Suite 410, Los Angeles CA  
 Tel (818) 227-2790 Fax (916) 608-0885

MICHAEL CHOI R.C.E. 67851 DATE

REVIEWED BY:  
 CHARMINE YAMBAO DATE  
 ASSOCIATE CIVIL ENGINEER

APPROVED BY:  
 RAMIRO ADEVA DATE  
 DIRECTOR OF PUBLIC WORKS/CITY ENGINEER

CITY OF  
  
 AGOURA HILLS

AGOURA ROAD WIDENING  
 STORM DRAIN PLANS SD-3

DRAWN BY: RC  
 CHECKED BY: JS/MC  
 KHA JOB NUMBER: 099083017  
 SHEET 50 OF 101

100% SUBMITTAL - OCTOBER 2012

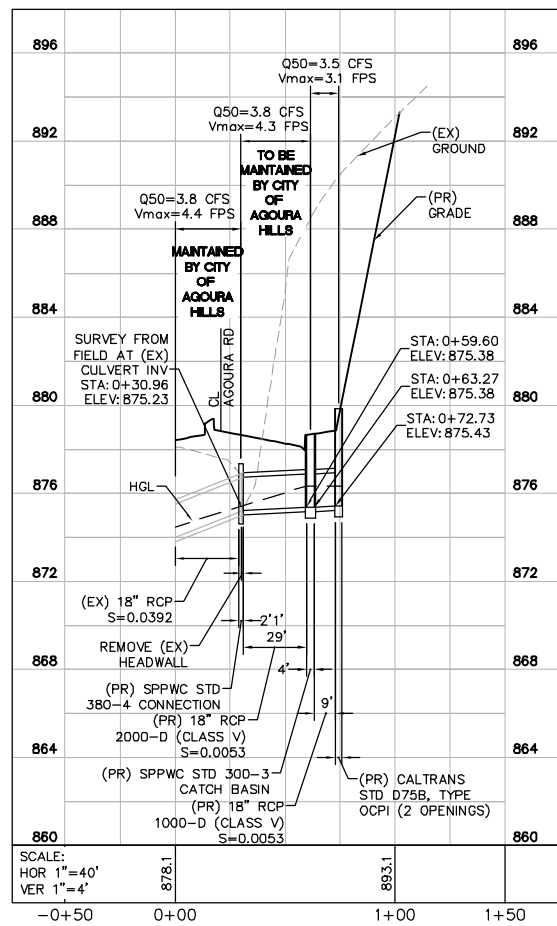

LINE "G-1"

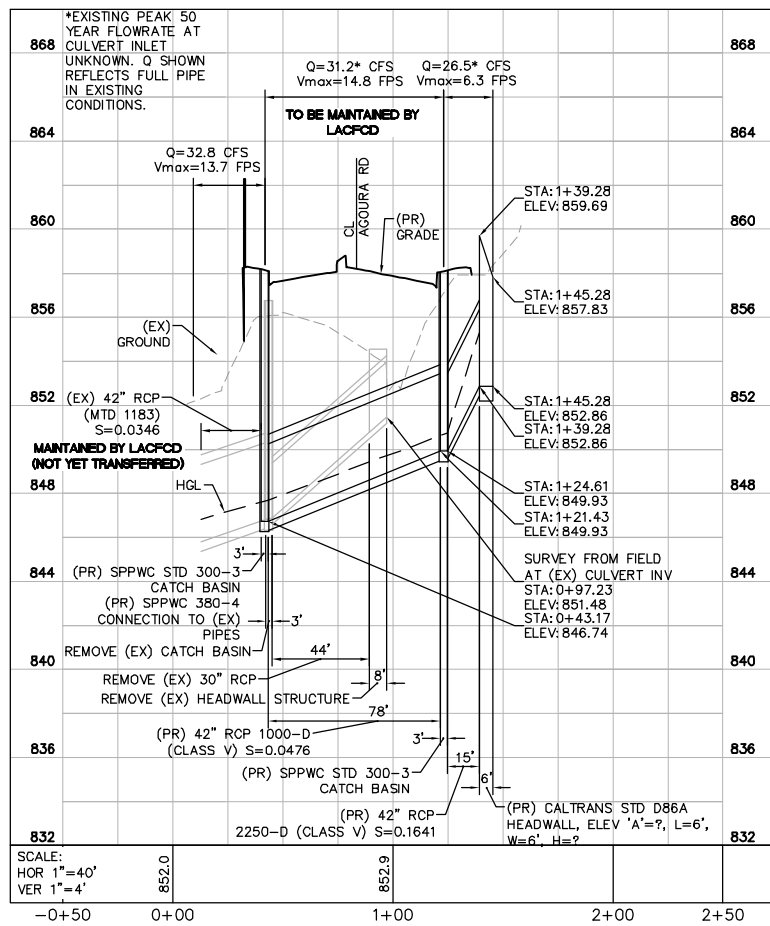

LINE "H-1"

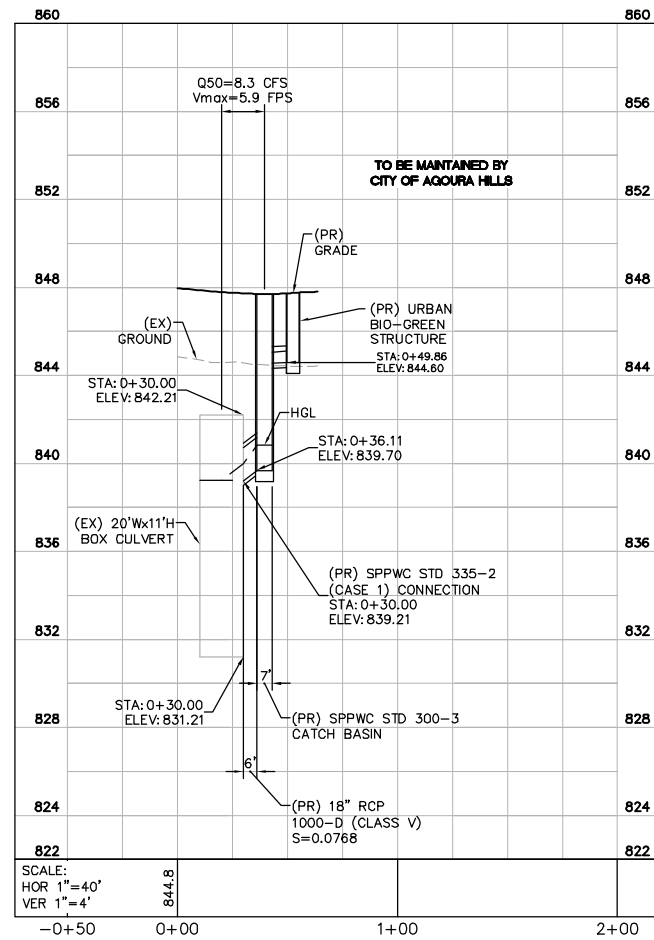

LINE "J-1"

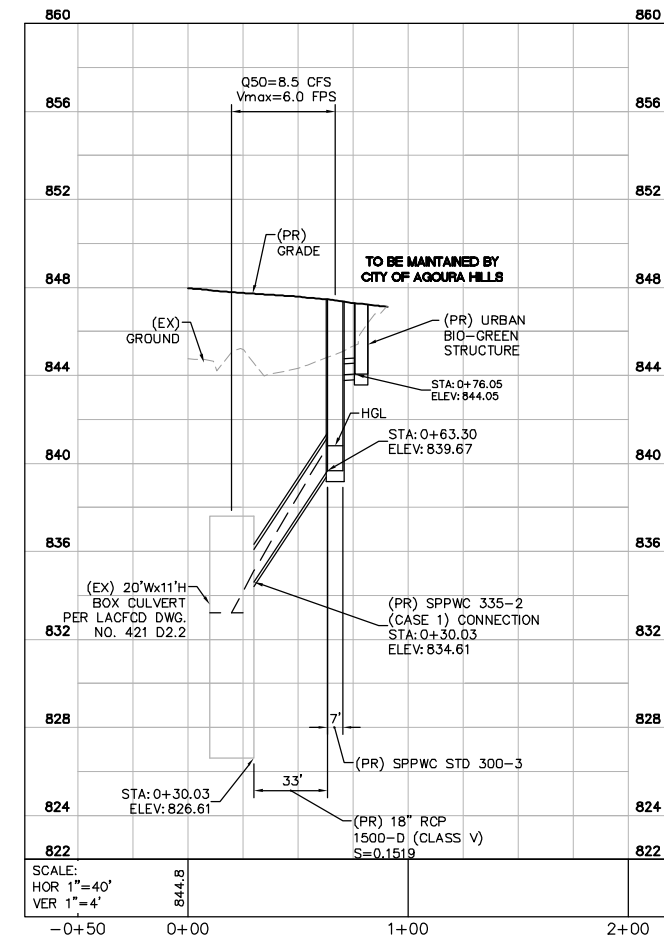

LINE "J-2"

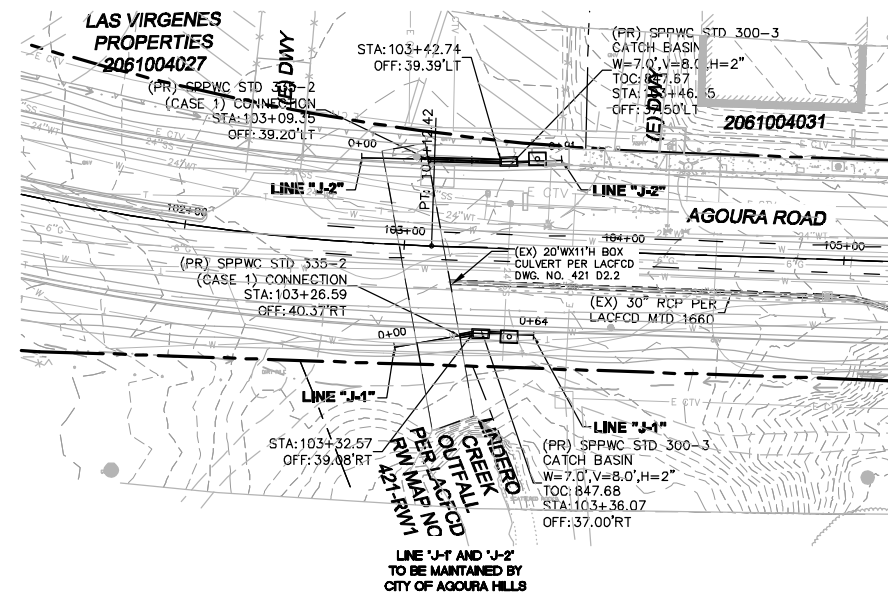
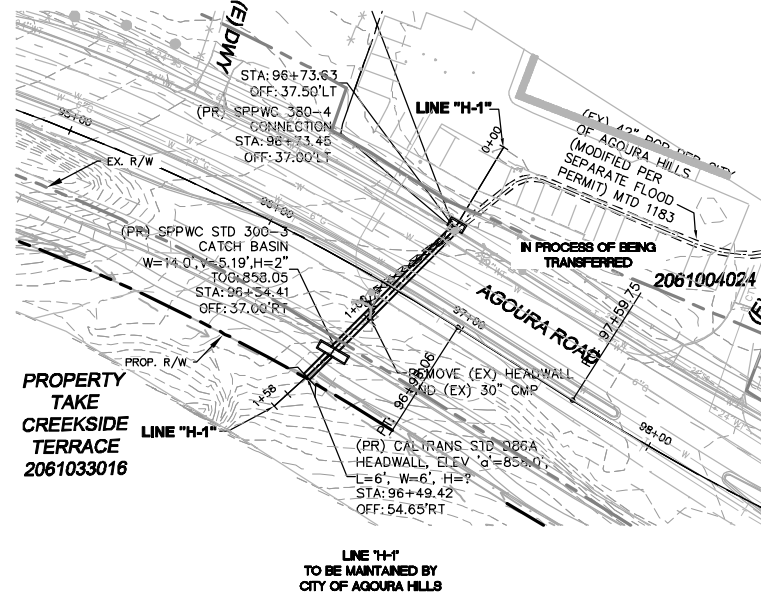
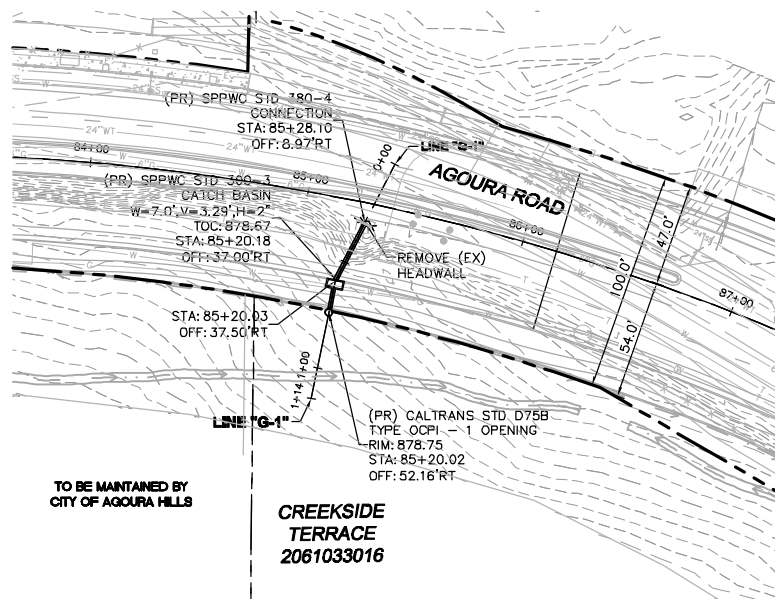

NOTES  
 1. ALL CATCH BASIN STATION AND OFFSET LOCATIONS ARE BASED ON THE CENTER OF THE CB AT THE FACE OF CURB.  
 2. ALL STATION AND OFFSETS SHOWN IN PROFILE ARE BASED ON INDIVIDUAL PIPE ALIGNMENT.  
 3. ALL STATION AND OFFSETS SHOWN IN PLAN ARE BASED ON AGOURA ROAD ALIGNMENT

GRAPHIC SCALE IN FEET  
 0 20 40 80

1		50%PS&E		9/9/11
2		75%PS&E		2/28/12
3		90%PS&E		6/8/12
4		100%PS&E		10/5/12
REV	SYMBOL	DESCRIPTION OF CHANGE	RCE	DATE

PREPARED BY:

© 2012 KIMLEY-HORN AND ASSOCIATES, INC.  
 6800 Owensmouth Avenue, Suite 410, Los Angeles CA  
 Tel (818) 227-2790 Fax (916) 608-0885

MICHAEL CHOI R.C.E. 67851 DATE

REVIEWED BY:

CHARMAINE YAMBAO ASSOCIATE CIVIL ENGINEER DATE

APPROVED BY:

RAMIRO ADEVA DIRECTOR OF PUBLIC WORKS/CITY ENGINEER DATE

CITY OF

AGOURA HILLS

AGOURA ROAD WIDENING  
 STORM DRAIN PLANS SD-4

DRAWN BY: RC  
 CHECKED BY: JS/MC  
 KHA JOB NUMBER: 099083017  
 SHEET 51 OF 101

100% SUBMITTAL - OCTOBER 2012

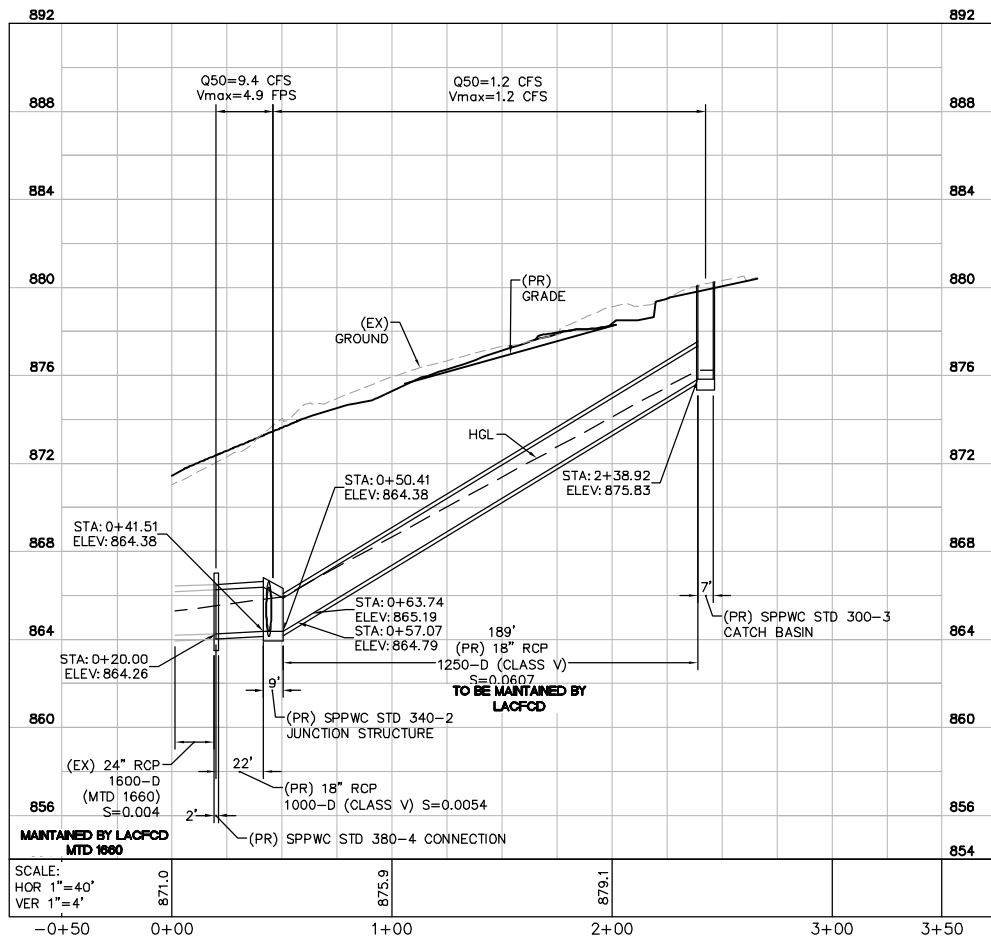

LINE "K-1"

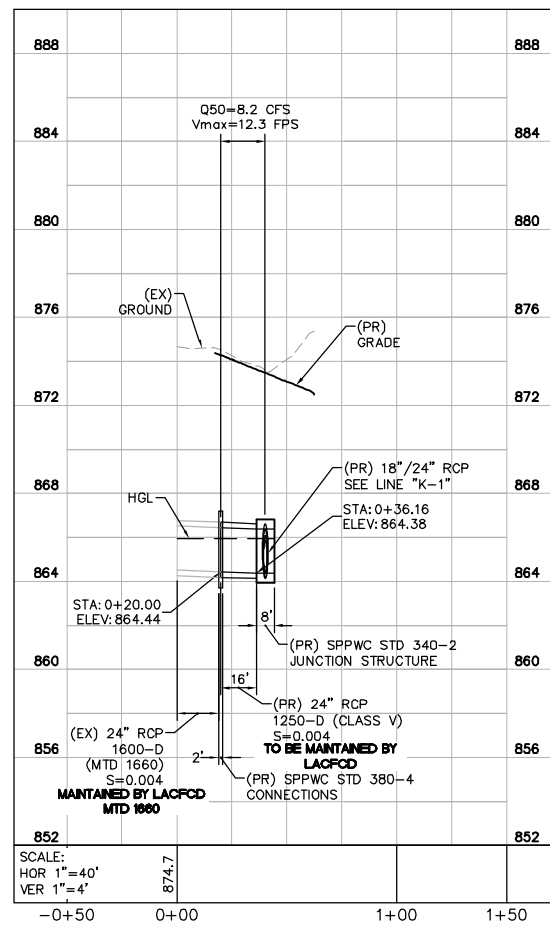

LINE "K-2"

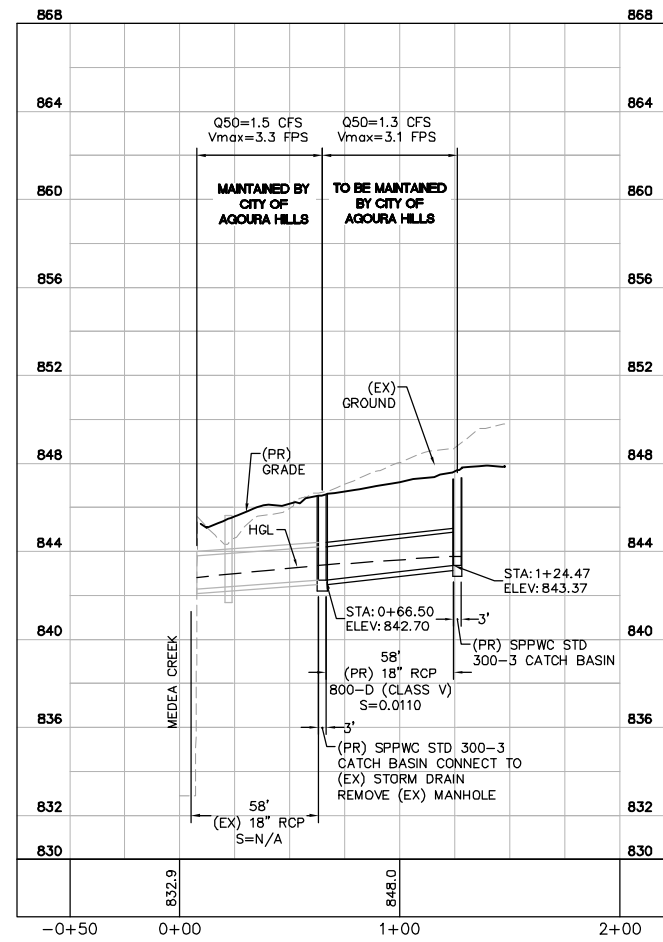

LINE "N-1"  
2061006044

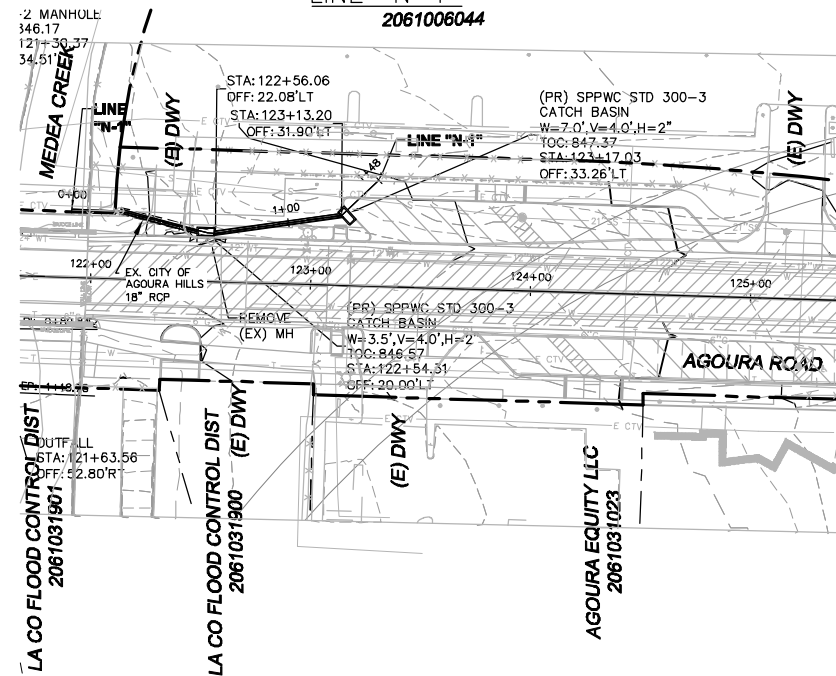
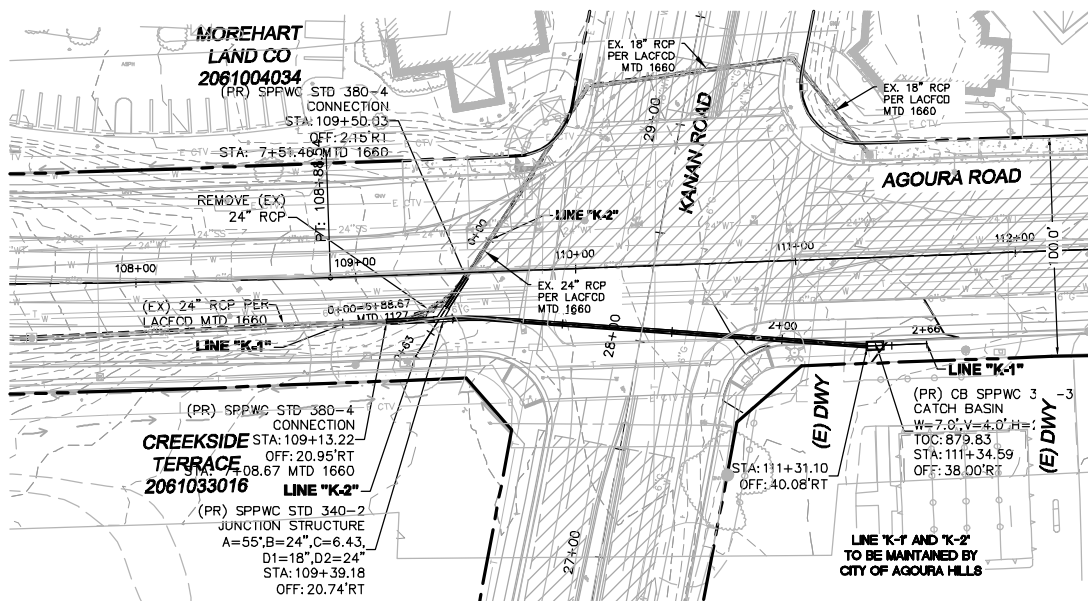

- NOTES
1. ALL CATCH BASIN STATION AND OFFSET LOCATIONS ARE BASED ON THE CENTER OF THE CB AT THE FACE OF CURB.
  2. ALL STATION AND OFFSETS SHOWN IN PROFILE ARE BASED ON INDIVIDUAL PIPE ALIGNMENT.
  3. ALL STATION AND OFFSETS SHOWN IN PLAN ARE BASED ON AGOURA ROAD ALIGNMENT.

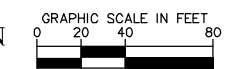

1		50%PS&E		9/9/11
2		75%PS&E		2/28/12
3		90%PS&E		6/8/12
4		100%PS&E		10/5/12
REV	SYMBOL	DESCRIPTION OF CHANGE	RCE	DATE

PREPARED BY:

**Kimley-Horn and Associates, Inc.**

© 2012 KIMLEY-HORN AND ASSOCIATES, INC.  
6800 Owensmouth Avenue, Suite 410, Los Angeles CA  
Tel (818) 227-2790 Fax (916) 608-0885

MICHAEL CHOI R.C.E. 67851 DATE



REVIEWED BY:

CHARMAINE YAMBAO DATE  
ASSOCIATE CIVIL ENGINEER

APPROVED BY:

RAMIRO ADEVA DATE  
DIRECTOR OF PUBLIC WORKS/CITY ENGINEER



AGOURA ROAD WIDENING  
STORM DRAIN PLANS SD-5

DRAWN BY: RC CHECKED BY: JS/MC KHA JOB NUMBER 099083017

SHEET 52 OF 101

100% SUBMITTAL - OCTOBER 2012

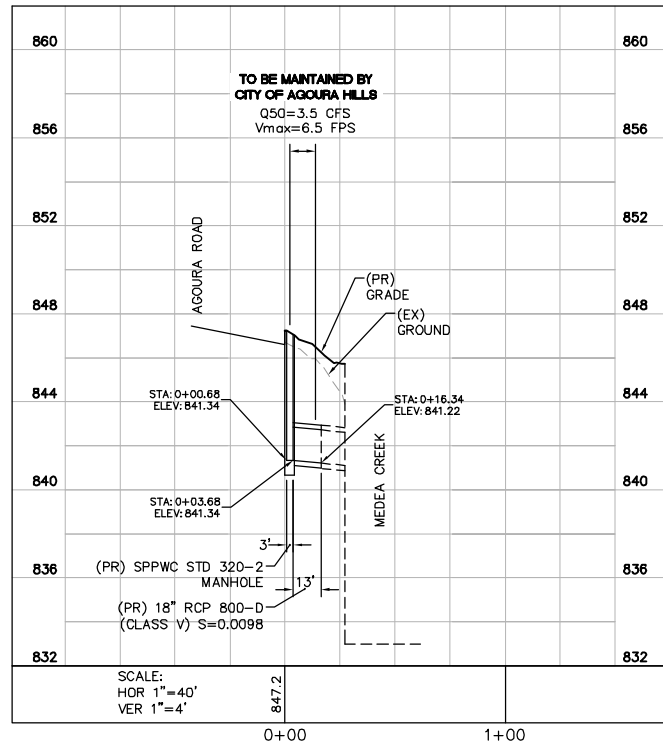

LINE "L-1"

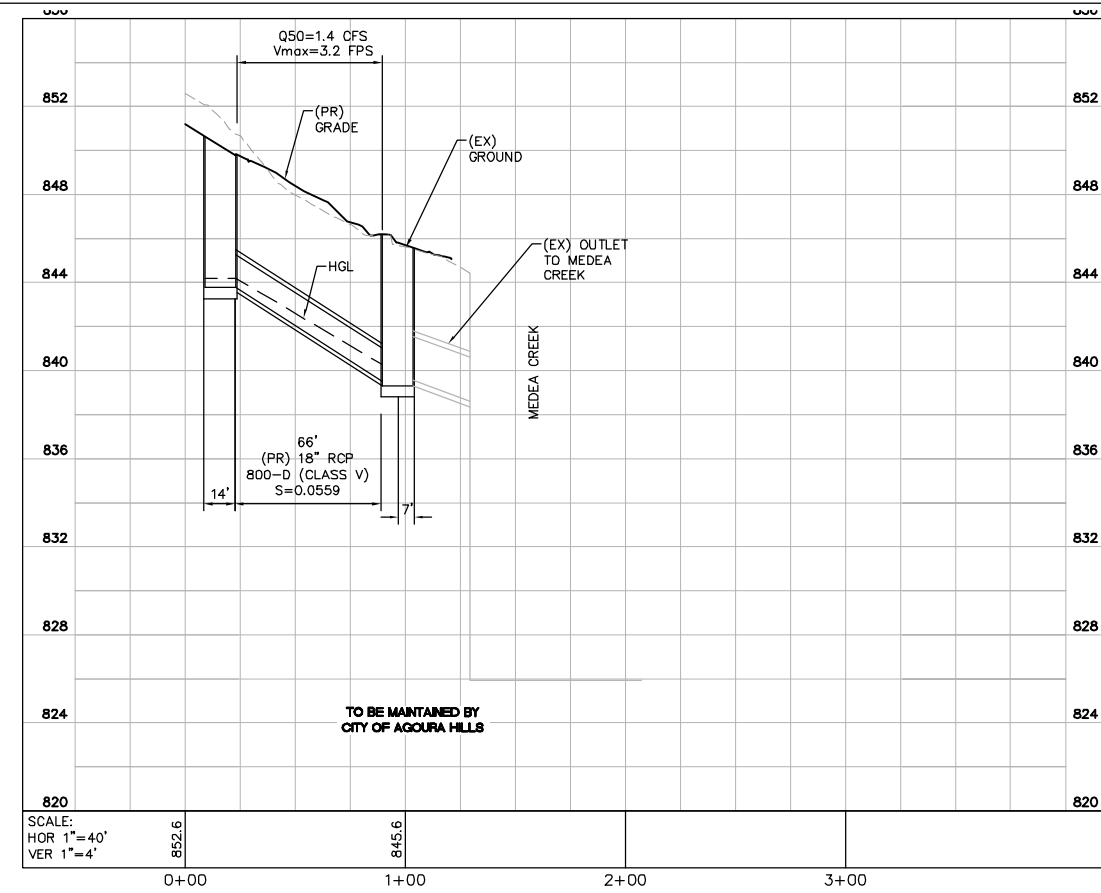

LINE "M-1"

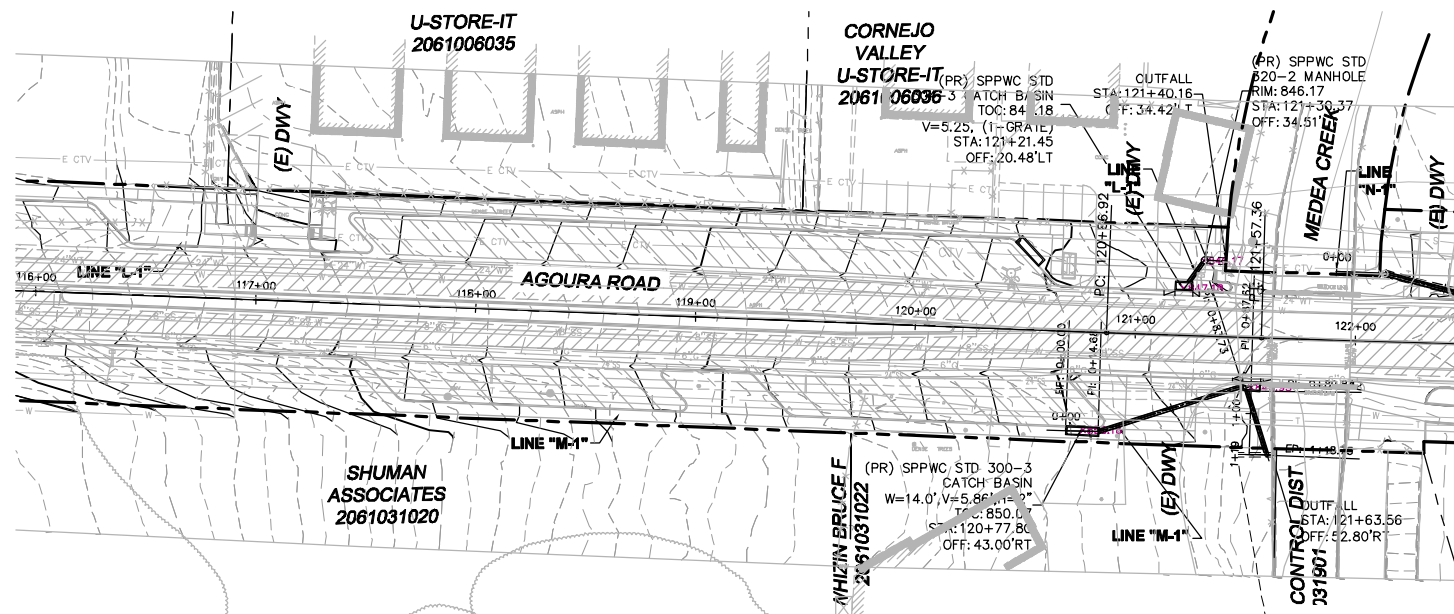

**NOTES**

1. ALL CATCH BASIN STATION AND OFFSET LOCATIONS ARE BASED ON THE CENTER OF THE CB AT THE FACE OF CURB.
2. ALL STATION AND OFFSETS SHOWN IN PROFILE ARE BASED ON INDIVIDUAL PIPE ALIGNMENT.
3. ALL STATION AND OFFSETS SHOWN IN PLAN ARE BASED ON AGOURA ROAD ALIGNMENT

GRAPHIC SCALE IN FEET  
0 20 40 80

1		50% PS&E		9/9/11
2		75% PS&E		2/28/12
3		90% PS&E		6/8/12
4		100% PS&E		10/5/12
REV	SYMBOL	DESCRIPTION OF CHANGE	RCE	DATE

PREPARED BY:

© 2012 KIMLEY-HORN AND ASSOCIATES, INC.  
6800 Owensmouth Avenue, Suite 410, Los Angeles CA  
Tel (818) 227-2790 Fax (916) 608-0885

MICHAEL CHOI R.C.E. 67851 DATE

REVIEWED BY:

CHARMAINE YAMBAO DATE  
ASSOCIATE CIVIL ENGINEER

APPROVED BY:

RAMIRO ADEVA DATE  
DIRECTOR OF PUBLIC WORKS/CITY ENGINEER

CITY OF  
AGOURA HILLS

AGOURA ROAD WIDENING  
STORM DRAIN PLANS SD-6

DRAWN BY: RC  
CHECKED BY: JS/MC  
KHA JOB NUMBER: 099083017

SHEET 53 OF 101

100% SUBMITTAL - OCTOBER 2012

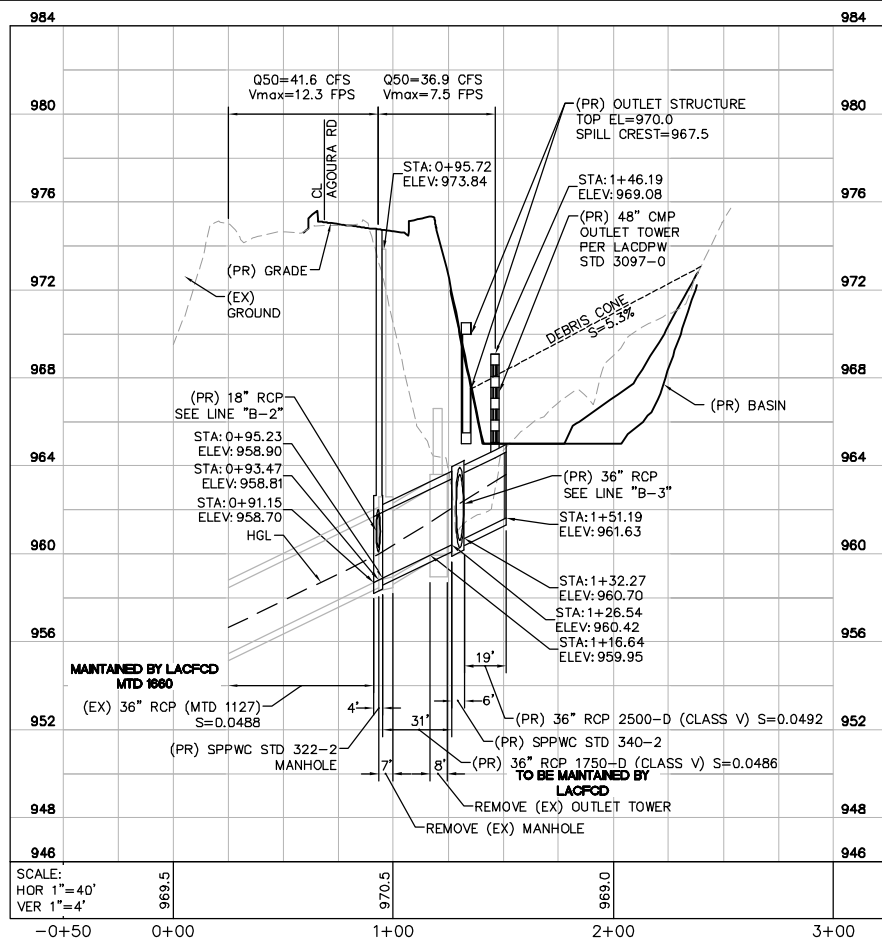

LINE "B-1"

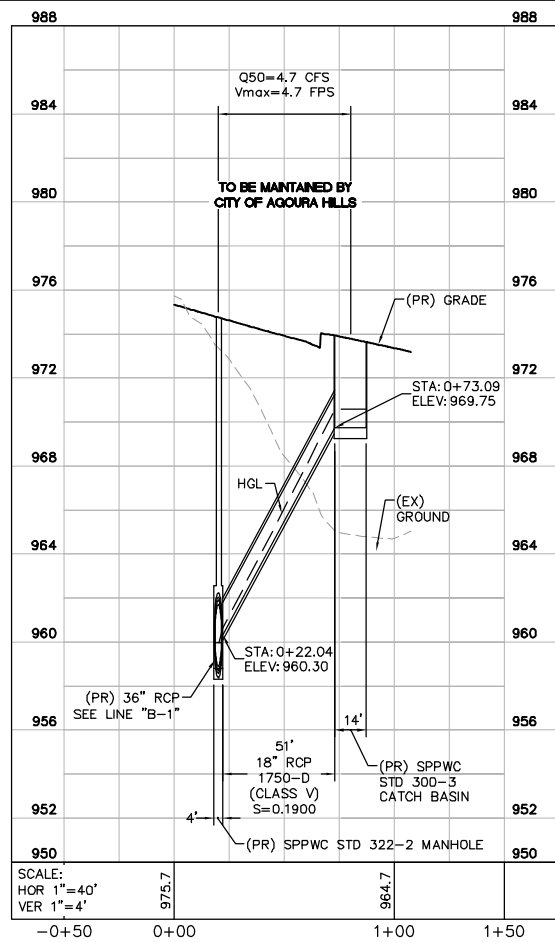

LINE "B-2"

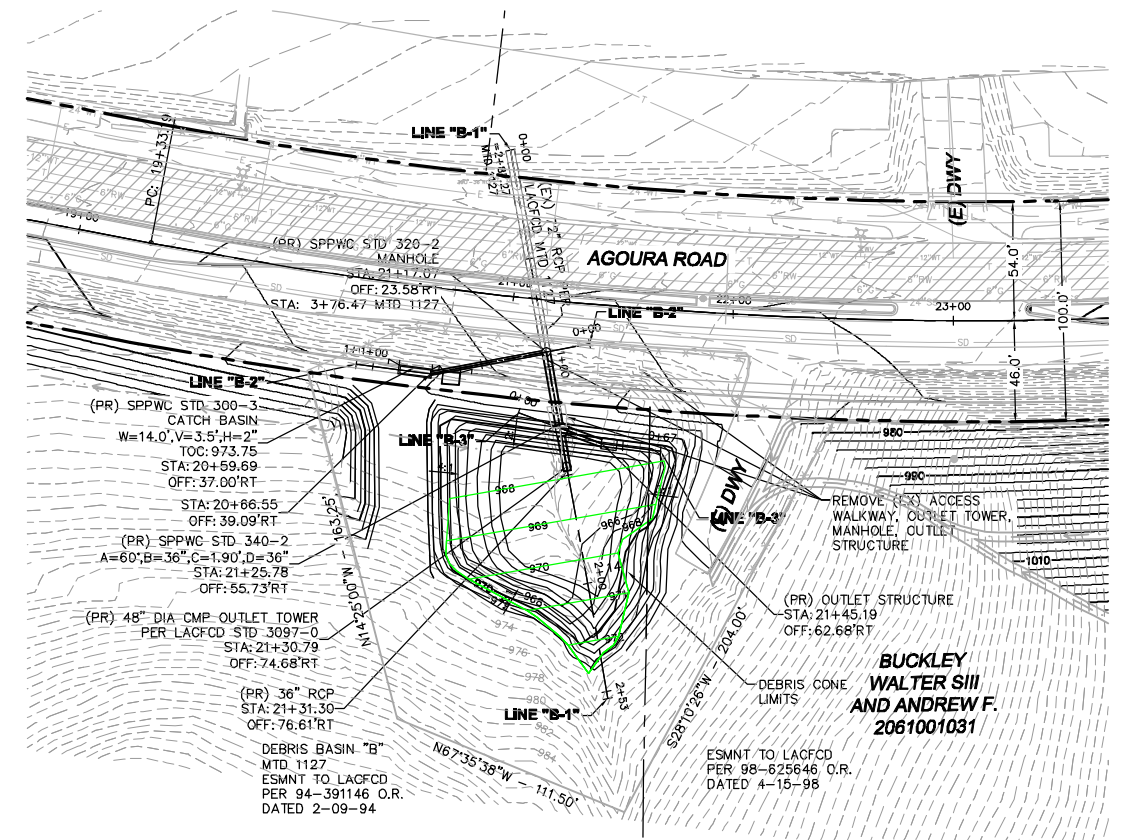

DEBRIS BASIN VOLUME REQUIRED: 725 CY PER MTD 1127 CALCULATIONS

DEBRIS BASIN VOLUME PROVIDED: 740 CY

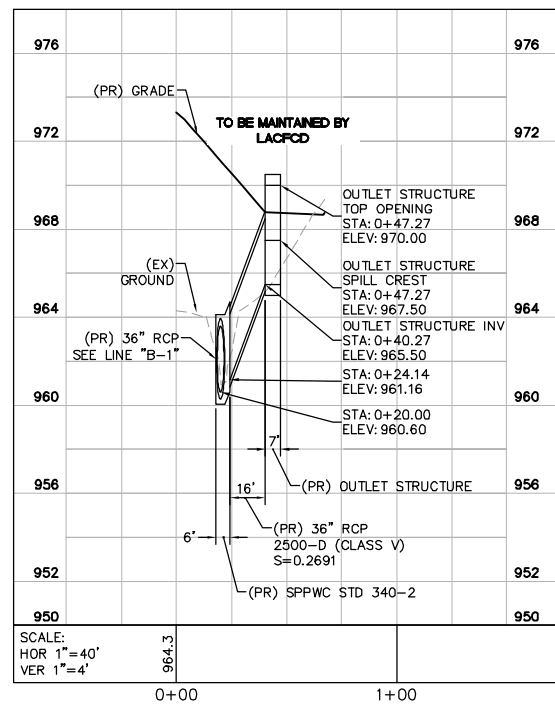

LINE "B-3"

NOTES

1. ALL CATCH BASIN STATION AND OFFSET LOCATIONS ARE BASED ON THE CENTER OF THE CB AT THE FACE OF CURB.
2. ALL STATION AND OFFSETS SHOWN IN PROFILE ARE BASED ON INDIVIDUAL PIPE ALIGNMENT.
3. ALL STATION AND OFFSETS SHOWN IN PLAN ARE BASED ON AGOURA ROAD ALIGNMENT

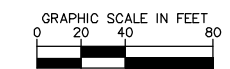

1		50%PS&E		9/9/11
2		75%PS&E		2/28/12
3		90%PS&E		6/8/12
4		100%PS&E		10/5/12
REV	SYMBOL	DESCRIPTION OF CHANGE	RCE	DATE

PREPARED BY:

**Kimley-Horn and Associates, Inc.**  
 © 2012 KIMLEY-HORN AND ASSOCIATES, INC.  
 6800 Owensmouth Avenue, Suite 410, Los Angeles CA  
 Tel (818) 227-2790 Fax (916) 608-0885



MICHAEL CHOI R.C.E. 67851 DATE

REVIEWED BY:

CHARMAINE YAMBAO DATE  
 ASSOCIATE CIVIL ENGINEER

APPROVED BY:

RAMIRO ADEVA DATE  
 DIRECTOR OF PUBLIC WORKS/CITY ENGINEER



AGOURA ROAD WIDENING  
 STORM DRAIN PLANS SD-7

DRAWN BY: RC CHECKED BY: JS/MC KHA JOB NUMBER 099083017

SHEET 54 OF 101

100% SUBMITTAL - OCTOBER 2012

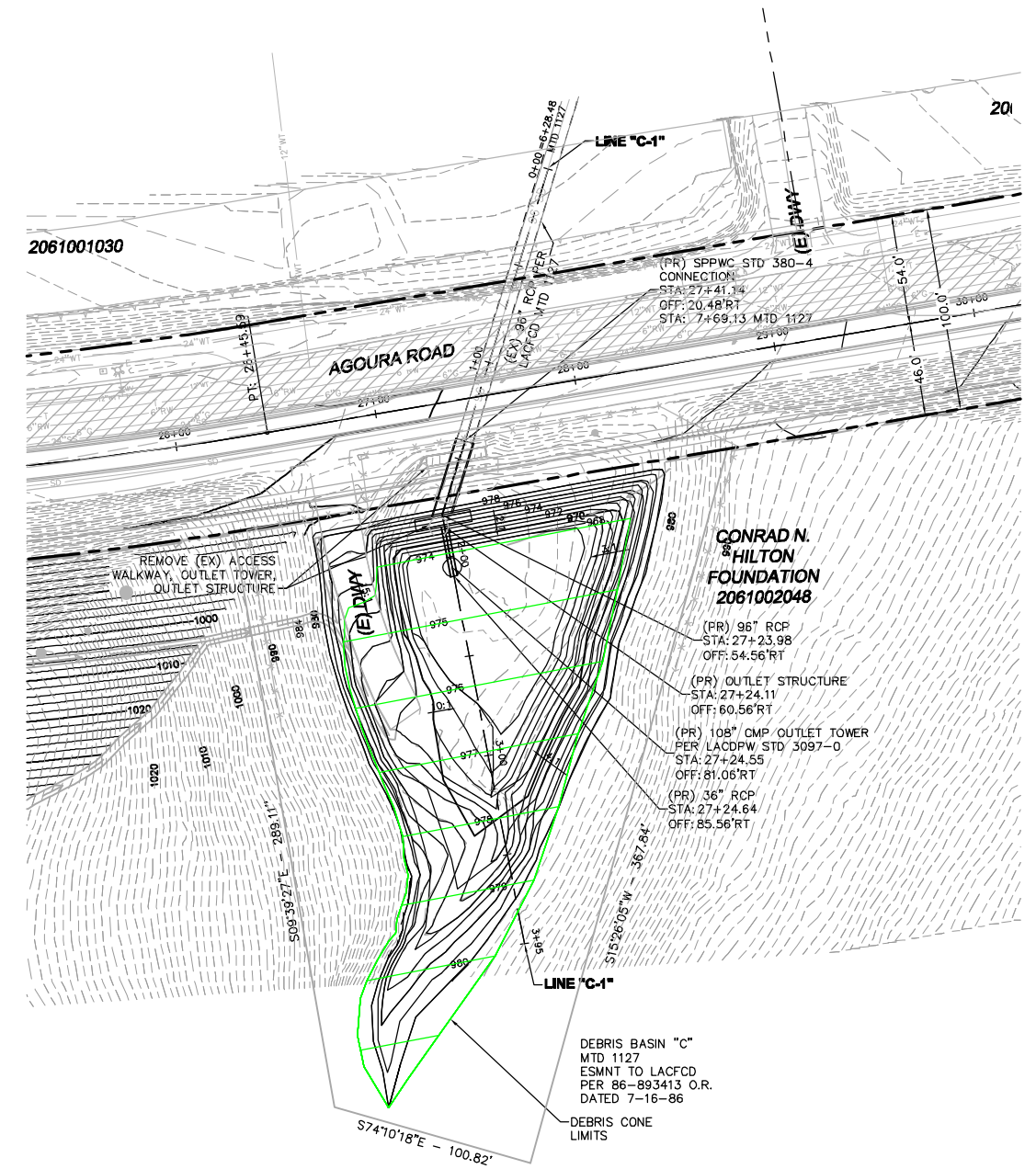
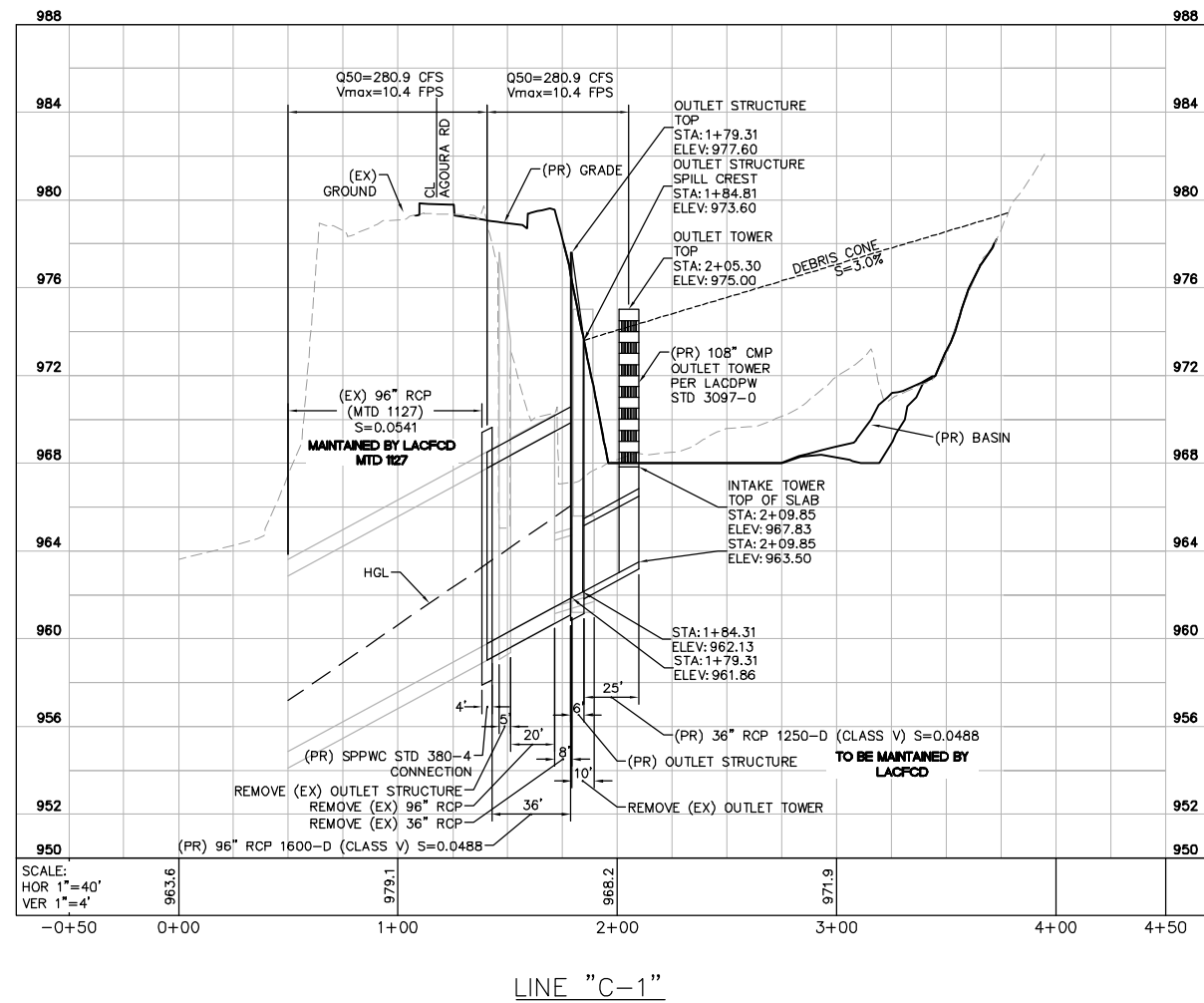

DEBRIS BASIN VOLUME REQUIRED: 4620 CY  
 PER MTD 1127 CALCULATIONS

DEBRIS BASIN VOLUME PROVIDED: 4635 CY

- NOTES**
1. ALL CATCH BASIN STATION AND OFFSET LOCATIONS ARE BASED ON THE CENTER OF THE CB AT THE FACE OF CURB.
  2. ALL STATION AND OFFSETS SHOWN IN PROFILE ARE BASED ON INDIVIDUAL PIPE ALIGNMENT.
  3. ALL STATION AND OFFSETS SHOWN IN PLAN ARE BASED ON AGOURA ROAD ALIGNMENT
- GRAPHIC SCALE IN FEET  
 0 20 40 80

1		50%PS&E		9/9/11
2		75%PS&E		2/28/12
3		90%PS&E		6/8/12
4		100%PS&E		10/5/12
REV	SYMBOL	DESCRIPTION OF CHANGE	RCE	DATE

PREPARED BY:

© 2012 KIMLEY-HORN AND ASSOCIATES, INC.  
 6800 Owensmouth Avenue, Suite 410, Los Angeles CA  
 Tel (818) 227-2790 Fax (916) 608-0885

MICHAEL CHOI R.C.E. 67851 DATE

REVIEWED BY:

CHARMAINE YAMBAO ASSOCIATE CIVIL ENGINEER DATE

APPROVED BY:

RAMIRO ADEVA DIRECTOR OF PUBLIC WORKS/CITY ENGINEER DATE

CITY OF  
 AGOURA HILLS

AGOURA ROAD WIDENING  
 STORM DRAIN PLANS SD-8

DRAWN BY: RC CHECKED BY: JS/MC KHA JOB NUMBER 099083017

SHEET 55 OF 101

100% SUBMITTAL - OCTOBER 2012

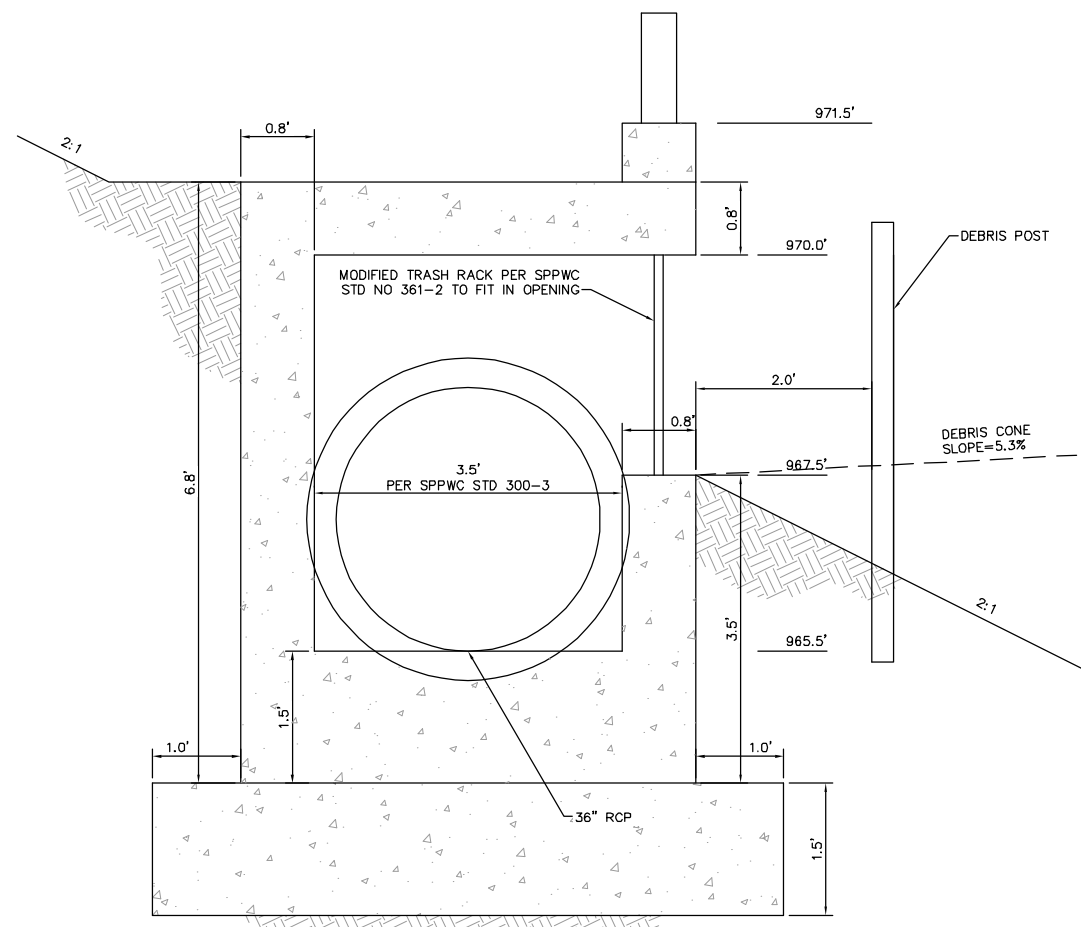

DEBRIS BASIN B INTAKE STRUCTURE  
NTS

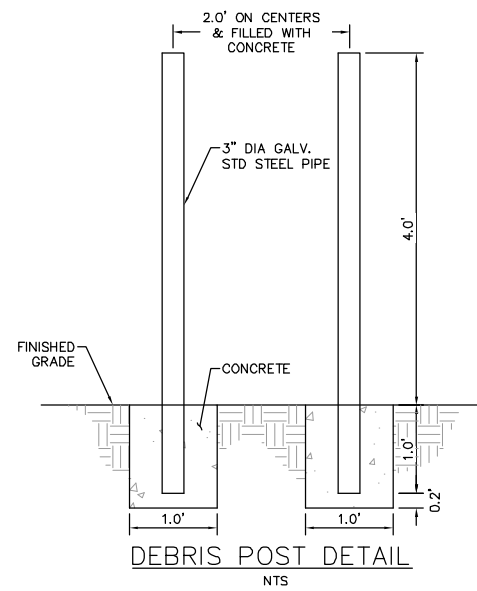

DEBRIS POST DETAIL  
NTS

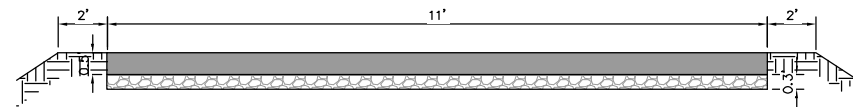

DEBRIS BASIN ACCESS ROAD  
NTS

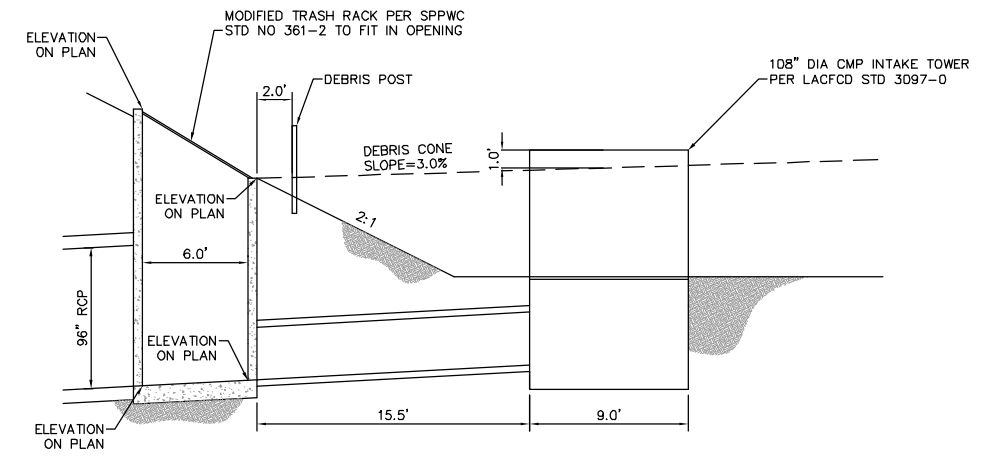

SECTION A-A  
NTS

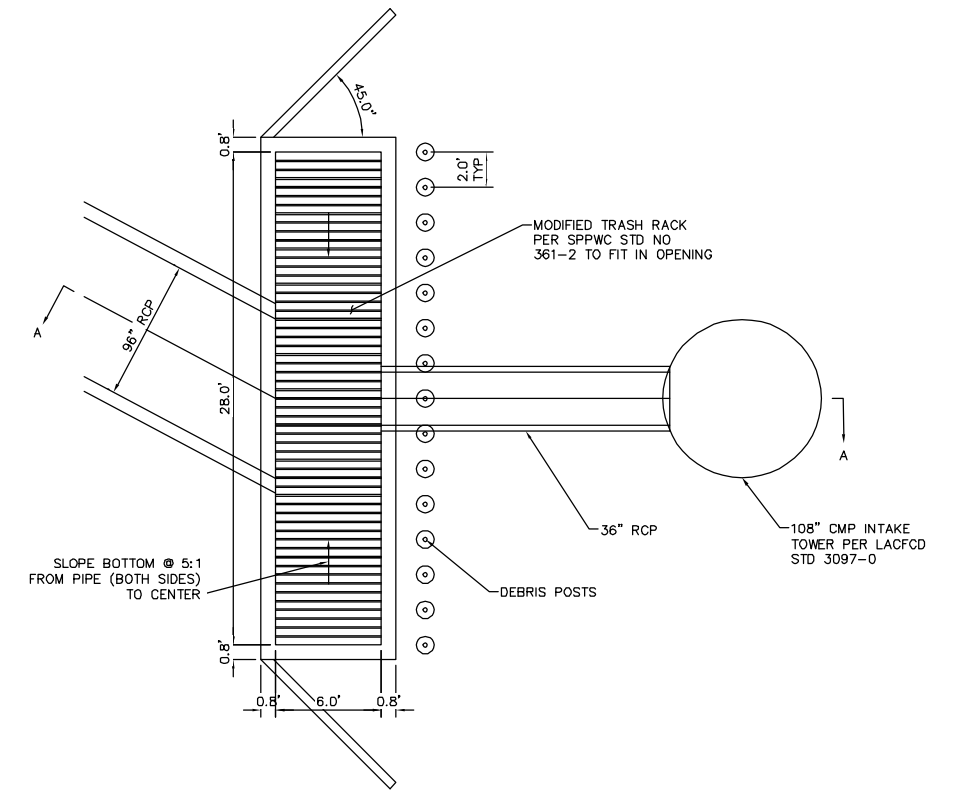

DEBRIS BASIN C INTAKE STRUCTURE  
NTS

1		50%PS&E		9/9/11
2		75%PS&E		2/28/12
3		90%PS&E		6/8/12
4		100%PS&E		10/5/12
REV	SYMBOL	DESCRIPTION OF CHANGE	RCE	DATE

PREPARED BY:

**Kimley-Horn and Associates, Inc.**  
© 2012 KIMLEY-HORN AND ASSOCIATES, INC.  
6800 Owensmouth Avenue, Suite 410, Los Angeles CA  
Tel (818) 227-2790 Fax (916) 608-0885

MICHAEL CHOI R.C.E. 67851 DATE



REVIEWED BY:

CHARMAINE YAMBAO DATE  
ASSOCIATE CIVIL ENGINEER

APPROVED BY:

RAMIRO ADEVA DATE  
DIRECTOR OF PUBLIC WORKS/CITY ENGINEER



AGOURA ROAD WIDENING  
STORM DRAIN PLANS SD-9

DRAWN BY: RC CHECKED BY: JS/MC KHA JOB NUMBER 099083017

SHEET 56 OF 101

100% SUBMITTAL - OCTOBER 2012

**SIGNING AND STRIPING  
(THIS SHEET ONLY)**

- 1 GRIND CONFLICTING EXISTING STRIPING, LEGEND OR ARROW, EXCEPT AS NOTED TO REMAIN. REMOVE RAISED PAVEMENT MARKERS AS NECESSARY.
- 2 PAINT STRIPING, LEGEND OR ARROWS PER CALTRANS STANDARD PLANS OR TYPE AS NOTED. INSTALL RAISED PAVEMENT MARKERS AS REQUIRED.
- 3 JOIN TO EXISTING STRIPING AS SHOWN.
- 4 RELOCATE EXISTING SIGN(S) AND POST AS NOTED.
- 5 FURNISH AND INSTALL NEW SIGN(S) ON NEW POST. SIGN AS SHOWN.
- 6 FURNISH AND INSTALL NEW OBJECT MARKER AS SHOWN.
- 7 REMOVE EXISTING SIGN(S) AND POST AS NOTED.
- 8 REMOVE EXISTING SIGN(S) AS SHOWN.
- 9 FURNISH AND INSTALL NEW SIGN(S) ON EXISTING POST.
- 10 FURNISH AND INSTALL NEW SIGN(S) AS SHOWN.
- 11 INSTALL 50' 4" WHITE LINE PER DETAIL B.
- 12 INSTALL 4" DIAGONAL THERMO WHITE LINES, 30' O.C. AS SHOWN.
- 13 FURNISH AND INSTALL BLUE REFLECTOR PER DETAIL "A"
- 14 FURNISH AND INSTALL NEW SIGN(S) ON EXISTING LUMINAIRE AS SHOWN.
- 15 PAINT 12" WHITE CROSSWALK. LENGTH AS SHOWN.
- 16 RELOCATE SIGN(S) AS SHOWN AND REMOVE EXISTING POST.

**LEGEND**

- (XX) INSTALL CALTRANS STRIPING AND PAVEMENT MARKINGS PER CALTRANS STANDARD PLANS A20A THRU A24E. DETAIL NO. AS INDICATED
- CENTERLINE
- † EXISTING SIGN
- † EXISTING FIRE HYDRANT
- † PROPOSED SIGN
- PROPOSED STRIPING
- ↪ EXISTING PAVEMENT MARKING TO BE REMOVED
- ↪ PROPOSED PAVEMENT MARKING

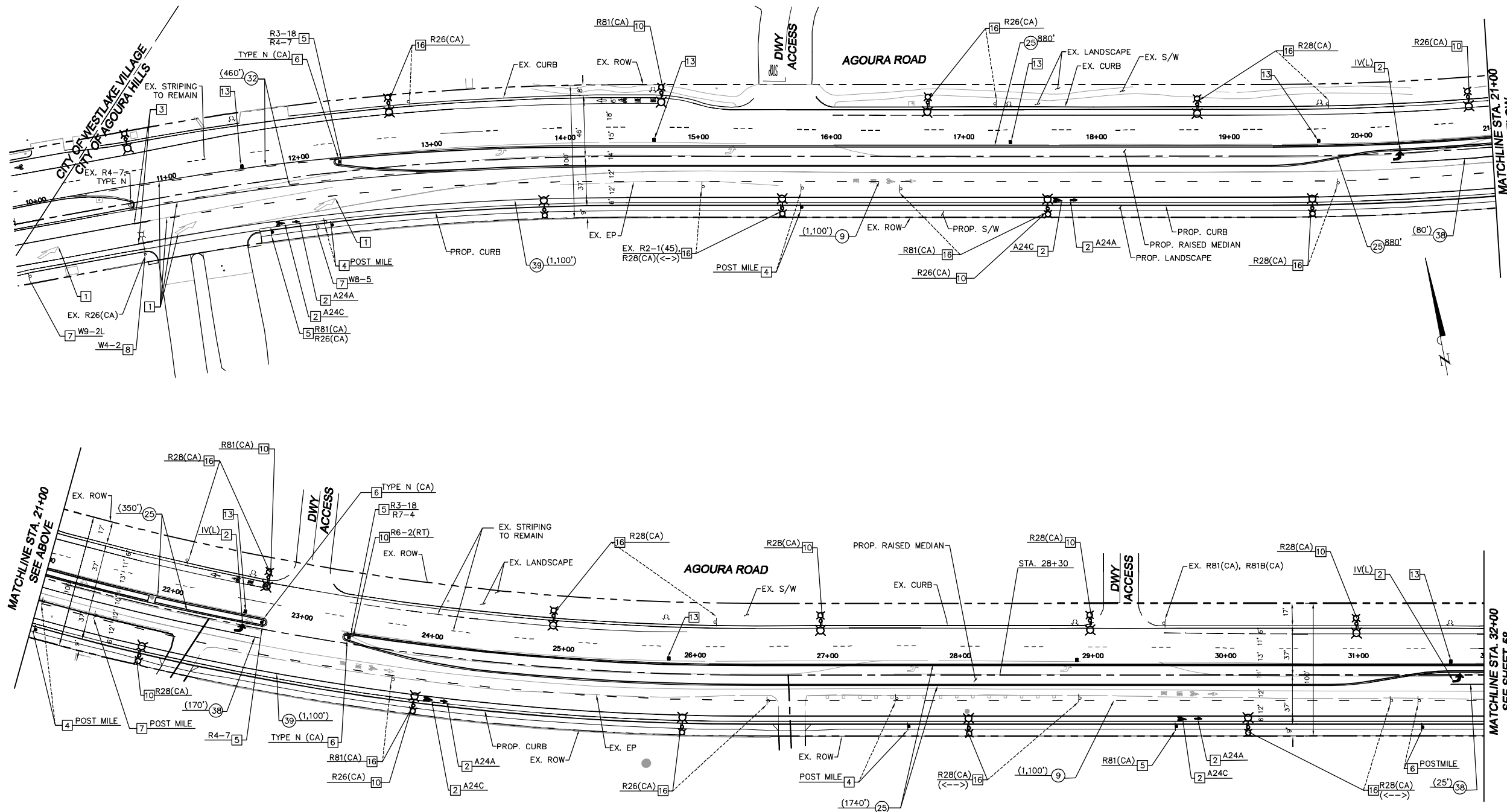
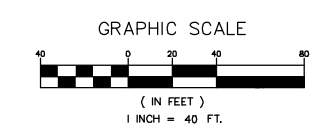
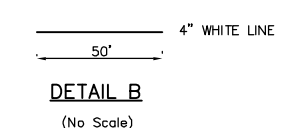
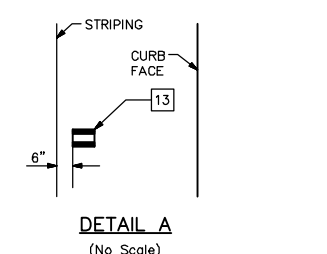

1		50%PS&E		9/9/11
2		75%PS&E		2/28/12
3		90%PS&E		6/8/12
4		100%PS&E		10/5/12
REV	SYMBOL	DESCRIPTION OF CHANGE	RCE	DATE

PREPARED BY:

**Kimley-Horn and Associates, Inc.**  
© 2012 KIMLEY-HORN AND ASSOCIATES, INC.  
6800 Owensmouth Avenue, Suite 410, Canoga Park, CA 91303  
Tel (818) 227-2790 Fax (916) 608-0885

SRIKANTH CHAKRAVARTHY R.C.E. C73629 DATE

REVIEWED BY:

CHARMAINE YAMBAO DATE  
ASSOCIATE CIVIL ENGINEER

APPROVED BY:

RAMIRO ADEVA DATE  
DIRECTOR OF PUBLIC WORKS/CITY ENGINEER

**CITY OF AGOURA HILLS**

AGOURA ROAD WIDENING  
SIGNING AND STRIPING PLAN SN-1

DRAWN BY: RC  
CHECKED BY: SC/JM  
KHA JOB NUMBER: 099083017

SHEET 57 OF 101

100% SUBMITTAL - OCTOBER 2012



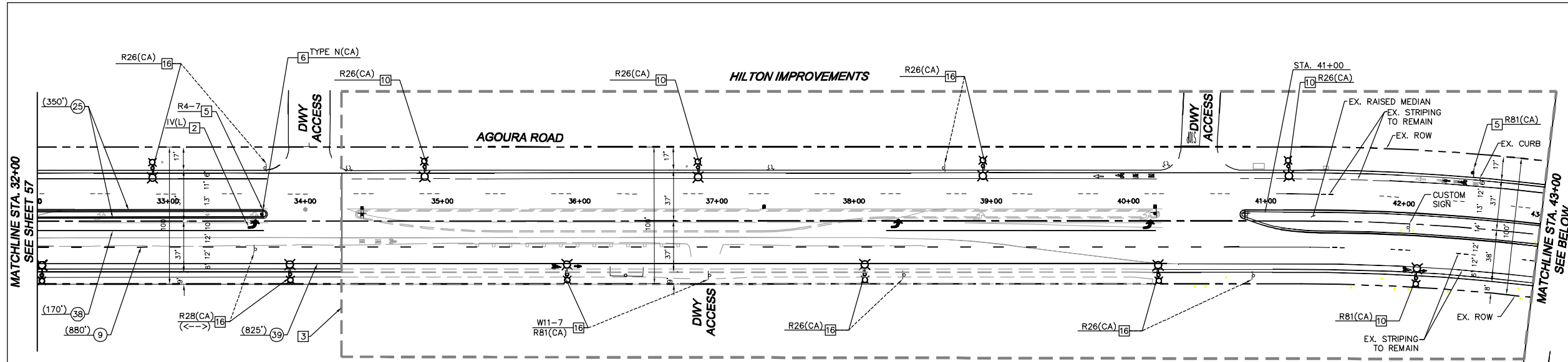

**SIGNING AND STRIPING  
(THIS SHEET ONLY)**

- 1 GRIND CONFLICTING EXISTING STRIPING, LEGEND OR ARROW, EXCEPT AS NOTED TO REMAIN. REMOVE RAISED PAVEMENT MARKERS AS NECESSARY.
- 2 PAINT STRIPING, LEGEND OR ARROWS PER CALTRANS STANDARD PLANS OR TYPE AS NOTED. INSTALL RAISED PAVEMENT MARKERS AS REQUIRED.
- 3 JOIN TO EXISTING STRIPING AS SHOWN.
- 4 RELOCATE EXISTING SIGN(S) AND POST AS NOTED.
- 5 FURNISH AND INSTALL NEW SIGN(S) ON NEW POST. SIGN AS SHOWN.
- 6 FURNISH AND INSTALL NEW OBJECT MARKER AS SHOWN.
- 7 REMOVE EXISTING SIGN(S) AND POST AS NOTED.
- 8 REMOVE EXISTING SIGN(S) AS SHOWN.
- 9 FURNISH AND INSTALL NEW SIGN(S) ON EXISTING POST.
- 10 FURNISH AND INSTALL NEW SIGN(S) AS SHOWN.
- 11 INSTALL 50' 4" WHITE LINE PER DETAIL B.
- 12 INSTALL 4" DIAGONAL THERMO WHITE LINES, 30' O.C. AS SHOWN.
- 13 FURNISH AND INSTALL BLUE REFLECTOR PER DETAIL "A"
- 14 FURNISH AND INSTALL NEW SIGN(S) ON EXISTING LUMINAIRE AS SHOWN.
- 15 PAINT 12" WHITE CROSSWALK. LENGTH AS SHOWN.
- 16 RELOCATE SIGN(S) AS SHOWN AND REMOVE EXISTING POST.

**LEGEND**

- (XX) INSTALL CALTRANS STRIPING AND PAVEMENT MARKINGS PER CALTRANS STANDARD PLANS A20A THRU A24E. DETAIL NO. AS INDICATED
- CENTERLINE
- ⊥ EXISTING SIGN
- ⊥ EXISTING FIRE HYDRANT
- ⊥ PROPOSED SIGN
- PROPOSED STRIPING
- ↪ EXISTING PAVEMENT MARKING TO BE REMOVED
- ↪ PROPOSED PAVEMENT MARKING

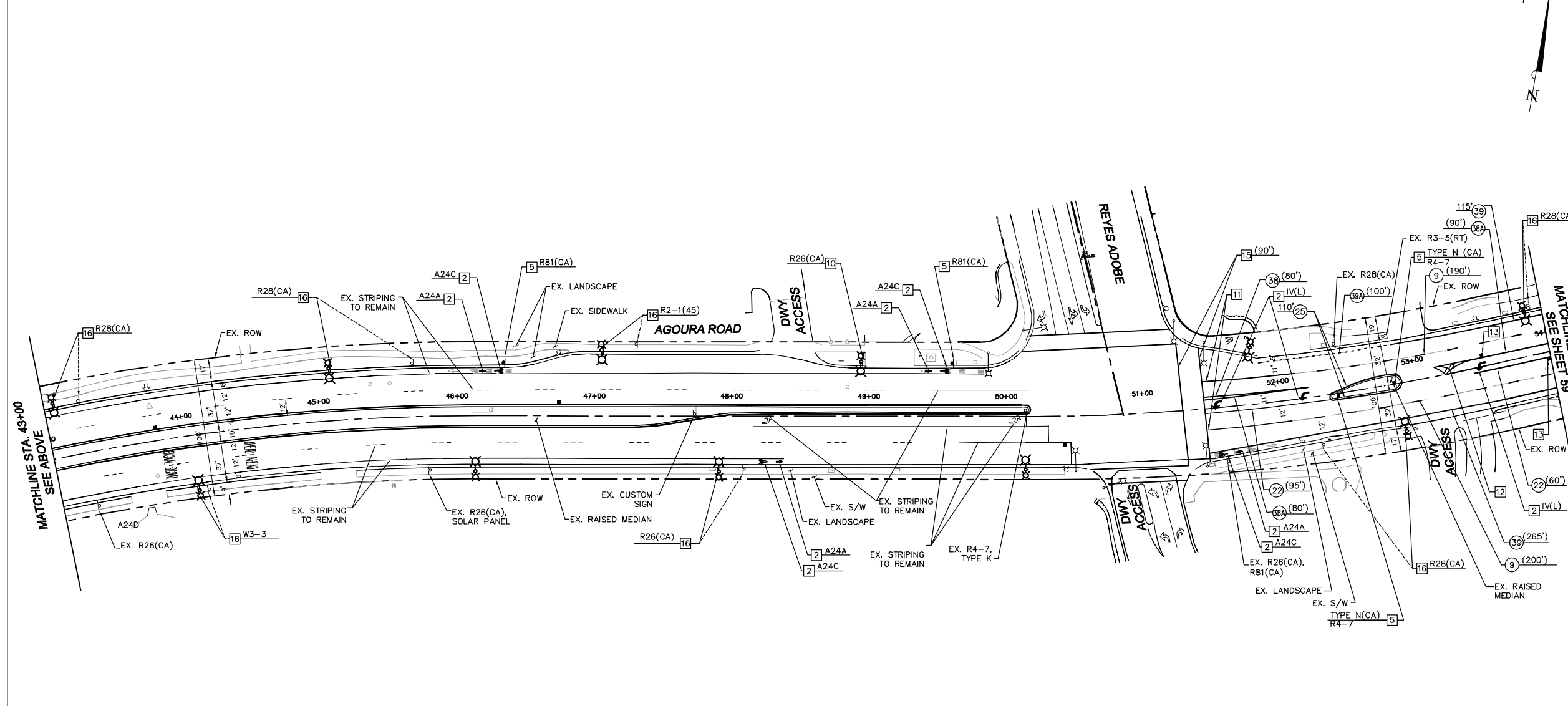
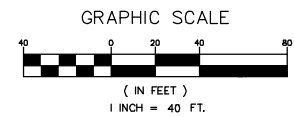
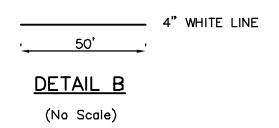
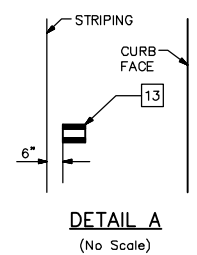

1		50%PS&E		9/9/11
2		75%PS&E		2/28/12
3		90%PS&E		6/8/12
4		100%PS&E		10/5/12
REV	SYMBOL	DESCRIPTION OF CHANGE	RCE	DATE

PREPARED BY:

**Kimley-Horn and Associates, Inc.**  
 © 2012 KIMLEY-HORN AND ASSOCIATES, INC.  
 6800 Owensmouth Avenue, Suite 410, Canoga Park, CA 91303  
 Tel (818) 227-2790 Fax (916) 608-0885

SRIKANTH CHAKRAVARTHY R.C.E. C73629 DATE



REVIEWED BY:

CHARMAINE YAMBAO  
 ASSOCIATE CIVIL ENGINEER

APPROVED BY:

RAMIRO ADEVA  
 DIRECTOR OF PUBLIC WORKS/CITY ENGINEER

CITY OF  
**AGOURA HILLS**

AGOURA ROAD WIDENING  
 SIGNING AND STRIPING PLAN SN-2

DRAWN BY: RC  
 CHECKED BY: SC/JM  
 KHA JOB NUMBER: 099083017

SHEET 58 OF 101

100% SUBMITTAL - OCTOBER 2012

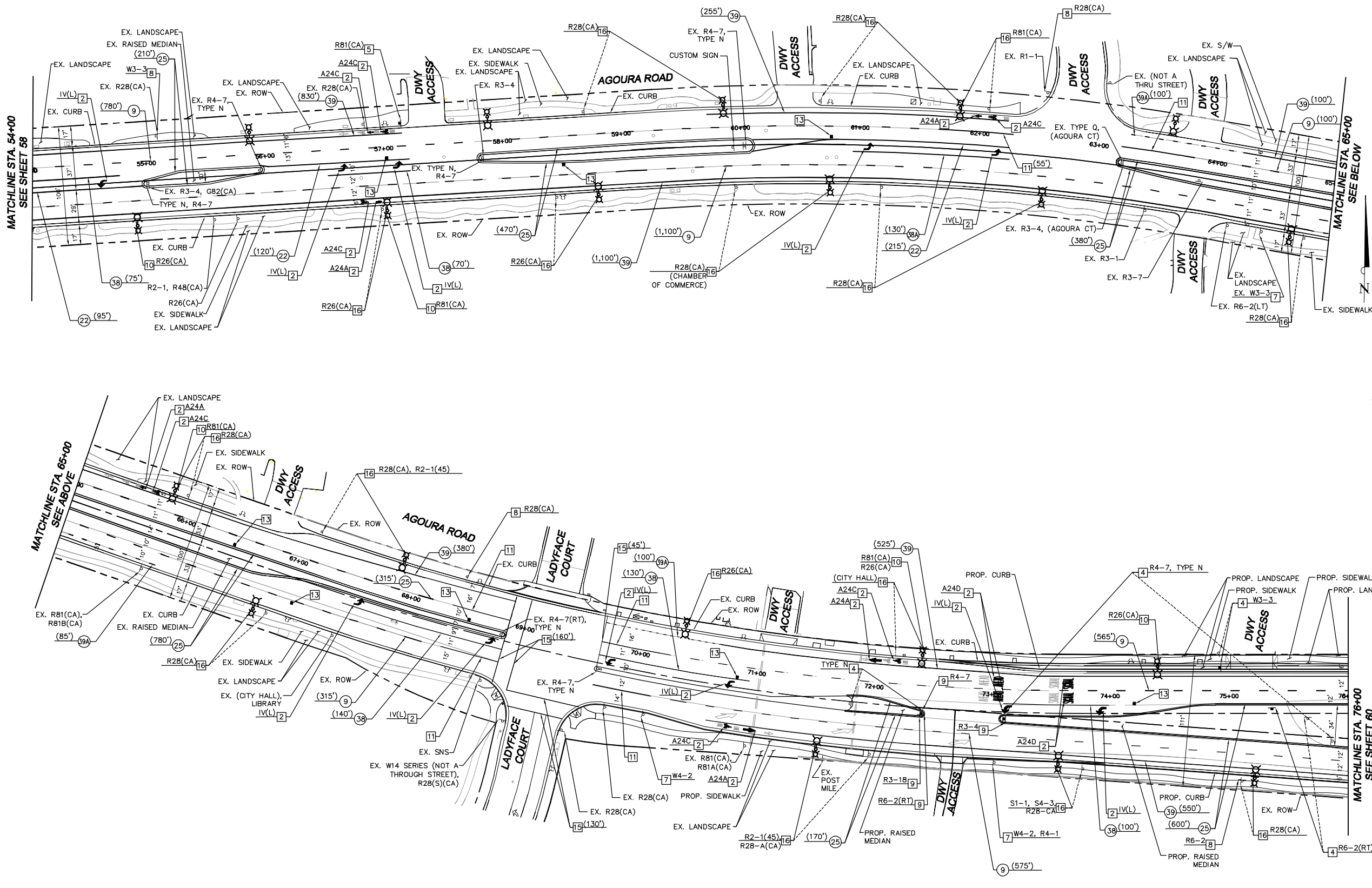

**SIGNING AND STRIPING  
(THIS SHEET ONLY)**

- 1 GRIND CONFLICTING EXISTING STRIPING, LEGEND OR ARROW, EXCEPT AS NOTED TO REMAIN. REMOVE RAISED PAVEMENT MARKERS AS NECESSARY.
- 2 PAINT STRIPING, LEGEND OR ARROWS PER CALTRANS STANDARD PLANS OR TYPE AS NOTED. INSTALL RAISED PAVEMENT MARKERS AS REQUIRED.
- 3 JOIN TO EXISTING STRIPING AS SHOWN.
- 4 RELOCATE EXISTING SIGN(S) AND POST AS NOTED.
- 5 FURNISH AND INSTALL NEW SIGN(S) ON NEW POST. SIGN(S) AS SHOWN.
- 6 FURNISH AND INSTALL NEW OBJECT MARKER AS SHOWN.
- 7 REMOVE EXISTING SIGN(S) AND POST AS NOTED.
- 8 REMOVE EXISTING SIGN(S) AS SHOWN.
- 9 FURNISH AND INSTALL NEW SIGN(S) ON EXISTING POST.
- 10 FURNISH AND INSTALL NEW SIGN(S) AS SHOWN.
- 11 INSTALL 50' 4" WHITE LINE PER DETAIL B.
- 12 INSTALL 4" DIAGONAL THERMO WHITE LINES, 30' O.C. AS SHOWN.
- 13 FURNISH AND INSTALL BLUE REFLECTOR PER DETAIL "A"
- 14 FURNISH AND INSTALL NEW SIGN(S) ON EXISTING LUMINAIRE AS SHOWN.
- 15 PAINT 12" WHITE LINE. LENGTH AS SHOWN.
- 16 RELOCATE SIGN(S) AS SHOWN AND REMOVE EXISTING POST.

**LEGEND**

- (XX) INSTALL CALTRANS STRIPING AND PAVEMENT MARKINGS PER CALTRANS STANDARD PLANS A20A THRU A24E. DETAIL NO. AS INDICATED
- CENTERLINE
- † EXISTING SIGN
- ⚡ EXISTING FIRE HYDRANT
- † PROPOSED SIGN
- PROPOSED STRIPING
- ↶ EXISTING PAVEMENT MARKING TO BE REMOVED
- ↷ PROPOSED PAVEMENT MARKING

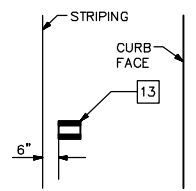

**DETAIL A**  
(No Scale)

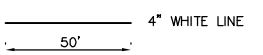

**DETAIL B**  
(No Scale)

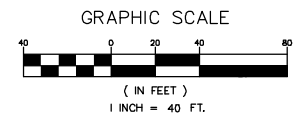

1		50%PS&E		9/9/11
2		75%PS&E		2/28/12
3		90%PS&E		6/8/12
4		100%PS&E		10/5/12
REV	SYMBOL	DESCRIPTION OF CHANGE	RCE	DATE

PREPARED BY:

**Kimley-Horn and Associates, Inc.**  
 © 2012 KIMLEY-HORN AND ASSOCIATES, INC.  
 6800 Owensmouth Avenue, Suite 410, Canoga Park, CA 91303  
 Tel (818) 227-2790 Fax (916) 608-0885

REGISTERED PROFESSIONAL ENGINEER  
 SRINATH CHAKRAVARTHY No. C73629  
 CIVIL STATE OF CALIFORNIA

REVIEWED BY:

CHARMAINE YAMBAO DATE  
 ASSOCIATE CIVIL ENGINEER

APPROVED BY:

RAMIRO ADEVA DATE  
 DIRECTOR OF PUBLIC WORKS/CITY ENGINEER

CITY OF  
**AGOURA HILLS**

AGOURA ROAD WIDENING  
 SIGNING AND STRIPING PLAN SN-3

DRAWN BY: RC  
 CHECKED BY: SC/JM  
 KHA JOB NUMBER: 099083017

REV	SYMBOL	DESCRIPTION OF CHANGE	RCE	DATE

100% SUBMITTAL - OCTOBER 2012



**SIGNING AND STRIPING  
(THIS SHEET ONLY)**

- 1 GRIND CONFLICTING EXISTING STRIPING, LEGEND OR ARROW, EXCEPT AS NOTED TO REMAIN. REMOVE RAISED PAVEMENT MARKERS AS NECESSARY.
- 2 PAINT STRIPING, LEGEND OR ARROWS PER CALTRANS STANDARD PLANS OR TYPE AS NOTED. INSTALL RAISED PAVEMENT MARKERS AS REQUIRED.
- 3 JOIN TO EXISTING STRIPING AS SHOWN.
- 4 RELOCATE EXISTING SIGN(S) AND POST AS NOTED.
- 5 FURNISH AND INSTALL NEW SIGN(S) ON NEW POST. SIGN AS SHOWN.
- 6 FURNISH AND INSTALL NEW OBJECT MARKER AS SHOWN.
- 7 REMOVE EXISTING SIGN(S) AND POST AS NOTED.
- 8 REMOVE EXISTING SIGN(S) AS SHOWN.
- 9 FURNISH AND INSTALL NEW SIGN(S) ON EXISTING POST.
- 10 FURNISH AND INSTALL NEW SIGN(S) AS SHOWN.
- 11 INSTALL 50' 4" WHITE LINE PER DETAIL B.
- 12 INSTALL 4" DIAGONAL THERMO WHITE LINES, 30' O.C. AS SHOWN.
- 13 FURNISH AND INSTALL BLUE REFLECTOR PER DETAIL "A"
- 14 FURNISH AND INSTALL NEW SIGN(S) ON EXISTING LUMINAIRE AS SHOWN.
- 15 PAINT 12" WHITE CROSSWALK. LENGTH AS SHOWN.
- 16 RELOCATE SIGN(S) AS SHOWN AND REMOVE EXISTING POST.

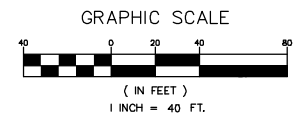
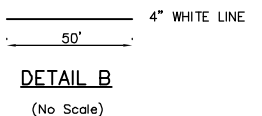
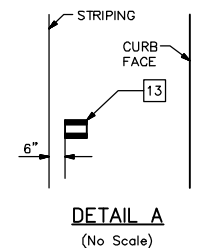
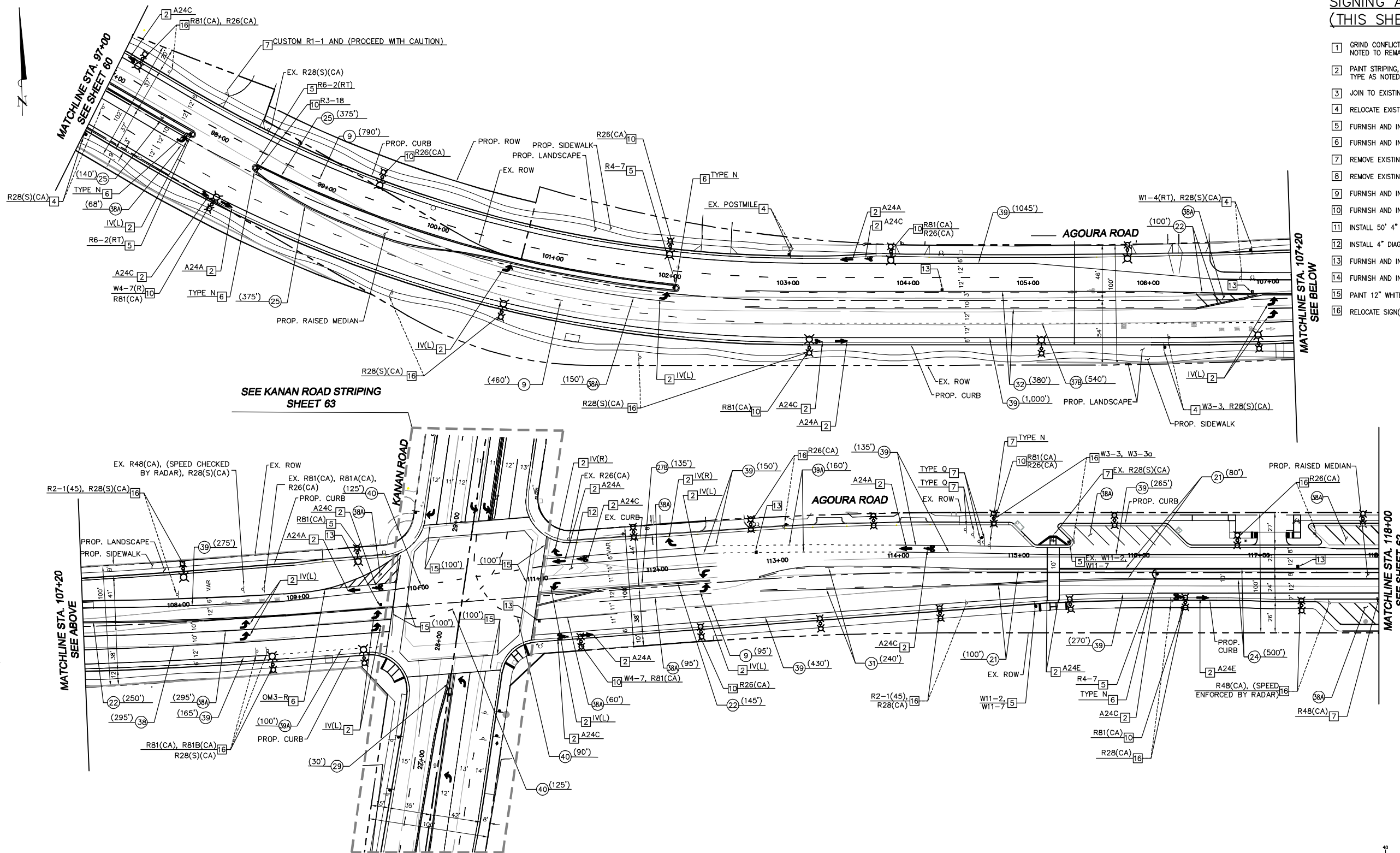

1		50%PS&E		9/9/11
2		75%PS&E		2/28/12
3		90%PS&E		6/8/12
4		100%PS&E		10/5/12
REV	SYMBOL	DESCRIPTION OF CHANGE	RCE	DATE

PREPARED BY:

**Kimley-Horn and Associates, Inc.**  
 © 2012 KIMLEY-HORN AND ASSOCIATES, INC.  
 6800 Owensmouth Avenue, Suite 410, Canoga Park, CA 91303  
 Tel (818) 227-2790 Fax (916) 608-0885

SRIKANTH CHAKRAVARTHY R.C.E. C73629 DATE

REVIEWED BY:

CHARMAINE YAMBAO DATE  
 ASSOCIATE CIVIL ENGINEER

APPROVED BY:

RAMIRO ADEVA DATE  
 DIRECTOR OF PUBLIC WORKS/CITY ENGINEER

CITY OF  
**AGOURA HILLS**

AGOURA ROAD WIDENING  
 SIGNING AND STRIPING PLAN SN-5

DRAWN BY: RC  
 CHECKED BY: SC/JM  
 KHA JOB NUMBER: 099083017

SHEET 61 OF 101

100% SUBMITTAL - OCTOBER 2012



SEE AGOURA ROAD STRIPING  
SHEET 61

SIGNING AND STRIPING (THIS SHEET ONLY)

- 1 GRIND CONFLICTING EXISTING STRIPING, LEGEND OR ARROW, EXCEPT AS NOTED TO REMAIN. REMOVE RAISED PAVEMENT MARKERS AS NECESSARY.
- 2 PAINT STRIPING, LEGEND OR ARROWS PER CALTRANS STANDARD PLANS OR TYPE AS NOTED. INSTALL RAISED PAVEMENT MARKERS AS REQUIRED.
- 3 JOIN TO EXISTING STRIPING AS SHOWN.
- 4 RELOCATE EXISTING SIGN(S) AND POST AS NOTED.
- 5 FURNISH AND INSTALL NEW SIGN(S) ON NEW POST. SIGN AS SHOWN.
- 6 FURNISH AND INSTALL NEW OBJECT MARKER AS SHOWN.
- 7 REMOVE EXISTING SIGN(S) AND POST AS NOTED.
- 8 REMOVE EXISTING SIGN(S) AS SHOWN.
- 9 FURNISH AND INSTALL NEW SIGN(S) ON EXISTING POST.
- 10 FURNISH AND INSTALL NEW SIGN(S) AS SHOWN.
- 11 INSTALL 50' 4" WHITE LINE PER DETAIL B.
- 12 INSTALL 4" DIAGONAL THERMO WHITE LINES, 30' O.C. AS SHOWN.
- 13 FURNISH AND INSTALL BLUE REFLECTOR PER DETAIL "A"
- 14 FURNISH AND INSTALL NEW SIGN(S) ON EXISTING LUMINAIRE AS SHOWN.
- 15 PAINT 12" WHITE CROSSWALK. LENGTH AS SHOWN.
- 16 RELOCATE SIGN(S) AS SHOWN AND REMOVE EXISTING POST.

LEGEND

- (XX) INSTALL CALTRANS STRIPING AND PAVEMENT MARKINGS PER CALTRANS STANDARD PLANS A20A THRU A24E DETAIL NO. AS INDICATED
- CENTERLINE
- † EXISTING SIGN
- † EXISTING FIRE HYDRANT
- † PROPOSED SIGN
- PROPOSED STRIPING
- ↪ EXISTING PAVEMENT MARKING TO BE REMOVED
- ↪ PROPOSED PAVEMENT MARKING

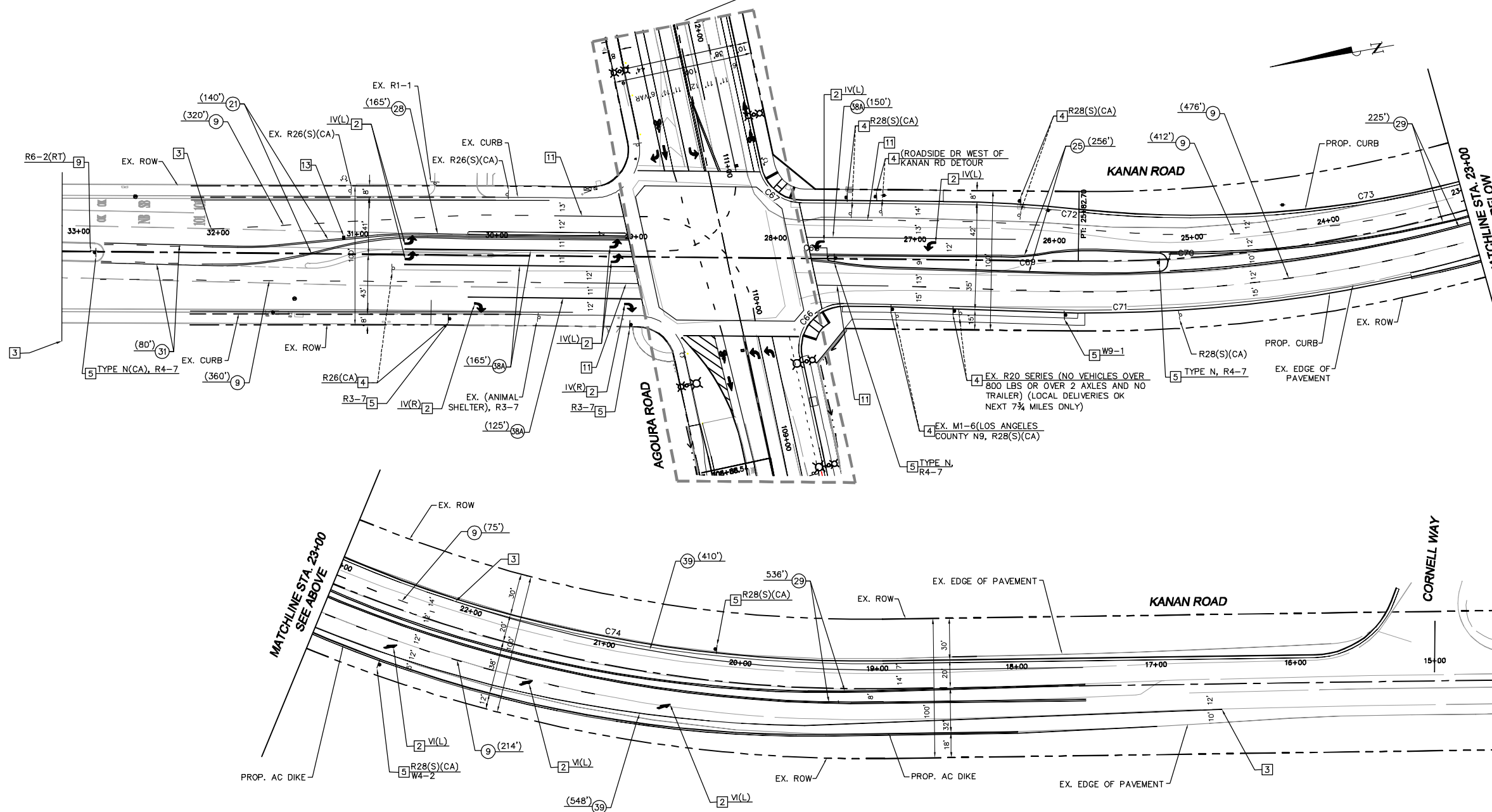
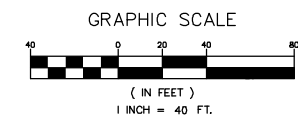
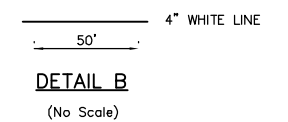
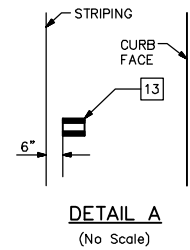

1		50%PS&E		9/9/11
2		75%PS&E		2/28/12
3		90%PS&E		6/8/12
4		100%PS&E		10/5/12
REV	SYMBOL	DESCRIPTION OF CHANGE	RCE	DATE

PREPARED BY:

**Kimley-Horn and Associates, Inc.**  
© 2012 KIMLEY-HORN AND ASSOCIATES, INC.  
6800 Owensmouth Avenue, Suite 410, Canoga Park, CA 91303  
Tel (818) 227-2790 Fax (916) 608-0885

SRIKANTH CHAKRAVARTHY R.C.E. C73629 DATE

REVIEWED BY:

CHARMAINE YAMBAO DATE  
ASSOCIATE CIVIL ENGINEER

APPROVED BY:

RAMIRO ADEVA DATE  
DIRECTOR OF PUBLIC WORKS/CITY ENGINEER

CITY OF  
**AGOURA HILLS**

AGOURA ROAD WIDENING  
SIGNING AND STRIPING PLAN SN-7

DRAWN BY: RC  
CHECKED BY: SC/JM  
KHA JOB NUMBER: 099083017

SHEET 63 OF 101

100% SUBMITTAL - OCTOBER 2012

**GENERAL NOTES:**

- TRAFFIC SIGNAL AND HIGHWAY SAFETY LIGHTING SYSTEMS SHALL CONFORM TO 2010 CALTRANS STANDARD PLANS AND STANDARD SPECIFICATIONS, AS SHOWN HEREON AND IN THE SPECIAL PROVISIONS.
- ALL MATERIAL AND EQUIPMENT SHALL BE FURNISHED AND INSTALLED BY THE CONTRACTOR.
- ALL SIGNAL EQUIPMENT SHALL BE RE-WIRED IN ACCORDANCE WITH THE NEW PROPOSED SIGNAL PHASE DIAGRAM.
- PEDESTRIAN HEADS SHALL BE STATE TYPE "A" WITH INTERNATIONAL SYMBOLS. UPRaised HAND AND WALKMAN SHALL BE "LED" MODULE AND CONFORM TO CALTRANS SPECIAL PROVISIONS.
- CONDUIT SHALL BE 3" GALVANIZED RIGID UNLESS OTHERWISE SPECIFIED.
- PULL BOXES SHALL BE SIZE No. 6E UNLESS OTHERWISE SPECIFIED.
- ALL WIRING SHALL BE MARKED (TAGGED) WITHIN THE CONTROLLER CABINET FOR PHASE IDENTIFICATION.
- POLE LOCATIONS SHOWN HEREON ARE EXISTING.
- THE CONTRACTOR SHALL NOTIFY UNDERGROUND SERVICE ALERT (USA) AT 811, 48 HOURS PRIOR TO EXCAVATION. NO EXCAVATION SHALL BEGIN PRIOR TO THE MARKING OF UTILITY LOCATIONS.
- UTILITIES SHOWN ON THESE PLANS ARE CORRECT AND ACCURATE TO THE EXTENT OF AVAILABLE RECORDS. THE CONTRACTOR IS REQUIRED TO TAKE STEPS TO ASCERTAIN THE EXACT LOCATION OF THE UNDERGROUND FACILITIES PRIOR TO DOING WORK THAT MAY DAMAGE OR INTERFERE WITH THEIR SERVICE.
- FOR SIGNING AND STRIPING SEE SIGNING AND STRIPING SHEETS.
- THIS PLAN IS ACCURATE FOR TRAFFIC SIGNAL WORK ONLY.
- ALL VEHICLE HEADS SHALL HAVE 12" LENSES WITH LOUVER SLOTTED BACKPLATES AND TYPE 1 "LED" INDICATIONS. USE DIALIGHT MODEL 433 SERIES, OR APPROVED EQUAL.
- VIDEO DETECTION SYSTEM AND CAMERA SHALL BE FURNISHED AND INSTALLED BY THE CONTRACTOR. MANUFACTURER REPRESENTATIVE SHALL BE PRESENT DURING THE INSTALLATION OF THE VIDEO DETECTION SYSTEM AND CAMERA. SEE SPECIAL PROVISIONS.
- DETECTION ZONES SHALL BE CENTERED IN THE LANE AND 2- FEET INTO CROSSWALK UNLESS OTHERWISE NOTED.
- INDICATES PROPOSED VIDEO DETECTION ZONE.
- INDICATES VIDEO DETECTION CAMERA.
- VEHICLE HEAD MOUNTINGS, PEDESTRIAN HEAD MOUNTINGS, PULL BOXES AND CONTROLLER ASSEMBLY SHALL CONFORM TO THE LOS ANGELES COUNTY STANDARD PLANS AND SPECIFICATIONS, LATEST EDITION.
- THE HEIGHT OF ALL PEDESTRIAN PUSH BUTTONS SHALL BE 3'-4" FROM THE GROUND. ALL PED PUSH BUTTONS SHALL BE ADA APPROVED POLARA ENGINEERING "BULL DOG" OR CITY APPROVED EQUAL.
- CONTRACTOR SHALL FURNISH AND INSTALL SPECIAL PEDESTRIAN CROSSING SIGN (8"x11") ABOVE EACH PEDESTRIAN PUSH BUTTON.
- LOCATE ALL SUBSTRUCTURES PRIOR TO CONSTRUCTION. HAND DIG FOUNDATIONS UNTIL CLEAR OF OBSTRUCTIONS. COORDINATE POLE INSTALLATIONS WITH OVERHEAD UTILITY OR SUBSTRUCTURE OWNERS.
- CONTRACTOR SHALL NOT WILLFULLY PROCEED WITH CONSTRUCTION AS SHOWN WHEN IT IS OBVIOUS THAT UNKNOWN CONDITIONS AND/OR OBJECTS EXIST THAT MAY NOT HAVE BEEN KNOWN DURING THE PREPARATION OF THESE PLANS. SUCH CONDITIONS AND/OR OBJECTS SHALL BE IMMEDIATELY BROUGHT TO THE ATTENTION OF THE CITY. THE CONTRACTOR SHALL ASSUME FULL RESPONSIBILITY FOR ALL NECESSARY REVISIONS DUE TO FAILURE TO GIVE SUCH NOTIFICATION.
- CONTRACTOR SHALL BE RESPONSIBLE FOR ANY COORDINATION WITH SUBCONTRACTORS AS REQUIRED TO ACCOMPLISH OPERATION.
- ALL EXISTING IMPROVEMENTS, MATERIALS AND PLANT MATERIAL TO REMAIN WITHIN THE CONSTRUCTION AREA SHALL BE PROPERLY AND ADEQUATELY PROTECTED FROM DAMAGE DURING CONSTRUCTION. IT SHALL BE THE RESPONSIBILITY OF THE CONTRACTOR TO RESTORE TO ORIGINAL CONDITION OR REPLACE IN KIND OF THESE EXISTING ITEMS THAT ARE DAMAGED OR DISTURBED IN ANY WAY, AT NO COST TO THE CITY.
- CONTRACTOR SHALL VISIT SITE PRIOR TO BID. NO CHANGE ON CONTRACT PRICE WILL BE ALLOWED FOR ACTUAL OR CLAIMED DISCREPANCY BETWEEN EXISTING SITE CONDITIONS AND THOSE SHOWN ON PLANS.
- ANY MODIFICATIONS OF OR CHANGE IN APPROVED PLANS MUST BE APPROVED BY THE CITY TRAFFIC ENGINEER.
- THE CONTRACTOR SHALL OBTAIN TIMING SHEET FOR TRAFFIC SIGNAL MODIFICATIONS, PRIOR TO BEGINNING OF CONSTRUCTION. CONTACT CHARMINE YAMBAO AT (818) 597-7360.
- CONTRACTOR SHALL HAVE A CERTIFIED TRAFFIC SIGNAL TECHNICIAN HARDWIRE THE TRAFFIC SIGNAL CONTROLLER'S CONFLICT MONITOR TO MONITOR FOR AN ENTRAPMENT SITUATION. (SEE CITY TRAFFIC ENGINEER FOR WIRING DIAGRAM).
- THE INTERSECTION SHALL NOT OPERATE ON RECALL NO MORE THAN THREE DAYS. IT IS THE RESPONSIBILITY OF THE CONTRACTOR TO SCHEDULE TIMELY CONSTRUCTION PHASE PERIODS TO MINIMIZE THE INTERSECTION TO OPERATE ON RECALL MODE.
- CONTRACTOR SHALL FURNISH AND INSTALL SPECIAL "NEW TRAFFIC PATTERN" SIGNS WITH ORANGE FLAGS ON THE DAY OF TURN-ON AS DIRECTED BY THE ENGINEER. CONTRACTOR SHALL REMOVE SIGNS 30 DAYS AFTER INSTALLATION. CONTACT CITY OF AGOURA HILLS FOR SIGN DETAIL.

CONDUCTOR SCHEDULE										
AWG SIZE	Ø	CIRCUIT	1	2	3	4	5	6	7	8
3	12	POLE - A	-	-	-	-	-	-	-	-
		B	-	-	-	-	-	-	-	-
		C	-	-	-	-	-	-	-	-
		D	-	-	-	-	-	-	-	-
		E	-	-	-	-	-	-	-	-
		F	-	-	-	-	-	-	-	-
		G	-	-	-	-	-	-	-	-
		H	-	-	-	-	-	-	-	-
TOTAL CABLES-3 CONDUCT./12 CONDUCT.			1	2	3	4	5	6	7	8
#10	LIGHTING	-	2	2	2	2	2	2	2	2
	IISNS	-	2	2	2	2	2	2	2	2
	SIG. COMMON	1	1	1	1	1	1	1	1	2
#6	SIGNAL SERVICE	-	-	-	-	-	-	-	-	1
	VIDEO DETECTION CABLE	-	1	1	2	2	1	1	4	4
CONDUIT SIZE			2"	3"	2-3"	2-3"	3"	3"	2-4"	2-4"
CONDUIT FILL %			16	21	15	20	14	14	21	23

■ ALL CONDUIT AND CONDUCTORS ARE NEW UNLESS NOTED OTHERWISE  
(E) EXISTING

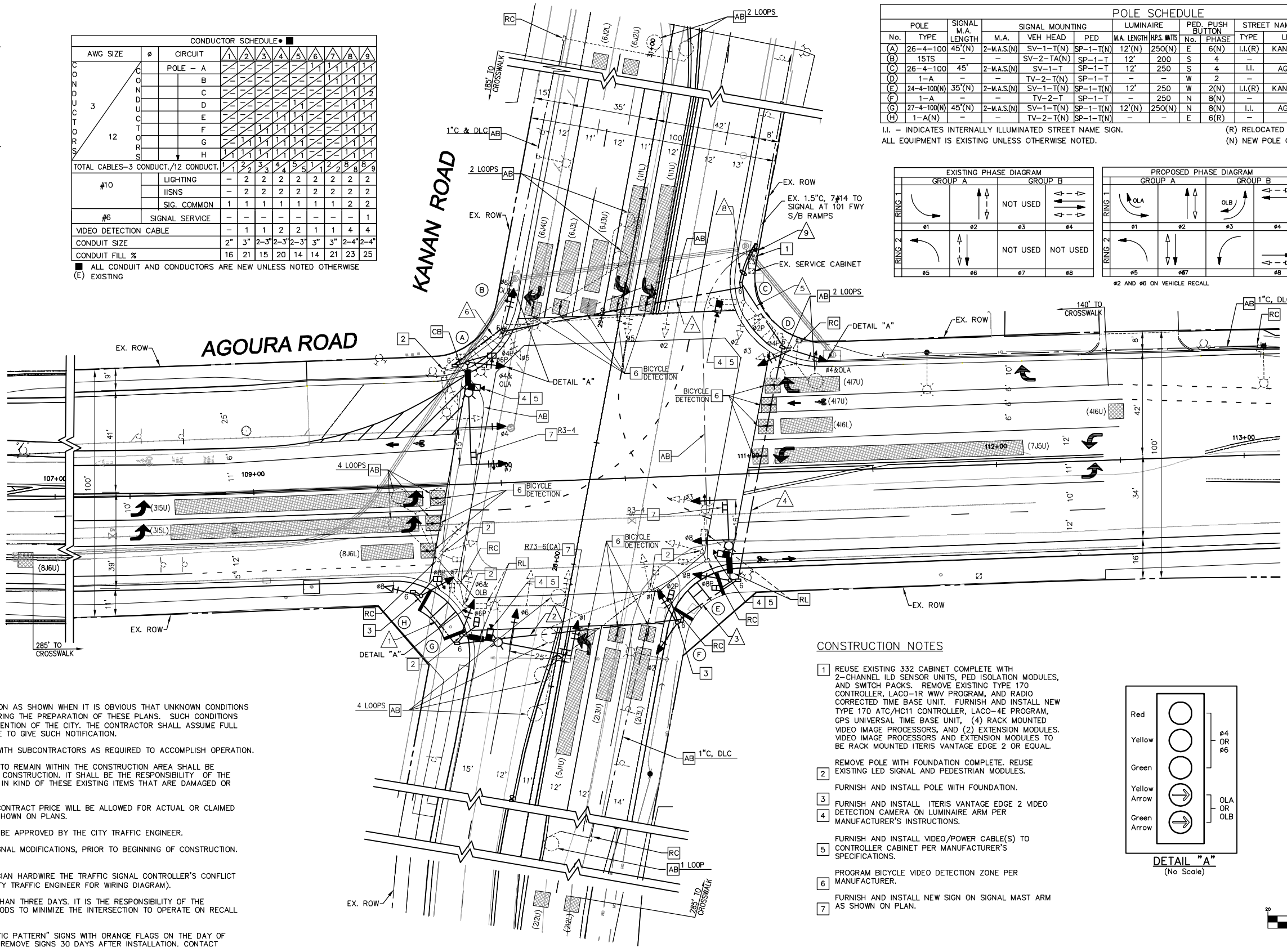

POLE SCHEDULE														
No.	TYPE	SIGNAL M.A. LENGTH	SIGNAL MOUNTING			LUMINAIRE		PED. PUSH BUTTON No.	PHASE	TYPE	LEGEND	POLE LOCATION		
			M.A.	VEH HEAD	PED	M.A. LENGTH	HPS. WTS					A	B	C
(A)	26-4-100	45'(N)	2-M.A.S.(N)	SV-1-T(N)	SP-1-T(N)	12'(N)	250(N)	E	6(N)	I.I.(R)	KANAN RD (R)	-	10.5'	2.0'
(B)	15TS	-	-	SV-2-TA(N)	SP-1-T	12'	200	S	4	-	-	-	11.0'	2.0'
(C)	26-4-100	45'	2-M.A.S.(N)	SV-1-T	SP-1-T	12'	250	S	4	I.I.	AGOURA RD	-	17.0'	2.0'
(D)	1-A	-	-	TV-2-T(N)	SP-1-T	-	-	W	2	-	-	-	-	-
(E)	24-4-100(N)	35'(N)	2-M.A.S.(N)	SV-1-T(N)	SP-1-T(N)	12'	250	W	2(N)	I.I.(R)	KANAN RD (R)	-	4.0'	4.5'
(F)	1-A	-	-	TV-2-T	SP-1-T	-	250	N	8(N)	-	-	-	3.5'	3.0'
(G)	27-4-100(N)	45'(N)	2-M.A.S.(N)	SV-1-T(N)	SP-1-T(N)	12'(N)	250(N)	N	8(N)	I.I.	AGOURA RD	-	13.0'	2.0'
(H)	1-A(N)	-	-	TV-2-T(N)	SP-1-T(N)	-	-	E	6(R)	-	-	-	11.0'	3.5'

I.I. - INDICATES INTERNALLY ILLUMINATED STREET NAME SIGN. (R) RELOCATED  
ALL EQUIPMENT IS EXISTING UNLESS OTHERWISE NOTED. (N) NEW POLE OR EQUIPMENT

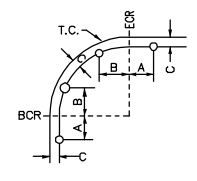
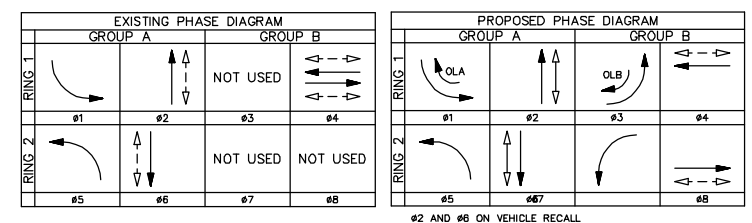

**CONSTRUCTION NOTES**

- REUSE EXISTING 332 CABINET COMPLETE WITH 2-CHANNEL ILD SENSOR UNITS, PED ISOLATION MODULES, AND SWITCH PACKS. REMOVE EXISTING TYPE 170 CONTROLLER, LACO-1R WWV PROGRAM, AND RADIO CORRECTED TIME BASE UNIT. FURNISH AND INSTALL NEW TYPE 170 ATC/H11 CONTROLLER, LACO-4E PROGRAM, GPS UNIVERSAL TIME BASE UNIT, (4) RACK MOUNTED VIDEO IMAGE PROCESSORS, AND (2) EXTENSION MODULES. VIDEO IMAGE PROCESSORS AND EXTENSION MODULES TO BE RACK MOUNTED ITERIS VANTAGE EDGE 2 OR EQUAL.
- REMOVE POLE WITH FOUNDATION COMPLETE. REUSE EXISTING LED SIGNAL AND PEDESTRIAN MODULES.
- FURNISH AND INSTALL POLE WITH FOUNDATION.
- FURNISH AND INSTALL ITERIS VANTAGE EDGE 2 VIDEO DETECTION CAMERA ON LUMINAIRE ARM PER MANUFACTURER'S INSTRUCTIONS.
- FURNISH AND INSTALL VIDEO/POWER CABLE(S) TO CONTROLLER CABINET PER MANUFACTURER'S SPECIFICATIONS.
- PROGRAM BICYCLE VIDEO DETECTION ZONE PER MANUFACTURER.
- FURNISH AND INSTALL NEW SIGN ON SIGNAL MAST ARM AS SHOWN ON PLAN.

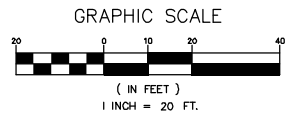
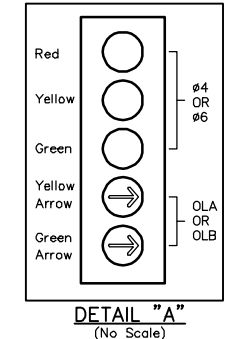

REV	SYMBOL	DESCRIPTION OF CHANGE	RCE	DATE

APPROVED BY:

© 2012 KIMLEY-HORN AND ASSOCIATES, INC.  
6800 Owensmouth Avenue, Suite 410, Canoga Park, CA  
Tel (818) 227-2790 Fax (916) 608-0885

APPROVED BY: SRIKANTH CHAKRAVARTHY R.C.E. 73629 DATE

REVIEWED BY:

CHARMAINE YAMBAO DATE  
ASSOCIATE CIVIL ENGINEER

APPROVED BY: RAMIRO ADEVA DATE  
CITY ENGINEER

CITY OF  
**AGOURA HILLS**

AGOURA ROAD WIDENING  
TRAFFIC SIGNAL PLAN DWG TS-1

DRAWN BY: RC  
CHECKED BY: SC/JM  
KHA JOB NUMBER: 099083017

SHEET 64 OF 101

100% SUBMITTAL - OCTOBER 2012

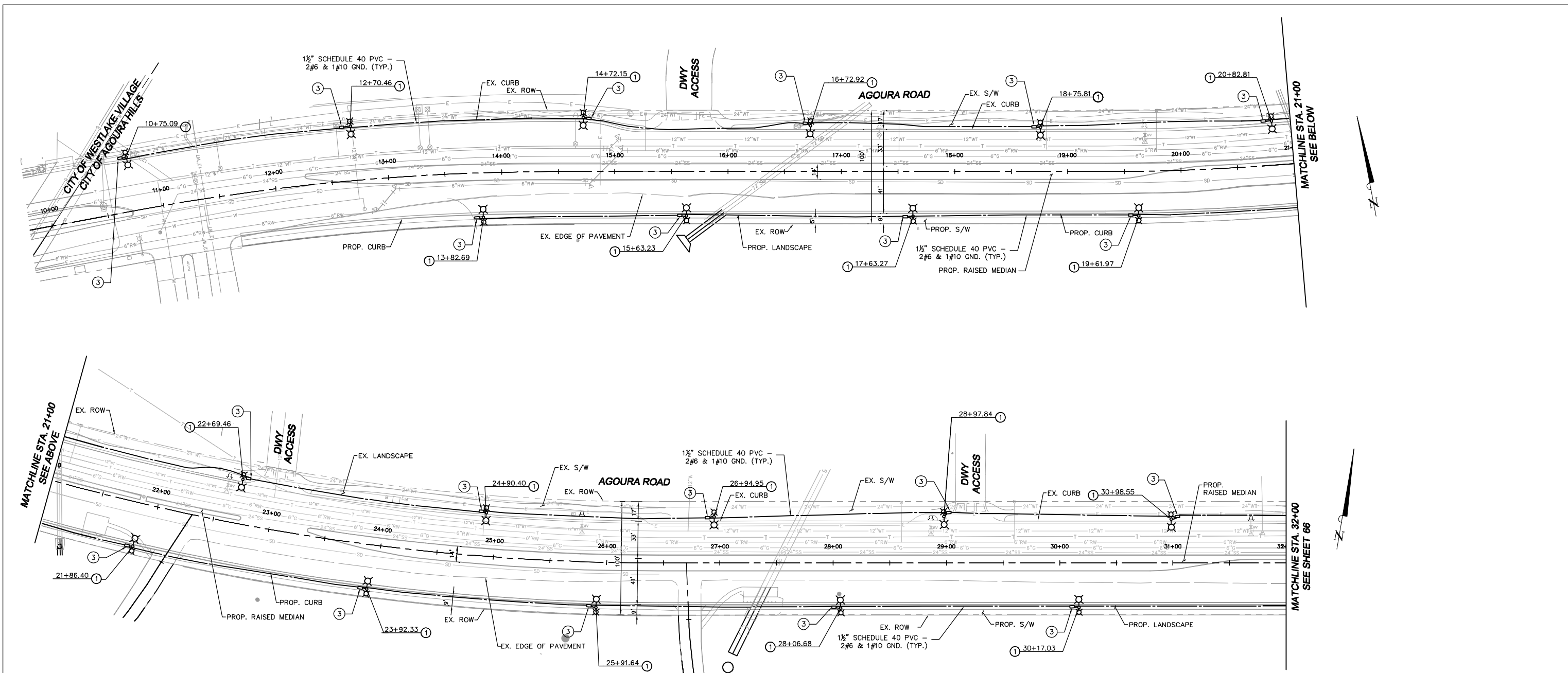

**ELECTRICAL CONSTRUCTION NOTES (THIS SHEET ONLY)**

- ① CONSTRUCT DECORATIVE STREET LIGHT AND FOUNDATION WITH 30' HEIGHT POLE, 8' MAST ARM, 70W 16000 SERIES LUMINAIRE AND 30W PENDANT LUMINAIRE PER DETAILS "A-D" ON SHEET 70.
- ② CONSTRUCT METERED TYPE III-BF ELECTRICAL SERVICE ENCLOSURE PER 2010 CALIFORNIA STANDARD PLAN ES-2E. PROVIDE 2P-20AMP BREAKER FOR EACH CIRCUIT.
- ③ CONSTRUCT #5 PULL BOX (25" X 15").
- ④ FURNISH AND INSTALL 2" RIGID STEEL CONDUIT -2#6 AND 1#10 GROUND.

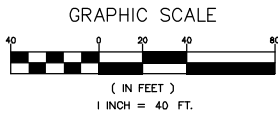

1		50%PS&E		9/9/11
2		75%PS&E		2/28/12
3		90%PS&E		6/8/12
4		100%PS&E		10/5/12
REV	SYMBOL	DESCRIPTION OF CHANGE	RCE	DATE

PREPARED BY:

**Kimley-Horn and Associates, Inc.**  
 © 2012 KIMLEY-HORN AND ASSOCIATES, INC.  
 6800 Owensmouth Avenue, Suite 410, Canoga Park, CA 91303  
 Tel (818) 227-2790 Fax (916) 608-0885

SRIKANTH CHAKRAVARTHY R.C.E. C73629 DATE



REVIEWED BY:

CHARMAINE YAMBAO DATE  
 ASSOCIATE CIVIL ENGINEER

APPROVED BY:

RAMIRO ADEVA DATE  
 DIRECTOR OF PUBLIC WORKS/CITY ENGINEER



AGOURA ROAD WIDENING  
 STREET LIGHTING LAYOUT SL-1

DRAWN BY: RC  
 CHECKED BY: SC/JM  
 KHA JOB NUMBER: 099083017  
 SHEET 65 OF 101

100% SUBMITTAL - OCTOBER 2012



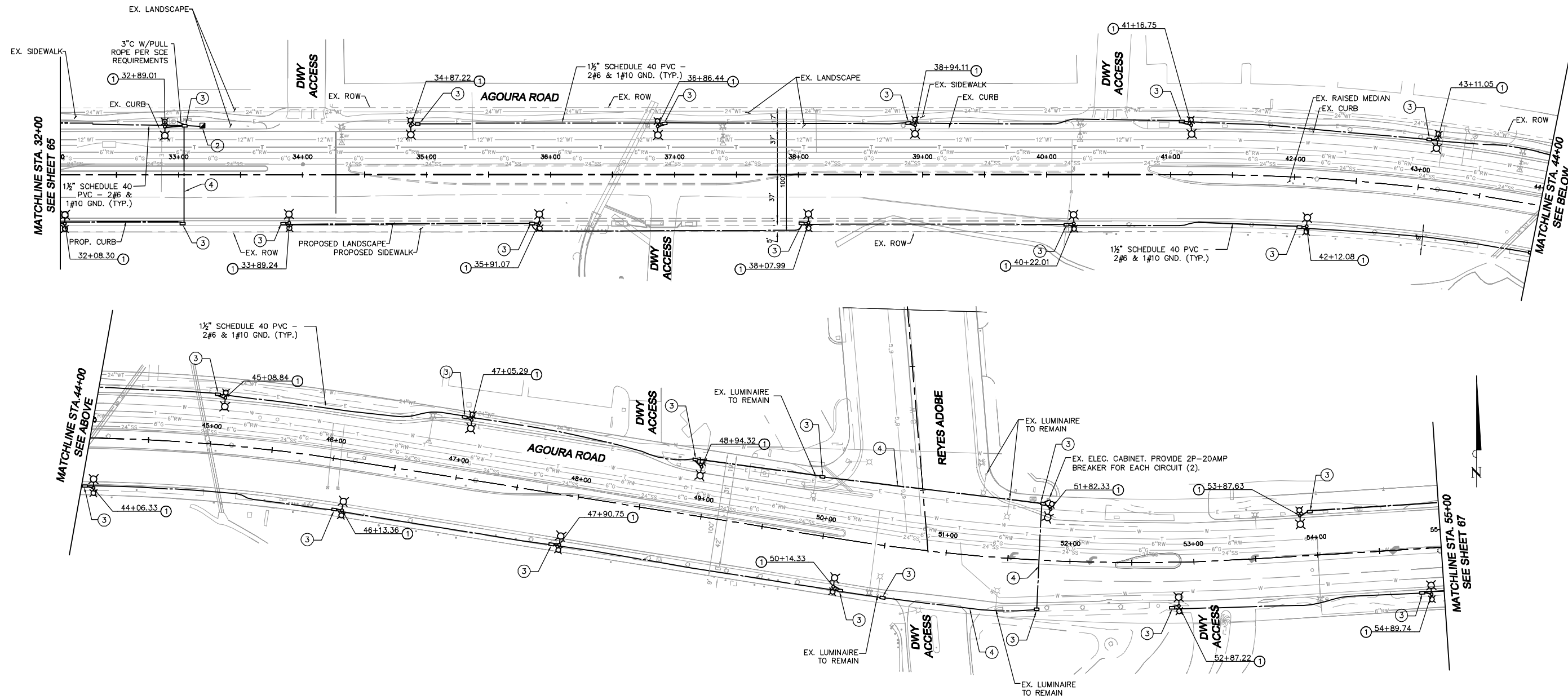

**ELECTRICAL CONSTRUCTION NOTES (THIS SHEET ONLY)**

- ① CONSTRUCT DECORATIVE STREET LIGHT AND FOUNDATION WITH 30' HEIGHT POLE, 8' MAST ARM, 100W 16000 SERIES LUMINAIRE AND 70W PENDANT LUMINAIRE PER DETAILS "A-D" ON SHEET 70.
- ② CONSTRUCT METERED TYPE III-BF ELECTRICAL SERVICE ENCLOSURE PER 2010 CALIFORNIA STANDARD PLAN ES-2E. PROVIDE 2P-20AMP BREAKER FOR EACH CIRCUIT.
- ③ CONSTRUCT #5 PULL BOX (25" X 15").
- ④ FURNISH AND INSTALL 2" RIGID STEEL CONDUIT -2#6 AND 1#10 GROUND.

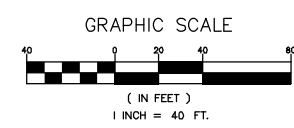

1		50%PS&E		9/9/11
2		75%PS&E		2/28/12
3		90%PS&E		6/8/12
4		100%PS&E		10/5/12
REV	SYMBOL	DESCRIPTION OF CHANGE	RCE	DATE

PREPARED BY:

**Kimley-Horn and Associates, Inc.**  
 © 2012 KIMLEY-HORN AND ASSOCIATES, INC.  
 6800 Owensmouth Avenue, Suite 410, Canoga Park, CA 91303  
 Tel (818) 227-2790 Fax (916) 608-0885

SRIKANTH CHAKRAVARTHY R.C.E. C73629 DATE

REVIEWED BY:

CHARMAINE YAMBAO DATE  
 ASSOCIATE CIVIL ENGINEER

APPROVED BY:

RAMIRO ADEVA DATE  
 DIRECTOR OF PUBLIC WORKS/CITY ENGINEER

AGOURA ROAD WIDENING  
 STREET LIGHTING LAYOUT SL-2

DRAWN BY: RC  
 CHECKED BY: SC/JM  
 KHA JOB NUMBER: 099083017

SHEET 66 OF 101

100% SUBMITTAL - OCTOBER 2012