

# CITY OF AGOURA HILLS

## AGOURA ROAD WIDENING

### FROM WESTERN CITY LIMIT TO CORNELL ROAD

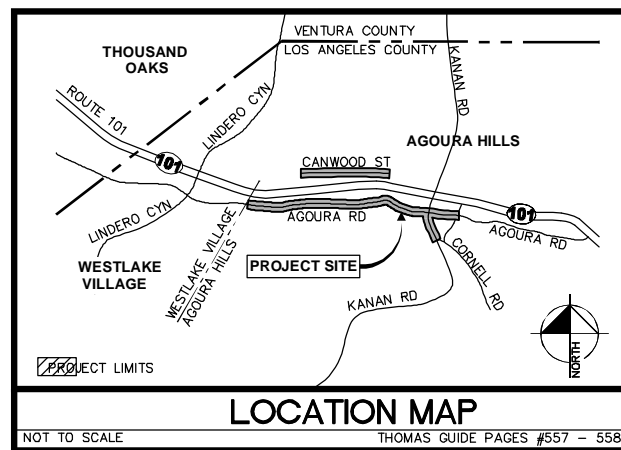
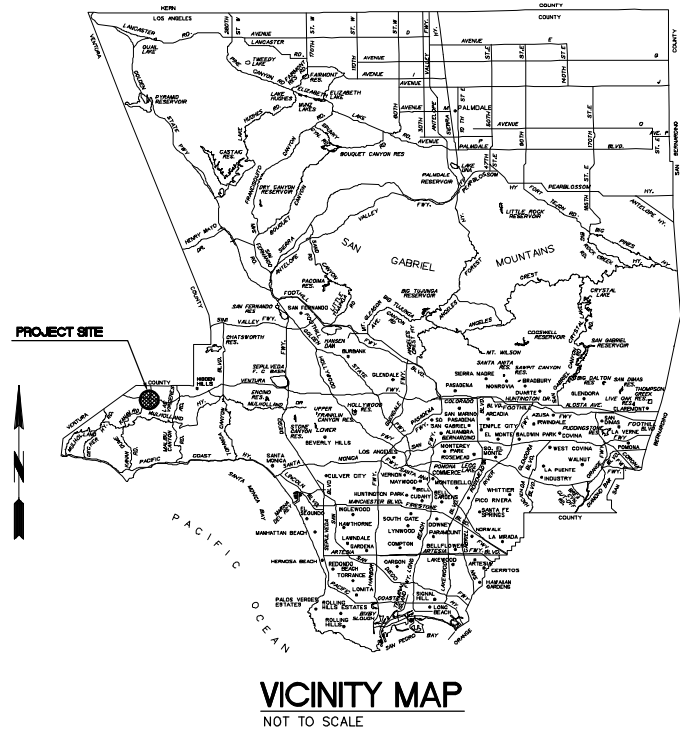

SHEET INDEX		
SHEET TITLE	SHEET NUMBER	DRAWING NUMBER (DWG)
TITLE SHEET	1	T-1
GENERAL NOTES, LEGEND AND ABBREVIATIONS SHEET	2-3	G-1 THROUGH G-2
TYPICAL SECTIONS	4-6	X-1 THROUGH X-3
STREET PLANS	7-20	L-1 THROUGH L-14
CONSTRUCTION DETAILS	21-28	CD-1 THROUGH CD-8
RETAINING WALL PLANS	29-31	RW-1 THROUGH RW-3
EROSION CONTROL PLANS	32-40	EC-0 THROUGH EC-8
UTILITY PLANS	41-47	UT-1 THROUGH UT-7
STORM DRAIN PLANS	48-56	SD-1 THROUGH SD-9
SIGNING AND STRIPING PLAN	57-63	SN-1 THROUGH SN-7
TRAFFIC SIGNAL PLAN	64	TS-1
STREET LIGHTING PLAN	65-70	SL-1 THROUGH SL-6
TREE REMOVAL PLANS	71-75	TR-1 THROUGH TR-5
HARDSCAPE PLANS	76-77	HS-1 THROUGH HS-2
PLANTING PLANS	78-82	LS-1 THROUGH LS-5
IRRIGATION PLANS	83-88	IR-1 THROUGH IR-6
STRUCTURAL PLANS	90-96	S-1 THROUGH S-7
CANWOOD PLANS	97-101	PR-0 THROUGH PR-4

PANEL	SHEET NO.					
	STREET PLANS	UTILITY PLANS	SIGNING AND STRIPING	STREET LIGHTING	PLANTING	IRRIGATION
1	7	41	57	65	78	83
2	8	41	57	65	78	83
3	9	42	58	66	79	84
4a	10	42	58	66	NA	NA
4b	10	43	59	67	NA	NA
5	11	43	59	67	79	84
6	12	44	60	68	80	85
7	13	44	60	68	80	85
8	15	45	61	69	81	86
9a	17	45	61	69	81	86
9b	19	47	63	NA	NA	NA
9c	20	47	NA	NA	NA	NA
10	18	46	62	69	82	87
11a	98					
11b	98					
12a	99					
12b	99					

NA--NOT A PART

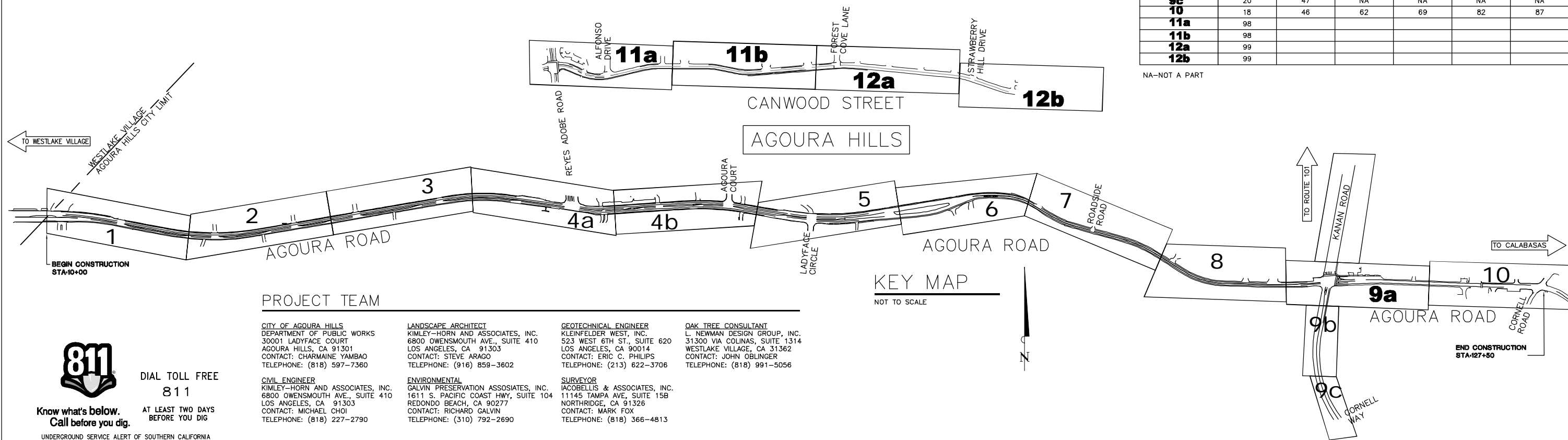

#### PROJECT TEAM

**CITY OF AGOURA HILLS**  
DEPARTMENT OF PUBLIC WORKS  
30001 LADYFACE COURT  
AGOURA HILLS, CA 91301  
CONTACT: CHARMINE YAMBABO  
TELEPHONE: (818) 597-7360

**CIVIL ENGINEER**  
KIMLEY-HORN AND ASSOCIATES, INC.  
6800 OWENSMOUTH AVE., SUITE 410  
LOS ANGELES, CA 91303  
CONTACT: MICHAEL CHOI  
TELEPHONE: (818) 227-2790

**LANDSCAPE ARCHITECT**  
KIMLEY-HORN AND ASSOCIATES, INC.  
6800 OWENSMOUTH AVE., SUITE 410  
LOS ANGELES, CA 91303  
CONTACT: STEVE ARAGO  
TELEPHONE: (916) 859-3602

**ENVIRONMENTAL**  
GALVIN PRESERVATION ASSOCIATES, INC.  
1611 S. PACIFIC COAST HWY, SUITE 104  
REDONDO BEACH, CA 90277  
CONTACT: RICHARD GALVIN  
TELEPHONE: (310) 792-2690

**GEOTECHNICAL ENGINEER**  
KLEINFELDER WEST, INC.  
523 WEST 6TH ST., SUITE 620  
LOS ANGELES, CA 90014  
CONTACT: ERIC C. PHILIPS  
TELEPHONE: (213) 622-3706

**SURVEYOR**  
IACOBELLIS & ASSOCIATES, INC.  
11145 TAMPA AVE, SUITE 15B  
NORTHRIDGE, CA 91326  
CONTACT: MARK FOX  
TELEPHONE: (818) 366-4813

**OAK TREE CONSULTANT**  
L. NEWMAN DESIGN GROUP, INC.  
31300 VIA COLINAS, SUITE 1314  
WESTLAKE VILLAGE, CA 91362  
CONTACT: JOHN OBLINGER  
TELEPHONE: (818) 991-5056



DIAL TOLL FREE  
**811**

Know what's below.  
Call before you dig.

AT LEAST TWO DAYS  
BEFORE YOU DIG

UNDERGROUND SERVICE ALERT OF SOUTHERN CALIFORNIA

REV	SYMBOL	DESCRIPTION OF CHANGE	RCE	DATE
1		50%PS&E		9/9/11
2		75%PS&E		2/28/12
3		90%PS&E		6/8/12
4		100%PS&E		10/5/12

PREPARED BY:



© 2012 KIMLEY-HORN AND ASSOCIATES, INC.  
6800 Owensmouth Avenue, Suite 410, Los Angeles CA  
Tel (818) 227-2790 Fax (916) 608-0885

MICHAEL CHOI R.C.E. 67851 DATE



REVIEWED BY:

CHARMAINE YAMBABO DATE  
ASSOCIATE CIVIL ENGINEER

APPROVED BY:

RAMIRO ADEVA DATE  
DIRECTOR OF PUBLIC WORKS/CITY ENGINEER



AGOURA ROAD WIDENING  
TITLE SHEET T-1

DRAWN BY: RC CHECKED BY: JS/MC KHA JOB NUMBER: 099083017

SHEET 1 OF 101

100% SUBMITTAL - OCTOBER 2012

## GENERAL NOTES

- ALL WORK SHALL BE DONE IN ACCORDANCE WITH THE STANDARD SPECIFICATIONS FOR PUBLIC WORKS CONSTRUCTION, LATEST EDITION, THE STANDARD PLANS FOR PUBLIC WORKS CONSTRUCTION (SPPWC), AND CITY OF AGOURA HILLS STANDARD PLANS. IN THE EVENT OF A CONFLICT BETWEEN THESE DOCUMENTS THE MOST STRINGENT REQUIREMENTS SHALL PREVAIL.
- THE CONTRACTOR SHALL REMOVE AND DISPOSE OF ALL EXISTING IMPROVEMENTS INTERFERING WITH THE PROPOSED WORK. WHETHER OR NOT SHOWN ON THE PLANS OR SPECIFIED IN THE SPECIAL PROVISIONS. NO IMPROVEMENTS ARE TO BE REMOVED IN THE PUBLIC RIGHT-OF-WAY UNLESS APPROVED BY THE CITY.
- THE CONTRACTOR SHALL ASSUME SOLE AND COMPLETE RESPONSIBILITY FOR THE JOB SITE CONDITIONS, INCLUDING SAFETY OF ALL PERSONS AND PROPERTY, DURING THE COURSE OF CONSTRUCTION OF THIS PROJECT. THIS REQUIREMENT SHALL APPLY CONTINUOUSLY, AND SHALL NOT BE LIMITED TO NORMAL WORKING HOURS.
- THE CONTRACTOR SHALL BECOME FAMILIAR WITH THE PLANS AND THE SITE CONDITIONS PRIOR TO COMMENCING WORK. IF CONDITIONS DIFFER FROM THOSE SHOWN IN THE PLANS, THE CONTRACTOR SHALL NOTIFY THE ENGINEER AND SHALL NOT BEGIN CONSTRUCTION UNTIL THE CHANGED CONDITIONS HAVE BEEN EVALUATED.
- WHEN JOINING EXISTING IMPROVEMENTS, THE CONTRACTOR SHALL SAW-CUT EXISTING SIDEWALK AND/OR CURB AND GUTTER AT THE NEAREST SCORELINE.
- THE CONTRACTOR SHALL SAW-CUT ALL CONCRETE AND/OR ASPHALT PAVEMENT PRIOR TO EXCAVATION, AND AT THE NEAREST SCORE LINES WHERE APPROPRIATE.
- THE CONTRACTOR SHALL REPLACE ALL IMPROVEMENTS TO MATCH EXISTING THAT ARE DAMAGED OR REMOVED DURING CONSTRUCTION OPERATIONS.
- SHOULD CONFLICTING INFORMATION BE FOUND ON THE PLANS, THE CONTRACTOR SHALL IMMEDIATELY NOTIFY THE ENGINEER IN WRITING BEFORE PROCEEDING WITH THE WORK IN QUESTION.
- CONTRACTOR SHALL BE RESPONSIBLE FOR OBTAINING A STORAGE AREA TO STOCKPILE MATERIAL, PARK EQUIPMENT AND STORE SURPLUS MATERIAL AT THE END OF EACH DAY. LOCATION USED AS A STORAGE AREA SHALL BE PER CITY CODE, AND APPROVED BY THE CITY PRIOR TO COMMENCING ANY WORK. NO STORAGE OF PIPE, MATERIAL OR EQUIPMENT SHALL BE PERMITTED WITHIN THE STREET RIGHT OF WAY.
- SEVENTY-TWO (72) HOURS (THREE WORKING DAYS) PRIOR TO ANY EXCAVATION, THE CONTRACTOR SHALL CONTACT UNDERGROUND SERVICE ALERT 811.
- THE CONTRACTOR SHALL OBTAIN AND PAY FOR ALL NECESSARY PERMITS AND LICENSES BEFORE COMMENCING WORK.
- CONTRACTOR SHALL BE RESPONSIBLE FOR REPAIRING DAMAGE TO ANY EXISTING UTILITY DURING EXCAVATION AT CONTRACTOR'S COST, WHETHER THE EXISTING UTILITY IS SHOWN OR NOT ON THE PLAN.
- CONTRACTOR SHALL REPLACE AT CONTRACTOR'S COST, ALL TRAFFIC STRIPING AND MARKING ON THE STREET AFFECTED BY THE CONSTRUCTION.
- ALL LAWN, SPRINKLER LINES, SPRINKLER HEAD AND APPURTENANCES, SHRUBS, GRASS, PLANTS AND GROUND COVERS THAT HAVE BEEN DAMAGED OR DISTURBED DURING CONSTRUCTION, SHALL BE REPLANTED AND/OR REPLACED TO MATCH EXISTING BY CONTRACTOR AT CONTRACTOR'S COST, AND THE WORK SITE SHALL BE RESTORED TO ITS ORIGINAL CONDITION.
- IF TREE ROOTS ARE ENCOUNTERED DURING EXCAVATION, CONTRACTOR SHALL IMMEDIATELY NOTIFY THE CITY.
- A TRAFFIC CONTROL PLAN SHALL BE SUBMITTED BY THE CONTRACTOR AND APPROVED BY THE CITY'S TRAFFIC ENGINEER PRIOR TO BEGINNING OF ANY WORK IN THE PUBLIC RIGHT-OF-WAY.
- CONTRACTOR SHALL PROVIDE "AS-BUILT" DRAWINGS TO THE CITY ENGINEER IMMEDIATELY UPON COMPLETION OF THE WORK.
- THE CONTRACTOR SHALL DEMONSTRATE WITH THE FLOW OF WATER FROM A WATER TRUCK OR HOSE THAT THE STREET AND GUTTER DRAIN SATISFACTORILY BEFORE THE CITY WILL ACCEPT THE WORK AS COMPLETE.
- THE CONTRACTOR SHALL BE AWARE OF OVERHEAD LINES AT ALL TIMES.
- STRAIGHT GRADE SHALL BE MAINTAINED BETWEEN CONTOUR LINES AND SPOT ELEVATIONS UNLESS OTHERWISE SHOWN ON PLANS.
- THE CONTRACTOR SHALL OBTAIN AN O.S.H.A. PERMIT FROM THE CALIFORNIA DIVISION OF INDUSTRIAL SAFETY PRIOR TO THE START OF CONSTRUCTION OF TRENCHES OR EXCAVATIONS FIVE FEET OR DEEPER.
- SHORING DESIGN, PLAN AND PERMITTING REQUIRED FOR EXCAVATIONS WILL BE PROVIDED BY CONTRACTOR.
- DIMENSIONS TO PIPE LINES ARE TO CENTERLINE, U.N.O.
- CONSTRUCTION GRADES ARE THE RESPONSIBILITY OF THE CONTRACTOR.
- CONTRACTOR TO COORDINATE WITH THE CITY TO PROVIDE NOTICES TO RESIDENTS AND BUSINESSES AT LEAST SEVENTY-TWO (72) HOURS PRIOR TO START OF CONSTRUCTION OR DIRECTED BY THE CITY.

## GENERAL NOTES (SIGNING AND STRIPING ONLY)

- ALL SIGNING AND STRIPING SHALL BE ACCORDING TO THE MAY 2006 EDITION OF THE STATE OF CALIFORNIA, DEPARTMENT OF TRANSPORTATION, STANDARD PLANS AND THE 2012 CALIFORNIA MANUAL OF UNIFORM TRAFFIC CONTROL DEVICES (CA MUTCD). ALL SIGNING AND STRIPING SHALL BE NEW INSTALLATIONS EXCEPT AS OTHERWISE NOTED.
- ALL CONFLICTING SIGNING OR STRIPING SHALL BE REMOVED. LINES AND PAVEMENT MARKINGS SHALL BE REMOVED BY SANDBLASTING OR GRINDING. PAVEMENT DAMAGED DUE TO REMOVING RAISED PAVEMENT MARKERS SHALL BE REPAIRED TO THE SATISFACTION OF THE CITY ENGINEER.
- ALL LANE LINES AT INTERSECTION APPROACHES SHALL BEGIN AND END WITH 50' OF SOLID WHITE.
- ALL ARROWS SHALL BE THERMOPLASTIC TYPE IV (L OR R), UNLESS OTHERWISE INDICATED.
- LANE WIDTHS SHALL BE MEASURED BETWEEN THE CENTER LINES OF EACH ADJACENT SINGLE OR DOUBLE STRIPE OR FACE OF CURB AS APPROPRIATE.
- STRIPING SHALL BE MARKED-OUT AND APPROVED BY THE CITY ENGINEER PRIOR TO FINAL INSTALLATION. CONTRACTOR SHALL WAIT ONE WEEK PRIOR TO FINAL STRIPING INSTALLATION.
- PROPOSED LANE LINES SHALL MATCH EXISTING LANE LINES UNLESS OTHERWISE INDICATED.
- SIGN POSTS SHALL BE "UNISTRUT" 2" SQUARE GALVANIZED STEEL POSTS WITH BREAKAWAY ANCHOR SLEEVE, OR APPROVED EQUAL.
- THIS PLAN IS ACCURATE FOR SIGNING AND STRIPING WORK ONLY.
- ALL STRIPING SHALL BE THERMOPLASTIC.

## GENERAL NOTES (ELECTRICAL ONLY)

- ALL NEW STREET LIGHT INSTALLATIONS SHALL MAINTAIN 30' MINIMUM CLEARANCE FROM THE BOTTOM OF THE LIGHT FIXTURE TO THE FINISHED SURFACE OF THE ROADWAY.
- ALL CONDUIT SHALL BE PLACED BEHIND CURB EXCEPT AT INTERSECTIONS.
- ALL INSTALLATION SHALL CONFORM TO THE GENERAL NOTES IN THE CITY OF AGOURA HILLS STANDARD PLANS.

## ENGINEER'S NOTES TO CONTRACTOR

- THE CONTRACTOR SHALL VERIFY ALL EXISTING DIMENSIONS, SITE AND SOIL CONDITIONS BEFORE COMMENCING WORK AND SHALL REPORT DISCREPANCIES OR CONFLICTS TO THE ENGINEER.
- THE CONTRACTOR SHALL BE RESPONSIBLE FOR THE RUBBISH AND DEBRIS RESULTING FROM THE WORK AND SHALL REMOVE IT FROM THE SITE AND DISPOSE OF IT PROPERLY.
- THE CONTRACTOR SHALL TAKE ALL NECESSARY MEASURES TO MINIMIZE INCONVENIENCE TO THE PUBLIC.
- THE CONTRACTOR SHALL ADJUST WATER VALVE BOXES, STORM DRAIN AND SEWER MANHOLES, VAULTS, METER BOXES, AND TRAFFIC SIGNAL AND STREET LIGHT PULL BOXES TO CONFORM TO FINISHED GRADES AS CONSTRUCTED WHETHER INDICATED ON THE PLANS OR NOT, AND SHALL BE APPROVED BY THE CITY ENGINEER OR HIS/HER REPRESENTATIVE.
- STORM DRAIN MANHOLES SHALL BE ADJUSTED TO GRADE PER LOS ANGELES COUNTY DEPARTMENT OF PUBLIC WORKS STANDARD DWG NO. 3029-0 (SPPWC 324-2).
- CONSTRUCTION SURVEYING IS THE RESPONSIBILITY OF THE CONTRACTOR.
- CONTRACTOR SHALL COORDINATE CONSTRUCTION WITH UTILITY OWNERS BEFORE START OF WORK, AND THROUGHOUT CONSTRUCTION.
- THE EXACT LOCATIONS OF UTILITIES HAVE NOT BEEN INDICATED ON THE CONSTRUCTION DRAWINGS. THE CONTRACTOR SHALL DETERMINE THE EXACT LOCATION OF ALL UTILITIES AND UNDERGROUND FACILITIES PRIOR TO DOING ANY WORK THAT MAY DAMAGE SUCH FACILITIES, OR IMPACT OR INTERFERE WITH THEIR SERVICE.
- AT LEAST 72 HOURS SHALL ELAPSE FROM THE TIME PCC IS PLACE UNTIL VEHICULAR TRAFFIC IS PERMITTED.
- THE MAXIMUM WIDTH OF PLACING PCC PAVEMENT IN ONE PASS SHALL BE 12 FEET.
- JOINT SEALANT SHALL BE PER SECTION 201-3.8 OF THE STANDARD SPECIFICATION FOR PUBLIC WORKS CONSTRUCTION.
- MATCH CURB AND GUTTER JOINTS WITH PCC PAVEMENT TRANSVERSE JOINTS.
- CONTRACTOR TO MAINTAIN ACCESS TO EXISTING DRIVEWAYS AT ALL TIMES.
- SAWING OF JOINTS SHALL BEGIN AS SOON AS THE CONCRETE HAS SUFFICIENTLY HARDENED TO PERMIT SAWING WITHOUT RAVELING, BUT NOT EXCEEDING SIX (6) HOURS AFTER PLACEMENT OF CONCRETE.
- P.C.C. TRENCH BACKFILL SAND CEMENT SLURRY NEEDS NOT TO BE COMPACTED. HOWEVER, IF SOIL-CEMENT MATERIALS ARE USED, THEN SOILS MUST BE COMPACTED TO 90% OF THE MAX. DENSITY OBTAINABLE BY ASTM D-1557.
- CONTRACTOR SHALL SCHEDULE THE CONSTRUCTION OF THIS PROJECT AS DIRECTED IN THE SPECIFICATIONS.
- CONTRACTOR SHALL MAINTAIN TRAFFIC FLOW AT ALL TIMES AS DIRECTED IN THE SPECIAL PROVISIONS.
- THE CONTRACTOR SHALL NOTIFY CITY OF AGOURA HILLS AND MTA BUS LINES OF ANY STREET CLOSURES FORTY-EIGHT (48) HOURS PRIOR TO BEGINNING ANY WORK.
- ALL IMPORTED SOIL USED FOR BACKFILL SHALL BE INSPECTED AND APPROVED BY THE GEOTECHNICAL ENGINEER.

20. CONTRACTOR AGREES THAT THEY SHALL ASSUME SOLE AND COMPLETE RESPONSIBILITY FOR JOB SITE CONDITIONS DURING THE COURSE OF CONSTRUCTION OF THIS PROJECT, INCLUDING: SAFETY OF ALL PERSONS AND PROPERTY, AND THIS REQUIREMENT SHALL APPLY CONTINUOUSLY AND NOT BE LIMITED TO NORMAL WORKING HOURS; AND THE CONTRACTOR SHALL INDEMNIFY AND HOLD HARMLESS THE ENGINEER AND CITY FROM ANY AND ALL LIABILITY REAL OR ALLEGED, IN CONNECTION WITH THE PERFORMANCE OF WORK ON THIS PROJECT EXCEPTING LIABILITY ARISING FROM THE SOLE NEGLIGENCE OF THE CITY OR ENGINEER.

21. CONTRACTOR TO PHASE CURB RAMP CONSTRUCTION SUCH THAT ONLY ONE CURB RAMP IS UNDER CONSTRUCTION AT A TIME AT A GIVEN INTERSECTION.

22. CONTRACTOR TO PHASE CONSTRUCTION IN A MANNER ACCEPTABLE TO THE CITY. WORK ON THE NORTH AND SOUTH SIDE OF THE STREET MAY NOT OCCUR AT THE SAME TIME.

## GRADING AND GEOTECHNICAL SPECIFICATIONS

1. ALL GRADING SHALL BE DONE UNDER THE OBSERVATION AND TESTING BY A QUALIFIED CIVIL ENGINEER OR GEOTECHNICAL ENGINEER AND, IF REQUIRED, BOTH A QUALIFIED CIVIL ENGINEER OR GEOTECHNICAL ENGINEER AND AN ENGINEERING GEOLOGIST. ALL GRADING MUST BE PERFORMED IN ACCORDANCE WITH APPLICABLE CITY ORDINANCE AND THE RECOMMENDATIONS AND SPECIFICATIONS SET FORTH IN THE SOILS REPORT OR GEOLOGICAL/GEOTECHNICAL INVESTIGATION PREPARED BY KLEINFELDER WEST, INC. DATED APRIL 5, 2011 FOR CANWOOD STREET AND MAY 26, 2011 FOR AGOURA ROAD AND KANAN ROAD.

2. IF THE GEOTECHNICAL CONSULTANT OF RECORD IS CHANGED FOR THE PROJECT, THE WORK SHALL BE STOPPED UNTIL THE REPLACEMENT HAS AGREED IN WRITING TO ACCEPT THE RESPONSIBILITY WITHIN THE AREA OF THEIR TECHNICAL COMPETENCE FOR APPROVAL UPON COMPLETION OF THE WORK. IT SHALL BE THE DUTY OF THE PERMITTEE TO NOTIFY THE CITY IN WRITING OF SUCH CHANGE PRIOR TO THE RECOMMENCEMENT OF GRADING.

3. THESE PLANS HAVE BEEN REVIEWED BY THE UNDERSIGNED AND FOUND TO BE IN CONFORMANCE WITH THE RECOMMENDATIONS AND SPECIFICATIONS CONTAINED IN THE REFERENCED GEOTECHNICAL REPORT(S) PREPARED FOR THIS PROJECT.

GEOTECHNICAL ENGINEER/GEOLOGIST	REGISTRATION NO.	DATE
MICHAEL CHOI	R.C.E. 87851	DATE

## UTILITY CONTACTS

NOTE: THIS LIST IS FOR GENERAL INFORMATION PURPOSE ONLY. CONTRACTOR SHALL BE RESPONSIBLE IN CONTACTING ALL UTILITY AGENCIES AFFECTED BY THE PROJECT WHETHER SHOWN HERE OR NOT. CONTACTS AND NUMBERS SHOWN BELOW MAY NOT BE CURRENT.

### UTILITY

UTILITY	PHONE NUMBER
AT&T LONG DISTANCE (ROSEMARIE HAMILL).....	(925) 977-2413
AT&T CALIFORNIA (DIANE ENGELS).....	(818) 778-2720
SOUTHERN CALIFORNIA EDISON (CONRAD REYNADO JR).....	(805) 494-7065
DISTRIBUTION.....	(818) 700-3667
TRANSMISSION.....	(805) 681-7928
TIME WARNER CABLE (RAUL LOPEZ).....	(805) 477-4430
CHARTER CABLE .....	(310) 456-9010
SOUTHERN CA GAS COMPANY (ERIC ENG).....	(818) 701-3324
LOS ANGELES COUNTY (GEORGE AINTABLAN).....	(626) 458-7959
FLOOD CONTROL (LUIS CERVANTES).....	(626) 458-4936
SEWER MAINTENANCE DIVISION (GLORIA YOUNG).....	(626) 300-3308
STORM DRAIN MAINTENANCE DIVISION.....	(626) 458-4146
LAND DEVELOPMENT (LIZBETH CORDOVA).....	(626) 458-4921 X 3764
STRUCTURAL (PETER CHANG).....	(626) 458-7822
PROGRAM DEVELOPER (DAVID PILKER).....	(626)458-3917
TRAFFIC SIGNAL/SIGNAL MAINT. DIV.....	(626)458-1700
LAS VIRGENES MUNICIPAL WATER DISTRICT (DAVID LIPPMAN).....	(818) 251-2221
CALSENSE FIELD REPRESENTATIVE (JOE PEREZ) .....	(661) 472-0341
UNDERGROUND SERVICE ALERT.....	811



## SURVEY INFORMATION

- PREPARED BY: IACOBELLIS AND ASSOCIATES, INC., 11145 TAMPA AVENUE STE 10B, NORTHBRIDGE, CA 91326
- DATES OF SURVEY: SEPTEMBER 14, 15, 17, 21, 22, 29, 2010 AND OCTOBER 4, 2010.
- BASIS OF BEARINGS: THE BEARING NORTH 80°38'24" EAST OF THE CENTERLINE OF AGOURA ROAD AS SHOWN ON MAP OF TRACT NO. 43746, AS PER MAP FILED IN BOOK 1062 PAGE 83 TO 86 OF MAPS, WAS USED AS THE BASIS OF BEARINGS FOR THIS MAP.
- VERTICAL DATUM: COUNTY OF LOS ANGELES BENCHMARK NO. Y-11279 ELEV. = 966.028 (2008 ADJ.); DPW BM TAG IN N CB 1M(3.3') E/O BCR @ NE COR ENT TO #30501 AGOURA HILLS BUS PARK & AGOURA RD.

## ABBREVIATIONS LIST

AB	AGGREGATE BASE	PRC	POINT OF REVERSE CURVATURE
AC	ASPHALT CONCRETE	PT	POINT OF TANGENT
AP	ANGLE POINT	PVC	POLYVINYL CHLORIDE
ARHM	ASPHALT RUBBER HOT MIX	PWFB	PUBLIC WORKS FIELD BOOK
BW	BACK OF WALK	R	RADIUS/RIGHT
CATV/CTV	CABLE TV	ROW	RIGHT OF WAY
CL	CENTER LINE	RW	RECLAIMED WATER
CMP	CORRIGATED METAL PIPE	S	SOUTH
CONC	CONCRETE	SD	STORM DRAIN
DPW	DEPARTMENT OF PUBLIC WORKS	SDMH	STORM DRAIN MANHOLE
DWG	DRAWING	SPPWC	STANDARD PLANS FOR PUBLIC WORKS CONSTRUCTION
E	ELECTRIC/EAST	SS	SANITARY SEWER
EMH	ELECTRIC MANHOLE	STA	STATION
EP	EDGE OF PAVEMENT	STD	STANDARD
EX/(E)/(EX)	EXISTING	S/W	SIDEWALK
FG	FINISHED GRADE	T	TELEPHONE
FL	FLOW LINE	TC	TOP OF CURVE
FS	FINISHED SURFACE	TG	TOP OF GRATE
FW	FIRE WATER	TMH	TELEPHONE MANHOLE
G	GAS	TW	TOP OF WALL
GA	GUY ANCHOR	UNO	UNLESS NOTED OTHERWISE
GP	GUY POLE	UTB	UTILITY BOX
GP	GUARD POST	UTV	UTILITY VAULT/VALVE
GV	GAS VALVE	W	WEST
HMA	HOT MIXED ASPHALT	W/W	WATER
ID	IDENTIFICATION	WV	WATER VALVE
L	LENGTH/LEFT		
LACO	LOS ANGELES COUNTY		
MAX	MAXIMUM		
MBGR	METAL BEAM GUARDRAIL		
MH	MANHOLE		
MIN	MINIMUM		
N	NORTH		
NO	NUMBER		
NTS	NOT TO SCALE		
OG	ON GRADE		
OHE	OVERHEAD ELECTRICAL		
PC	POINT OF CURVE		
PCC	PORTLAND CEMENT CONCRETE		
PI	POINT OF TANGENT INTERSECTIONS		
PL	PROPERTY LINE		
PP	POWER POLE		
PR	PROPOSED		

## LEGEND

—W—	W	—W—	EX. WATER SUPPLY
—FW—	FW	—FW—	EX. FIRE WATER LINE
—RW—	RW	—RW—	EX. RECLAIMED WATER LINE
—G—	G	—G—	EX. GAS LINE
—SD—	SD	—SD—	EX. STORM DRAIN
—SS—	SS	—SS—	EX. SANITARY SEWER LINE
—E—	E	—E—	EX. ELECTRICAL CONDUIT
—T—	T	—T—	EX. TELECOMMUNICATIONS LINE
—ECTV—			EX. CAT 5 TELECOMMUNICATIONS LINE
— — — —		— — — —	EX. OVERHEAD ELECTRIC LINE
—OHE—		—OHE—	PROPOSED OVERHEAD ELECTRIC LINE
—FW—		—FW—	PROPOSED FIRE WATER LINE
— — — —		— — — —	CENTERLINE
— — — —		— — — —	EXISTING RIGHT OF WAY
— — — —		— — — —	EXISTING CURB
— — — —		— — — —	PROPOSED CURB
— — — —		— — — —	PROPOSED GUTTER
— — — —		— — — —	EDGE OF PAVEMENT
— — — —		— — — —	PROPOSED RIGHT OF WAY

1		50%PS&E		9/9/11
2		75%PS&E		2/28/12
3		90%PS&E		6/8/12
4		100%PS&E		10/5/12
REV	SYMBOL	DESCRIPTION OF CHANGE	RCE	DATE

PREPARED BY:

**Kimley-Horn  
and Associates, Inc.**

© 2012 KIMLEY-HORN AND ASSOCIATES, INC.  
6800 Owensmouth Avenue, Suite 410, Los Angeles CA  
Tel (818) 227-2790 Fax (916) 608-0885

MICHAEL CHOI R.C.E. 87851 DATE



REVIEWED BY:

CHARMAINE YAMBABO DATE  
ASSOCIATE CIVIL ENGINEER

APPROVED BY:

RAMIRO ADEVA DATE  
DIRECTOR OF PUBLIC WORKS/CITY ENGINEER



AGOURA ROAD WIDENING  
GENERAL NOTES G-1

DRAWN BY: RC CHECKED BY: JS/MC KHA JOB NUMBER 099083017

SHEET 2 OF 101

## STORMWATER POLLUTION NOTES

- EVERY EFFORT SHOULD BE MADE TO ELIMINATE THE DISCHARGE OF NON-STORMWATER FROM THE PROJECT SITE AT ALL TIMES.
- ERODED SEDIMENTS AND OTHER POLLUTANTS MUST BE RETAINED ON-SITE AND MAY NOT BE TRANSPORTED FROM THE SITE VIA SHEET FLOW, SWALES, AREA DRAINS, NATURAL DRAINAGE COURSES OR WIND.
- STOCKPILES OF EARTH AND OTHER CONSTRUCTION RELATED MATERIALS MUST BE PROTECTED FROM BEING TRANSPORTED FROM THE SITE BY THE FORCES OF WIND OR WATER.
- FUELS, OILS, SOLVENTS, AND OTHER TOXIC MATERIAL MUST BE STORED IN ACCORDANCE WITH THEIR LISTING AND ARE NOT TO CONTAMINATE THE SOIL AND SURFACE WATERS. ALL APPROVED STORAGE CONTAINERS ARE TO BE PROTECTED FROM THE WEATHER. SPILLS MUST BE CLEANED UP IMMEDIATELY AND DISPOSED OF IN A PROPER MANNER. SPILLS MAY NOT BE WASHED INTO THE DRAINAGE SYSTEM.
- EXCESS OR WASTE CONCRETE MAY NOT BE WASHED INTO THE PUBLIC WAY OR ANY OTHER DRAINAGE SYSTEM. PROVISIONS SHALL BE MADE TO RETAIN CONCRETE WASTES ON-SITE UNTIL THEY CAN BE DISPOSED OF AS SOLID WASTE.
- TRASH AND CONSTRUCTION RELATED SOLID WASTES MUST BE DEPOSITED INTO A COVERED RECEPTACLE TO PREVENT CONTAMINATION OF RAINWATER AND DISPERSAL BY WIND.
- SEDIMENTS AND OTHER MATERIALS MAY NOT BE TRACKED FROM THE SITE BY VEHICLE TRAFFIC. THE CONSTRUCTION ENTRANCE ROADWAYS MUST BE STABILIZED SO AS TO INHIBIT SEDIMENTS FROM BEING DEPOSITED INTO THE PUBLIC WAY. ACCIDENTAL DEPOSITIONS MUST BE SWEEPED UP IMMEDIATELY AND MAY NOT BE WASHED DOWN BY RAIN OR OTHER MEANS.
- ANY SLOPES WITH DISTURBED SOILS OR DENUDED OF VEGETATION MUST BE STABILIZED SO AS TO INHIBIT EROSION BY WIND AND WATER.

THE FOLLOWING BMP'S AS OUTLINED IN, BUT NOT LIMITED TO, THE CALIFORNIA STORMWATER BEST MANAGEMENT PRACTICES HANDBOOK, JULY 2010, OR THE LATEST REVISED EDITION, MAY APPLY DURING THE CONSTRUCTION OF THIS PROJECT (ADDITIONAL MEASURES MAY BE REQUIRED IF DEEMED APPROPRIATE BY THE PROJECT ENGINEER OR THE BUILDING OFFICIAL):

### EROSION CONTROL

EC-1	SCHEDULING
EC-2	PRESERVATION OF EXISTING VEGETATION
EC-3	HYDRAULIC MULCH
EC-4	HYDROSEEDING
EC-5	SOIL BINDERS
EC-6	STRAW MULCH
EC-7	GEOTEXTILES AND MATS
EC-8	WOOD MULCHING
EC-9	EARTH DIKES & DRAINAGE SWALES
EC-10	VELOCITY DISSIPATION DEVICES
EC-11	SLOPE DRAINS
EC-12	STREAMBANK STABILIZATION
EC-13	RESERVED
EC-14	COMPOST BLANKETS
EC-15	SOIL PREPARATION/ROUGHENING
EC-16	NON-VEGETATED STABILIZATION

### TEMPORARY SEDIMENT CONTROL

SE-1	SILT FENCE
SE-2	SEDIMENT BASIN
SE-3	SEDIMENT TRAP
SE-4	CHECK DAM
SE-5	FIBER ROLLS
SE-6	GRAVEL BAG BERM
SE-7	STREET SWEEPING & VACUUMING
SE-8	SANDBAG BARRIER
SE-9	STRAW BALE BARRIER
SE-10	STORM DRAIN INLET PROTECTION
SE-11	ACTIVE TREATMENT SYSTEMS
SE-12	TEMPORARY SILT DIKE
SE-13	COMPOST SOCKS & BERMS
SE-14	BIOFILTER BAGS

### WIND EROSION CONTROL

WE-1	WIND EROSION CONTROL
------	----------------------

### EQUIPMENT TRACKING CONTROL

TC-1	STABILIZED CONSTRUCTION ENTRANCE/EXIT
TC-2	STABILIZED CONSTRUCTION ROADWAY
TC-3	ENTRANCE/OUTLET TIRE WASH

### EQUIPMENT TRACKING CONTROL

TC-1	STABILIZED CONSTRUCTION ENTRANCE EXIT
TC-2	STABILIZED CONSTRUCTION ROADWAY
TC-3	ENTRANCE/OUTLET TIRE WASH

### NON-STORMWATER MANAGEMENT

NS-1	WATER CONSERVATION PRACTICES
NS-2	DEWATERING OPERATIONS
NS-3	PAVING AND GRINDING OPERATION
NS-4	TEMPORARY STREAM CROSSING
NS-5	CLEAR WATER DIVERSION
NS-6	ILLDIT CONNECTION/DISCHARGE
NS-7	PORTABLE WATER/IRRIGATION
NS-8	VEHICLE AND EQUIPMENT CLEANING
NS-9	VEHICLE AND EQUIPMENT FUELING
NS-10	VEHICLE AND EQUIPMENT MAINTENANCE
NS-11	PILE DRAWING OPERATION
NS-12	CONCRETE CURING
NS-13	CONCRETE FINISHING
NS-14	MATERIAL AND EQUIPMENT USE
NS-15	DEMOLITION ADJACENT TO WATER
NS-16	TEMPORARY BATCH PLANTS

### WASTE MANAGEMENT & MATERIAL POLLUTION CONTROL

WM-1	MATERIAL DELIVERY AND STORAGE
WM-2	MATERIAL USE
WM-3	STOCKPILE MANAGEMENT
WM-4	SPILL PREVENTION AND CONTROL
WM-5	SOLID WASTE MANAGEMENT
WM-6	HAZARDOUS WASTE MANAGEMENT
WM-7	CONTAMINATION SOIL MANAGEMENT
WM-8	CONCRETE WASTE MANAGEMENT
WM-9	SANITARY/SEPTIC WASTE MANAGEMENT
WM-10	LIQUID WASTE MANAGEMENT

1		50%PS&E		9/9/11
2		75%PS&E		2/28/12
3		90%PS&E		6/8/12
4		100%PS&E		10/5/12
REV	SYMBOL	DESCRIPTION OF CHANGE	RCE	DATE

PREPARED BY:



© 2012 KIMLEY-HORN AND ASSOCIATES, INC.  
6800 Owensmouth Avenue, Suite 410, Los Angeles CA  
Tel (818) 227-2790 Fax (916) 608-0885

MICHAEL CHOI R.C.E. 67851 DATE

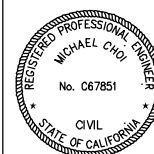

REVIEWED BY:

CHARMAINE YAMBABO DATE  
ASSOCIATE CIVIL ENGINEER

APPROVED BY:

RAMIRO ADEVA DATE  
DIRECTOR OF PUBLIC WORKS/CITY ENGINEER



AGOURA ROAD WIDENING  
GENERAL NOTES G-2

DRAWN BY: RC CHECKED BY: JS/MC KHA JOB NUMBER: 099083017

SHEET 3 OF 101

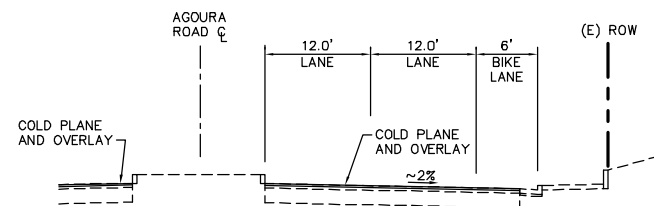

**PAVEMENT SECTION:**

**A**  
 0.13' ARHM  
 0.5' HMA (TYPE A)  
 1.5' CLASS 2 AB  
 2.0' COMPACTED ENGINEERED FILL

**B**  
 0.13' ARHM  
 0.5' HMA (TYPE A)  
 1.7' CLASS 2 AB  
 2.0' COMPACTED ENGINEERED FILL

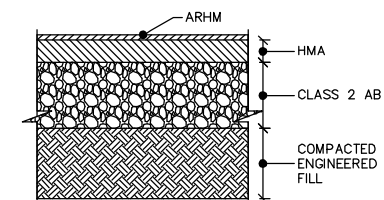

**TYPICAL PAVEMENT SECTION**  
NTS

**NOTES:**

- DESIGN DESIGNATION:  
 TI = 9.0 (TYPICAL) - PAVEMENT SECTION 'A' AT EACH LEG  
 TI = 9.5 AT INTERSECTIONS, 300 FEET REACH MEASURED FROM ECR (SEE STREET PLANS) - PAVEMENT SECTION 'B'.
- DIMENSIONS OF STRUCTURAL SECTIONS ARE SUBJECT TO TOLERANCES SPECIFIED IN THE SPECIFICATIONS.
- SUBGRADE SLOPE TO BE THE SAME AS THE TYPICAL SURFACE SLOPE UNLESS OTHERWISE SHOWN OR NOTED.
- STRUCTURAL SECTIONS TO BE UNDERLAIN BY A NEWLY PLACED ENGINEERED FILL PER GEOTECHNICAL REPORT PREPARED BY KLIENFELDER DATED MAY 25, 2012.

**TYPICAL SECTION - AGOURA ROAD**  
STA. 9+64.94 TO STA. 11+63.48

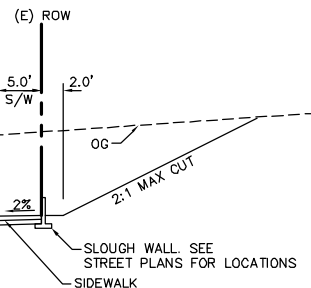
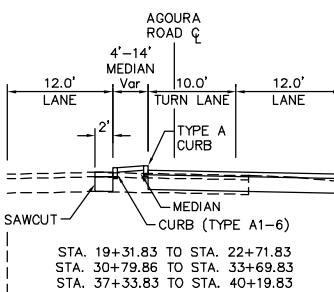

STA. 19+31.83 TO STA. 22+71.83  
 STA. 30+79.86 TO STA. 33+69.83  
 STA. 37+33.83 TO STA. 40+19.83

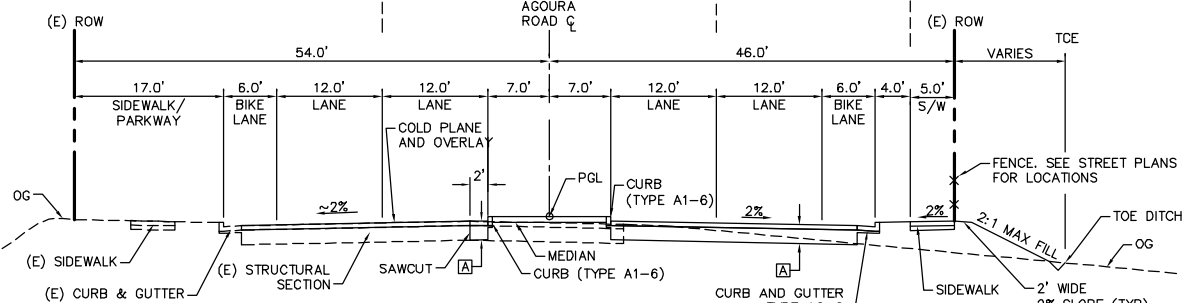

**TYPICAL SECTION - AGOURA ROAD**  
STA. 11+63.48 TO STA. 32+30.89

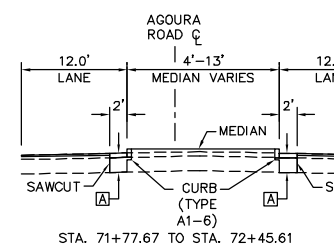

**TYPICAL SECTION - AGOURA ROAD**  
STA. 69+44.05 TO STA. 72+54.74

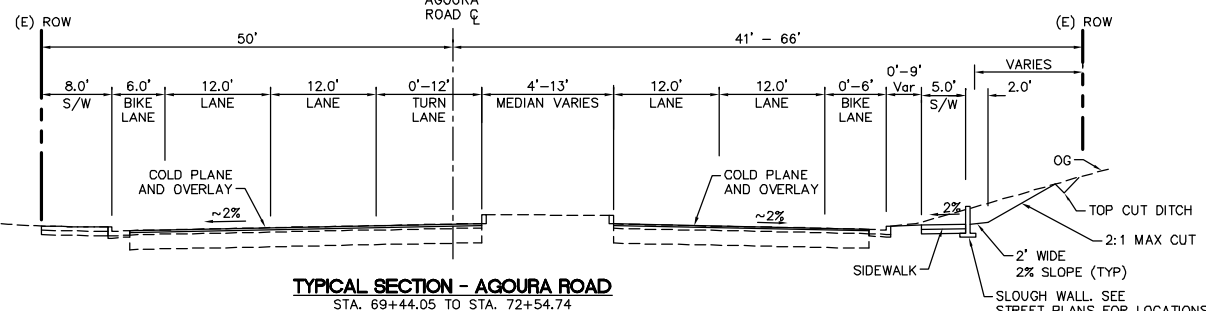

**TYPICAL SECTION - AGOURA ROAD**  
STA. 73+10.22 TO STA. 74+78.83

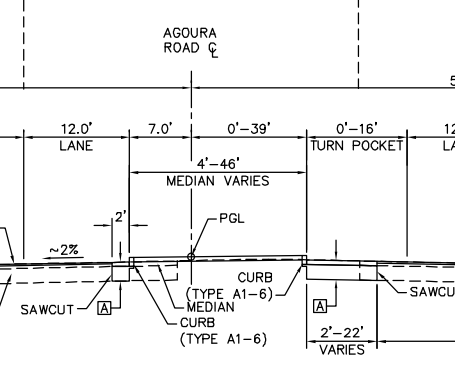

**TYPICAL SECTION - AGOURA ROAD**  
STA. 72+54.74 TO STA. 78+22.66

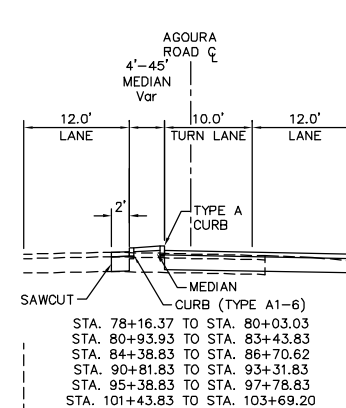

**TYPICAL SECTION - AGOURA ROAD**  
STA. 78+22.66 TO STA. 103+73.43

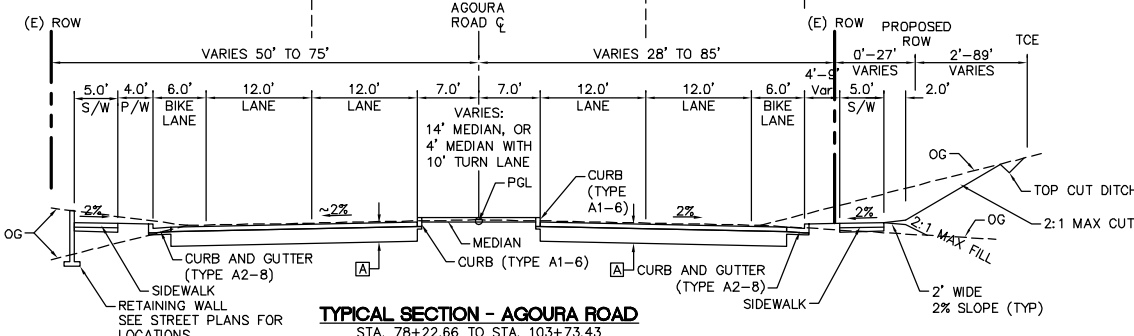

1		50% PS&E		9/9/11
2		75% PS&E		2/28/12
3		90% PS&E		6/8/12
REV	SYMBOL	DESCRIPTION OF CHANGE	RCE	DATE

PREPARED BY:

© 2012 KIMLEY-HORN AND ASSOCIATES, INC.  
 6800 Owensmouth Avenue, Suite 410, Los Angeles CA  
 Tel (818) 227-2790 Fax (916) 608-0885

MICHAEL CHOI R.C.E. 67851 DATE

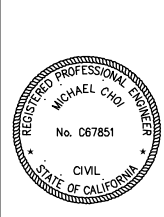

REVIEWED BY:

CHARMAINE YAMBAO DATE  
 ASSOCIATE CIVIL ENGINEER

APPROVED BY:

RAMIRO ADEVA DATE  
 DIRECTOR OF PUBLIC WORKS/CITY ENGINEER



AGOURA ROAD WIDENING  
 TYPICAL SECTIONS X-1

DRAWN BY: CE/RC  
 CHECKED BY: JS/MC/SC  
 KHA JOB NUMBER: 099083017

SHEET 4 OF 101

100% SUBMITTAL - OCTOBER 2012

**PAVEMENT SECTION:**

A	0.13'	ARHM	
	0.5'	HMA (TYPE A)	
	1.5'	CLASS 2 AB	
2.0'			COMPACTED ENGINEERED FILL
B	0.13'	ARHM	
	0.5'	HMA (TYPE A)	
	1.7'	CLASS 2 AB	
	2.0'	COMPACTED ENGINEERED FILL	

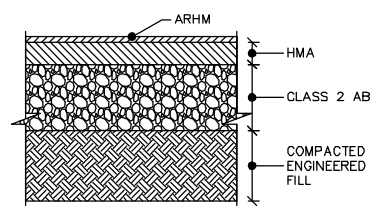

NOTE: SEE PAVEMENT SECTION FOR DIMENSIONS.  
**TYPICAL PAVEMENT SECTION**  
NTS

- NOTES:**
- DESIGN DESIGNATION:  
T1 = 9.0 (TYPICAL) - PAVEMENT SECTION 'A'  
T1 = 9.5 AT INTERSECTIONS, 300 FEET REACH AT EACH LEG MEASURED FROM ECR (SEE STREET PLANS) - PAVEMENT SECTION 'B'.
  - DIMENSIONS OF STRUCTURAL SECTIONS ARE SUBJECT TO TOLERANCES SPECIFIED IN THE SPECIFICATIONS.
  - SUBGRADE SLOPE TO BE THE SAME AS THE TYPICAL SURFACE SLOPE UNLESS OTHERWISE SHOWN OR NOTED.
  - STRUCTURAL SECTIONS TO BE UNDERLAIN BY A NEWLY PLACED ENGINEERED FILL PER GEOTECHNICAL REPORT PREPARED BY KLIENFELDER DATED MAY 25, 2012.

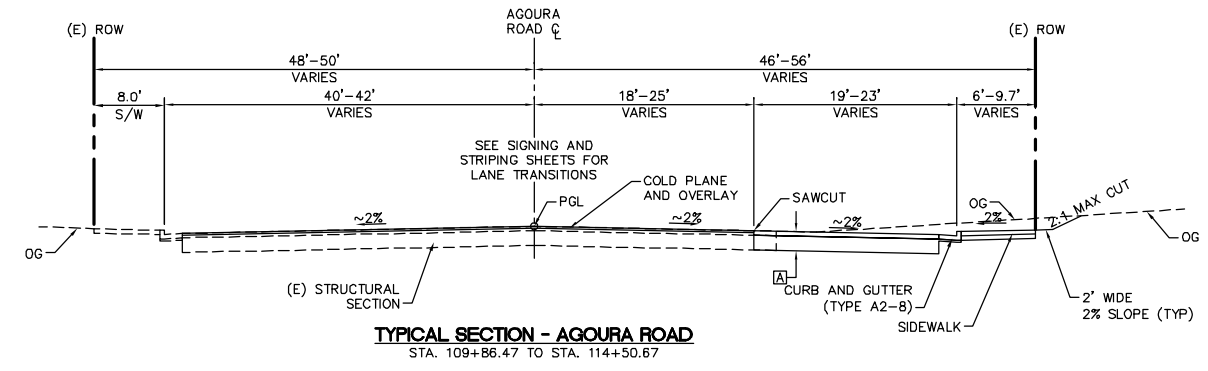
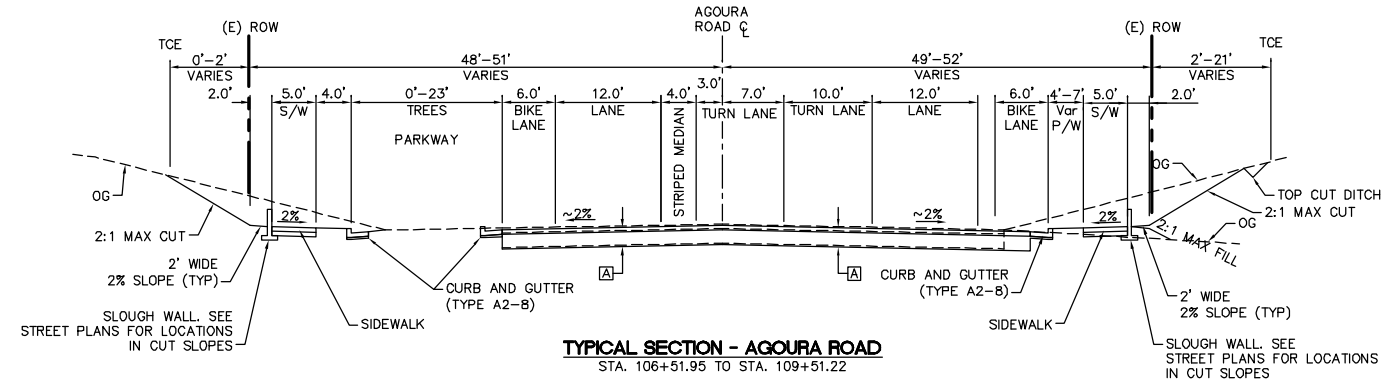
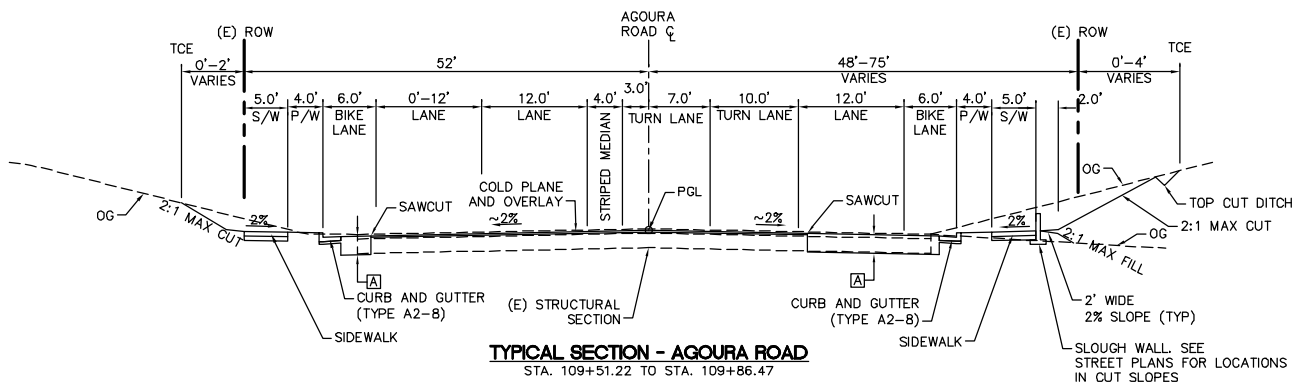
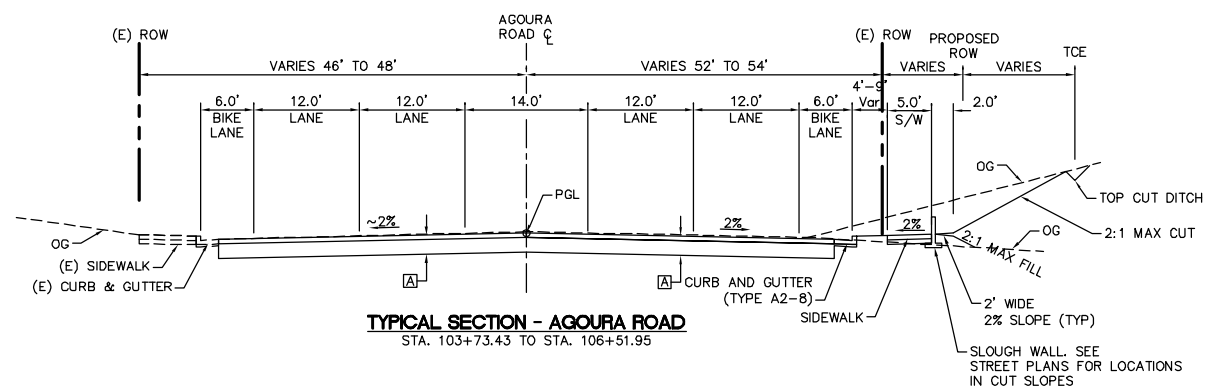

1		50% PS&E		9/9/11
2		75% PS&E		2/28/12
3		90% PS&E		6/8/12
REV	SYMBOL	DESCRIPTION OF CHANGE	RCE	DATE

PREPARED BY:

© 2012 KIMLEY-HORN AND ASSOCIATES, INC.  
6800 Owensmouth Avenue, Suite 410, Los Angeles CA  
Tel (818) 227-2790 Fax (916) 608-0885

MICHAEL CHOI R.C.E. 67851 DATE

REVIEWED BY:

CHARMAINE YAMBABO DATE  
ASSOCIATE CIVIL ENGINEER

APPROVED BY:

RAMIRO ADEVA DATE  
DIRECTOR OF PUBLIC WORKS/CITY ENGINEER

AGOURA ROAD WIDENING  
TYPICAL SECTIONS X-2

DRAWN BY: CE/RC  
CHECKED BY: JS/MC/SC  
KHA JOB NUMBER: 099083017

SHEET 5 OF 101

100% SUBMITTAL - OCTOBER 2012

**PAVEMENT SECTION:**

- 0.13' ARHM
- 0.5' HMA (TYPE A)
- 1.5' CLASS 2 AB
- 2.0' COMPACTED ENGINEERED FILL

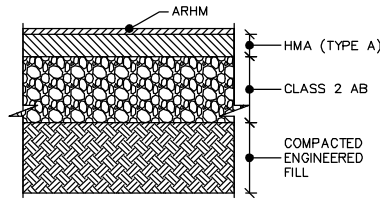

NOTE: SEE PAVEMENT SECTION FOR DIMENSIONS.

**TYPICAL PAVEMENT SECTION**  
NTS

**NOTES:**

1. DESIGN DESIGNATION:  
T1 = 9.0 (TYPICAL) - PAVEMENT SECTION 'A'  
T1 = 9.5 AT INTERSECTIONS, 300 FEET REACH AT EACH LEG  
MEASURED FROM ECR (SEE STREET PLANS) - PAVEMENT SECTION 'B'.
2. DIMENSIONS OF STRUCTURAL SECTIONS ARE SUBJECT TO TOLERANCES SPECIFIED IN THE SPECIFICATIONS.
3. SUBGRADE SLOPE TO BE THE SAME AS THE TYPICAL SURFACE SLOPE UNLESS OTHERWISE SHOWN OR NOTED.
4. STRUCTURAL SECTIONS TO BE UNDERLAIN BY A NEWLY PLACED ENGINEERED FILL PER GEOTECHNICAL REPORT PREPARED BY KLIENFELDER DATED MAY 25, 2012.

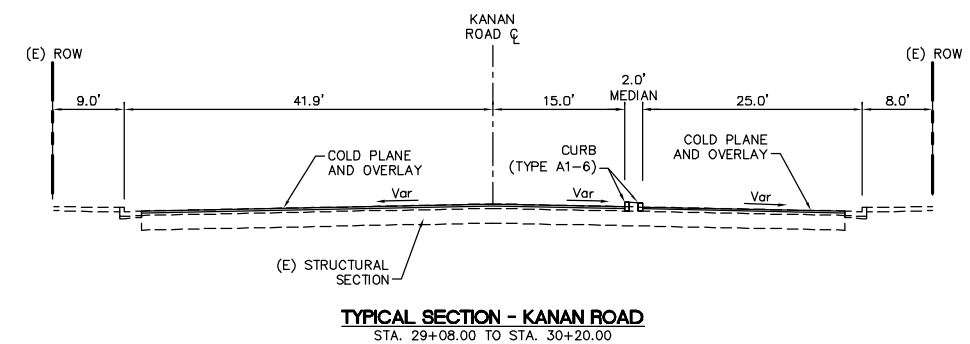
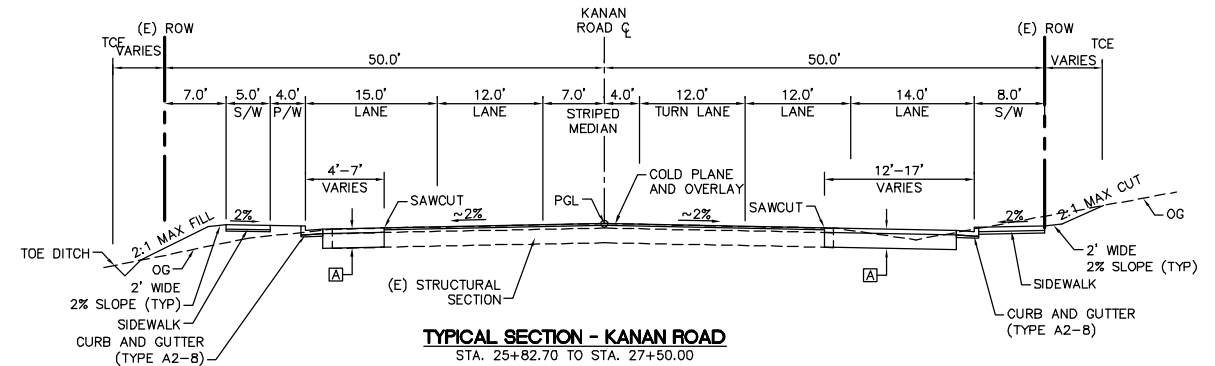
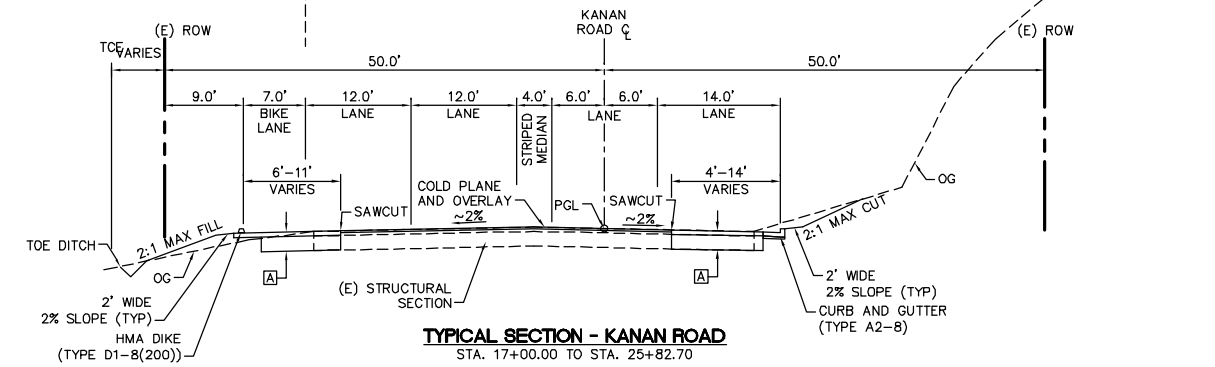
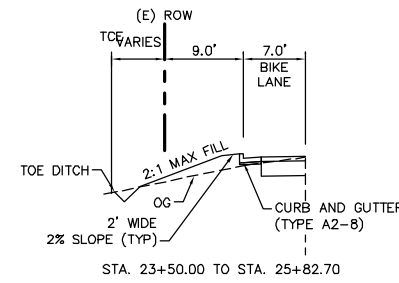
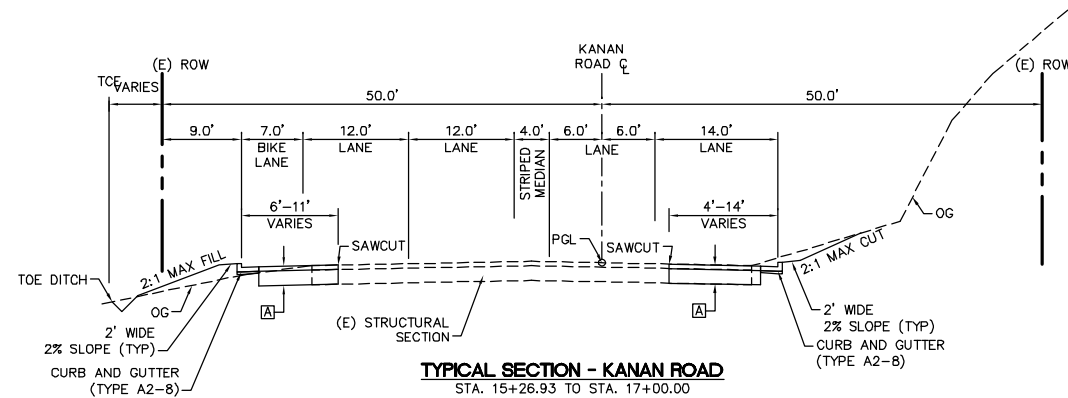
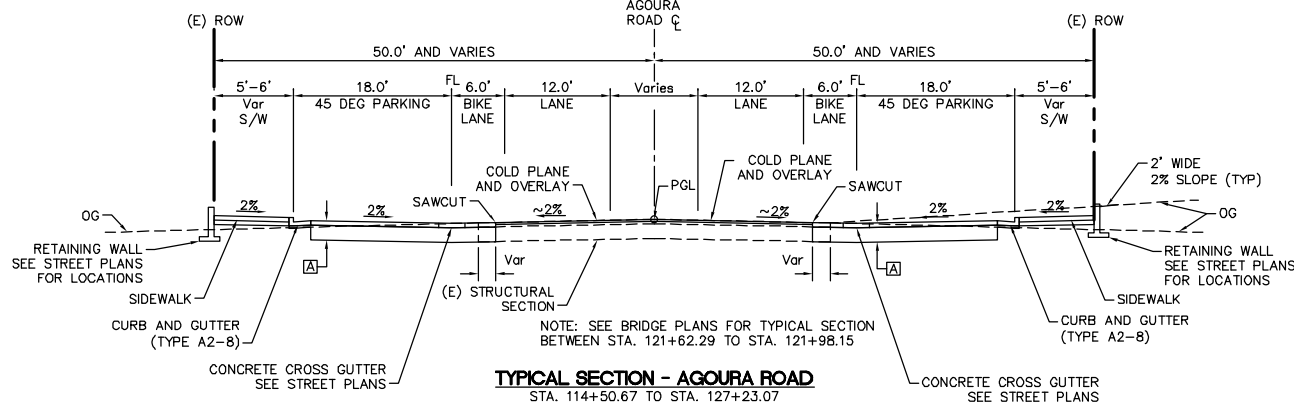
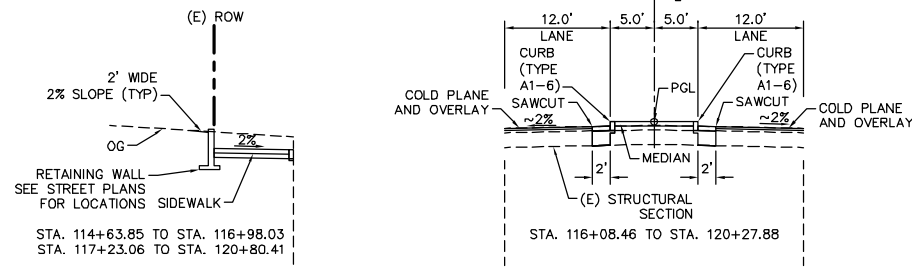

1		50% PS&E		9/9/11
2		75% PS&E		2/28/12
3		90% PS&E		6/8/12
REV	SYMBOL	DESCRIPTION OF CHANGE	RCE	DATE

PREPARED BY:

**Kimley-Horn and Associates, Inc.**  
© 2012 KIMLEY-HORN AND ASSOCIATES, INC.  
6800 Owensmouth Avenue, Suite 410, Los Angeles CA  
Tel (818) 227-2790 Fax (916) 608-0885



MICHAEL CHOI R.C.E. 67851 DATE

REVIEWED BY:

CHARMAINE YAMBABO DATE  
ASSOCIATE CIVIL ENGINEER

APPROVED BY:

RAMIRO ADEVA DATE  
DIRECTOR OF PUBLIC WORKS/CITY ENGINEER



**AGOURA ROAD WIDENING  
TYPICAL SECTIONS X-3**

DRAWN BY:  
CE/RC

CHECKED BY:  
JS/MC/SC

KHA JOB NUMBER  
099083017

SHEET 6 OF 101

100% SUBMITTAL - OCTOBER 2012

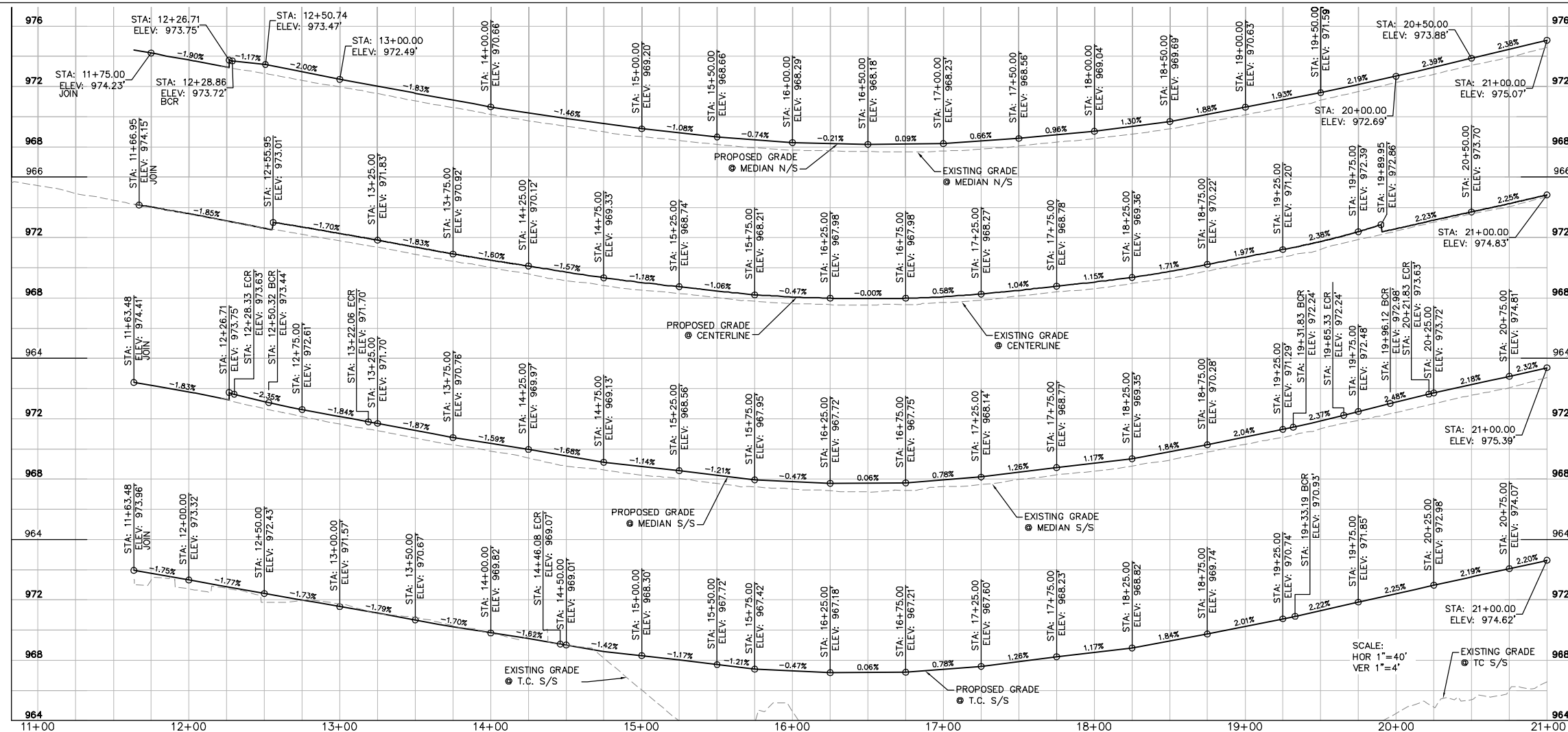

- LEGEND:**
- COLD PLANE AND OVERLAY AREA
  - HMA PAVEMENT
  - STAMPED CONCRETE DRIVEWAY
  - PROPOSED RIGHT OF WAY
  - (E) RIGHT OF WAY
  - ALIGNMENT CENTERLINE
  - SAWCUT LINE
  - GRADING LIMIT
  - TOP CUT DITCH / TOE FILL DITCH
  - SLOUGH WALL
  - CENTER LINE CURVE NUMBER
  - CURVE NUMBER
- NOTES:**
1. STATION AND OFFSET CALLOUTS ARE TO TOP FACE OF CURB UNLESS OTHERWISE NOTED.
  2. FOR ADDITIONAL GRADING AND LAYOUT INFORMATION SEE CONSTRUCTION DETAIL SHEETS.
  3. EXISTING RIGHT OF WAY TO BE VERIFIED BY THE CONTRACTOR PRIOR TO START OF WORK.
  4. SEE UTILITY PLANS FOR UTILITY RELOCATIONS AND ADJUSTMENTS.
  5. SEE SIGNING AND STRIPING PLANS FOR LANE MARKINGS AND TRAFFIC SIGNS.
  6. SEE STORM DRAIN PLANS FOR STORM DRAIN AND DEBRIS BASIN WORK.
  7. SEE TREE REMOVAL PLANS FOR TREES TO BE REMOVED.
- CONSTRUCTION NOTES:**
- 1 CATCH BASIN (SEE STORM DRAIN PLANS)
  - 2 COLDPLANE TO MIN. 1.5" DEPTH. WIDTH PER PLAN. CONSTRUCT OVERLAY ASPHALT PAVEMENT
  - 3 CONSTRUCT PCC SIDEWALK (SEE CONSTRUCTION DETAILS)
  - 4 CONSTRUCT CURB AND GUTTER, TYPE A2-8, PER APWA STD. PLAN 120-2
  - 5 CONSTRUCT CURB RAMP, CASE A-TYPE 1, PER APWA STD. PLAN 111-4
  - 6 CONSTRUCT CURB RAMP, CASE B-TYPE 1, PER APWA STD. PLAN 111-4
  - 7 CONSTRUCT CURB RAMP, CASE D-TYPE 1, PER APWA STD. PLAN 111-4
  - 8 CONSTRUCT CURB, TYPE A1-6, PER APWA STD. PLAN 120-2
  - 9 CONSTRUCT DRIVEWAY APPROACH, TYPE B, PER APWA STD. PLAN 110-2
  - 10 CONSTRUCT PCC CROSS GUTTER (SEE CONSTRUCTION DETAILS)
  - 11 EXTEND CULVERT (SEE STORM DRAIN PLANS)
  - 12 JOIN EXISTING
  - 13 LANDSCAPING PER LANDSCAPE PLANS
  - 14 MODIFY DRAINAGE BASIN (SEE STORM DRAIN PLANS)
  - 15 RELOCATE EXISTING DRIVEWAY (SEE CONSTRUCTION DETAILS)
  - 16 RELOCATE EXISTING MONUMENT
  - 17 REMOVE EXISTING PAVEMENT, SIDEWALK, CURB, GUTTER OR MEDIAN AS REQUIRED
  - 18 SAWCUT
  - 19 PROTECT EXISTING OAK TREE IN PLACE (SEE TREE REMOVAL PLANS FOR MORE INFORMATION)
  - 20 REMOVE AND REPLACE EXISTING FENCE AS REQUIRED
  - 21 CONSTRUCT TOP CUT DITCH (SEE CONSTRUCTION DETAILS)
  - 22 CONSTRUCT SLOUGH WALL. (SEE DETAIL 6 ON CD-10 ON SHEET 30)
  - 23 REMOVE/RELOCATE EXISTING MBGR
  - 24 RETAINING WALL (SEE RETAINING WALL PLANS)
  - 25 CONSTRUCT TOE FILL DITCH (SEE CONSTRUCTION DETAILS SHEET 30)
  - 26 CONSTRUCT AC DIKE, TYPE D1-8, PER APWA STD. PLAN 120-2
  - 27 REMOVE EXISTING AC BERM/CURB.
  - 28 REMOVE EXISTING CMP AND INLET.
  - 29 INSTALL TRUNCATED DOME PER APWA STD. PLAN 111-3. COORDINATE WORK WITH CITY INSPECTOR.
  - 30 CONSTRUCT PARKWAY DRAIN PER APWA STD. PLAN 151-1, S=2
  - 31 CONSTRUCT URBAN BIOGREEN FILTER PER DETAIL ON SHEET 27.
  - 32 CONSTRUCT SPLASH WALL PER DETAIL ON SHEET 28.

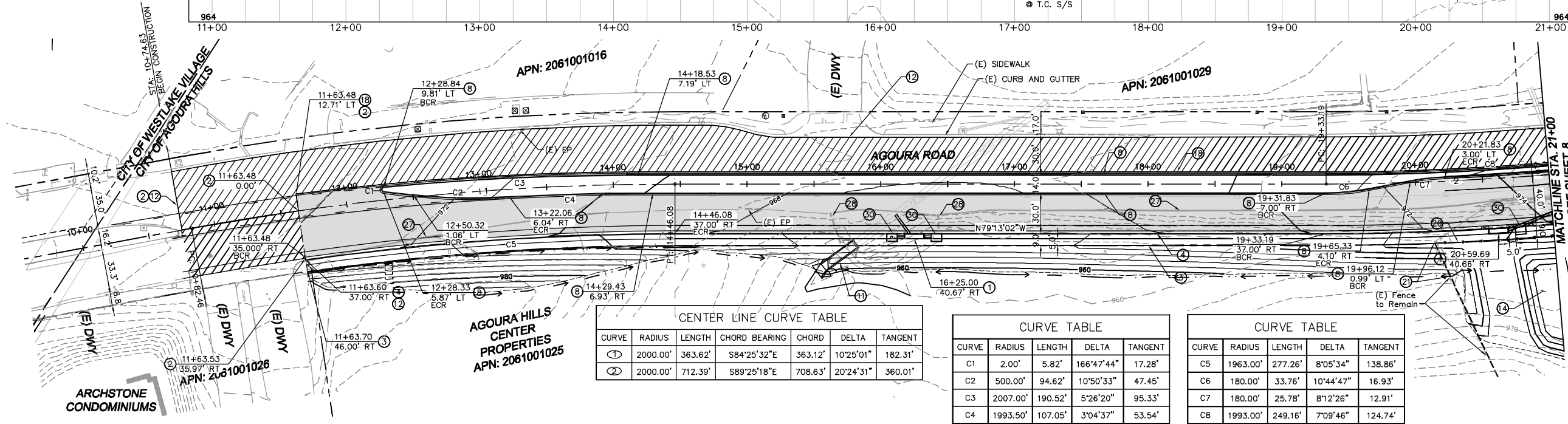

**CENTER LINE CURVE TABLE**

CURVE	RADIUS	LENGTH	CHORD BEARING	CHORD	DELTA	TANGENT
1	2000.00'	363.62'	S84°25'32"E	363.12'	10°25'01"	182.31'
2	2000.00'	712.39'	S89°25'18"E	708.63'	20°24'31"	360.01'

**CURVE TABLE**

CURVE	RADIUS	LENGTH	DELTA	TANGENT
C1	2.00'	5.82'	166°47'44"	17.28'
C2	500.00'	94.62'	10°50'33"	47.45'
C3	2007.00'	190.52'	5°26'20"	95.33'
C4	1993.50'	107.05'	3°04'37"	53.54'

**CURVE TABLE**

CURVE	RADIUS	LENGTH	DELTA	TANGENT
C5	1963.00'	277.26'	8°05'34"	138.86'
C6	180.00'	33.76'	10°44'47"	16.93'
C7	180.00'	25.78'	8°12'26"	12.91'
C8	1993.00'	249.16'	7°09'46"	124.74'

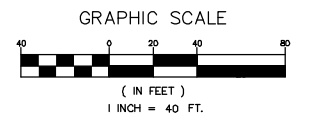

1		50%PS&E		9/9/11
2		75%PS&E		2/28/12
3		90%PS&E		6/8/12
4		100%PS&E		10/5/12
REV	SYMBOL	DESCRIPTION OF CHANGE	RCE	DATE

PREPARED BY:

**Kimley-Horn and Associates, Inc.**  
 © 2012 KIMLEY-HORN AND ASSOCIATES, INC.  
 6800 Owensmouth Avenue, Suite 410, Los Angeles CA  
 Tel (818) 227-2790 Fax (916) 608-0885

MICHAEL CHOI R.C.E. 67851 DATE

REVIEWED BY:

CHARMAINE YAMBAO DATE  
 ASSOCIATE CIVIL ENGINEER

APPROVED BY:

RAMIRO ADEVA DATE  
 DIRECTOR OF PUBLIC WORKS/CITY ENGINEER

**CITY OF**

**AGOURA HILLS**

**AGOURA ROAD WIDENING**  
**STREET PLANS L-1**

DRAWN BY: RC  
 CHECKED BY: JS/MC  
 KHA JOB NUMBER: 099083017  
 SHEET 7 OF 101

100% SUBMITTAL - OCTOBER 2012



- LEGEND:**
- COLD PLANE AND OVERLAY AREA
  - HMA PAVEMENT
  - STAMPED CONCRETE DRIVEWAY
  - PROPOSED RIGHT OF WAY
  - (E) RIGHT OF WAY
  - ALIGNMENT CENTERLINE
  - SAWCUT LINE
  - GRADING LIMIT
  - TOP CUT DITCH / TOE FILL DITCH
  - SLOUGH WALL
  - CENTER LINE CURVE NUMBER
  - CURVE NUMBER
- NOTES:**
1. STATION AND OFFSET CALLOUTS ARE TO TOP FACE OF CURB UNLESS OTHERWISE NOTED.
  2. FOR ADDITIONAL GRADING AND LAYOUT INFORMATION SEE CONSTRUCTION DETAIL SHEETS.
  3. EXISTING RIGHT OF WAY TO BE VERIFIED BY THE CONTRACTOR PRIOR TO START OF WORK.
  4. SEE UTILITY PLANS FOR UTILITY RELOCATIONS AND ADJUSTMENTS.
  5. SEE SIGNING AND STRIPING PLANS FOR LANE MARKINGS AND TRAFFIC SIGNS.
  6. SEE STORM DRAIN PLANS FOR STORM DRAIN AND DEBRIS BASIN WORK.
  7. SEE TREE REMOVAL PLANS FOR TREES TO BE REMOVED.
- CONSTRUCTION NOTES**
- 1 CATCH BASIN (SEE STORM DRAIN PLANS)
  - 2 COLDPLANE TO MIN. 1.5" DEPTH, WIDTH PER PLAN. CONSTRUCT OVERLAY ASPHALT PAVEMENT
  - 3 CONSTRUCT PCC SIDEWALK (SEE CONSTRUCTION DETAILS)
  - 4 CONSTRUCT CURB AND GUTTER, TYPE A2-8, PER APWA STD. PLAN 120-2
  - 5 CONSTRUCT CURB RAMP, CASE A-TYPE 1, PER APWA STD. PLAN 111-4
  - 6 CONSTRUCT CURB RAMP, CASE B-TYPE 1, PER APWA STD. PLAN 111-4
  - 7 CONSTRUCT CURB RAMP, CASE D-TYPE 1, PER APWA STD. PLAN 111-4
  - 8 CONSTRUCT CURB, TYPE A1-6, PER APWA STD. PLAN 120-2
  - 9 CONSTRUCT DRIVEWAY APPROACH, TYPE B, PER APWA STD. PLAN 110-2
  - 10 CONSTRUCT PCC CROSS GUTTER (SEE CONSTRUCTION DETAILS)
  - 11 EXTEND CULVERT (SEE STORM DRAIN PLANS)
  - 12 JOIN EXISTING
  - 13 LANDSCAPING PER LANDSCAPE PLANS
  - 14 MODIFY DRAINAGE BASIN (SEE STORM DRAIN PLANS)
  - 15 RELOCATE EXISTING DRIVEWAY (SEE CONSTRUCTION DETAILS)
  - 16 RELOCATE EXISTING MONUMENT
  - 17 REMOVE EXISTING PAVEMENT, SIDEWALK, CURB, GUTTER OR MEDIAN AS REQUIRED
  - 18 SAWCUT
  - 19 PROTECT EXISTING OAK TREE IN PLACE (SEE TREE REMOVAL PLANS FOR MORE INFORMATION)
  - 20 REMOVE AND REPLACE EXISTING FENCE AS REQUIRED
  - 21 CONSTRUCT TOP CUT DITCH (SEE CONSTRUCTION DETAILS)
  - 22 CONSTRUCT SLOUGH WALL. (SEE DETAIL 6 ON CD-10 ON SHEET 30)
  - 23 REMOVE/RLOCATE EXISTING MBGR
  - 24 RETAINING WALL (SEE RETAINING WALL PLANS)
  - 25 CONSTRUCT TOE FILL DITCH (SEE CONSTRUCTION DETAILS SHEET 30)
  - 26 CONSTRUCT AC DIKE, TYPE D1-8, PER APWA STD. PLAN 120-2
  - 27 REMOVE EXISTING AC BERM/CURB.
  - 28 REMOVE EXISTING CMP AND INLET.
  - 29 INSTALL TRUNCATED DOME PER APWA STD. PLAN 111-3. COORDINATE WORK WITH CITY INSPECTOR.
  - 30 CONSTRUCT PARKWAY DRAIN PER APWA STD. PLAN 151-1, S=2'
  - 31 CONSTRUCT URBAN BIOGREEN FILTER PER DETAIL ON SHEET 27.
  - 32 CONSTRUCT SPLASH WALL PER DETAIL ON SHEET 28.

SCALE:  
HOR 1"=40'  
VER 1"=4'

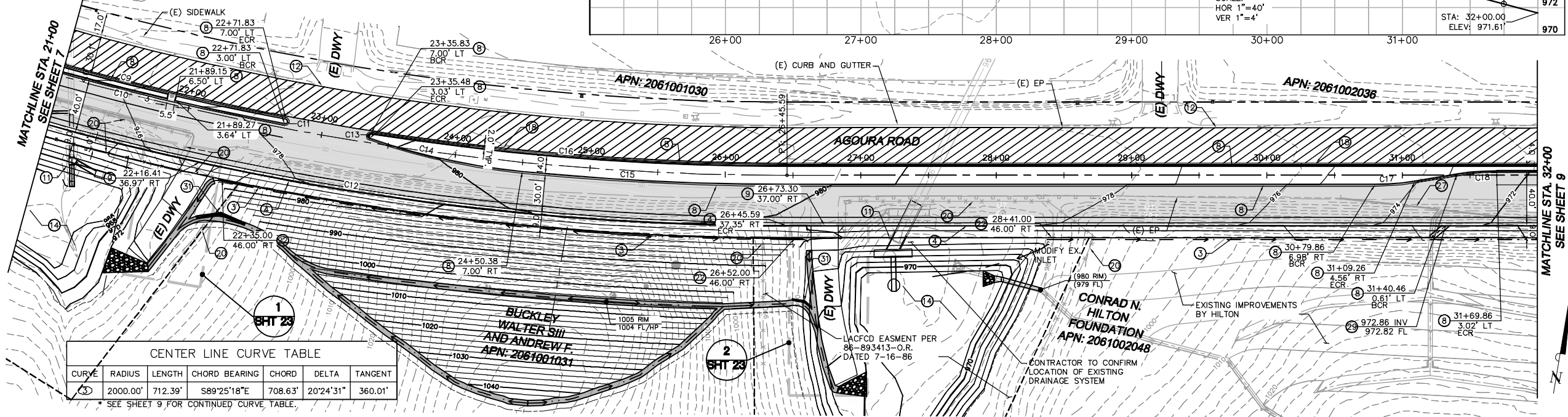

**CENTER LINE CURVE TABLE**

CURVE	RADIUS	LENGTH	CHORD BEARING	CHORD	DELTA	TANGENT
3	2000.00'	712.39'	S89°25'18"E	708.63'	20°24'31"	360.01'

SEE SHEET 9 FOR CONTINUED CURVE TABLE.

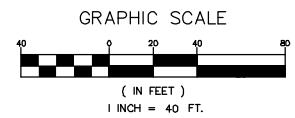

1		50%PS&E		9/9/11
2		75%PS&E		2/28/12
3		90%PS&E		6/8/12
4		100%PS&E		10/5/12
REV	SYMBOL	DESCRIPTION OF CHANGE	RCE	DATE

PREPARED BY:

**Kimley-Horn and Associates, Inc.**  
 © 2012 KIMLEY-HORN AND ASSOCIATES, INC.  
 6800 Owensmouth Avenue, Suite 410, Los Angeles CA  
 Tel (818) 227-2790 Fax (916) 608-0885

MICHAEL CHOI R.C.E. 67851 DATE

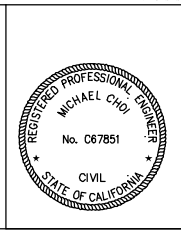

REVIEWED BY:

CHARMAINE YAMBAO DATE  
 ASSOCIATE CIVIL ENGINEER

APPROVED BY:

RAMIRO ADEVA DATE  
 DIRECTOR OF PUBLIC WORKS/CITY ENGINEER

AGOURA ROAD WIDENING  
STREET PLANS L-2

DRAWN BY: RC  
 CHECKED BY: JS/MC  
 KHA JOB NUMBER: 099083017

SHEET 8 OF 101

100% SUBMITTAL - OCTOBER 2012



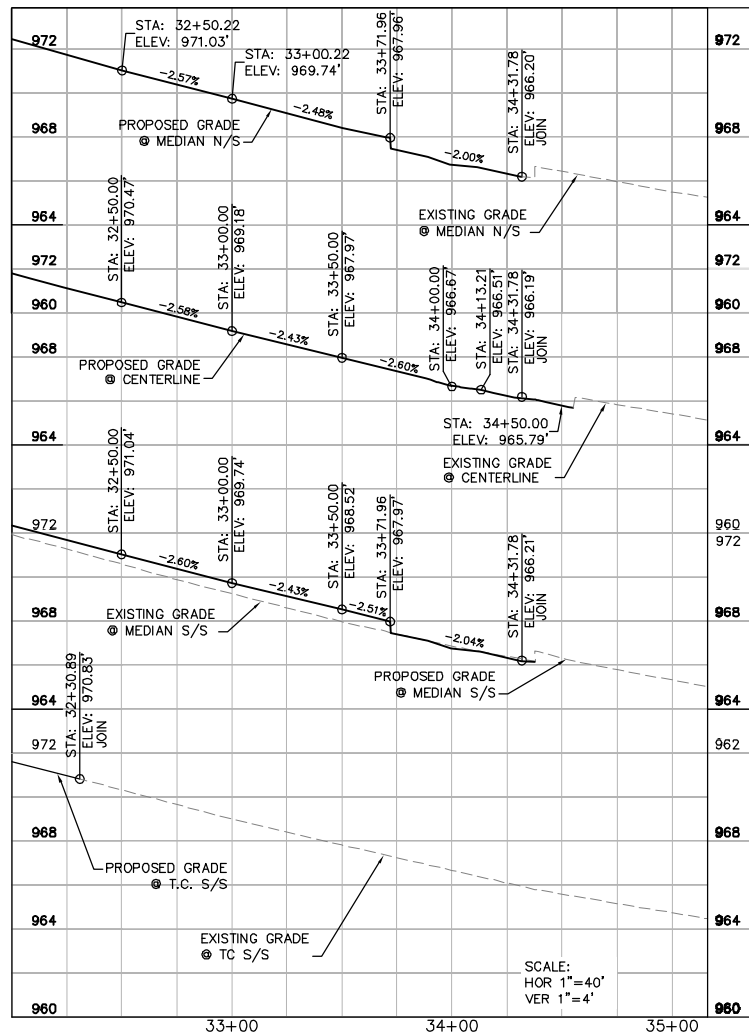

IMPROVEMENTS BY HILTON

CURVE	RADIUS	LENGTH	DELTA	TANGENT
C9	1993.00'	249.16'	7°09'46"	124.74'
C10	1997.00'	161.12'	4°37'22"	80.60'
C11	2.00'	6.28'	180°00'00"	
C12	2037.00'	725.57'	20°24'31"	366.67'
C13	2.00'	5.93'	170°01'28"	22.92'
C14	500.00'	115.69'	13°15'26"	58.10'
C15	2007.00'	195.89'	5°35'32"	98.02'
C16	1993.00'	308.67'	8°52'26"	154.64'
C17	180.00'	29.53'	9°24'03"	14.80'
C18	180.00'	29.53'	9°24'03"	14.80'
C19	2.00'	6.28'	180°00'00"	

CURVE	RADIUS	LENGTH	CHORD BEARING	CHORD	DELTA	TANGENT
④	1500.00'	489.50'	N89°43'23"E	487.33'	18°41'51"	246.95'

- LEGEND:
- COLD PLANE AND OVERLAY AREA
  - HMA PAVEMENT
  - STAMPED CONCRETE DRIVEWAY
  - PROPOSED RIGHT OF WAY
  - (E) RIGHT OF WAY
  - ALIGNMENT CENTERLINE
  - SAWCUT LINE
  - GRADING LIMIT
  - TOP CUT DITCH / TOE FILL DITCH
  - SLOUGH WALL
  - CENTER LINE CURVE NUMBER
  - CURVE NUMBER

- NOTES:
1. STATION AND OFFSET CALLOUTS ARE TO TOP FACE OF CURB UNLESS OTHERWISE NOTED.
  2. FOR ADDITIONAL GRADING AND LAYOUT INFORMATION SEE CONSTRUCTION DETAIL SHEETS.
  3. EXISTING RIGHT OF WAY TO BE VERIFIED BY THE CONTRACTOR PRIOR TO START OF WORK.
  4. SEE UTILITY PLANS FOR UTILITY RELOCATIONS AND ADJUSTMENTS.
  5. SEE SIGNING AND STRIPING PLANS FOR LANE MARKINGS AND TRAFFIC SIGNS.
  6. SEE STORM DRAIN PLANS FOR STORM DRAIN AND DEBRIS BASIN WORK.
  7. SEE TREE REMOVAL PLANS FOR TREES TO BE REMOVED.

- CONSTRUCTION NOTES:
- ① CATCH BASIN (SEE STORM DRAIN PLANS)
  - ② COLDPLANE TO MIN. 1.5" DEPTH. WIDTH PER PLAN. CONSTRUCT OVERLAY ASPHALT PAVEMENT
  - ③ CONSTRUCT PCC SIDEWALK (SEE CONSTRUCTION DETAILS)
  - ④ CONSTRUCT CURB AND GUTTER, TYPE A2-8, PER APWA STD. PLAN 120-2
  - ⑤ CONSTRUCT CURB RAMP, CASE A-TYPE 1, PER APWA STD. PLAN 111-4
  - ⑥ CONSTRUCT CURB RAMP, CASE B-TYPE 1, PER APWA STD. PLAN 111-4
  - ⑦ CONSTRUCT CURB RAMP, CASE D-TYPE 1, PER APWA STD. PLAN 111-4
  - ⑧ CONSTRUCT CURB, TYPE A1-6, PER APWA STD. PLAN 120-2
  - ⑨ CONSTRUCT DRIVEWAY APPROACH, TYPE B, PER APWA STD. PLAN 110-2
  - ⑩ CONSTRUCT PCC CROSS GUTTER (SEE CONSTRUCTION DETAILS)
  - ⑪ EXTEND CULVERT (SEE STORM DRAIN PLANS)
  - ⑫ JOIN EXISTING
  - ⑬ LANDSCAPING PER LANDSCAPE PLANS
  - ⑭ MODIFY DRAINAGE BASIN (SEE STORM DRAIN PLANS)
  - ⑮ RELOCATE EXISTING DRIVEWAY (SEE CONSTRUCTION DETAILS)
  - ⑯ RELOCATE EXISTING MONUMENT
  - ⑰ REMOVE EXISTING PAVEMENT, SIDEWALK, CURB, GUTTER OR MEDIAN AS REQUIRED
  - ⑱ SAWCUT
  - ⑲ PROTECT EXISTING OAK TREE IN PLACE (SEE TREE REMOVAL PLANS FOR MORE INFORMATION)
  - ⑳ REMOVE AND REPLACE EXISTING FENCE AS REQUIRED
  - ㉑ CONSTRUCT TOP CUT DITCH (SEE CONSTRUCTION DETAILS)
  - ㉒ CONSTRUCT SLOUGH WALL. (SEE DETAIL 6 ON CD-10 ON SHEET 30)
  - ㉓ REMOVE/RELOCATE EXISTING MBGR
  - ㉔ RETAINING WALL (SEE RETAINING WALL PLANS)
  - ㉕ CONSTRUCT TOE FILL DITCH (SEE CONSTRUCTION DETAILS SHEET 30)
  - ㉖ CONSTRUCT AC DIKE, TYPE D1-8, PER APWA STD. PLAN 120-2
  - ㉗ REMOVE EXISTING AC BERM/CURB.
  - ㉘ REMOVE EXISTING CMP AND INLET.
  - ㉙ INSTALL TRUNCATED DOME PER APWA STD. PLAN 111-3. COORDINATE WORK WITH CITY INSPECTOR.
  - ㉚ CONSTRUCT PARKWAY DRAIN PER APWA STD. PLAN 151-1, S=2
  - ㉛ CONSTRUCT URBAN BIOGREEN FILTER PER DETAIL ON SHEET 27.
  - ㉜ CONSTRUCT SPLASH WALL PER DETAIL ON SHEET 28.

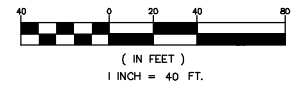
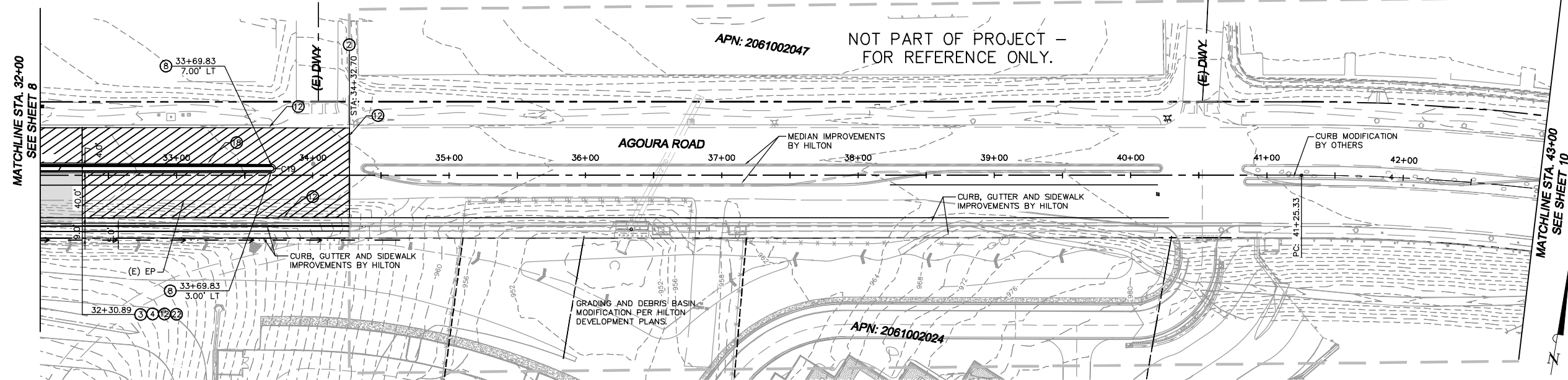

1		50%PS&E		9/9/11
2		75%PS&E		2/28/12
3		90%PS&E		6/8/12
4		100%PS&E		10/5/12
REV	SYMBOL	DESCRIPTION OF CHANGE	RCE	DATE

PREPARED BY:

**Kimley-Horn and Associates, Inc.**  
 © 2012 KIMLEY-HORN AND ASSOCIATES, INC.  
 6800 Owensmouth Avenue, Suite 410, Los Angeles CA  
 Tel (818) 227-2790 Fax (916) 608-0885

MICHAEL CHOI R.C.E. 67851 DATE

REVIEWED BY:

CHARMAINE YAMBAO ASSOCIATE CIVIL ENGINEER DATE

APPROVED BY:

RAMIRO ADEVA DIRECTOR OF PUBLIC WORKS/CITY ENGINEER DATE

CITY OF

**AGOURA HILLS**

AGOURA ROAD WIDENING  
STREET PLANS L-3

DRAWN BY: RC CHECKED BY: JS/MC KHA JOB NUMBER: 099083017

SHEET 9 OF 101

100% SUBMITTAL - OCTOBER 2012

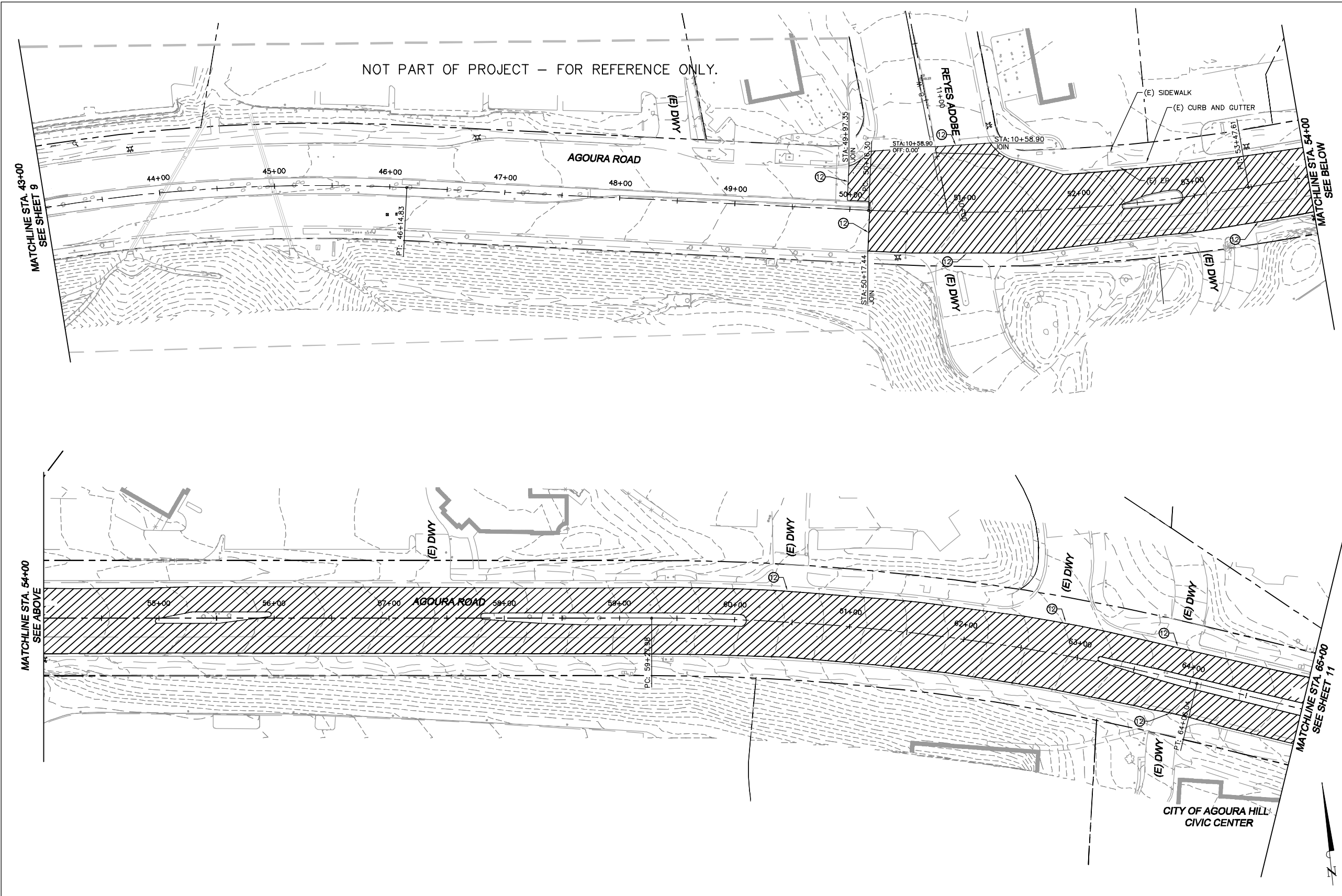

- LEGEND:**
- COLD PLANE AND OVERLAY AREA
  - HMA PAVEMENT
  - STAMPED CONCRETE DRIVEWAY
  - PROPOSED RIGHT OF WAY
  - (E) RIGHT OF WAY
  - ALIGNMENT CENTERLINE
  - SAWCUT LINE
  - GRADING LIMIT
  - TOP CUT DITCH / TOE FILL DITCH
  - SLOUGH WALL
  - CENTER LINE CURVE NUMBER
  - CURVE NUMBER

- NOTES:**
1. STATION AND OFFSET CALLOUTS ARE TO TOP FACE OF CURB UNLESS OTHERWISE NOTED.
  2. FOR ADDITIONAL GRADING AND LAYOUT INFORMATION SEE CONSTRUCTION DETAIL SHEETS.
  3. EXISTING RIGHT OF WAY TO BE VERIFIED BY THE CONTRACTOR PRIOR TO START OF WORK.
  4. SEE UTILITY PLANS FOR UTILITY RELOCATIONS AND ADJUSTMENTS.
  5. SEE SIGNING AND STRIPING PLANS FOR LANE MARKINGS AND TRAFFIC SIGNS.
  6. SEE STORM DRAIN PLANS FOR STORM DRAIN AND DEBRIS BASIN WORK.
  7. SEE TREE REMOVAL PLANS FOR TREES TO BE REMOVED.

- CONSTRUCTION NOTES:**
- 1 CATCH BASIN (SEE STORM DRAIN PLANS)
  - 2 COLDPLANE TO MIN. 1.5" DEPTH. WIDTH PER PLAN. CONSTRUCT OVERLAY ASPHALT PAVEMENT
  - 3 CONSTRUCT PCC SIDEWALK (SEE CONSTRUCTION DETAILS)
  - 4 CONSTRUCT CURB AND GUTTER, TYPE A2-8, PER APWA STD. PLAN 120-2
  - 5 CONSTRUCT CURB RAMP, CASE A-TYPE 1, PER APWA STD. PLAN 111-4
  - 6 CONSTRUCT CURB RAMP, CASE B-TYPE 1, PER APWA STD. PLAN 111-4
  - 7 CONSTRUCT CURB RAMP, CASE D-TYPE 1, PER APWA STD. PLAN 111-4
  - 8 CONSTRUCT CURB, TYPE A1-6, PER APWA STD. PLAN 120-2
  - 9 CONSTRUCT DRIVEWAY APPROACH, TYPE B, PER APWA STD. PLAN 110-2
  - 10 CONSTRUCT PCC CROSS GUTTER (SEE CONSTRUCTION DETAILS)
  - 11 EXTEND CULVERT (SEE STORM DRAIN PLANS)
  - 12 JOIN EXISTING
  - 13 LANDSCAPING PER LANDSCAPE PLANS
  - 14 MODIFY DRAINAGE BASIN (SEE STORM DRAIN PLANS)
  - 15 RELOCATE EXISTING DRIVEWAY (SEE CONSTRUCTION DETAILS)
  - 16 RELOCATE EXISTING MONUMENT
  - 17 REMOVE EXISTING PAVEMENT, SIDEWALK, CURB, GUTTER OR MEDIAN AS REQUIRED
  - 18 SAWCUT
  - 19 PROTECT EXISTING OAK TREE IN PLACE (SEE TREE REMOVAL PLANS FOR MORE INFORMATION)
  - 20 REMOVE AND REPLACE EXISTING FENCE AS REQUIRED
  - 21 CONSTRUCT TOP CUT DITCH (SEE CONSTRUCTION DETAILS)
  - 22 CONSTRUCT SLOUGH WALL. (SEE DETAIL 6 ON CD-10 ON SHEET 30)
  - 23 REMOVE/RLOCATE EXISTING MBGR
  - 24 RETAINING WALL (SEE RETAINING WALL PLANS)
  - 25 CONSTRUCT TOE FILL DITCH (SEE CONSTRUCTION DETAILS SHEET 30)
  - 26 CONSTRUCT AC DIKE, TYPE D1-8, PER APWA STD. PLAN 120-2
  - 27 REMOVE EXISTING AC BERM/CURB.
  - 28 REMOVE EXISTING CMP AND INLET.
  - 29 INSTALL TRUNCATED DOME PER APWA STD. PLAN 111-3. COORDINATE WORK WITH CITY INSPECTOR.
  - 30 CONSTRUCT PARKWAY DRAIN PER APWA STD. PLAN 151-1, S=2
  - 31 CONSTRUCT URBAN BIOGREEN FILTER PER DETAIL ON SHEET 27.
  - 32 CONSTRUCT SPLASH WALL PER DETAIL ON SHEET 28.

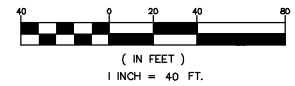

1		50%PS&E		9/9/11
2		75%PS&E		2/28/12
3		90%PS&E		6/8/12
4		100%PS&E		10/5/12
REV	SYMBOL	DESCRIPTION OF CHANGE	RCE	DATE

PREPARED BY:

**Kimley-Horn and Associates, Inc.**  
 © 2012 KIMLEY-HORN AND ASSOCIATES, INC.  
 6800 Owensmouth Avenue, Suite 410, Los Angeles CA  
 Tel (818) 227-2790 Fax (916) 608-0885

MICHAEL CHOI R.C.E. 67851 DATE

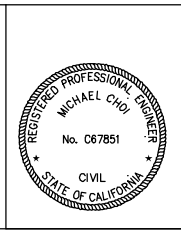

REVIEWED BY:

CHARMAINE YAMBAO DATE  
 ASSOCIATE CIVIL ENGINEER

APPROVED BY:

RAMIRO ADEVA DATE  
 DIRECTOR OF PUBLIC WORKS/CITY ENGINEER

**CITY OF AGOURA HILLS**

AGOURA ROAD WIDENING  
 STREET PLANS L-4

DRAWN BY: RC CHECKED BY: JS/MC KHA JOB NUMBER: 099083017

SHEET 10 OF 101

100% SUBMITTAL - OCTOBER 2012

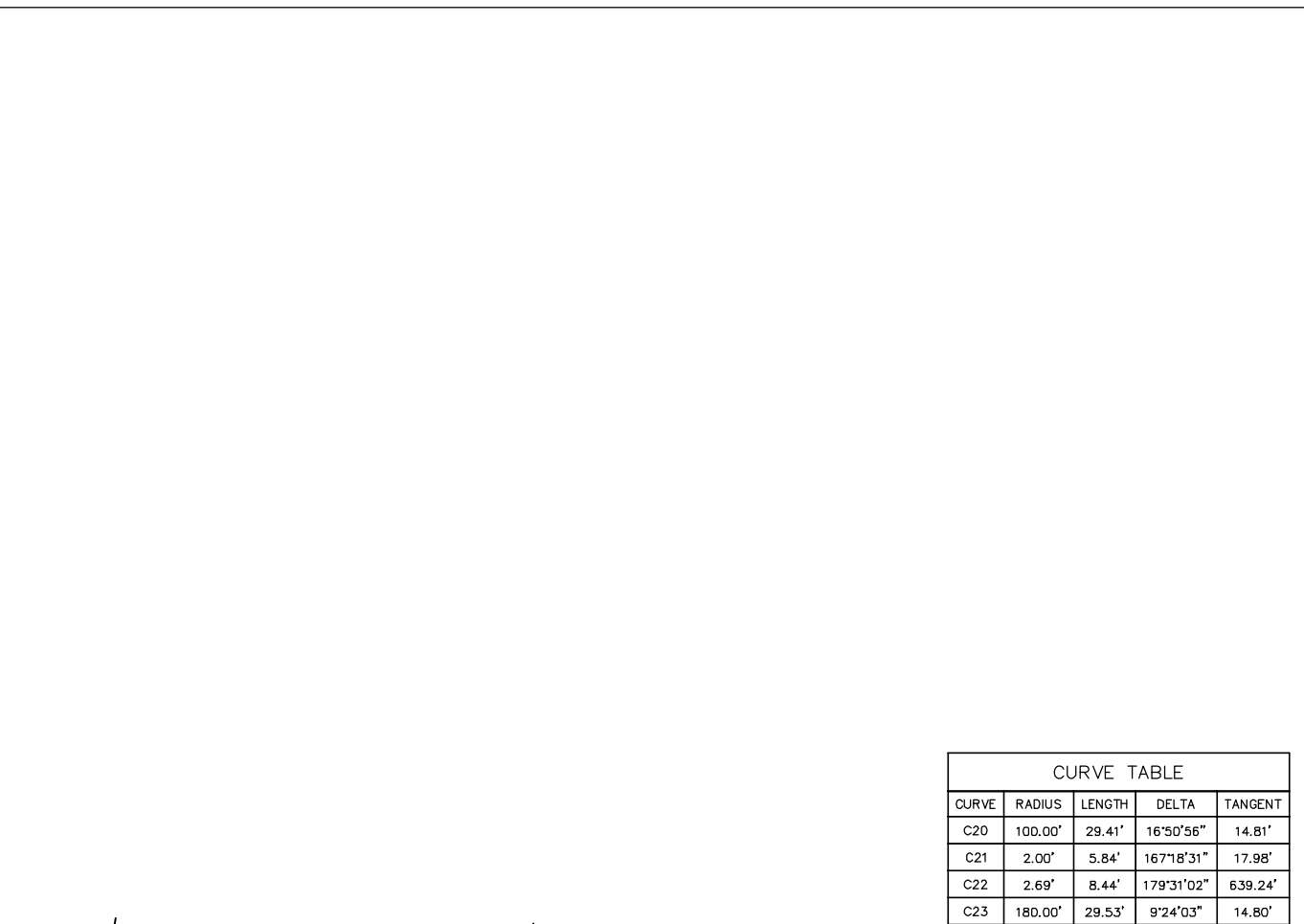

CURVE	RADIUS	LENGTH	DELTA	TANGENT
C20	100.00'	29.41'	16°50'56"	14.81'
C21	2.00'	5.84'	167°18'31"	17.98'
C22	2.69'	8.44'	179°31'02"	6.39.24'
C23	180.00'	29.53'	9°24'03"	14.80'
C24	180.00'	29.53'	9°24'03"	14.80'

CURVE	RADIUS	LENGTH	CHORD BEARING	CHORD	DELTA	TANGENT
5	2000.00'	670.10'	S89°29'12"E	666.97'	19°11'49"	338.22'

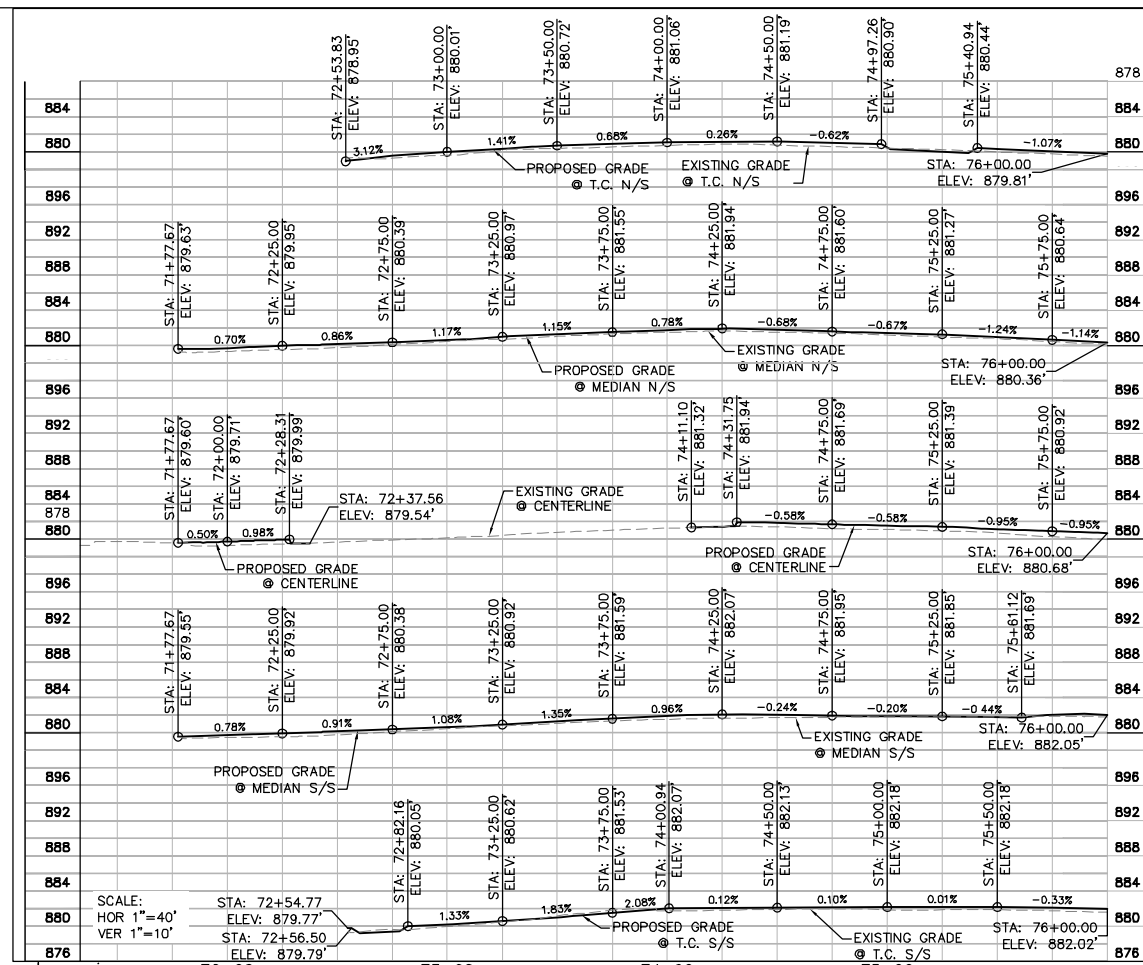

- LEGEND:**
- COLD PLANE AND OVERLAY AREA
  - HMA PAVEMENT
  - STAMPED CONCRETE DRIVEWAY
  - PROPOSED RIGHT OF WAY
  - (E) RIGHT OF WAY
  - ALIGNMENT CENTERLINE
  - SAWCUT LINE
  - GRADING LIMIT
  - TOP CUT DITCH / TOE FILL DITCH
  - SLOUGH WALL
  - CENTER LINE CURVE NUMBER
  - CURVE NUMBER
- NOTES:**
- STATION AND OFFSET CALLOUTS ARE TO TOP FACE OF CURB UNLESS OTHERWISE NOTED.
  - FOR ADDITIONAL GRADING AND LAYOUT INFORMATION SEE CONSTRUCTION DETAIL SHEETS.
  - EXISTING RIGHT OF WAY TO BE VERIFIED BY THE CONTRACTOR PRIOR TO START OF WORK.
  - SEE UTILITY PLANS FOR UTILITY RELOCATIONS AND ADJUSTMENTS.
  - SEE SIGNING AND STRIPING PLANS FOR LANE MARKINGS AND TRAFFIC SIGNS.
  - SEE STORM DRAIN PLANS FOR STORM DRAIN AND DEBRIS BASIN WORK.
  - SEE TREE REMOVAL PLANS FOR TREES TO BE REMOVED.
- CONSTRUCTION NOTES:**
- CATCH BASIN (SEE STORM DRAIN PLANS)
  - COLDPLANE TO MIN. 1.5" DEPTH. WIDTH PER PLAN. CONSTRUCT OVERLAY ASPHALT PAVEMENT
  - CONSTRUCT PCC SIDEWALK (SEE CONSTRUCTION DETAILS)
  - CONSTRUCT CURB AND GUTTER, TYPE A2-8, PER APWA STD. PLAN 120-2
  - CONSTRUCT CURB RAMP, CASE A-TYPE 1, PER APWA STD. PLAN 111-4
  - CONSTRUCT CURB RAMP, CASE B-TYPE 1, PER APWA STD. PLAN 111-4
  - CONSTRUCT CURB RAMP, CASE D-TYPE 1, PER APWA STD. PLAN 111-4
  - CONSTRUCT CURB, TYPE A1-6, PER APWA STD. PLAN 120-2
  - CONSTRUCT DRIVEWAY APPROACH, TYPE B, PER APWA STD. PLAN 110-2
  - CONSTRUCT PCC CROSS GUTTER (SEE CONSTRUCTION DETAILS)
  - EXTEND CULVERT (SEE STORM DRAIN PLANS)
  - JOIN EXISTING
  - LANDSCAPING PER LANDSCAPE PLANS
  - MODIFY DRAINAGE BASIN (SEE STORM DRAIN PLANS)
  - RELOCATE EXISTING DRIVEWAY (SEE CONSTRUCTION DETAILS)
  - RELOCATE EXISTING MONUMENT
  - REMOVE EXISTING PAVEMENT, SIDEWALK, CURB, GUTTER OR MEDIAN AS REQUIRED
  - SAWCUT
  - PROTECT EXISTING OAK TREE IN PLACE (SEE TREE REMOVAL PLANS FOR MORE INFORMATION)
  - REMOVE AND REPLACE EXISTING FENCE AS REQUIRED
  - CONSTRUCT TOP CUT DITCH (SEE CONSTRUCTION DETAILS)
  - CONSTRUCT SLOUGH WALL. (SEE DETAIL 6 ON CD-10 ON SHEET 30)
  - REMOVE/RELOCATE EXISTING MBGR
  - RETAINING WALL (SEE RETAINING WALL PLANS)
  - CONSTRUCT TOE FILL DITCH (SEE CONSTRUCTION DETAILS SHEET 30)
  - CONSTRUCT AC DIKE, TYPE D1-8, PER APWA STD. PLAN 120-2
  - REMOVE EXISTING AC BERM/CURB.
  - REMOVE EXISTING CMP AND INLET.
  - INSTALL TRUNCATED DOME PER APWA STD. PLAN 111-3. COORDINATE WORK WITH CITY INSPECTOR.
  - CONSTRUCT PARKWAY DRAIN PER APWA STD. PLAN 151-1, S=2
  - CONSTRUCT URBAN BIOGREEN FILTER PER DETAIL ON SHEET 27.
  - CONSTRUCT SPLASH WALL PER DETAIL ON SHEET 28.

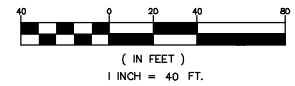

REV	SYMBOL	DESCRIPTION OF CHANGE	RCE	DATE
1		50%PS&E		9/9/11
2		75%PS&E		2/28/12
3		90%PS&E		6/8/12
4		100%PS&E		10/5/12

PREPARED BY:

**Kimley-Horn and Associates, Inc.**  
 © 2012 KIMLEY-HORN AND ASSOCIATES, INC.  
 6800 Owensmouth Avenue, Suite 410, Los Angeles CA  
 Tel (818) 227-2790 Fax (916) 608-0885

MICHAEL CHOI R.C.E. 67851 DATE

REVIEWED BY:

CHARMAINE YAMBAO DATE  
 ASSOCIATE CIVIL ENGINEER

APPROVED BY:

RAMIRO ADEVA DATE  
 DIRECTOR OF PUBLIC WORKS/CITY ENGINEER

**CITY OF AGGOURA HILLS**

AGOURA ROAD WIDENING  
 STREET PLANS L-5

DRAWN BY: RC  
 CHECKED BY: JS/MC  
 KHA JOB NUMBER: 099083017

SHEET 11 OF 101

100% SUBMITTAL - OCTOBER 2012

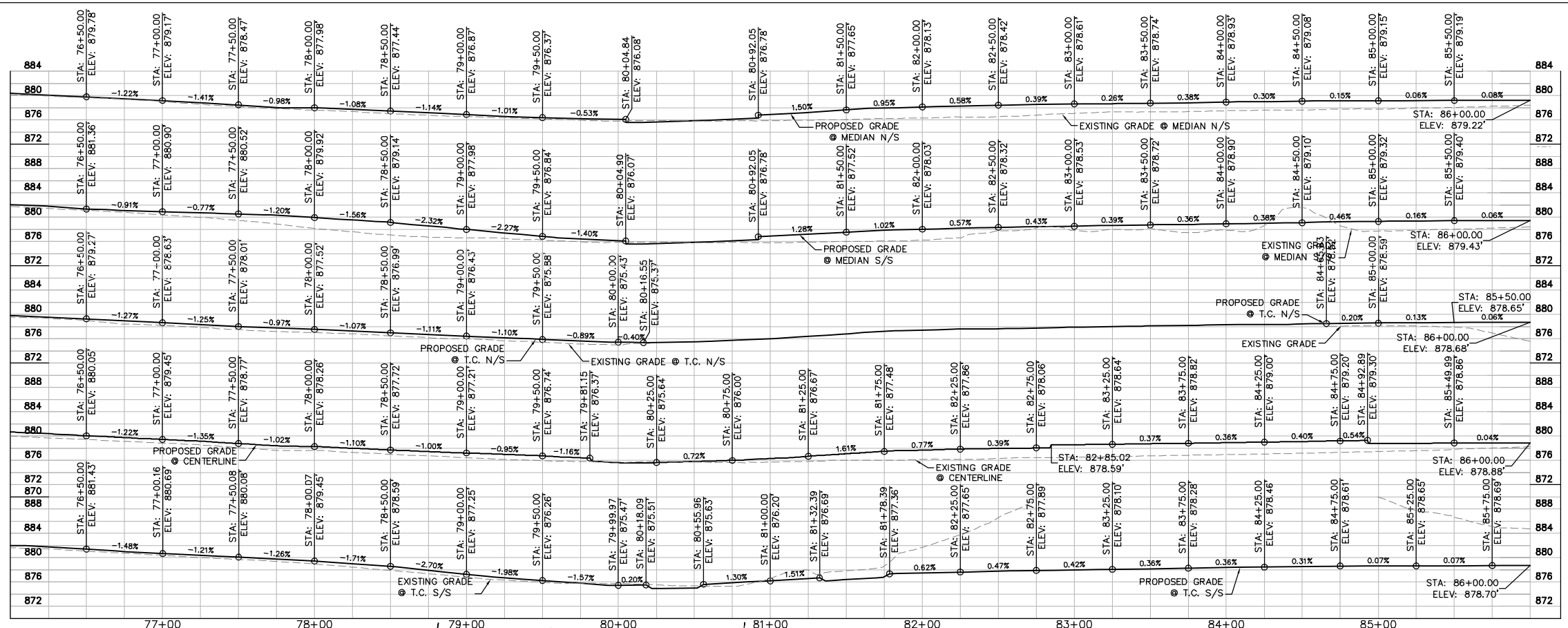

- LEGEND:**
- COLD PLANE AND OVERLAY AREA
  - HMA PAVEMENT
  - STAMPED CONCRETE DRIVEWAY
  - PROPOSED RIGHT OF WAY
  - (E) RIGHT OF WAY
  - ALIGNMENT CENTERLINE
  - SAWCUT LINE
  - GRADING LIMIT
  - TOP CUT DITCH / TOE FILL DITCH
  - SLOUGH WALL
  - CENTER LINE CURVE NUMBER
  - CURVE NUMBER
- NOTES:**
1. STATION AND OFFSET CALLOUTS ARE TO TOP FACE OF CURB UNLESS OTHERWISE NOTED.
  2. FOR ADDITIONAL GRADING AND LAYOUT INFORMATION SEE CONSTRUCTION DETAIL SHEETS.
  3. EXISTING RIGHT OF WAY TO BE VERIFIED BY THE CONTRACTOR PRIOR TO START OF WORK.
  4. SEE UTILITY PLANS FOR UTILITY RELOCATIONS AND ADJUSTMENTS.
  5. SEE SIGNING AND STRIPING PLANS FOR LANE MARKINGS AND TRAFFIC SIGNS.
  6. SEE STORM DRAIN PLANS FOR STORM DRAIN AND DEBRIS BASIN WORK.
  7. SEE TREE REMOVAL PLANS FOR TREES TO BE REMOVED.
- CONSTRUCTION NOTES:**
- 1 CATCH BASIN (SEE STORM DRAIN PLANS)
  - 2 COLDPLANE TO MIN. 1.5" DEPTH. WIDTH PER PLAN. CONSTRUCT OVERLAY ASPHALT PAVEMENT
  - 3 CONSTRUCT PCC SIDEWALK (SEE CONSTRUCTION DETAILS)
  - 4 CONSTRUCT CURB AND GUTTER, TYPE A2-8, PER APWA STD. PLAN 120-2
  - 5 CONSTRUCT CURB RAMP, CASE A-TYPE 1, PER APWA STD. PLAN 111-4
  - 6 CONSTRUCT CURB RAMP, CASE B-TYPE 1, PER APWA STD. PLAN 111-4
  - 7 CONSTRUCT CURB RAMP, CASE D-TYPE 1, PER APWA STD. PLAN 111-4
  - 8 CONSTRUCT CURB, TYPE A1-6, PER APWA STD. PLAN 120-2
  - 9 CONSTRUCT DRIVEWAY APPROACH, TYPE B, PER APWA STD. PLAN 110-2
  - 10 CONSTRUCT PCC CROSS GUTTER (SEE CONSTRUCTION DETAILS)
  - 11 EXTEND CULVERT (SEE STORM DRAIN PLANS)
  - 12 JOIN EXISTING
  - 13 LANDSCAPING PER LANDSCAPE PLANS
  - 14 MODIFY DRAINAGE BASIN (SEE STORM DRAIN PLANS)
  - 15 RELOCATE EXISTING DRIVEWAY (SEE CONSTRUCTION DETAILS)
  - 16 RELOCATE EXISTING MONUMENT
  - 17 REMOVE EXISTING PAVEMENT, SIDEWALK, CURB, GUTTER OR MEDIAN AS REQUIRED
  - 18 SAWCUT
  - 19 PROTECT EXISTING OAK TREE IN PLACE (SEE TREE REMOVAL PLANS FOR MORE INFORMATION)
  - 20 REMOVE AND REPLACE EXISTING FENCE AS REQUIRED
  - 21 CONSTRUCT TOP CUT DITCH (SEE CONSTRUCTION DETAILS)
  - 22 CONSTRUCT SLOUGH WALL. (SEE DETAIL 6 ON CD-10 ON SHEET 30)
  - 23 REMOVE/RELOCATE EXISTING MBGR
  - 24 RETAINING WALL (SEE RETAINING WALL PLANS)
  - 25 CONSTRUCT TOE FILL DITCH (SEE CONSTRUCTION DETAILS SHEET 30)
  - 26 CONSTRUCT AC DIKE, TYPE D1-8, PER APWA STD. PLAN 120-2
  - 27 REMOVE EXISTING AC BERM/CURB.
  - 28 REMOVE EXISTING CMP AND INLET.
  - 29 INSTALL TRUNCATED DOME PER APWA STD. PLAN 111-3. COORDINATE WORK WITH CITY INSPECTOR.
  - 30 CONSTRUCT PARKWAY DRAIN PER APWA STD. PLAN 151-1, S=2
  - 31 CONSTRUCT URBAN BIOGREEN FILTER PER DETAIL ON SHEET 27.
  - 32 CONSTRUCT SPLASH WALL PER DETAIL ON SHEET 28.

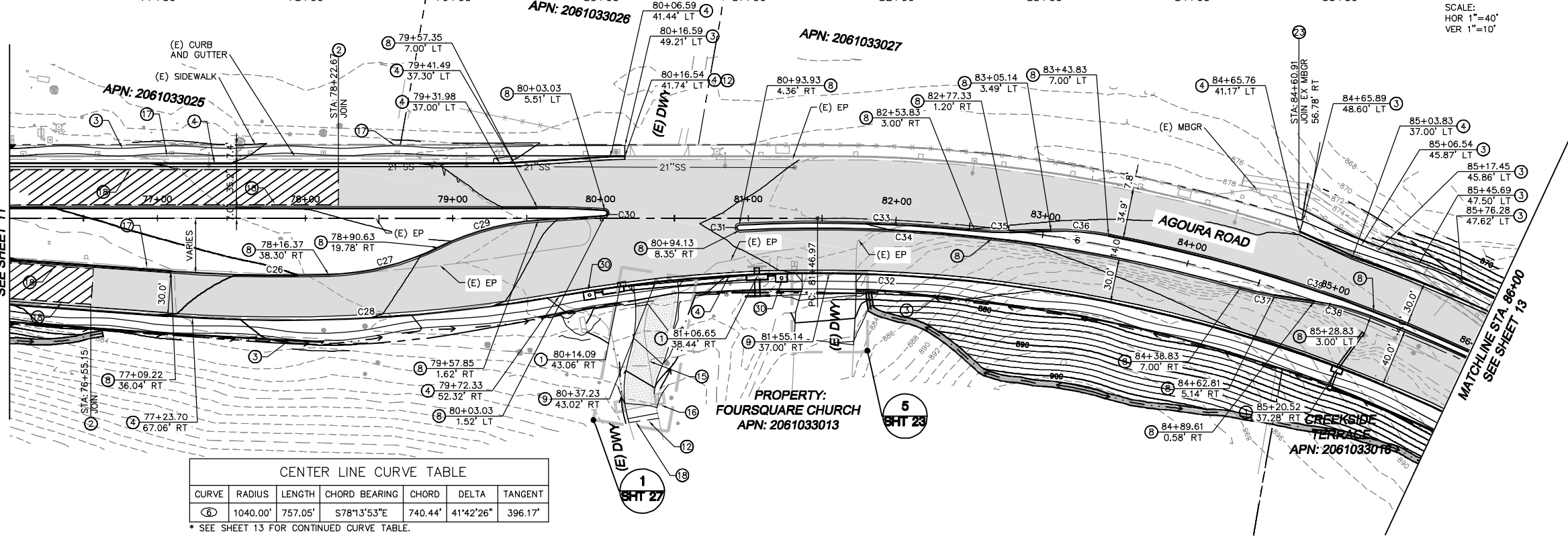

**CENTER LINE CURVE TABLE**

CURVE	RADIUS	LENGTH	CHORD BEARING	CHORD	DELTA	TANGENT
①	1040.00'	757.05'	S78°13'53"E	740.44'	41°42'26"	396.17'

\* SEE SHEET 13 FOR CONTINUED CURVE TABLE.

- SCALE:**  
HOR 1"=40'  
VER 1"=10'
- GRAPHIC SCALE**  
( IN FEET )  
1 INCH = 40 FT.

REV	SYMBOL	DESCRIPTION OF CHANGE	RCE	DATE
1		50%PS&E		9/9/11
2		75%PS&E		2/28/12
3		90%PS&E		6/8/12
4		100%PS&E		10/5/12

PREPARED BY:

**Kimley-Horn and Associates, Inc.**  
© 2012 KIMLEY-HORN AND ASSOCIATES, INC.  
6800 Owensmouth Avenue, Suite 410, Los Angeles CA  
Tel (818) 227-2790 Fax (916) 608-0885

MICHAEL CHOI R.C.E. 67851 DATE

REVIEWED BY:

CHARMAINE YAMBAO DATE  
ASSOCIATE CIVIL ENGINEER

APPROVED BY:

RAMIRO ADEVA DATE  
DIRECTOR OF PUBLIC WORKS/CITY ENGINEER

**CITY OF AGOURA HILLS**

AGOURA ROAD WIDENING  
STREET PLANS L-6

DRAWN BY: RC  
CHECKED BY: JS/MC  
KHA JOB NUMBER: 099083017

SHEET 12 OF 101

100% SUBMITTAL - OCTOBER 2012