

Memorandum

*Flex your power!
Be energy efficient!*

To: KHAN A HOSSAIN – 07
PROJECT MANAGER
OFFICE OF DESIGN D, LOS ANGELES

DATE: JUNE 21, 2011

File: 07-LA-101 PM 33 / 34.4
Interchange Mod- Palo Comado
Br. No. 53-1678
07-257200 EFIS 07-0700001840

From: **RICHARD C. HARTZELL** 
Liaison Engineer
Office of Special Funded Projects
Structure Design Services & Earthquake Engineering
Division of Engineering Services

Subject: Advance Planning Study (APS) APPROVAL

The Office of Special Funded Projects has reviewed the Advance Planning Study and estimate for the Palo Camado Canyon Rd OC, widening. The study and estimate are satisfactory for this stage of the project. My signature was placed on the plans for the proposed wall on June 21, 2011.

Please make sure the consultant uses the signed attached APS in the Final Project Report.

Should you have any comments or questions, please contact me at (916) 227-4113.

c: Andranik Arzumian, Dist 7 (Via Email)
Robert Blume/Kimley Horn & Associates, Rancho Cordova, Ca (Via Email)

OSFP file

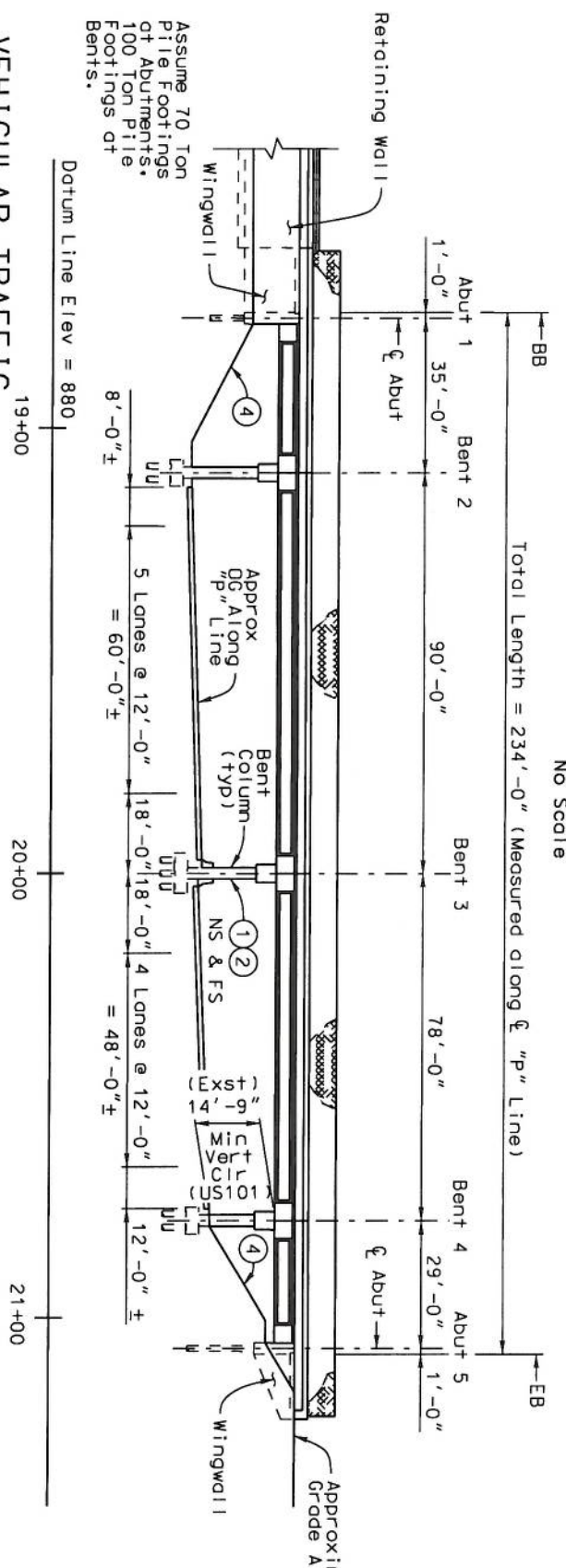
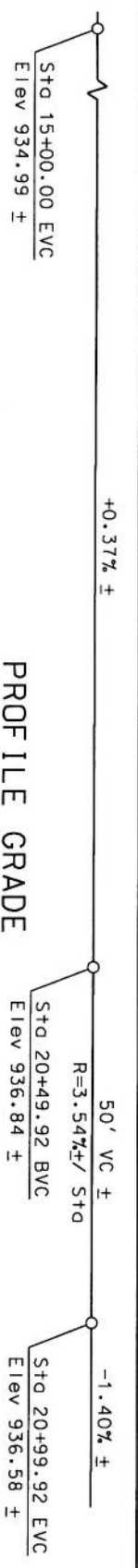

VEHICULAR TRAFFIC

1. New Alignment. No traffic at the site.
2. Traffic will be detoured away from site.
3. Traffic will be carried on the structure.
4. Traffic will pass under the structure on US 101

A.X. No falsework required over traffic
 B. Falsework openings required

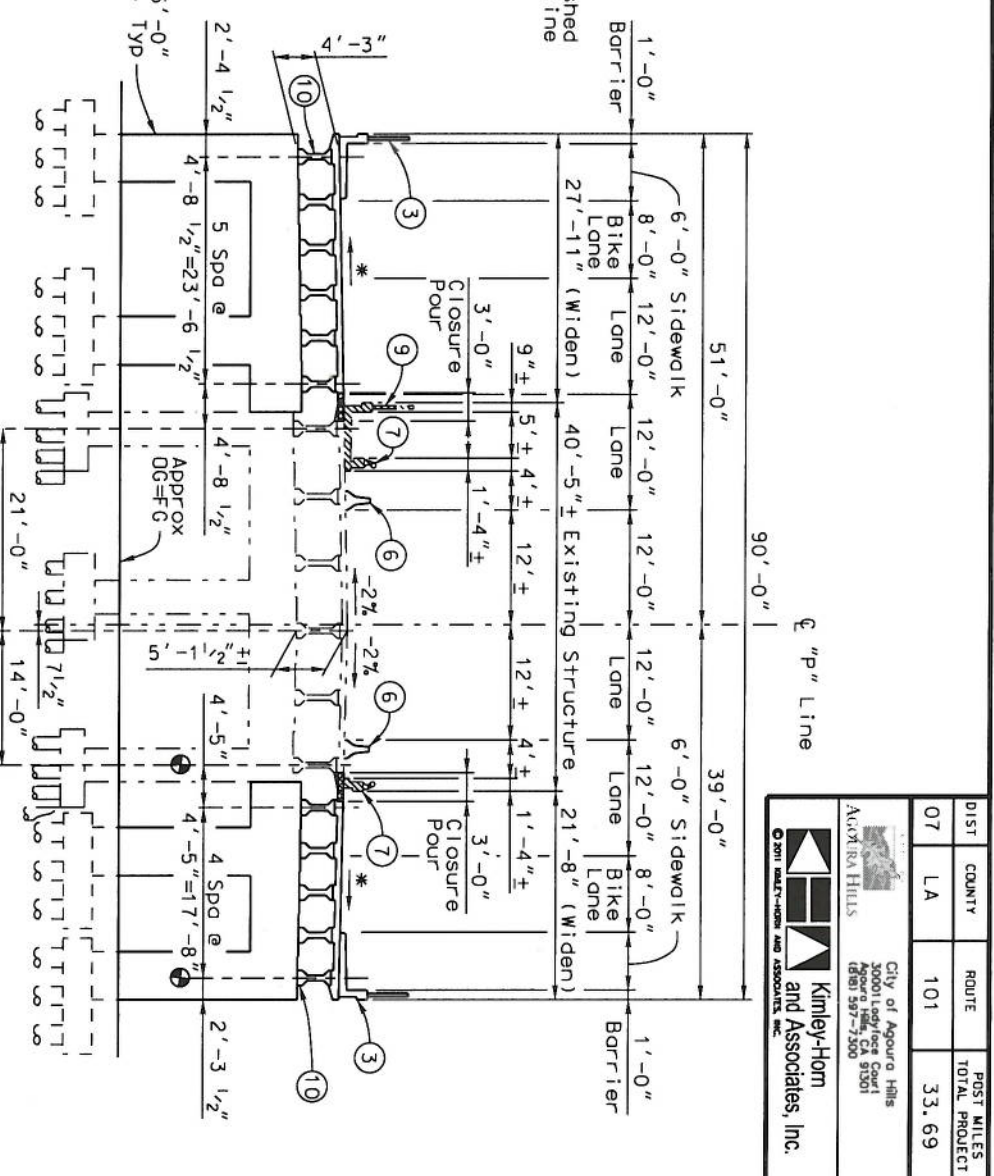
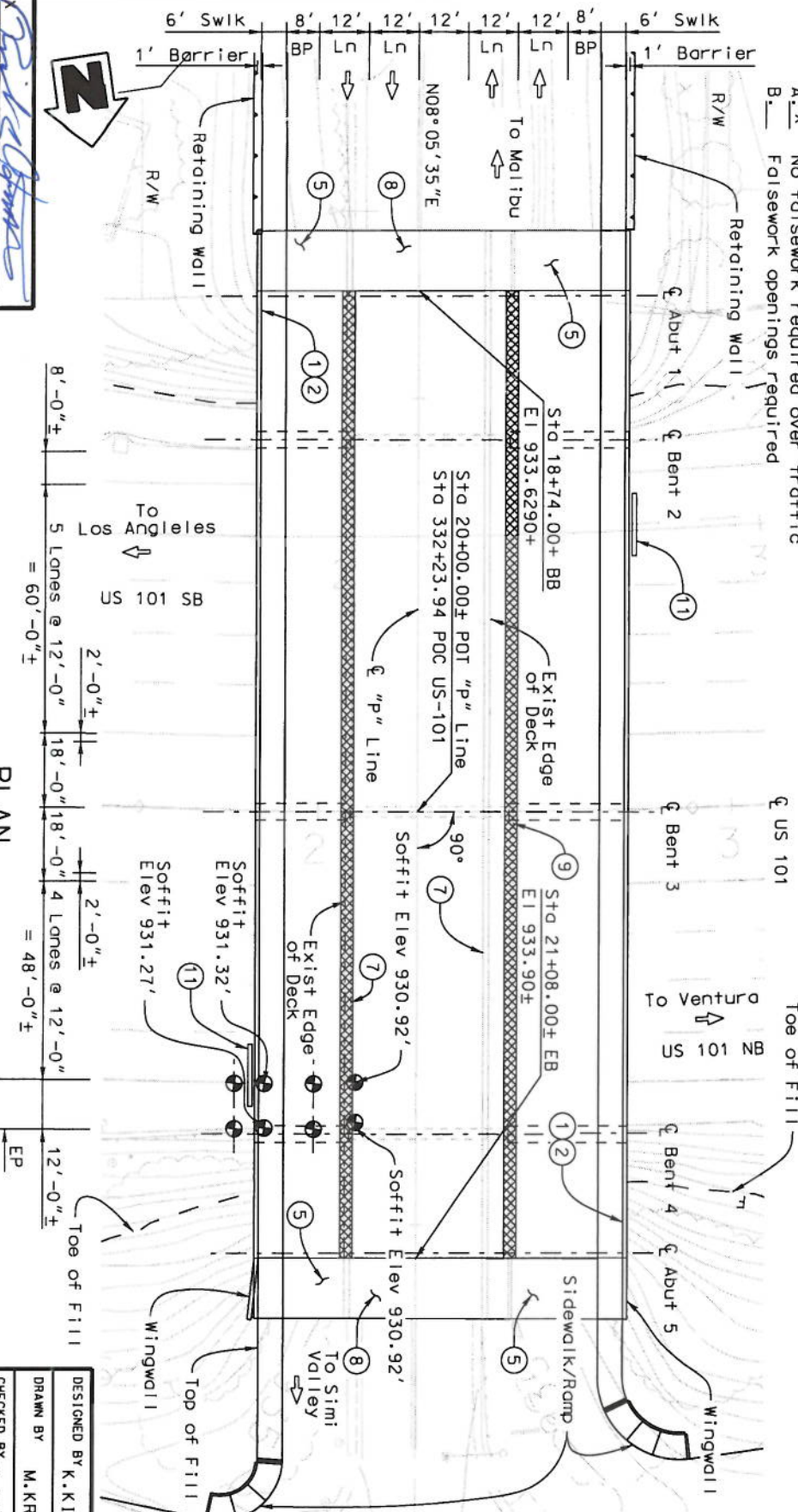

LEGEND:

- Indicates Point of Minimum Vertical Clearance Base on Survey Dated January 2010
- ETW Existing: 15.14' EP Existing: 14.75'
- ETW Proposed: 15.14' EP Proposed: 14.75'

TYPICAL SECTION * Match Exist Slope

NOTES:

1. Paint "Br No. 53-1678"
2. Paint "Palo Comado Canyon Road OC"
3. Concrete Barrier Type 26 (Mod) w/Chain Link Rolling Type 7
4. Concrete Slope Paving
5. Structure Approach Slab Type N(30S)
6. Temporary Rolling Type K
7. Remove and Salvage Existing Type 1 Barrier Rolling
8. Structure Approach Type R(30D)
9. Remove and Salvage Existing Bridge
10. Precast P/S Concrete I Girder (42")
11. Relocate Existing Bridge Mounted Signs.

Date of Estimate	Bridge Removal	Structure Depth	Length	Width (widened)	Area (widened)	Cost/Sf including 10% Mobilization & 25% Contingency	Total Cost
4/26/11	=	= 4'-3"	= 234'-0"	= 49'-7"	= 11,602 SF	= \$269	= \$3,120,000

ALTERNATIVE 2 GENERAL PLAN

PLANNING STUDY

DESIGNED BY: K. KIMM DATE: 05/11
 DRAWN BY: M. KRZYZEWSKI DATE: 05/11
 CHECKED BY: K. RAMANATHAN/D. LEISTIKO DATE: 05/11
 APPROVED: DATE: 05/18/2011

PALO COMADO CANYON RD OC (WIDEN)

BRIDGE NO. 53-1678 UNIT: OSFP Structure Design
 SCALE: AS NOTED PROJECT NUMBER & PHASE: EA: 12-25720

CONTRACT NO.: X

Kimley-Horn and Associates, Inc.

30001 Leffingwell Court
 Dublin, CA 94568
 (925) 937-7200

DIST	COUNTY	ROUTE	POST MILES TOTAL PROJECT
07	LA	101	33.69

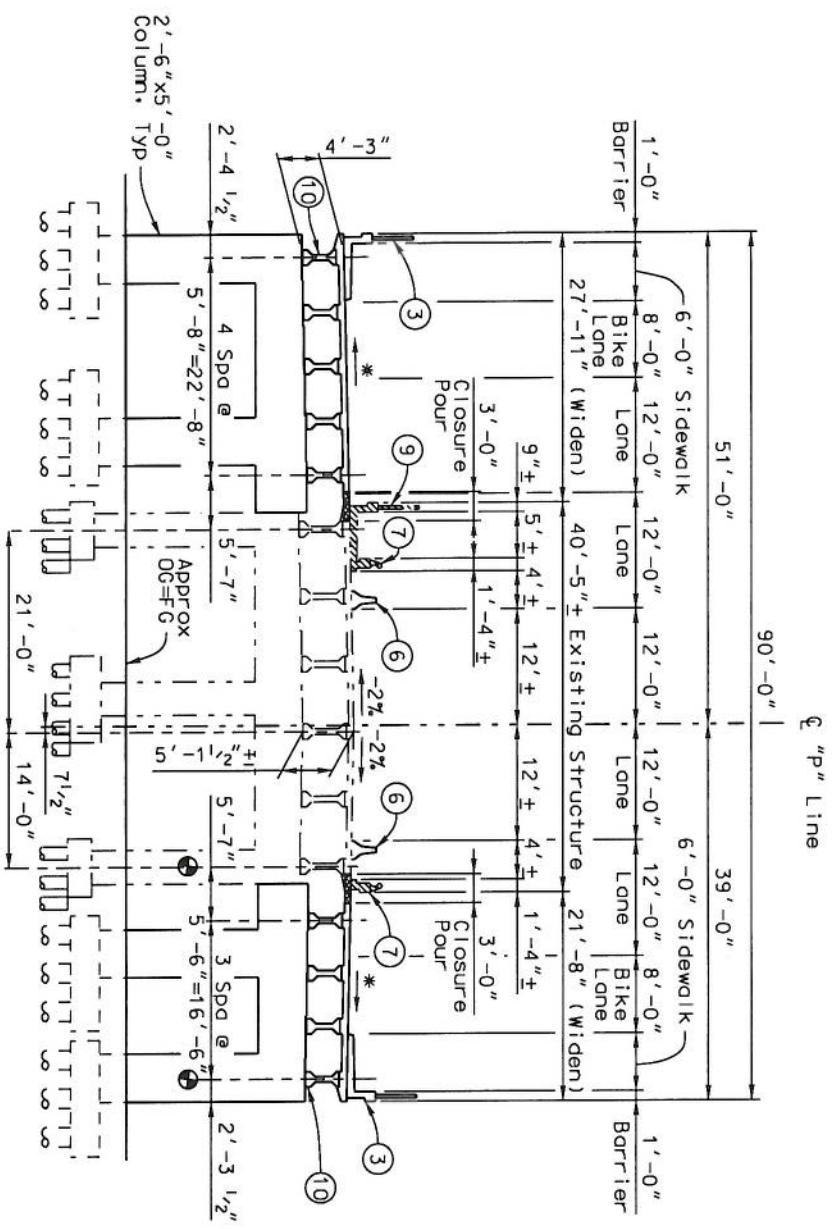

TYPICAL SECTION - SPANS 1, 3 AND 4

Scale: 1:10'

* Match Exist Slope

GENERAL NOTES:

1. General Plan & Elevation for Alternative 2A similar to Alternative 2.

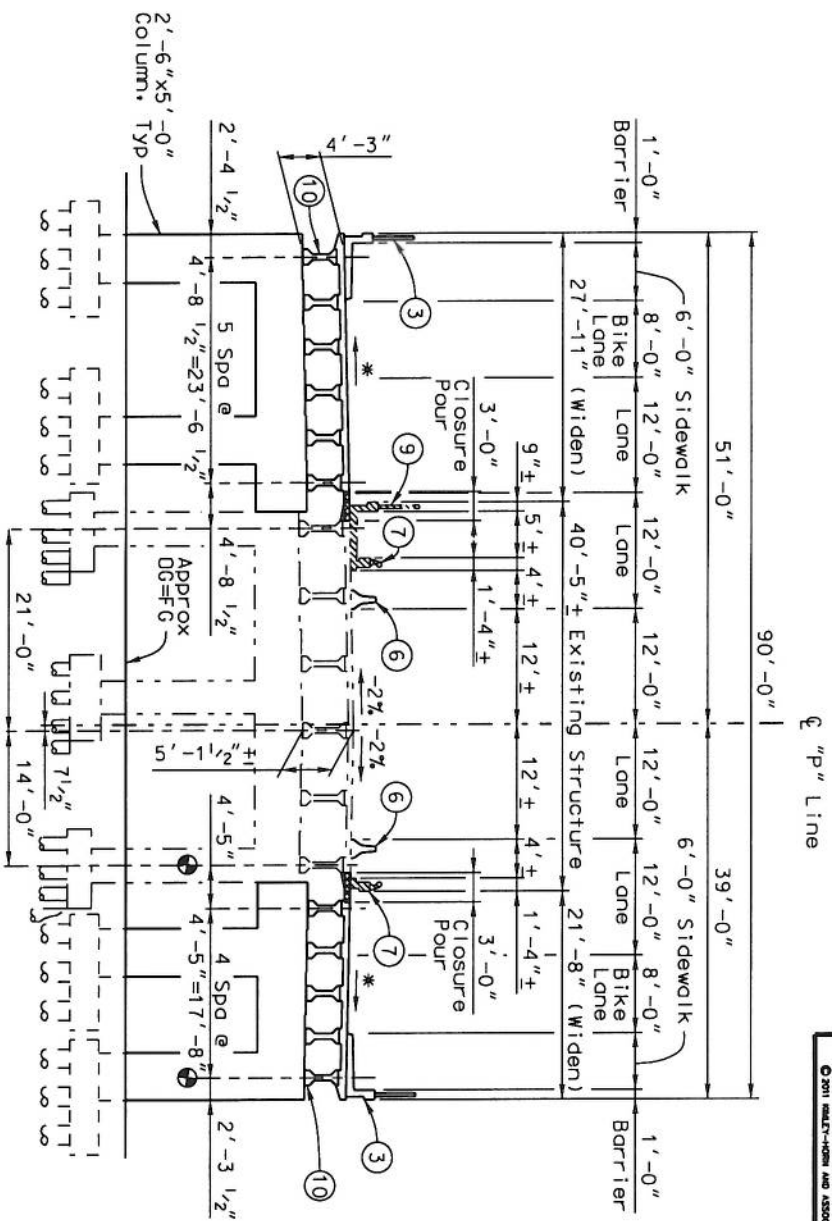

TYPICAL SECTION - SPAN 2

Scale: 1:10'

* Match Exist Slope

NOTES:

- 1 Point "Br No. 53-1678"
- 2 Point "Palo Comodo Canyon Road DC"
- 3 Concrete Barrier Type 26 (Mod) w/Chain Link Railing Type K
- 6 Temporary Railing Type K
- 7 Remove and Salvage Existing Type 1 Barrier Railing
- 9 Remove and Salvage Existing Pipe Railing
- 10 Precast P/S Concrete I Girder (42")

Date of Estimate	= 4/26/11
Bridge Removal	=
Structure Depth	= 4'-3"
Length	= 234'-0"
Width (Widened)	= 49'-7"
Area (Widened)	= 11,602 SF
Cost/Sf Including 10% Mobilization & 25% Contingency	= \$266
Total Cost	= \$3,080,000

DIST	COUNTY	ROUTE	POST MILES TOTAL PROJECT
07	LA	101	33.69

City of Agoura Hills
3000 Lusk
Agoura Hills, CA 91301
(818) 587-7500

Kimley-Horn and Associates, Inc.
2011 INDIAN HILLS AND ASSOCIATES, INC.

DESIGNED BY: K. KIMM DATE: 05/11
 DRAWN BY: M. KRZYZEWSKI DATE: 05/11
 CHECKED BY: K. RAMANATHAN/D. LEISTIKO DATE: 05/11
 APPROVED: DATE: 05/18/2011

DESIGNED BY: K. KIMM DATE: 05/11
 DRAWN BY: M. KRZYZEWSKI DATE: 05/11
 CHECKED BY: K. RAMANATHAN/D. LEISTIKO DATE: 05/11
 APPROVED: DATE: 05/18/2011



PLANNING STUDY

PALO COMODO CANYON RD OC (WIDEN)

BRIDGE NO. 53-1678 UNIT: OSFP Structure Design
 SCALE: AS NOTED PROJECT NUMBER & PHASE: EA: 12-2572C