



## REPORT TO CITY COUNCIL

**DATE:** AUGUST 27, 2014

**TO:** HONORABLE MAYOR AND MEMBERS OF THE CITY COUNCIL

**FROM:** GREG RAMIREZ, CITY MANAGER 

**BY:** RAMIRO ADEVA, PUBLIC WORKS DIRECTOR/CITY ENGINEER 

**SUBJECT:** CONDUCT A CONTINUED OPEN PUBLIC HEARING AND CONSIDER THE APPROVAL OF RESOLUTION NO. 14-1761, ADOPTING THE FINAL MITIGATED NEGATIVE DECLARATION (MND) REPORT AND MITIGATION MONITORING AND REPORTING PROGRAM (MMRP), AND RESOLUTION NO. 14-1762, APPROVING THE FINAL PROJECT AREA LIMITS FOR THE ROADSIDE DRIVE BRIDGE WIDENING PROJECT

---

At the regular meeting on August 13, 2014, the City Council opened and continued the open public hearing to August 27, 2014.

This report seeks City Council authorization to conduct a public hearing and consider the approval of Resolution No. 14-1761, adopting the final Mitigated Negative Declaration (MND) and the Mitigation Monitoring and Reporting Program (MMRP), and Resolution No. 14-1763, approving the final project area limits for the Roadside Drive Bridge Widening Project. The adoption of the MND and MMRP provides final project area approval and mitigation measures to be included as part of the construction phase of the project.

Roadside Drive is classified as a Collector Street in the City's General Plan. The General Plan defines collector streets as "streets that are designed to distribute traffic from higher classified arterial streets to local access streets and adjacent properties."

Due to the narrowness of the two-lane bridge in comparison to the width of Roadside Drive, the bridge deck was classified as functionally obsolete and was therefore eligible to receive Federal funds under the Highway Bridge Program (HBP). In addition, toll credits are permitted to be used as the non-federal matching share to ensure this project is fully funded for both design and construction. In June 2012, the City entered into an Agreement with Willdan Engineering to provide final design plans and specifications for the project construction.

The established project limits include the Roadside Drive Bridge over Medea Creek, and one thousand linear feet of Roadside Drive, between Cornell Road on the east, and Kanan Road on the west. The proposed project consists of widening the existing bridge from 30 feet to 42 feet in width; adding a sidewalk on the south side of Roadside Drive

It should be noted Caltrans administers the HBP funding and requires the IS/MND to be approved by the City Council prior to releasing the remaining funding pertaining to design work, which includes utility coordination and construction easements.

Approval of the MND and MMRP will provide the project with final approval of the project area limits and environmental mitigation measures to be included as part of project construction. A Draft Initial Study/Mitigated Negative Declaration (IS/MND) was prepared for this project, in compliance with the California Environmental Quality Act (CEQA). The MND concluded that, although potentially significant impacts to aesthetics, biological resources, cultural resources, geology and soils, and noise materials may occur, these impacts would be reduced to a level of less than significant with incorporation of the mitigation measures outlined in the MND. Air quality impacts were found to be less than significant; however the MND lists standard dust minimizing measures to be implemented during construction, as recommended by the South Coast Air Quality Management District (SCAQMD).

The Draft IS/MND was circulated for public review from March 6, 2014, to April 7, 2014. The Notice of Availability and Notice of Intent to Adopt the MND (NOA/NOI) was published in the Ventura County Star newspaper on March 8, 2014, and posted at City Hall, the Agoura Hills Library, and at the City Recreation Center, as well as on the City's website. The NOA/NOI was also mailed to public and regulatory agencies and interest groups that typically receive CEQA document notices. A hard copy of the IS/MND was made available for public review at the Planning Counter at City Hall and at the Agoura Hills Library, and the document was posted on the City's website. Comments received during the public review period were addressed in writing as part of the Response to Comments section of the IS/MND (refer to Final IS/MND section prior to Appendix A of the Final MND). The Final MND (Exhibit C) includes the Responses to Comments and the Mitigation Monitoring and Reporting Program (refer to section in Final IS/MND just before the Response to Comments), which outlines when each mitigation measure will be implemented and what entity is responsible for ensuring it is implemented. No changes were necessary to the MND text as a result of the public comments.

A copy of the Final IS/MND has been posted on the City's website. A notice of this City Council hearing to consider adoption of the Final IS/MND and the availability of the Final IS/MND has been published in the Acorn and sent to the entities on the CEQA document mailing list. All persons and entities that provided comments on the Draft IS/MND have been provided with a notice of the public hearing and a copy of the Responses to Comments.

Attachment "A" is City Council Resolution No. 14-1761, adopting the Final IS/MND for the Roadside Drive Bridge Widening Project; making environmental findings pursuant to the CEQA; and adopting a Mitigation Monitoring and Reporting Program (MMRP).

According to the CEQA Guidelines (§15074), the decision-making body of the Lead Agency (City Council) shall consider the proposed IS/MND, together with any comments received during the public review process. The City Council shall adopt the proposed

According to the CEQA Guidelines (§15074), the decision-making body of the Lead Agency (City Council) shall consider the proposed IS/MND, together with any comments received during the public review process. The City Council shall adopt the proposed IS/MND only if it finds, on the basis of the whole record before it, that there is no substantial evidence that the project will have a significant effect on the environment, and that the IS/MND reflects the City Council's independent judgment and analysis.

Attachment "B" is City Council Resolution No. 14-1762 approving the Project Area Limits for the Roadside Drive Bridge Widening Project; including the MMRP. Also included is Exhibit A, which is a copy of the current design plans.

The proposed Resolution No. 14-1761 and Resolution No. 14-1762 have been reviewed by the City Attorney and approved as to form.

## **RECOMMENDATION**

City Staff recommends the City Council:

1. Conduct the continued open public hearing to consider the adoption of Resolution No. 14-1761 and Resolution No. 14-1762.
2. Adopt Resolution No. 14-1761, adopting the Final Mitigated Negative Declaration (MND) Report and Mitigation Monitoring and Reporting Program (MMRP) for the Roadside Drive Bridge Widening Project, and making the required environmental findings pursuant to the California Environmental Quality Act (CEQA).
3. Adopt Resolution No. 14-1762, approving the Final Project Area Limits for the Roadside Drive Bridge Widening Project.

Attachment:      Attachment A – Resolution No. 14-1761  
Attachment B – Resolution No. 14-1762, with Exhibit A  
Attachment C – Final MND

**RESOLUTION NO. 14-1761**

**A RESOLUTION OF THE CITY COUNCIL OF THE CITY OF AGOURA HILLS, CALIFORNIA ADOPTING THE FINAL INITIAL STUDY/MITIGATED NEGATIVE DECLARATION AND THE MITIGATION MONITORING AND REPORTING PROGRAM FOR THE ROADSIDE DRIVE BRIDGE WIDENING PROJECT AND MAKING THE REQUIRED ENVIRONMENTAL FINDINGS PURSUANT TO CEQA**

**THE CITY COUNCIL OF THE CITY OF AGOURA HILLS HEREBY FINDS, RESOLVES, AND ORDERS AS FOLLOWS:**

**WHEREAS**, a public hearing was duly held on August 27, 2014, in the Council Chambers of City Hall, 30001 Ladyface Court, Agoura Hills, California. Notice of the time, date, place and purpose of the public hearing was duly given; and

**WHEREAS**, evidence, both written and oral, was duly presented to and considered by the City Council of the City of Agoura Hills at the aforesaid public hearing; and

**WHEREAS**, after close of the public hearing, the City Council considered all public comments received both before and during the public hearing, the presentation by City staff, the staff report, and all other pertinent documents and associated actions regarding the proposed Final Initial Study/Mitigated Negative Declaration; and

**WHEREAS**, the City Council hereby makes the following environmental findings and determinations in connection with the Roadside Bridge Drive Widening Project Final Initial Study/Mitigated Negative Declaration:

- A. Pursuant to the California Environmental Quality Act ("CEQA") and the City's local CEQA Guidelines, City staff prepared an Initial Study of the potential environmental effects of the Roadside Drive Bridge Widening Project, as described in the Initial Study (the "Project"). Based upon the findings contained in that Initial Study, City staff, acting as the Lead Agency, determined that all identified potentially significant environmental impacts could be reduced to a level of less than significant with the incorporation of mitigation measures so that the project would not have a significant effect on the environment, and therefore a Mitigated Negative Declaration was prepared; and
- B. Thereafter, City staff provided public notice of the public comment period and of the intent to adopt the Initial Study/Mitigated Negative Declaration as required by law. The public comment period commenced on March 6, 2014, and ended on April 7, 2014. Copies of the documents have been available for public review and inspection at the offices of the Department of Planning and Community Development, located at City Hall, 30001 Ladyface Court, California, 91301; and

- C. The City Council has independently reviewed the Initial Study/Mitigated Negative Declaration and all comments received regarding the document prior to and at the August 27, 2014, public hearing, and based on the whole record before it, finds that: (1) the Initial Study/Mitigated Negative Declaration was prepared in compliance with CEQA and the City's local CEQA Guidelines; (2) that City staff has correctly concluded that there is no substantial evidence that the Project will have a significant effect on the environment; and (3) the Initial Study/Mitigated Negative Declaration reflects the independent judgment and analysis of the City Council; and

**WHEREAS**, the custodian of records for the Final Initial Study/Mitigated Negative Declaration and all materials that constitute the record of proceedings upon which the City Council's decision is based is the City Clerk of the City of Agoura Hills, and those documents are available for public review in the Office of the City clerk located at 30001 Ladyface Court, Agoura Hills, California, 91301.

**NOW, THEREFORE, BE IT RESOLVED** based on the findings and conclusion set forth above, that the City Council of the City of Agoura Hills hereby adopts the Roadside Drive Bridge Widening Project Final Initial Study/Mitigated Negative Declaration and the Mitigation Monitoring and Reporting Program for the Final Initial Study/Mitigated Negative Declaration.

**PASSED, APPROVED, and ADOPTED** this 27<sup>th</sup> day of August, 2014 by the following vote to wit:

AYES: (0)  
NOES: (0)  
ABSENT: (0)  
ABSTAIN: (0)

---

William D. Koehler, Mayor

ATTEST:

---

Kimberly M. Rodrigues, City Clerk

**RESOLUTION NO. 14-1762**

**A RESOLUTION OF THE CITY COUNCIL OF THE CITY OF AGOURA HILLS, CALIFORNIA, APPROVING THE FINAL PROJECT AREA LIMITS FOR THE ROADSIDE DRIVE BRIDGE WIDENING PROJECT**

**THE CITY COUNCIL OF THE CITY OF AGOURA HILLS HEREBY FINDS, RESOLVES, AND ORDERS AS FOLLOWS:**

**WHEREAS**, on June 13, 2012, the City Council awarded a contract for final design of the Roadside Drive Bridge Widening Project ("Project") to Willdan Engineering; and

**WHEREAS**, on August 27, 2014, the City Council held a duly noticed public hearing on the Final Initial Study/Mitigated Negative Declaration for the Project, at which time all persons had the opportunity to present oral and written evidence on the Final Initial Study/Mitigated Negative Declaration for the Project. Notice of the time, date, place, and purpose of the public hearing was duly given;

**WHEREAS**, on August 27, 2014, following consideration of information received at the public hearing before the City Council and due consideration of the Project, the City Council adopted Resolution No. 14-1762, A RESOLUTION OF THE CITY COUNCIL OF THE CITY OF AGOURA HILLS, CALIFORNIA, ADOPTING THE FINAL INITIAL STUDY/MITIGATED NEGATIVE DECLARATION AND THE MITIGATION MONITORING AND REPORTING PROGRAM FOR THE ROADSIDE DRIVE BRIDGE WIDENING PROJECT AND MAKING THE REQUIRED ENVIRONMENTAL FINDINGS PURSUANT TO CEQA; and

**WHEREAS**, the Project area limits have been finalized, which include the Roadside Drive Bridge over Medea Creek, and one thousand linear feet of Roadside Drive between Cornell Road on the east side and Kanan Road on the west. The proposed project consists of widening the existing bridge from 30 feet to 42 feet in width; adding approximately 600 linear feet of sidewalk on the south side of Roadside Drive, and installing landscape and lighting improvements. The project improvements of the Project will also include the construction of a retaining wall to accommodate the sidewalk; and

**WHEREAS**, the alignment component and the project area limits component of the design plans for the Roadside Drive Bridge Widening Project are final; and

**WHEREAS**, the custodian of records for the design plans and all materials that constitute the record of proceedings upon which the City Council's decision is based is the City Clerk of the City of Agoura Hills, and those documents are available for public review in the Office of the City Clerk located at 30001 Ladyface Court, Agoura Hills, California, 91301.

**NOW, THEREFORE, BE IT RESOLVED**, based on the findings and conclusion set forth above, that the City Council of the City of Agoura Hills hereby approves the design plans and final project area limits for the Roadside Drive Bridge Widening Project, as shown on Exhibit "A", attached hereto and incorporated herein as though set forth in full.

**PASSED, APPROVED, and ADOPTED** this 27<sup>th</sup> day of August, 2014, by the following vote to wit:

AYES: (0)  
NOES: (0)  
ABSENT: (0)  
ABSTAIN: (0)

\_\_\_\_\_  
William D. Koehler, Mayor

ATTEST:

\_\_\_\_\_  
Kimberly M. Rodrigues, City Clerk

**EXHIBIT "A"**

**DESIGN PLANS**

**KANAN ROAD AND AGOURA ROAD ROUNDABOUT PROJECT**













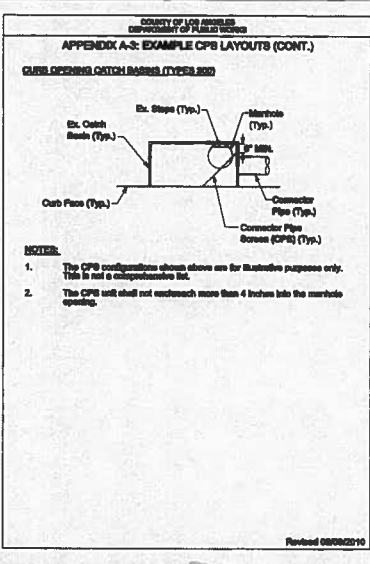
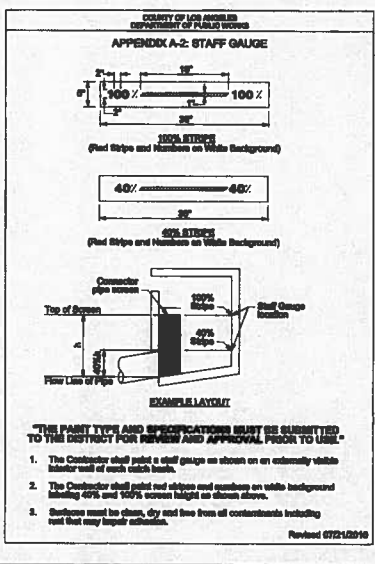
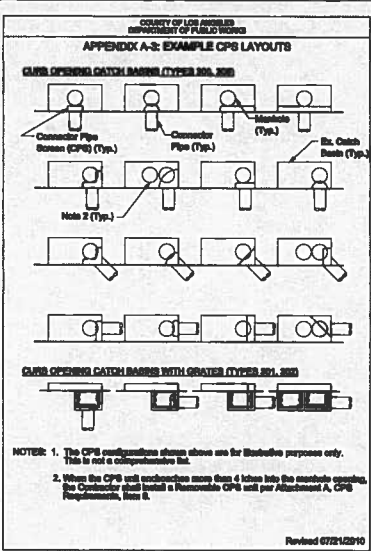
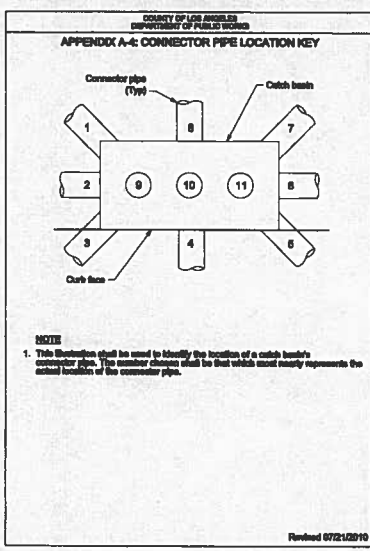
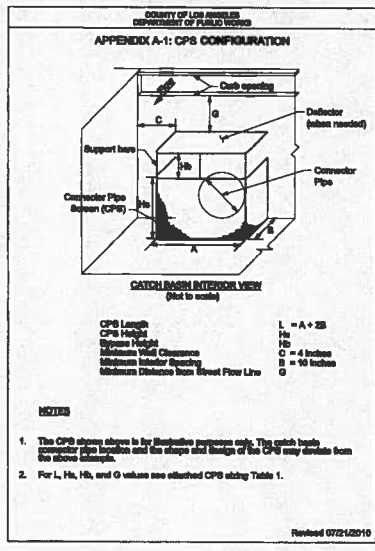

[PCFL 201202559]

**TABLE 1  
CPS SIZING TABLE FOR CBs IN NON-SUMP CONDITIONS WITH NO ARS**

V depth (ft)	CB Width (ft)	Bypass Height H <sub>b</sub> (in)	Screen Height H <sub>s</sub> (in)	Screen Length L (ft)	G (in)
3.0	3.5	5	14	3.0	6
	4.0				
	5.0				
	6.0				
	7.0				
3.5	7	16	15	3.0	8
	4.0				
	5.0				
	6.0				
	7.0				
4.0	7	12	20	3.0	8
	4.0				
	5.0				
	6.0				
	7.0				
4.5 or greater	3.5	12	22	3.0	10 or greater
	4.0				
	5.0				
	6.0				
	7.0				

for CBs with v-depth less than 3 feet, contact the District for H<sub>b</sub>, H<sub>s</sub>, L, and G values

LA COUNTY  
CONNECTOR PIPE SCREEN DETAILS  
N.T.S.

REVISION #	SYMBOL	DESCRIPTION OF CHANGE	APPROVED	DATE	PREPARED BY:	CITY OF AGOURA HILLS APPROVAL	DATE
					PROJECT ENGINEER	RAHMO ADEVA CITY ENGINEER	DATE
					REVIEWED BY	08863 8/30/14 ROE NO. EXP DATE	DATE



CITY OF AGOURA HILLS  
ROADSIDE DRIVE BRIDGE WIDENING  
STORM DRAIN DETAILS  
SHEET 8 OF 13

\\net-ds\lhb\lhb\10448 Roadside Drain Details\10448-Roadside - EX-VD-Plan\pl-31002.dwg - 7/29/2014 4:37 PM



14000 E. Valley Blvd  
City of Industry, CA 91746  
(877) 4-Storm (877) 477-7669  
Fax: (626) 961-3108

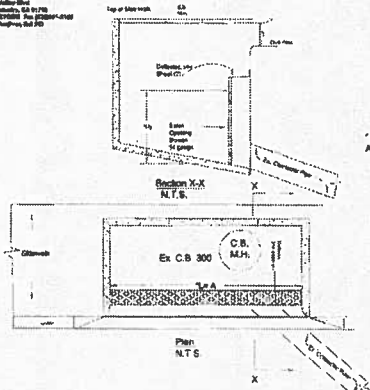

\* See Appendix A-1 and CPS using Tables 1 & 2

DATE	
PROJECT	
LOCATION	
SCALE	
DESIGNED BY	
CHECKED BY	
APPROVED BY	
DATE	



14000 E. Valley Blvd  
City of Industry, CA 91746  
(877) 4-Storm (877) 477-7669  
Fax: (626) 961-3108

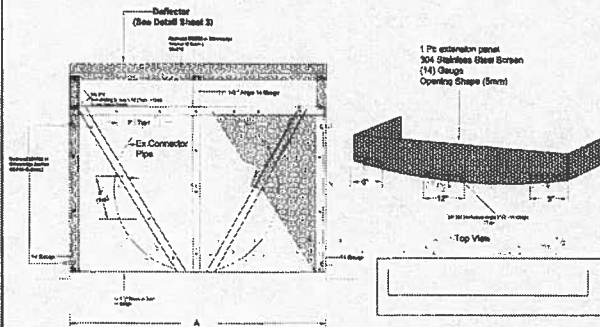

1. For estimation please use 304 Stainless Steel Screen (14) Gauge Opening Shape (5mm)

DATE	
PROJECT	
LOCATION	
SCALE	
DESIGNED BY	
CHECKED BY	
APPROVED BY	
DATE	

United Storm Water- CPS Technical Manual

United Storm Water, Inc. Connector Pipe Screen Installation Instructions:

1. Bring the CPS unit into the catch basin and rest it on top of outlet hole. The unit has 3 components, deflector, CP "Z" panels, and the base screen, depending on the size of the catch basin opening. Establish a definite location for your first "Z" Panel and then mark your holes by drilling. Do the same for your second Panel.
2. Remove the CPS unit from the installation well. Drill 3/8" x 4" holes where you marked. Make sure to drill straight into the catch basin wall to avoid rounding difficulties.
3. Hammer 3/8" x 1 1/2" stainless steel anchor bolts into the holes.
4. After all of the anchor bolts are hammered into place, attach the "Z" panels.
5. Deflector deflex, measure and cut a length of deflector screen same length as CPS unit. Make cuts using a compact grinder. Be sure to "grind smooth" any sharp edges. Place deflector on wall to catch basin and establish a definite location for the deflector, directly above the CPS device. Heat, mark and drill 3/8" x 2 1/2" holes.
6. Hammer 3/8"x2 1/2" stainless steel anchor bolts into the holes.
7. After all of the anchor bolts are hammered into place, attach the deflector onto the anchor bolts and secure it tight.
8. Scribe and cut the bottom of the first panel to conform to the catch basin bottom section. Then attach the first panel to the "Z" panels using the self tapping screen provided.
9. Attach deflector support bracket (1" x 1 1/2" uncoated angle) behind 1" of deflector to top corner of CPS device. Secure with self tapping screen provided.
10. Only when CPS unit is wider than 30", 1"x1" angle need to be install from top corner of the CPS unit to bottom Center Support Bracket, secure with self tapping screen provided.
11. Install front screen of the CPS unit; tighten all bolts and screws to assure a tight fit.



14000 E. Valley Blvd  
City of Industry, CA 91746  
(877) 4-Storm (877) 477-7669  
Fax: (626) 961-3108

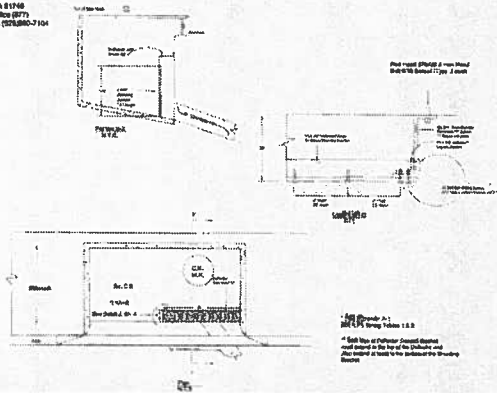

\* See Appendix A-1 and CPS using Tables 1 & 2

DATE	
PROJECT	
LOCATION	
SCALE	
DESIGNED BY	
CHECKED BY	
APPROVED BY	
DATE	



14000 E. Valley Blvd  
City of Industry, CA 91746  
(877) 4-Storm (877) 477-7669  
Fax: (626) 961-3108

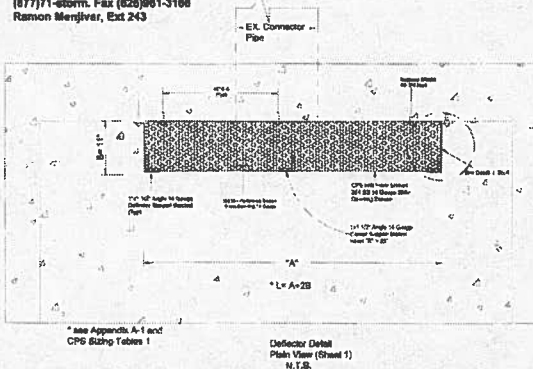

\* See Appendix A-1 and CPS using Tables 1 & 2

DATE	
PROJECT	
LOCATION	
SCALE	
DESIGNED BY	
CHECKED BY	
APPROVED BY	
DATE	

United Storm Water- CPS Technical Manual

Preventive Maintenance:

Maintenance crews should regularly check catch basins and establish a maintenance schedule based on the level of debris collected. Storm season will require more frequent cleaning than other. Catch basins should be cleaned of debris to allow for water to freely flow through the screen. Pressure-washing the unit may additionally benefit but is not necessary.

Yearly Maintenance Schedule:

Visual Inspection:

1. Build-up debris and foreign object debris can hinder the unit's operation. Remove any visible debris that may be on, in front of, and nearby the unit.
2. Look for any visible signs of vandalism or damage that may compromise the unit's ability to properly function. Attempted vandalism and slight damage should be inspected closely to ensure no future damage may result.

Replacement Schedule:

All components on United Storm Water Connector Pipe Screen are made from 304 stainless steel. Unless the unit is severely damaged, e.g., vandalism, etc., no scheduled replacement is required. United Storm Water, Inc. should be notified if a replacement is required.

Tools Required:

For removal of United Storm Water Connector Pipe Screen, use a 3/16" socket wrench to remove the anchor bolt nuts. A socket extension may be needed for hard to reach areas.

Removal and Reassembly:

For removal of United Storm Water Connector Pipe Screen, use a 3/16" socket to remove the anchor bolt nuts. A socket extension may be needed for hard to reach areas. Carefully remove the wall space of anchor bolt nuts from removed. Realign the unit on the anchor bolts and securely tighten anchor bolt nuts for reassembly.

For removal of the Deflector United Storm Water Connector Pipe Screen, use a 3/16" socket wrench to remove the anchor bolt nuts. Realign the bypass section and tighten the screws for reassembly.

UNITED STORM WATER, INC.  
CONNECTOR PIPE SCREEN DETAILS  
NTS

REVISION #		SYMBOL		DESCRIPTION OF CHANGE		APPROVED	DATE	PROJECT ENGINEER	DATE	CITY OF AGOURA HILLS APPROVAL				
										RAMIRO ADEVA	DATE	8/30/14	EXP. DATE	CITY OF AGOURA HILLS DWG. NO.
										CITY ENGINEER				SHEET 7 OF 13

\\ps01-ds\hills\201408\Roadside Bridge Widening\2014-08-25\2014-Plan\4-30001.dwg - 7/28/2014 2:41 PM





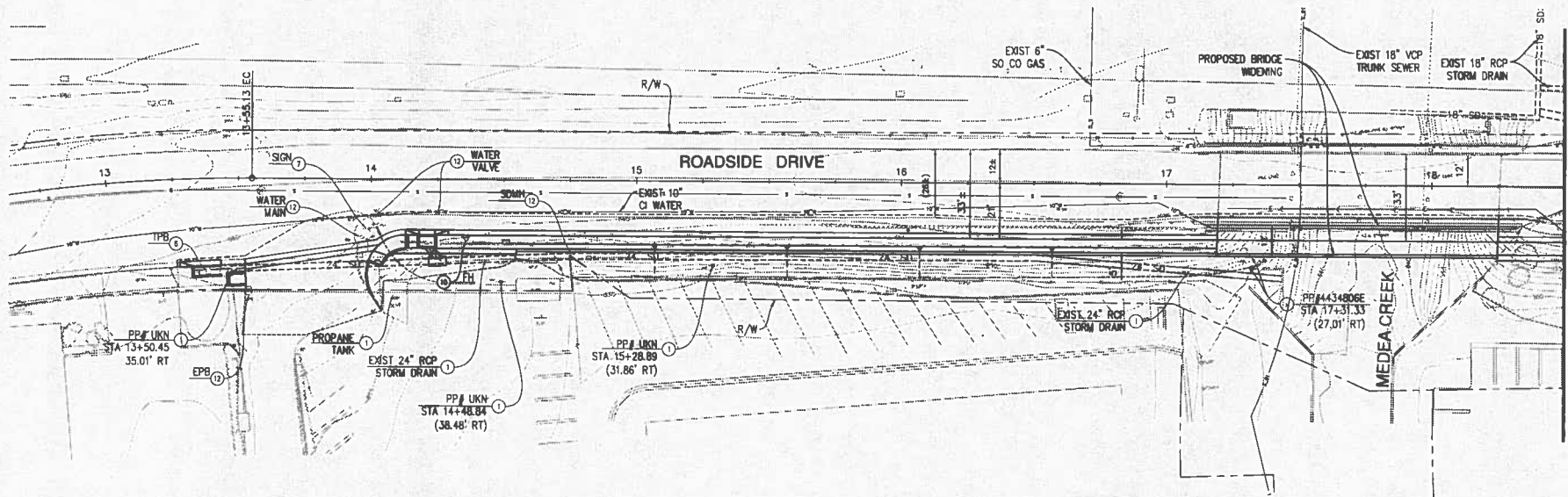

MATCH LINE 18+50  
SEE BELOW

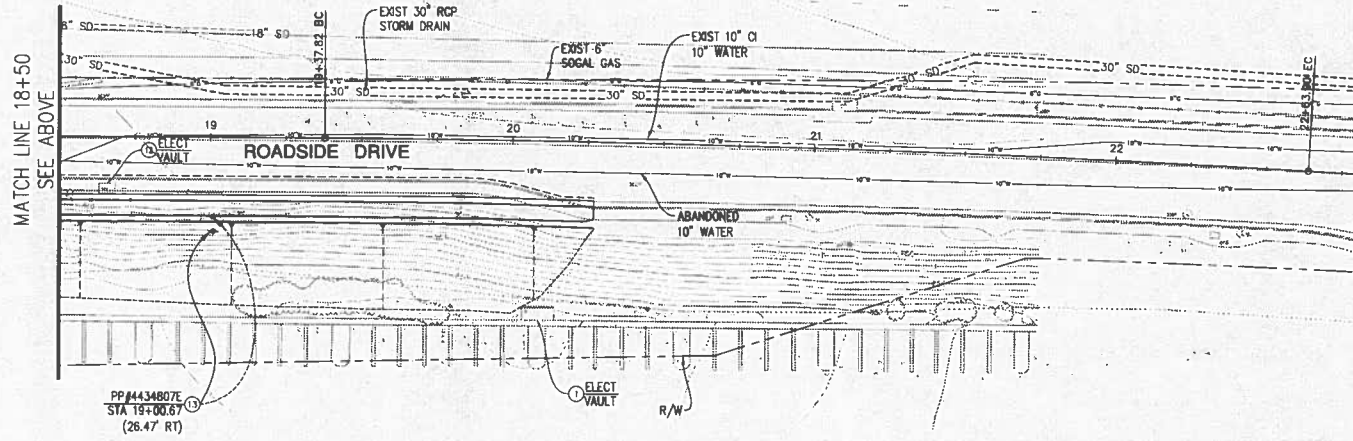

MATCH LINE 18+50  
SEE ABOVE

**CONSTRUCTION NOTES**

- ① PROTECT IN PLACE
- ⑥ RELOCATE
- ⑦ REMOVE
- ⑩ RELOCATE AND REPLACE ASSEMBLY AND UPGRADE TO XXXX
- ⑫ ADJUST TO GRADE
- ⑬ REMOVE AND REPLACE

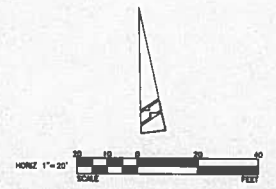

				PREPARED BY:		CITY OF AGOURA HILLS APPROVAL				
				PROJECT ENGINEER	DATE	REVIEWED BY	DATE	DATE	DATE	DATE
REVISION #	SYMBOL	DESCRIPTION OF CHANGE	APPROVED	DATE	PROJECT ENGINEER	DATE	REVIEWED BY	DATE	DATE	DATE



CITY OF AGOURA HILLS  
ROADSIDE DRIVE BRIDGE WIDENING  
UTILITIES

SHEET 9 OF 13

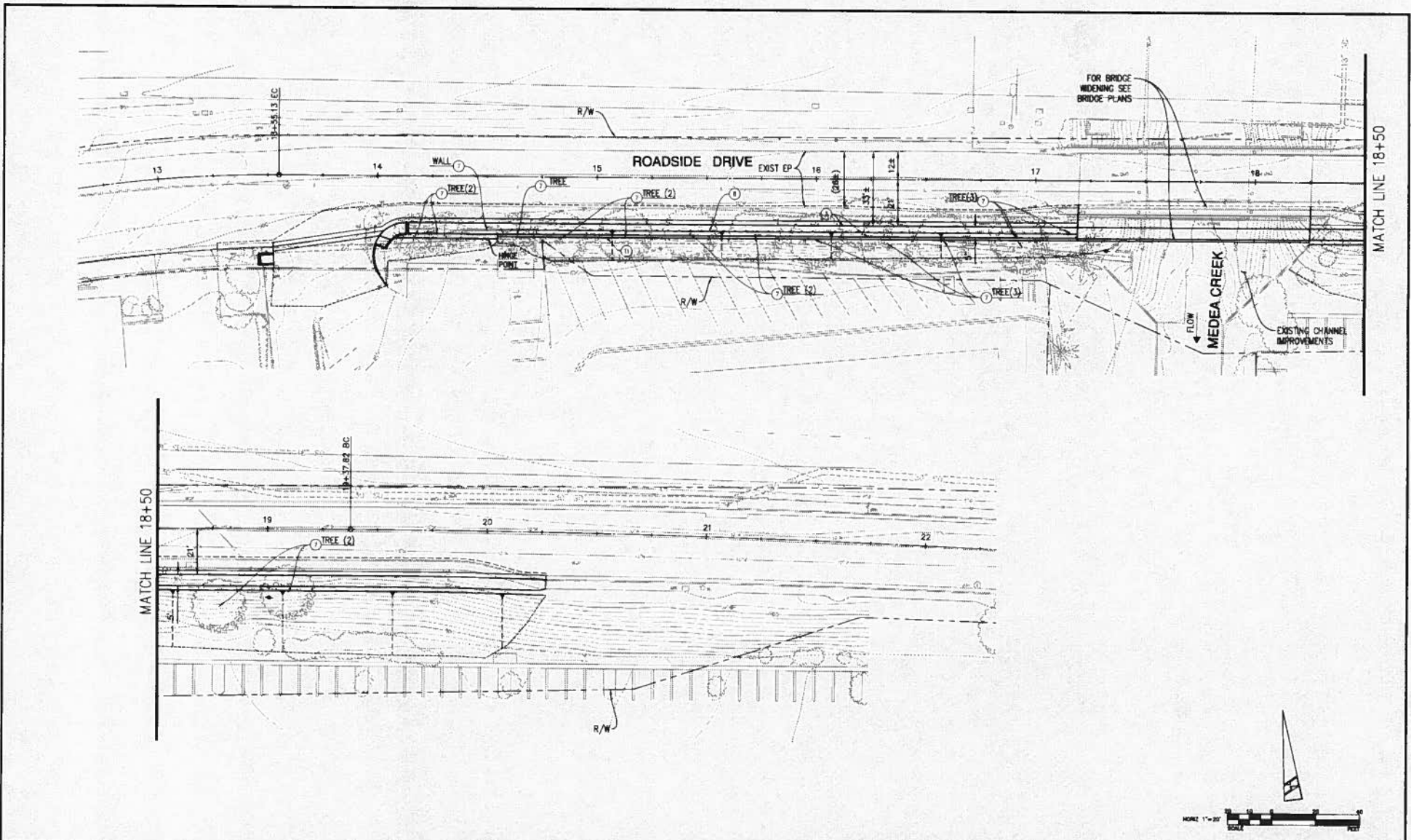

				PREPARED BY:		CITY OF AGOURA HILLS APPROVAL				
				PROJECT ENGINEER		REVIEWED BY		RAMIRO ADEVA CITY ENGINEER		DATE
REVISION #	SYMBOL	DESCRIPTION OF CHANGE	APPROVED	DATE	DATE	DATE	DATE	DATE	DATE	DATE

\\s01-dp\2014\10488 Roadside Drive Widening\100-Route + 100\100-Plan\100-LANDSCAPE - 1/20/2014 4:27 PM



CITY OF AGOURA HILLS  
ROADSIDE DRIVE BRIDGE WIDENING  
LANDSCAPE PLAN

SHEET 10 OF 13

CITY OF AGOURA HILLS DWG. NO.

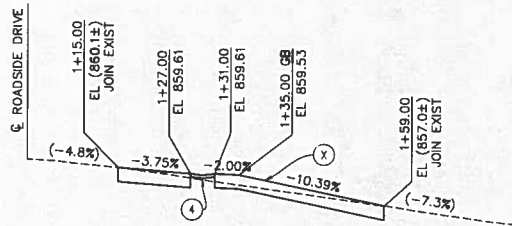

**DRIVEWAY PROFILE**  
SCALE: HORIZ 1"=10'  
VERT 1"=5'

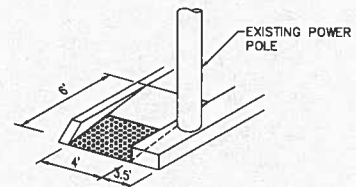

**CURB RAMP DETAIL "A"**  
**CASE D TYPE 2 [MOD]**  
NO SCALE

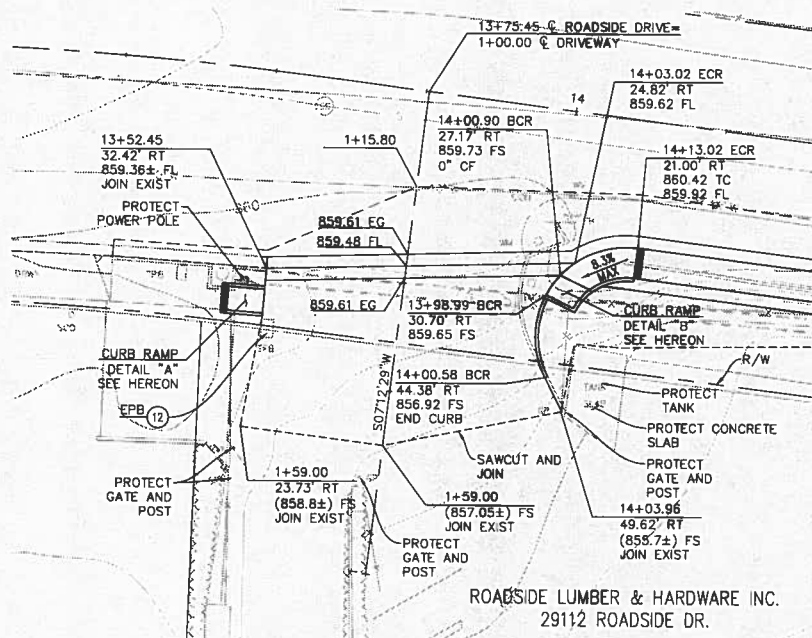

**DRIVEWAY PLAN**  
SCALE: 1"=10'

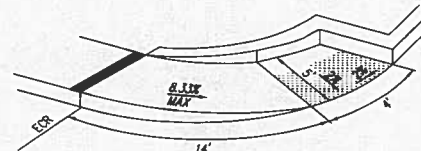

**CURB RAMP DETAIL "B"**  
**CASE B TYPE 1 [MOD]**  
NO SCALE

REVISION #	SYMBOL	DESCRIPTION OF CHANGE	APPROVED	DATE	PROJECT ENGINEER	DATE	REVIEWED BY	DATE	CITY OF AGOURA HILLS APPROVAL	DATE



CITY OF AGOURA HILLS  
ROADSIDE DRIVE BRIDGE WIDENING  
CONSTRUCTION DETAILS 1  
SHEET 11 OF 13

\\net-01\p0001\0048 Roadside Bridge Widening\000-Roadway\001\011-Plan\1-DR.Dwg - 7/20/14 4:15 PM

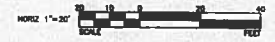
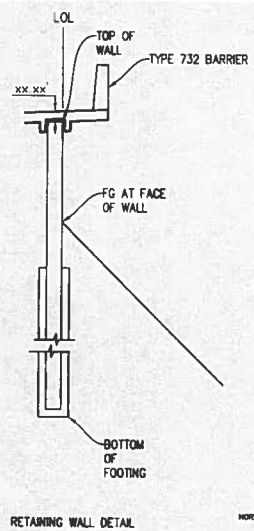
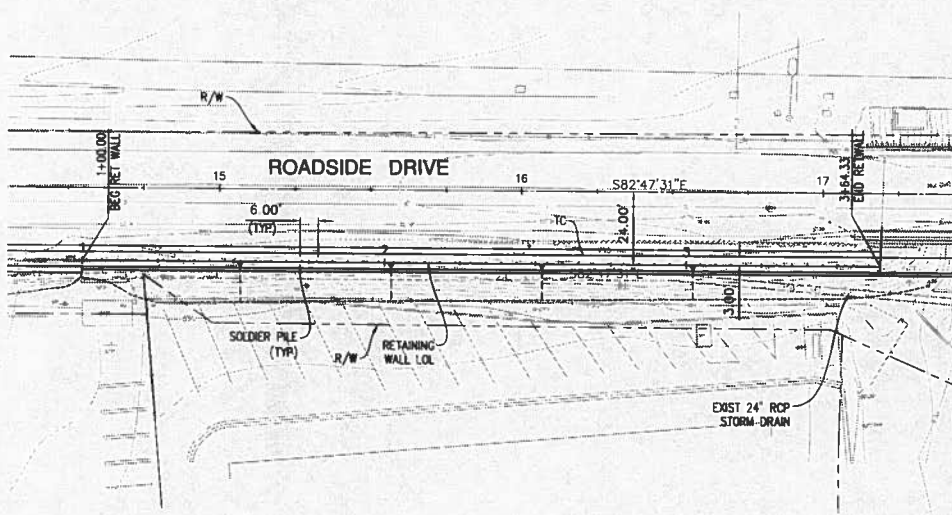
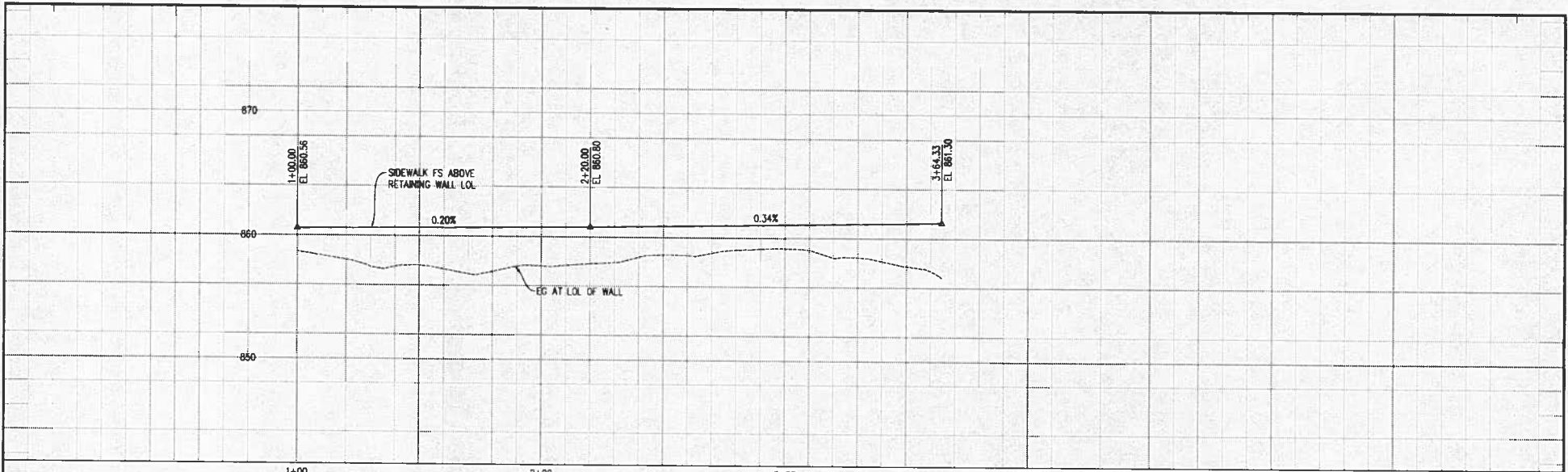

REVISION #	SYMBOL	DESCRIPTION OF CHANGE	APPROVED	DATE

PREPARED BY:		CITY OF AGOURA HILLS APPROVAL			
PROJECT ENGINEER	DATE	REVIEWED BY	DATE	RAMIRO ADEVA CITY ENGINEER	DATE
				68883	8/30/14
				RCE NO.	EXP DATE



CITY OF AGOURA HILLS  
 ROADSIDE DRIVE BRIDGE WIDENING  
 RETAINING WALL PLAN AND PROFILE  
 SHEET 12 OF 13

\\nas-s01\p0001\08100 Roadside Drive Widening\08100-Roadside - 12\1213-Plan\12-RET WALL.dwg - 7/28/2014 4:17 PM

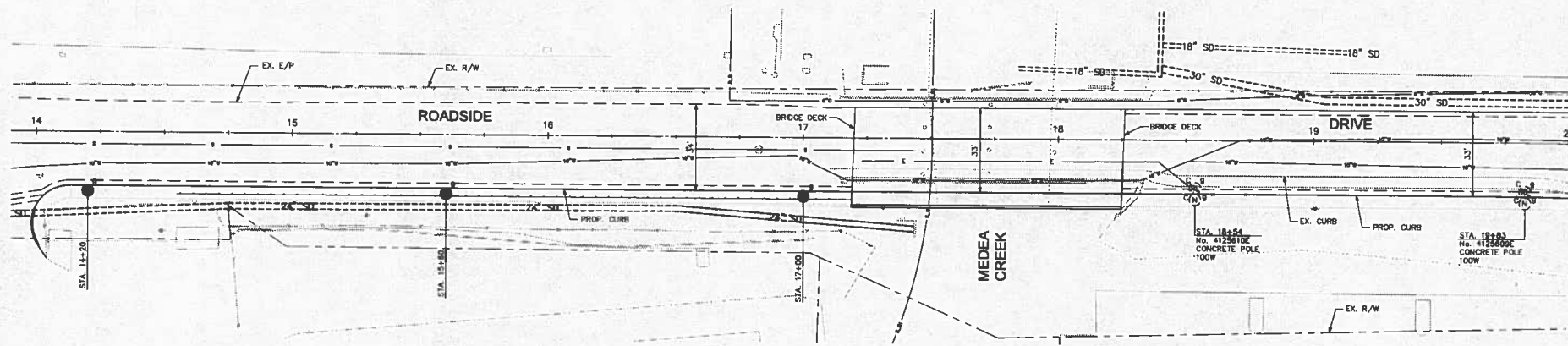

**STREET LIGHTING GENERAL NOTES:**

1. THIS STREET LIGHTING LAYOUT EXPRESSES TWO YEARS AFTER THE LATEST DATE OF APPROVAL.
2. THE LOCATION OF A STREET LIGHT MAY ONLY BE ADJUSTED UP TO 10 FEET, ONLY TO AVOID AN OBSTRUCTION SUCH AS A GATE, BASIN, DRIVEWAY, ETC. ANY DEVIATION EXCEEDING 10 FEET MUST HAVE THE APPROVAL OF THE COUNTY OF LOS ANGELES DEPARTMENT OF PUBLIC WORKS, STREET LIGHTING SECTION. IF SUCH APPROVAL IS NOT OBTAINED, THE LIGHTS PROPOSED BY THIS PLAN WILL NOT BE ACCEPTED BY COUNTY LIGHTING MAINTENANCE DISTRICT.
3. A REVISED STREET LIGHTING LAYOUT SHALL BE SUBMITTED FOR ANY CHANGES IN THE MAP, SUCH AS STREET ALIGNMENT, LOT OR PARCEL SIZES, BOUNDARIES, ETC.
4. THE STREET LIGHT POLES SHALL BE AMERON TYPE 1-C1 SERIES OR AGENCY APPROVED EQUAL.
5. ALL STREET LIGHT WIRING SHALL BE UNDERGROUND.
6. ON STREETS WHERE THE SIDEWALK AND CURB ARE GREATER THAN 5 1/2 FEET IN WIDTH, THE MAST ARMS AND BRACKETS SHALL BE PERPENDICULAR TO THE CURB FACE. THE STREET LIGHTING ELECTRODUK STANDARDS SHALL BE PLACED 24" FROM THE CURB FACE. USE A 4-FOOT LONG MAST ARM FOR 100 WATT LAMPS AND 6-FOOT LONG MAST ARM FOR OTHER WATTAGE, UNLESS OTHERWISE SPECIFIED.
7. ON STREETS WHERE THE SIDEWALK AND CURB ARE LESS THAN OR EQUAL TO 5 1/2 FEET IN WIDTH, THE STREET LIGHTING ELECTRODUK STANDARDS AND PULL BOXES SHALL BE PLACED OUTSIDE OF THE SIDEWALK AREA UNLESS OTHERWISE SPECIFIED. USE AN 8-FOOT LONG MAST ARM FOR ALL WATTAGE, UNLESS OTHERWISE SPECIFIED.
8. ALL LIGHTS SHOWN ON THIS LAYOUT SHALL BE ENERGIZED PRIOR TO ACCEPTANCE OF THE LIGHTING SYSTEM TO A COUNTY LIGHTING DISTRICT.
9. EXISTING STREET LIGHTING SYSTEMS SHALL REMAIN IN OPERATION DURING ANY MODIFICATION. ANY PROPOSED TEMPORARY STREET LIGHTING SYSTEM MUST BE APPROVED BY THE LOS ANGELES COUNTY DEPARTMENT OF PUBLIC WORKS.
10. FIVE-FOOT CLEARANCE TO BE MAINTAINED FROM FIRE HYDRANT.
11. FOUR-FOOT CLEARANCE TO BE MAINTAINED FROM TOP OF SLOPE AT COMMERCIAL DRIVEWAY, AND 2 FOOT CLEARANCE FROM RESIDENTIAL DRIVEWAY.

**DESIGN GUIDELINES**

FOR 9,500 LUMEN LAMPS, THE POLE SPACING IS BASED ON 0.4 FOOTCANDLES, FOR "LOCAL RESIDENTIAL" STREETS. THE LUMINAIRE SHALL HAVE A 25 FOOT MOUNTING HEIGHT, SHALL BE (A.M.S.)-(I.E.S.) MEDIUM FULL-CUT-OFF (FLAT GLASS), TYPE B1, AND EQUIPPED WITH A 100 WATT HIGH PRESSURE SODIUM VAPOR LAMP.

**LEGEND**

- 3 - ● PROPOSED 9,500 LUMEN (100 WATT) H.P.S.V. LAMPS ON CONCRETE POLES.
- EXISTING STREET LIGHT, TYPE OF POLE, SIZE OF LAMP, AND POLE NUMBER AS INDICATED.
- 2 - (RL) ○ EXISTING 9,500 LUMEN LIGHT ON CONCRETE POLE TO BE RELOCATED.
- 2 - (N) ○ NEW LOCATION OF RELOCATED LIGHT.



LOS ANGELES COUNTY DEPARTMENT OF PUBLIC WORKS		
APPROVAL FOR STREET LIGHT RELOCATION BY THE SOUTHERN CALIFORNIA Edison COMPANY		
BY	RCE NO.	DATE

REVISION #		SYMBOL		DESCRIPTION OF CHANGE		APPROVED	DATE	PREPARED BY:	CITY OF AGOURA HILLS APPROVAL			 CITY OF AGOURA HILLS	CITY OF AGOURA HILLS ROADSIDE DRIVE BRIDGE WIDENING STREET LIGHTING LAYOUT SHEET 13 OF 13
								PROJECT ENGINEER	DATE	REVIEWED BY	DATE		

\\sdc-s01\hills\101448 Roadside Drive Widening\1000-Rescopy - 02\103-Plan\10-03.rvt - 7/28/2014 4:12 PM

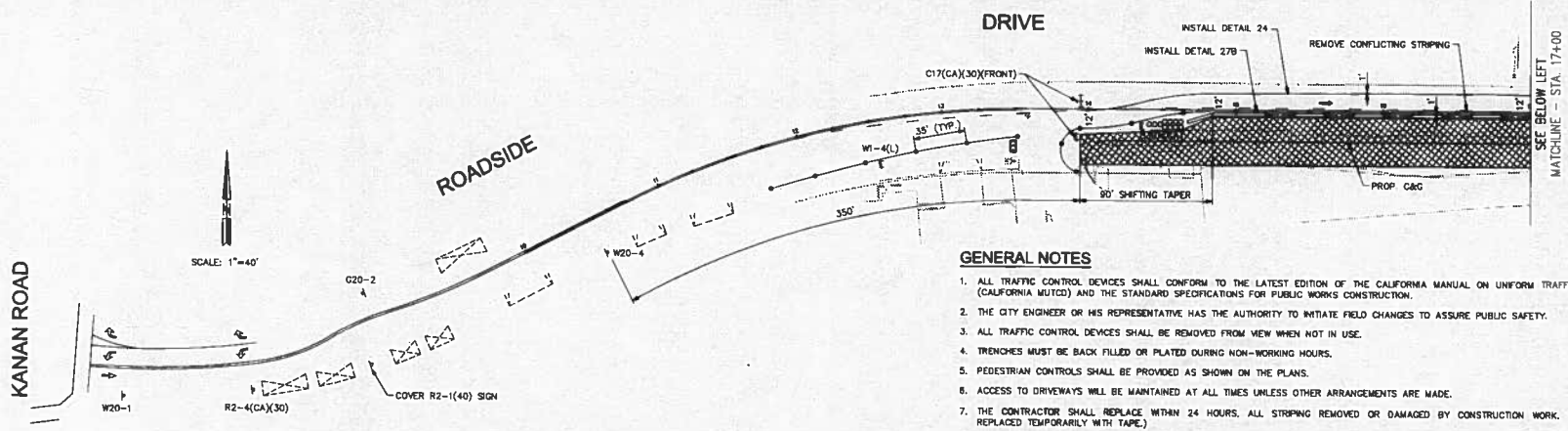

**GENERAL NOTES**

1. ALL TRAFFIC CONTROL DEVICES SHALL CONFORM TO THE LATEST EDITION OF THE CALIFORNIA MANUAL ON UNIFORM TRAFFIC CONTROL DEVICES (CALIFORNIA MUTCD) AND THE STANDARD SPECIFICATIONS FOR PUBLIC WORKS CONSTRUCTION.
2. THE CITY ENGINEER OR HIS REPRESENTATIVE HAS THE AUTHORITY TO INITIATE FIELD CHANGES TO ASSURE PUBLIC SAFETY.
3. ALL TRAFFIC CONTROL DEVICES SHALL BE REMOVED FROM VIEW WHEN NOT IN USE.
4. TRENCHES MUST BE BACK FILLED OR PLATED DURING NON-WORKING HOURS.
5. PEDESTRIAN CONTROLS SHALL BE PROVIDED AS SHOWN ON THE PLANS.
6. ACCESS TO DRIVEWAYS WILL BE MAINTAINED AT ALL TIMES UNLESS OTHER ARRANGEMENTS ARE MADE.
7. THE CONTRACTOR SHALL REPLACE WITHIN 24 HOURS, ALL STRIPING REMOVED OR DAMAGED BY CONSTRUCTION WORK. (STRIPING MAY BE REPLACED TEMPORARILY WITH TAPE).
8. ALL WORKERS SHALL BE EQUIPPED WITH AN ORANGE VEST (OR A REFLECTIVE VEST AT NIGHT). ALL FLAGGERS SHALL ALSO BE EQUIPPED WITH A HARD HAT, C28 "STOP/SLOW" PADDLE AND SHALL BE TRAINED IN THE PROPER FUNDAMENTALS OF FLAGGING TRAFFIC.
9. THE CONTRACTOR SHALL MAINTAIN ALL TRAFFIC CONTROL DEVICES 24 HOURS PER DAY AND 7 DAYS PER WEEK.
10. A MINIMUM OF TWELVE (12) FOOT TRAVEL LANES MUST BE MAINTAINED UNLESS OTHERWISE APPROVED BY THE DEPARTMENT OF PUBLIC WORKS.

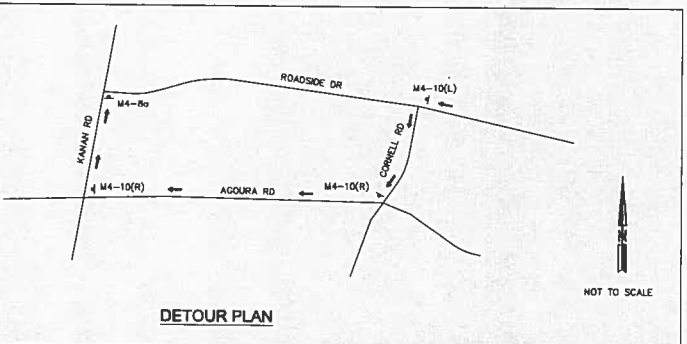
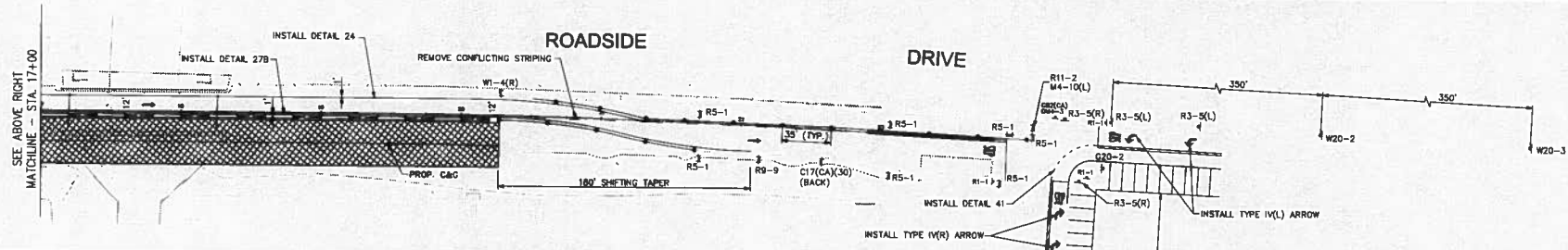

**LEGEND**

	WORK AREA
	TYPE II BARRICADE WITH SIGN
	TYPE III BARRICADE WITH SIGN
	TEMPORARY SIGN (AS NOTED ON PLAN)
	REFLECTORIZED PORTABLE DELINEATOR
	DIRECTION OF TRAVEL (NOT A PHYSICAL INSTALLATION)
	FLASHING ARROW SIGN (FAS)
	TEMPORARY CRASH CUSHION, SAND FILLED ARRAY 'U1', UNLESS OTHERWISE NOTED
	TEMPORARY K-RAIL

PREPARED BY: _____ PROJECT ENGINEER: _____ DATE: _____				CITY OF AGOURA HILLS APPROVAL REVIEWED BY: _____ DATE: _____ RAMIRO ADEVA CITY ENGINEER						<b>CITY OF AGOURA HILLS</b> <b>ROADSIDE DRIVE BRIDGE WIDENING</b> <b>TRAFFIC CONTROL PLAN</b>	
REVISION #	SYMBOL	DESCRIPTION OF CHANGE	APPROVED	DATE	PROJECT ENGINEER	DATE	REVIEWED BY	DATE	RAMIRO ADEVA	DATE	SHEETS 8/30/14 RCE NO. EXP DATE

\\ms-dc1\p0001\00001\Roadside Bridge Widening\100-Reading\02\103-Plan\pl-1078.dwg - 7/26/2014 4:13 PM

**LEGEND**

- Denotes Existing Structure
- Denotes Proposed Structure
-  Denotes Bridge Removal (Portion)

**NOTES**

- ① Paint "MEDEA CREEK BRIDGE".
- ② Paint "BR NO. 56C0290".
- ③ Remove Concrete Railing and Metal Handrail.
- ④ Refinish Bridge Deck.
- ⑤ Temporary Railing (Type K)

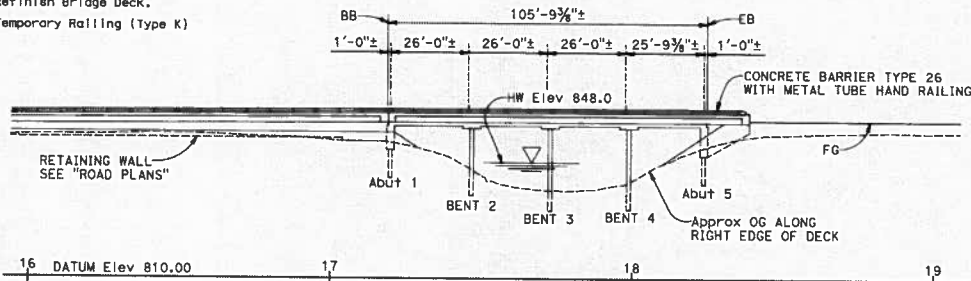

**ELEVATION**  
SCALE: 1" = 20'

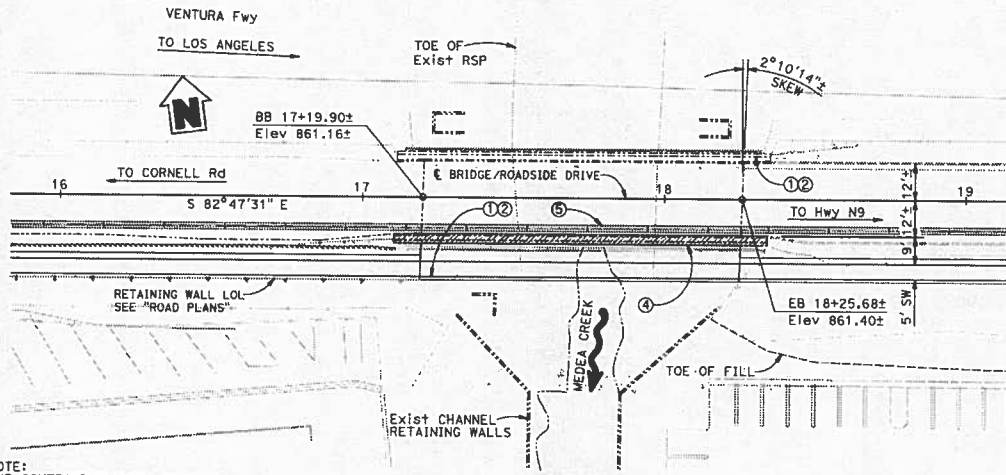

**PLAN**  
SCALE: 1" = 20'

NOTE:  
THE CONTRACTOR SHALL VERIFY ALL CONTROLLING FIELD DIMENSION BEFORE ORDERING OR FABRICATING ANY MATERIAL.

**INDEX TO PLANS**

SHEET No.	TITLE
1	GENERAL PLAN
2	DECK CONTOURS
3	FOUNDATION PLAN
4	ABUTMENT 1 LAYOUT
5	ABUTMENT 5 LAYOUT
6	ABUTMENT DETAILS NO. 1
7	PIER LAYOUT
8	COLUMN CASING - STEEL
9	SLAB BRIDGE PILE DETAILS
10	SLAB REINFORCEMENT DETAILS NO. 1
11	SLAB REINFORCEMENT DETAILS NO. 2
12	LOG OF TEST BORINGS

DIST	COUNTY	ROUTE	POST MILES TOTAL PROJECT	SHEET No	TOTAL SHEETS
07	LA	LOCAL			

REGISTERED CIVIL ENGINEER X DATE \_\_\_\_\_

PLANS APPROVAL DATE \_\_\_\_\_

*The State of California or its officers or agents shall not be responsible for the accuracy or completeness of scanned copies of this plan sheet.*

Prepared for:  
CITY OF AGOURA HILLS  
30001 LADYFACE COURT  
AGOURA HILLS, CALIFORNIA 93101

Prepared by:  
WILLDAN ENGINEERING  
374 POLI STREET, SUITE 101  
VENTURA, CALIFORNIA 93001

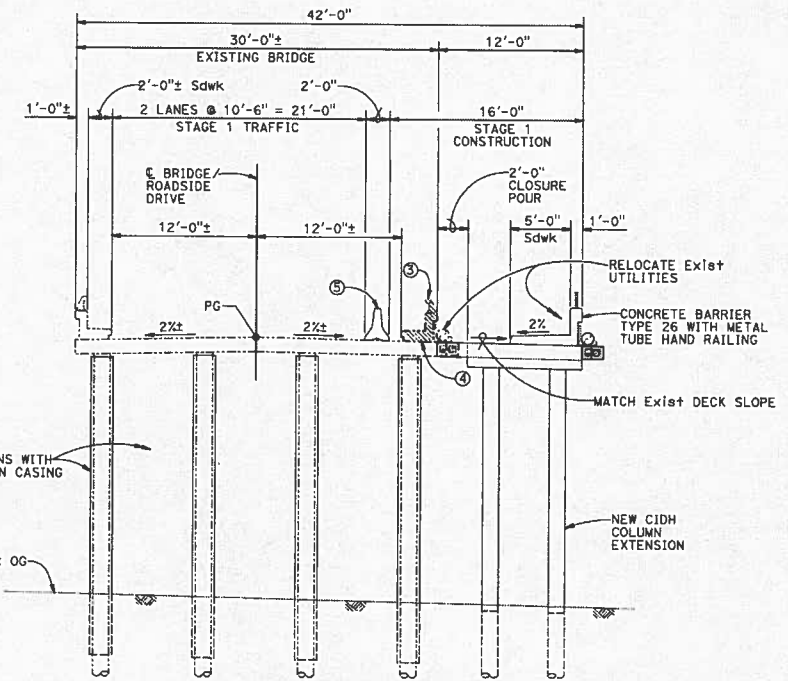



**TYPICAL SECTION**  
SCALE: 1" = 5'

DESIGN OVERSIGHT X	DESIGN BY	J. ENGLAND	CHECKED BY	R. UHLMANN	PROJECT NO.	53C0290	BRIDGE NO. 53C0290	POST MILES X	MEDEA CREEK BRIDGE (WIDENING) GENERAL PLAN
	QUANTITIES BY	X	CHECKED BY	X	PROJECT ENGINEER	JOHN ENGLAND			
SIGN OFF DATE					DEPARTMENT OF TRANSPORTATION				
DESIGN GENERAL PLAN SHEET (ENGLR01) (REV. 03/14/12)					UNIT: PROJECT NUMBER & PHASE: X		CONTRACT NO.: X		DISSEMINATION CONTROL
REVISIONS					FILE # 53C0290-a-gp01.dgn		SHEET 1 OF 12		

USERNAME: P:\R\UNIFORM\PROJ\07\117212013 TIME PLOTTED: 11:01:55 AM

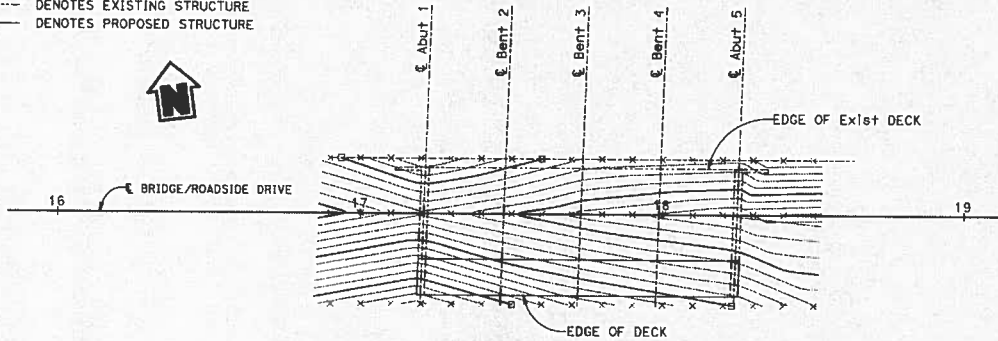
**LEGEND**  
 ----- DENOTES EXISTING STRUCTURE  
 \_\_\_\_\_ DENOTES PROPOSED STRUCTURE



**DECK CONTOURS**

SCALE: 1" = 20'

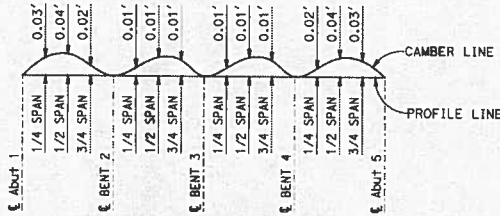

**CAMBER DIAGRAM**

NO SCALE

NOTE: DOES NOT INCLUDE ALLOWANCE FOR FALSEWORK SETTLEMENT.

**APPROXIMATE QUANTITIES**

ITEM CODE	ITEM DESCRIPTION	QUANTITY	UNIT
157560	BRIDGE REMOVAL (PORTION)	X	X
192003	STRUCTURE EXCAVATION		
192032	STRUCTURE EXCAVATION (ROCK SLOPE PROTECTION)		
193003	STRUCTURE BACKFILL (BRIDGE)		
490376	FURNISH PILING (CLASS 90)		
490746	FURNISH PILING (CLASS 140)		
510053	STRUCTURAL CONCRETE, BRIDGE		
510086A	STRUCTURAL CONCRETE, APPROACH SLAB TYPE N(300)		
511106	DRILL AND BOND DOWEL		
519091	JOINT SEAL (TYPE A)		
520101	BAR REINFORCING STEEL (BRIDGE)		
721016	ROCK SLOPE PROTECTION (LIGHT, METHOD B)		
729012	ROCK SLOPE PROTECTION FABRIC (CLASS 10)		
833092	METAL TUBE HAND RAILING		
833140	CONCRETE BARRIER (TYPE 26)		

NOTE:  
 THE CONTRACTOR SHALL VERIFY  
 ALL CONTROLLING FIELD DIMENSION  
 BEFORE ORDERING OR FABRICATING  
 ANY MATERIAL.

**NOTES:**

1. Contour indicate top of deck elevation.
2. □ Indicates even 0.25 foot contours.
3. X Indicates 10' intervals measured along "B" Line.
4. Contour interval = 0.05'
5. Contours do not include allowances for camber or falsework settlement.

DIST	COUNTY	ROUTE	POST MILES TOTAL PROJECT	SHEET No	TOTAL SHEETS
07	LA	LOCAL			

REGISTERED CIVIL ENGINEER DATE \_\_\_\_\_ X  
 PLANS APPROVAL DATE \_\_\_\_\_  
 The State of California or its officers or agents shall not be responsible for the accuracy or completeness of scanned copies of this plan sheet.  
 REGISTERED PROFESSIONAL ENGINEER  
 CIVIL  
 STATE OF CALIFORNIA

Prepared for:  
 CITY OF AGOURA HILLS  
 30001 LADYFACE COURT  
 AGOURA HILLS, CALIFORNIA 93101  
 Prepared by:  
 WILLIAMS ENGINEERING  
 374 POLI STREET, SUITE 101  
 VENTURA, CALIFORNIA 93001

**GENERAL NOTES  
 LOAD AND RESISTANCE FACTOR DESIGN**

DESIGN : AASHTO LRFD Bridge Design Specifications, 4th Edition and with Caltrans Amendments, preface dated September 2010; except Type 215 Metal Tube Bridge Railing.

SEISMIC DESIGN: Caltrans Seismic Design Criteria (SDC), Version 1.6 dated November 2010.

DEAD LOAD: Includes 35 psf for future wearing surface.

LIVE LOADING: HL93 and permit design load.

SEISMIC LOADING: Soil Profile: Moment Magnitude: Peak Ground Acceleration = 0.36 g

REINFORCED CONCRETE:  $f_y = 60$  ksi  
 $f'_c = 4.0$  ksi (Superstructure)  
 $f'_c = 3.5$  ksi (Substructure)

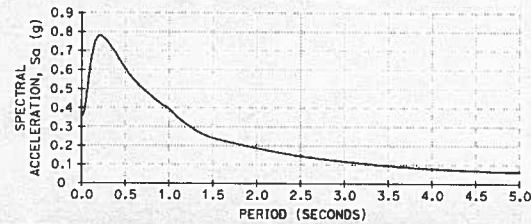

**ACCELERATION RESPONSE SPECTRUM CURVE**

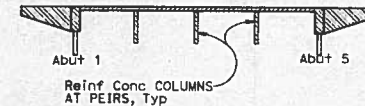

- STRUCTURAL CONCRETE BRIDGE 3.5 ksi AT 28 DAYS
- STRUCTURAL CONCRETE BRIDGE 4 ksi AT 28 DAYS

**CONCRETE STRENGTH AND TYPE LIMITS**

NO SCALE

X	DESIGN OVERSIGHT
X	STAMP OFF DATE

DESIGN DETAIL SHEET (ENGLISH) (REV. 03/14/12)

DESIGN	BY J. ENGLAND	CHECKED X
DETAILS	BY R. UHLMANN	CHECKED X
QUANTITIES	BY X	CHECKED X

PREPARED FOR THE  
 STATE OF CALIFORNIA  
 DEPARTMENT OF TRANSPORTATION

JOHN ENGLAND  
 PROJECT ENGINEER

BRIDGE NO.	530290
POST MILES	X

**MEDEA CREEK BRIDGE (WIDENING)  
 DECK CONTOURS**

PRINTING SCALE IN INCHES FOR REDUCED PLANS

0 1 2 3

UNIT: PROJECT NUMBER & PHASE: X  
 FILE => 530290-d-dc01.dgn

CONTRACT NO.: X

DISMISSED PRINTS BEARING EARLIER REVISION DATES	PERMITTED DATES	SHEET 2	OF 12
---	-----------------	---------	-------

DATE PLOTTED: 03/11/2013 10:11:25 AM



**BENCH MARK**

LACBM No. 10004 (MALIBU QUAD)  
 ELEV=877.40 (NAVD '88, 2008 ADJ.)  
 RDBM TAG IN W CB 2' N/O BCR @  
 NW COR KANAN RD & AGOURA RD.

**BASIS OF BEARING**

CALIFORNIA STATE PLANE ZONE 5,  
 NAD 1983 (2007 EPOCH)

**HYDROLOGIC SUMMARY**

DRAINAGE AREA XX.X SQ MI	DESIGN FLOOD	BASE FLOOD	OVERTOPPING FLOOD	RECORD FLOOD
FREQUENCY, YEARS	50	100	X	X
DISCHARGE CUBIC FT/SEC.	X	X	X	X
WATER SURFACE ELEVATION AT BRIDGE	X	X	X	X

NOTE:  
 Flood Plain Data is based upon information available when the plans were prepared and are shown to meet Federal requirements. The accuracy of said information is not warranted by the Designer and interested or affected parties should make their own investigation.

**LEGEND**

- DENOTES EXISTING STRUCTURE
- DENOTES PROPOSED STRUCTURE
- o DENOTES EXISTING PILES
- o DENOTES CLASS 90 OR CLASS 140 PILES

**NOTES**

1. Utility relocation not shown. Utilities in conflict with piles will be relocated for bridge construction.

DIST	COUNTY	ROUTE	POST MILES TOTAL PROJECT	SHEET No	TOTAL SHEETS
07	LA	LOCAL			

REGISTERED CIVIL ENGINEER DATE X

PLANS APPROVAL DATE

The State of California or its officers or agents shall not be responsible for the accuracy or completeness of scanned copies of this plan sheet.



Prepared for:  
 CITY OF AGOURA HILLS  
 30001 LADYFACE COURT  
 AGOURA HILLS, CALIFORNIA 93101

Prepared by:  
 WILLDAN ENGINEERING  
 374 POLI STREET, SUITE 101  
 VENTURA, CALIFORNIA 93001

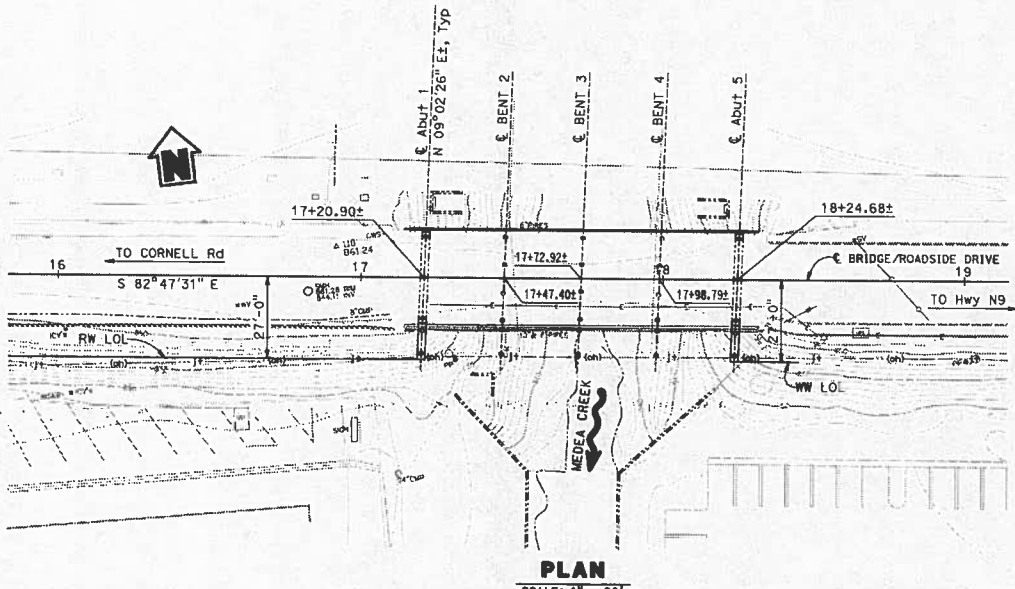

**PILE DATA TABLE**

LOCATION	PILE TYPE	DESIGN LOADING (SERVICE)	NOMINAL RESISTANCE		DESIGN TIP ELEV* (FEET)	SPECIFIED TIP ELEV (FEET)
			COMPRESSION	TENSION		
Abut 1	CLASS 90	140 kips	280 kips	0	XXX.0 (1), XXX.0 (3)	XXX.0
BENT 2	CLASS 140	140 kips	280 kips	0	XXX.0 (1), XXX.0 (3)	XXX.0
BENT 3	CLASS 140	140 kips	280 kips	0	XXX.0 (1), XXX.0 (3)	XXX.0
BENT 4	CLASS 140	140 kips	280 kips	0	XXX.0 (1), XXX.0 (3)	XXX.0
Abut 5	CLASS 90	140 kips	280 kips	0	XXX.0 (1), XXX.0 (3)	XXX.0

\* DESIGN TIP ELEVATION IS CONTROLLED BY THE FOLLOWING DEMANDS:  
 (1) COMPRESSION, (2) TENSION, (3) LATERAL LOADS, (4) SETTLEMENT

NOTE:  
 THE CONTRACTOR SHALL VERIFY ALL CONTROLLING FIELD DIMENSION BEFORE ORDERING OR FABRICATION ANY MATERIAL.

DESIGN OVERSIGHT	SCALE: 1"=20'	VERT. DATUM NAVD83	HORIZ. DATUM NAD83	DESIGN BY J. ENGLAND	CHECKED X	<b>PREPARED FOR THE STATE OF CALIFORNIA</b> DEPARTMENT OF TRANSPORTATION	BRIDGE NO. 53C0290	<b>MEDEA CREEK BRIDGE (WIDENING)</b> FOUNDATION PLAN
PHOTOGRAMMETRY AS OF: X	ALIGNMENT TIES X	DESIGN BY R. UHLMANN	CHECKED X	PROJECT ENGINEER JOHN ENGLAND	POST MILES X			
SURVEYED BY X	DRAFTED BY X	QUANTITIES BY X	CHECKED X					
FIELD CHECKED BY X	CHECKED BY X							
FOUNDATION PLAN SHEET (ENGLISH) (REV. 03/14/12)				UNIT: PROJECT NUMBER & PHASE: X	CONTRACT NO.: X	DATE: 11/21/2013	SHEET 3 OF 12	

USERNAME: s3x UNIFORM.DWG PLOTTED AS: 11/21/2013 11:41:40 AM

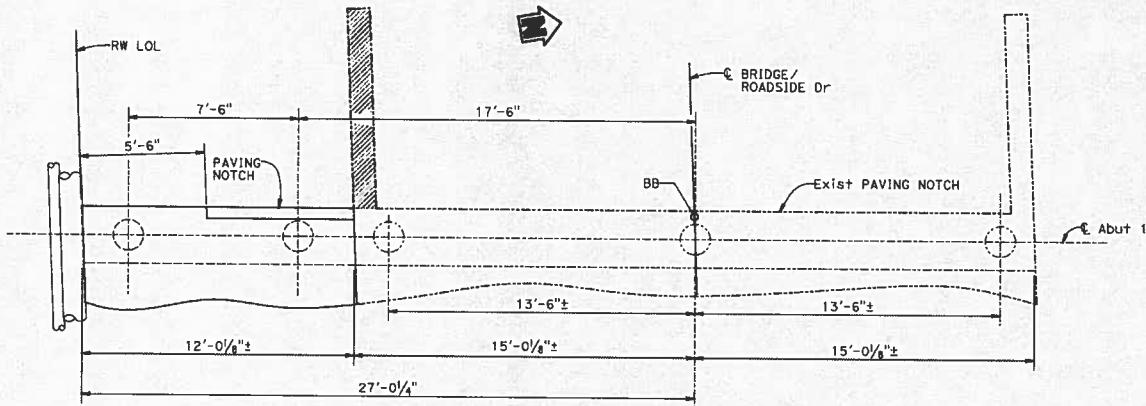

**PLAN**  
SCALE: 3/8" = 1'-0"  
B0-1

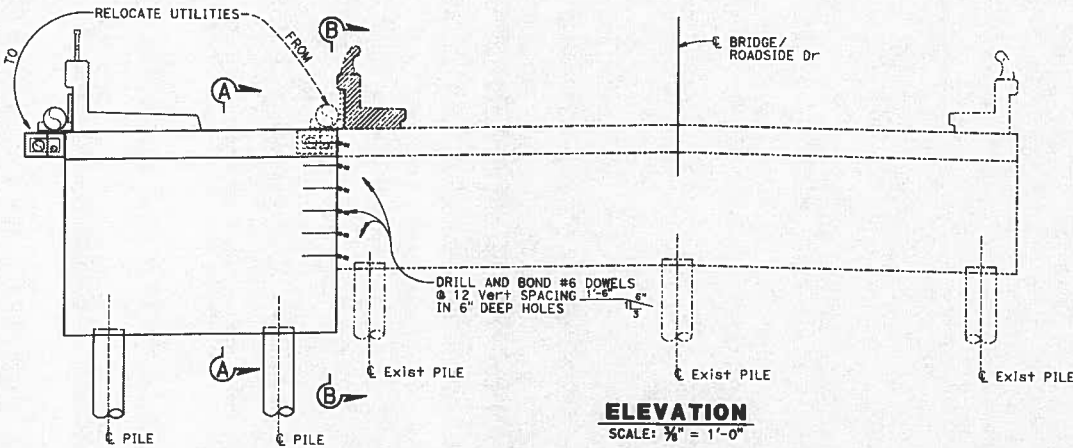

**ELEVATION**  
SCALE: 3/8" = 1'-0"

**LEGEND**

- Denotes Existing Structure
- Denotes Proposed Structure
- ▨ Denotes Bridge Removal (Portion)

**NOTES**

1. For SECTION B-B see "ABUTMENT DETAILS NO. 1" SHEET.
2. For Retaining Wall Details, see "ROADWAY" plans.

DIST	COUNTY	ROUTE	POST MILES TOTAL PROJECT	SHEET No	TOTAL SHEETS
07	LA	LOCAL			

REGISTERED CIVIL ENGINEER	X	DATE	
PLANS APPROVAL DATE			
The State of California or its officers or agents shall not be responsible for the accuracy or completeness of scanned copies of this plan sheet.			

Prepared for:  
CITY OF AGOURA HILLS  
30001 LADYFACE COURT  
AGOURA HILLS, CALIFORNIA 93101

Prepared by:  
WILLDAN ENGINEERING  
374 POLI STREET, SUITE 101  
VENTURA, CALIFORNIA 93001

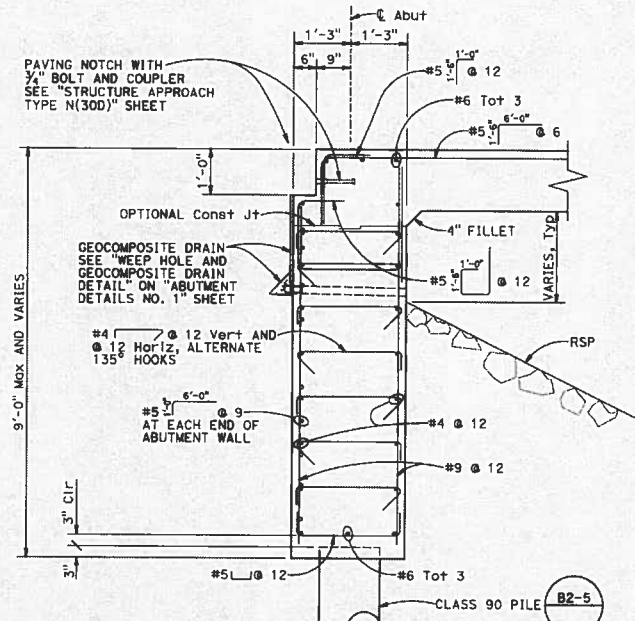

**SECTION A-A**  
SCALE: 3/4" = 1'-0"  
B2-5

NOTE:  
THE CONTRACTOR SHALL VERIFY ALL CONTROLLING FIELD DIMENSION BEFORE ORDERING OR FABRICATION ANY MATERIAL.

X	DESIGN OVERSIGHT
X	SIGN OFF DATE

DESIGN	BY J. ENGLAND	CHECKED X
DETAILS	BY R. UHLMANN	CHECKED X
QUANTITIES	BY X	CHECKED X

PREPARED FOR THE  
STATE OF CALIFORNIA  
DEPARTMENT OF TRANSPORTATION

PROJECT ENGINEER	JOHN ENGLAND
BRIDGE NO.	53C0290
POST MILES	X

**MEDEA CREEK BRIDGE (WIDENING)**  
**ABUTMENT 1 LAYOUT**

DESIGN DETAIL SHEET (ENGLISH) (REV. 03/14/12)

OVERALL SCALE IN DIMENSIONS FOR REVISION PLANS

UNIT: X  
PROJECT NUMBER & PHASE: X  
FILE => 53C0290-7-001\_101.dgn

CONTRACT NO.: X

DISSEMINATION PRIORITY BEARING  
LARGER REVISION DATES

REVISION DATES				
SHEET	4	OF	12	

DATE PLOTTED: 11/27/2013 10:23:35 AM  
USER: NAME: 05-R UNIMP/DATE PLOTTED: 11/27/2013

**LEGEND**

- Denotes Existing Structure
- Denotes Proposed Structure
- ▨ Denotes Bridge Removal (Portion)

**NOTES**

1. For SECTION B-B see "ABUTMENT DETAILS NO. 1" sheet.
2. For WINGWALL ELEVATION, see "ABUTMENT DETAILS NO. 1" sheet.

DIST	COUNTY	ROUTE	POST MILES TOTAL PROJECT	SHEET NO.	TOTAL SHEETS
07	LA	LOCAL			

REGISTERED CIVIL ENGINEER	X	DATE	
			
PLANS APPROVAL DATE			

Prepared for:  
 CITY OF AGOURA HILLS  
 30001 LADYFACE COURT  
 AGOURA HILLS, CALIFORNIA 93101

Prepared by:  
 WILLDAN ENGINEERING  
 374 POLI STREET, SUITE 101  
 VENTURA, CALIFORNIA 93001

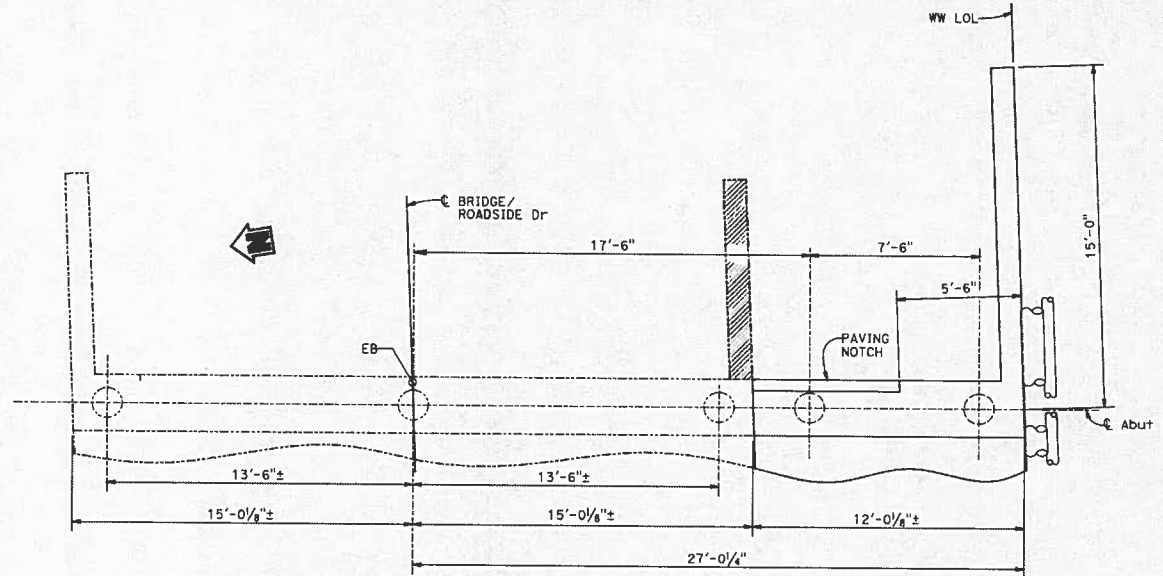

Note: Dimensions are measured along  $\epsilon$  of abutment.

**PLAN**  
 SCALE:  $\frac{3}{8}$ " = 1'-0"  
 B0-1

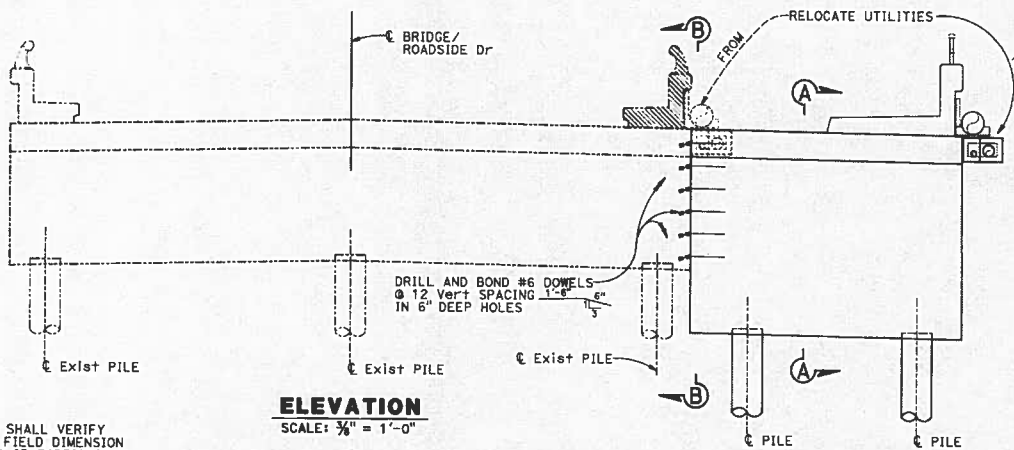

**ELEVATION**  
 SCALE:  $\frac{3}{8}$ " = 1'-0"

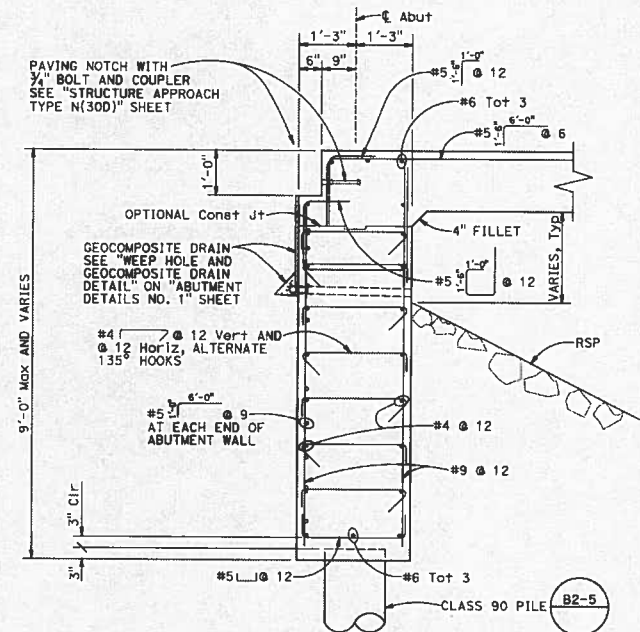

**SECTION A-A**  
 SCALE:  $\frac{3}{4}$ " = 1'-0"

NOTE:  
 THE CONTRACTOR SHALL VERIFY ALL CONTROLLING FIELD DIMENSION BEFORE ORDERING OR FABRICATING ANY MATERIAL.

X	DESIGN OVERSIGHT
X	SIGN OFF DATE

DESIGN	BY J. ENGLAND	CHECKED X
DETAILS	BY R. UHLMANN	CHECKED X
QUANTITIES	BY X	CHECKED X

PREPARED FOR THE  
 STATE OF CALIFORNIA  
 DEPARTMENT OF TRANSPORTATION

PROJECT ENGINEER	JOHN ENGLAND
BRIDGE NO.	5300290
POST MILES	X

**MEDEA CREEK BRIDGE (WIDENING)  
 ABUTMENT 5 LAYOUT**

OPTIONAL SCALE IN INCHES FOR REVISION PLANS



UNIT: PROJECT NUMBER & PHASE: X CONTRACT NO.: X

DATE	BY	DATE	BY	SHEET	OF
				5	12

FILE => 5300290-7-001.105.dgn

FILE PLOTTED 10:24:21 AM

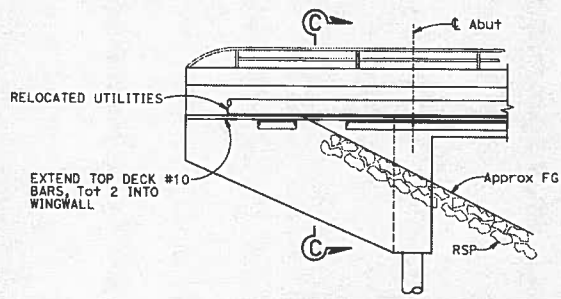

**WINGWALL ELEVATION**  
SCALE: 1/4" = 1'-0" (80-1)

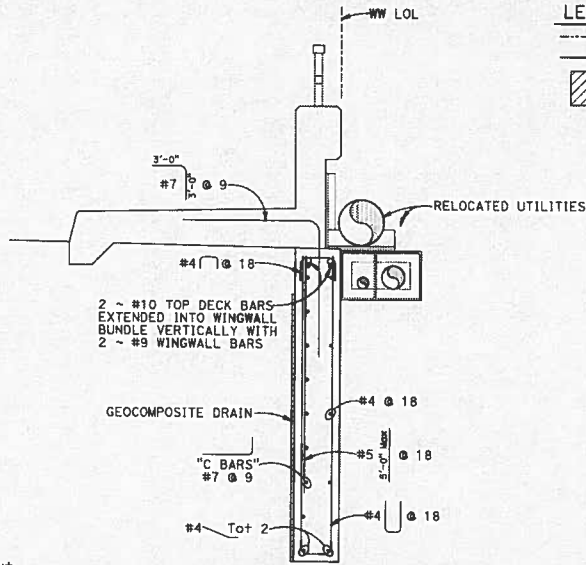

**SECTION C-C**  
SCALE: 3/4" = 1'-0"

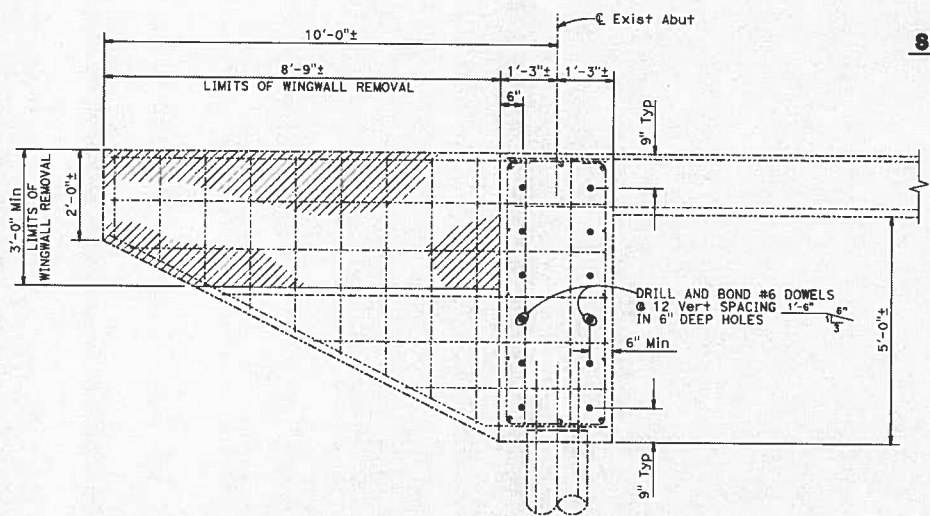

**SECTION B-B**  
SCALE: 3/4" = 1'-0"

**LEGEND**  
 - - - - - Denotes Existing Structure  
 ——— Denotes Proposed Structure  
 ▨ Denotes Bridge Removal (Portion)

DIST	COUNTY	ROUTE	POST MILES TOTAL PROJECT	SHEET No	TOTAL SHEETS
07	LA	LOCAL			

REGISTERED CIVIL ENGINEER X DATE  
 PLANS APPROVAL DATE  
 The State of California or its officers or agents shall not be responsible for the accuracy or completeness of scanned copies of this plan sheet.



Prepared for:  
 CITY OF AGOURA HILLS  
 30001 LADYFACE COURT  
 AGOURA HILLS, CALIFORNIA 93101  
 Prepared by:  
 WILLDAN ENGINEERING  
 374 POLI STREET, SUITE 101  
 VENTURA, CALIFORNIA 93001

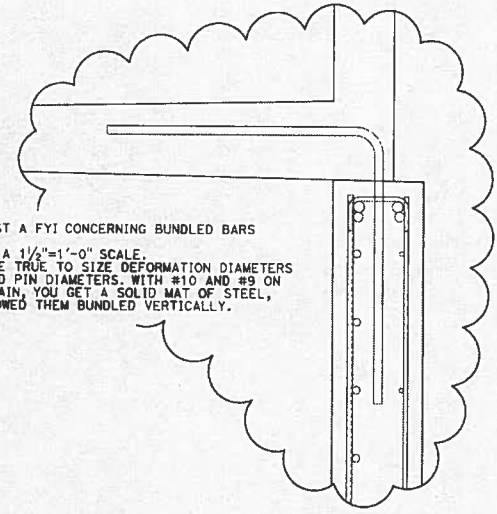

JOE, JUST A FYI CONCERNING BUNDLED BARS  
 THIS IS A 1/2"=1'-0" SCALE.  
 BARS ARE TRUE TO SIZE DEFORMATION DIAMETERS AND BEND PIN DIAMETERS. WITH #10 AND #9 ON SAME PLAIN, YOU GET A SOLID MAT OF STEEL, SO I SHOWED THEM BUNDLED VERTICALLY.

NOTE:  
 THE CONTRACTOR SHALL VERIFY ALL CONTROLLING FIELD DIMENSION BEFORE ORDERING OR FABRICATION ANY MATERIAL.

X	DESIGN OVERSIGHT
X	SIGN OFF DATE

DESIGN BY	J. ENGLAND	CHECKED	X
DETAILS BY	R. UHLMANN	CHECKED	X
QUANTITIES BY	X	CHECKED	X

PREPARED FOR THE  
 STATE OF CALIFORNIA  
 DEPARTMENT OF TRANSPORTATION

JOHN ENGLAND  
 PROJECT ENGINEER

BRIDGE NO.	53C0290
POST MILES	X

**MEDEA CREEK BRIDGE (WIDENING)**  
**ABUTMENT DETAILS NO. 1**

ORIGINAL SCALE IN INCHES FOR REDUCED PLANS

UNIT: X  
 PROJECT NUMBER & PHASE: X  
 FILE => 53C0290-r-0010101.dgn

CONTRACT NO.: X

DATE PLOTTED	11/17/05 AM
DATE	
SHEET OF	6 12

DATE PLOTTED 11/17/05 AM

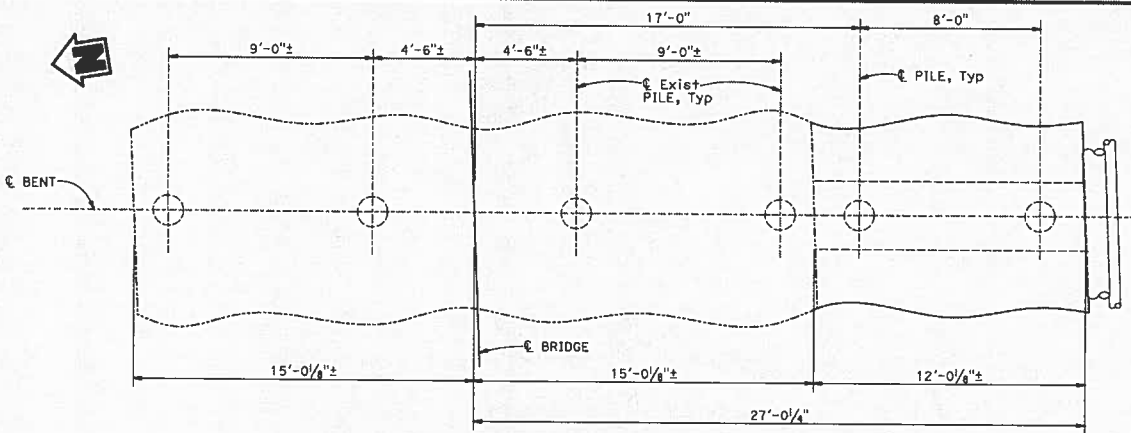

Note: Dimensions are measured along CL of bent.

**PLAN**  
SCALE: 3/8" = 1'-0"

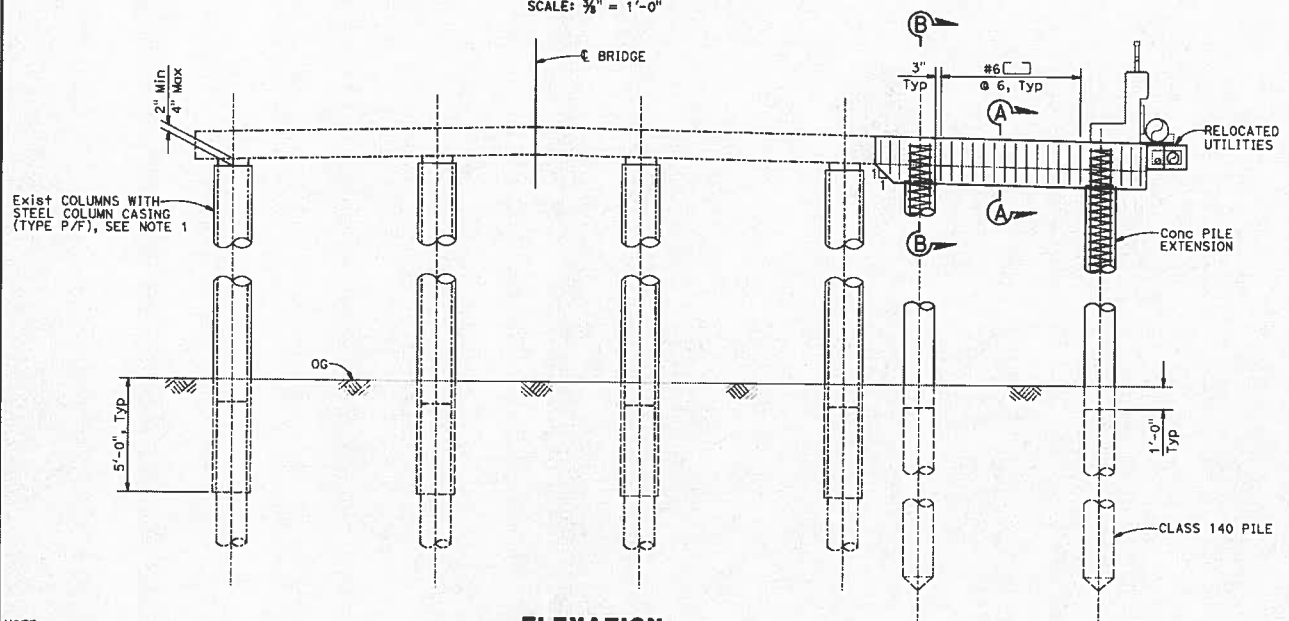

**ELEVATION**  
SCALE: 3/8" = 1'-0"

**LEGEND**

- Denotes Existing Structure
- Denotes Proposed Structure

**NOTES**

- For Steel Column Casing (Type P/F) details not shown see "COLUMN CASING - STEEL" sheet.

DIST	COUNTY	ROUTE	POST MILES TOTAL PROJECT	SHEET NO	TOTAL SHEETS
07	LA	LOCAL			

REGISTERED CIVIL ENGINEER DATE X

PLANS APPROVAL DATE

The State of California or its officers or agents shall not be responsible for the accuracy or completeness of scanned copies of this plan sheet.



Prepared for:  
CITY OF AGOURA HILLS  
30001 LADYFACE COURT  
AGOURA HILLS, CALIFORNIA 93101

Prepared by:  
WILLDAN ENGINEERING  
374 POLI STREET, SUITE 101  
VENTURA, CALIFORNIA 93001

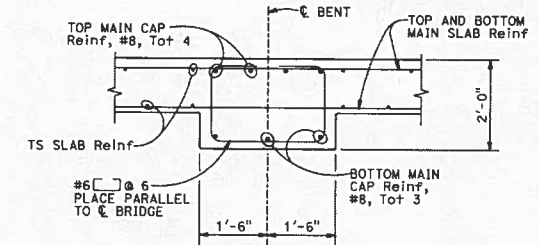

**SECTION A-A**  
SCALE: 3/4" = 1'-0"

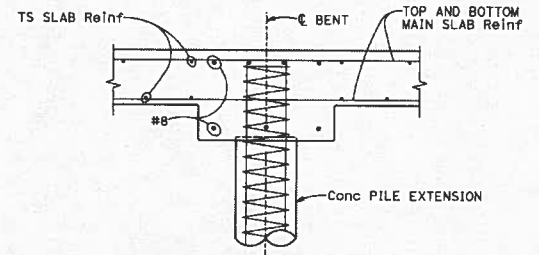

**SECTION B-B**  
SCALE: 3/4" = 1'-0"

NOTE:  
THE CONTRACTOR SHALL VERIFY ALL ONTROLLING FIELD DIMENSION BEFORE ORDERING OR FABRICATION ANY MATERIAL.

X	DESIGN OVERSIGHT
X	SIGN OFF DATE

DESIGN	BY J. ENGLAND	CHECKED X
DETAILS	BY R. UHLMANN	CHECKED X
QUANTITIES	BY X	CHECKED X

PREPARED FOR THE  
STATE OF CALIFORNIA  
DEPARTMENT OF TRANSPORTATION

JOHN ENGLAND  
PROJECT ENGINEER

BRIDGE NO.	53C0290
POST MILES	X

**MEDEA CREEK BRIDGE (WIDENING)  
BENT LAYOUT**

GRAPHIC SCALE IN INCHES FOR REDUCED PLANS

UNIT: PROJECT NUMBER & PHASE: X  
FILE => 53C0290-1-p01\_1001.dgn

CONTRACT NO.: X

REVISION DATE	7	12
---------------	---	----

USERNAME: R UNTERPODBAE PLOTTED: 11/27/2013 TIME PLOTTED: 11:34:47 AM

DIST	COUNTY	ROUTE	POST MILES TOTAL PROJECT	SHEET NO	TOTAL SHEETS
07	LA	LOCAL			

REGISTERED CIVIL ENGINEER X DATE \_\_\_\_\_  
 PLANS APPROVAL DATE \_\_\_\_\_  
 The State of California or its officers or agents shall not be responsible for the accuracy or completeness of several copies of this plan sheet.



Prepared for:  
 CITY OF AGOURA HILLS  
 30001 LADYFACE COURT  
 AGOURA HILLS, CALIFORNIA 93101  
 Prepared by:  
 WILLDAN ENGINEERING  
 374 POLI STREET, SUITE 101  
 VENTURA, CALIFORNIA 93001

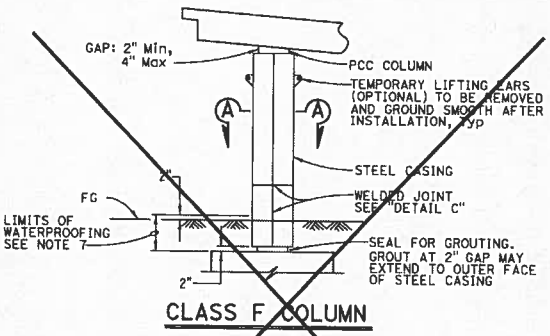

**CLASS F COLUMN**

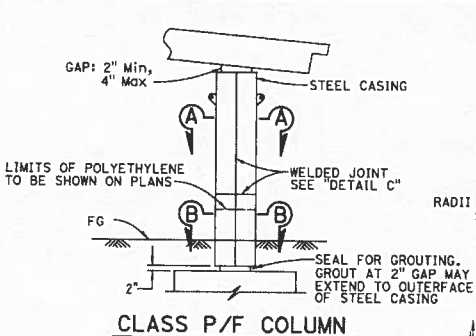

**CLASS P/F COLUMN**

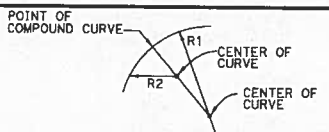

**ELLIPTICAL CASING DETAIL CLASS F AND P/F COLUMN**

RADI R1 AND R2 TO BE DETERMINED BY THE CONTRACTOR SUBJECT TO THE APPROVAL OF THE ENGINEER

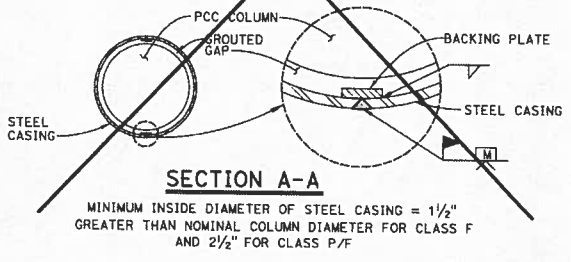

**SECTION A-A**

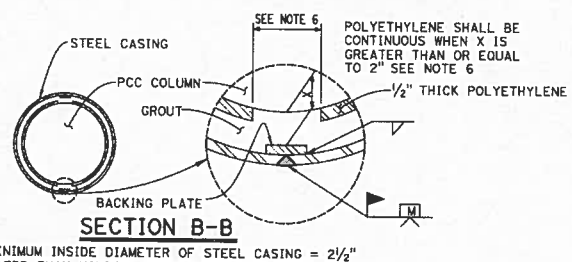

**SECTION B-B**

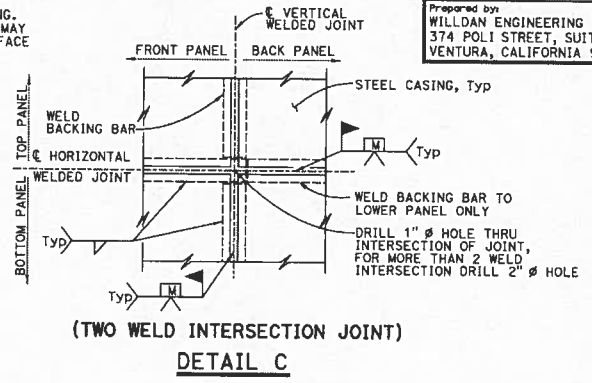

**(TWO WELD INTERSECTION JOINT) DETAIL C**

- NOTES:
- For varying thickness, steel casing inside surface to remain flush. Minimum clearance from PCC column to casing shall be maintained.
  - Appropriate injection nozzles to be provided on casing, but removed and ground flush following completion of grouting operation.
  - All voids between steel casing and polyethylene (Class P/F), and steel casing and PCC column (Class F) to be filled with grout.
  - Location and number of vertical and horizontal welds to be determined by the Contractor and subject to the approval of the Engineer. The location of casing welds are for illustration. No skip welds allowed.
  - Circular steel casing to be 1/4" thick minimum for casings with a 4'-4" diameter or less; all other steel casings to be 3/8" thick unless noted differently on contract plans. Backing plates to be the same thickness as casing up to maximum 3/8" thick.
  - Contractor shall remove 12" polyethylene strip behind backing plate if backing plate is closer than 2" from face of column.
  - Waterproof limits for steel casings. Typical for Class "F" and "P/F".
  - For pipe extensions, opening shall be no more than 1/4" greater than the pipe extension diameter. For other openings, the opening diameter to be determined by the Engineer.

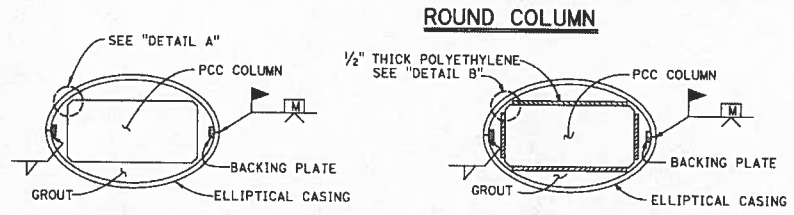

**ROUND COLUMN**

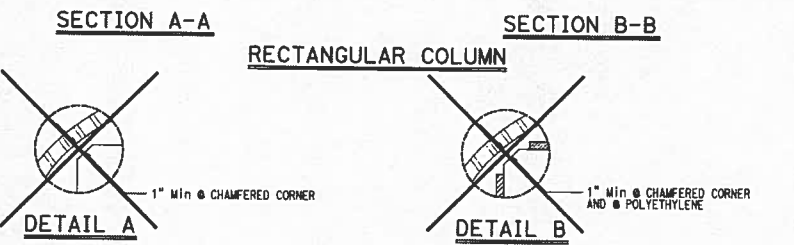

**RECTANGULAR COLUMN**

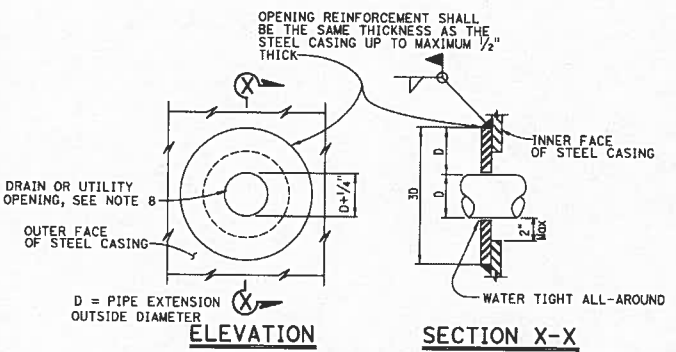

**CASING OPENING**

NOTE: OPENING REINFORCEMENT REQUIRED FOR DRAIN OR UTILITY OPENINGS LARGER THAN 4"

NOTE:  
 THE CONTRACTOR SHALL VERIFY ALL CONTROLLING FIELD DIMENSION BEFORE ORDERING OR FABRICATING ANY MATERIAL.

DESIGN BY J. ENGLAND	CHECKED X	PREPARED FOR THE STATE OF CALIFORNIA DEPARTMENT OF TRANSPORTATION	BRIDGE NO. 53C0290	<b>MEDEA CREEK BRIDGE (WIDENING) COLUMN CASING - STEEL</b>
DETAILS BY R. UHLMANN	CHECKED X	JOHN ENGLAND PROJECT ENGINEER	POST MILES X	
QUANTITIES BY X	CHECKED X			

DESIGN DETAIL SHEET (ENGLISH) (REV. 03/14/12)	SCALE OF THIS SHEET: 1" = 4'-0"	UNIT: PROJECT NUMBER & PHASE: X	CONTRACT NO.: X	REVISION DATES	SHEET 8 OF 12
---	---------------------------------	---------------------------------	-----------------	----------------	---------------

DATE PLOTTED: 11/28/2013 11:58:31 AM

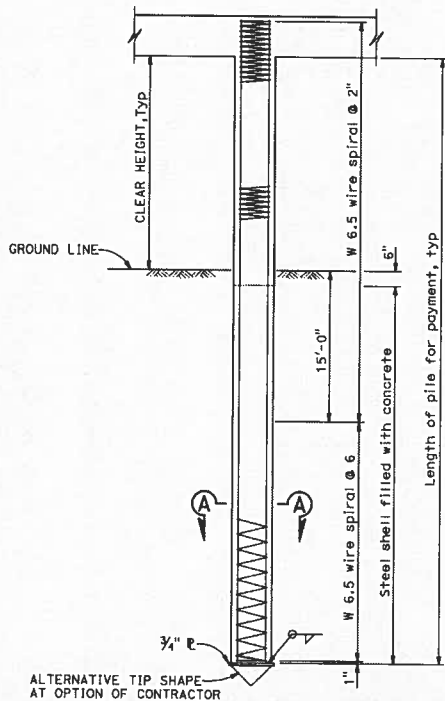
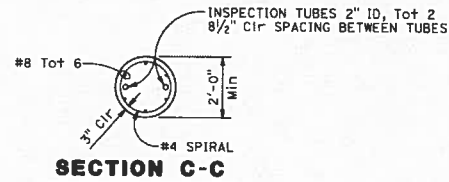
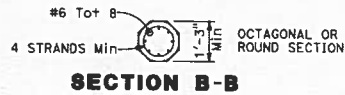
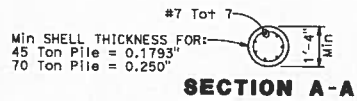

**CAST-IN-STEEL SHELL  
CONCRETE PILE**

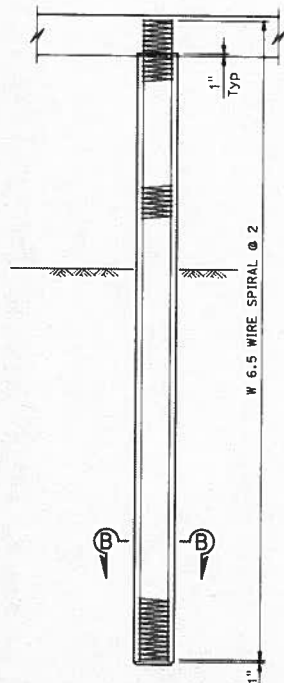

**PRECAST PRESTRESSED  
CONCRETE PILE**

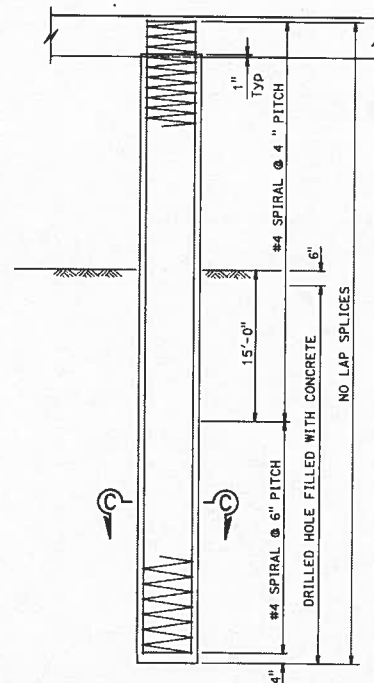

**CAST-IN-DRILLED HOLE  
CONCRETE PILE**

NOTE:  
THE CONTRACTOR SHALL VERIFY  
ALL CONTROLLING FIELD DIMENSION  
BEFORE ORDERING OR FABRICATION  
ANY MATERIAL.

X	DESIGN OVERSIGHT
X	SIGN OFF DATE

DESIGN DETAIL SHEET (ENGLISH) (REV. 03/14/12)

DESIGN	BY J. ENGLAND	CHECKED X
DETAILS	BY R. UHLMANN	CHECKED X
QUANTITIES	BY X	CHECKED X

PREPARED FOR THE  
**STATE OF CALIFORNIA**  
DEPARTMENT OF TRANSPORTATION

JOHN ENGLAND  
PROJECT ENGINEER

BRIDGE NO.	53C0290
POST MILES	X

**MEDEA CREEK BRIDGE (WIDENING)  
SLAB BRIDGE PILE DETAILS**

GRAPHIC SCALE IN INCHES  
FOR REDUCED PLANS

UNIT:  
PROJECT NUMBER & PHASE: X

CONTRACT NO.: X

FILE => 53C0290-p-51cb Bridge Pile Details.dgn

DATE AND PRINTED DATE

REVISION DATE SHEET OF  
1 9 12

DIST	COUNTY	ROUTE	POST MILES TOTAL PROJECT	SHEET NO	TOTAL SHEETS
07	LA	LOCAL			

REGISTERED CIVIL ENGINEER DATE

PLANS APPROVAL DATE

The State of California or its officers or agents shall not be responsible for the accuracy or completeness of scanned copies of this plan sheet.

Prepared for:  
CITY OF AGOURA HILLS  
30001 LADYFACE COURT  
AGOURA HILLS, CALIFORNIA 93101

Prepared by:  
WILLDAN ENGINEERING  
374 POLI STREET, SUITE 101  
VENTURA, CALIFORNIA 93001

**NOTES:**

- Design service level loading is 140 kips service and 280 kips nominal axial structural resistance or less as noted.
- Maximum size of aggregate is 1".
- For the prestressed concrete pile:
  - The prestress force after all losses shall provide 700 psi minimum stress.
  - The concrete strength shall not be less than 6000 psi at 28 days.
- No splices allowed in the longitudinal reinforcement within the "clear height" or within 10' below the ground line.
- Reinforced Concrete  $f'c = 4,000$  psi.
- Steel pile  $f_y$  minimum yield strength = 45,000 psi.  
 $f_u$  minimum tensile strength = 66,000 psi.

DATE PLOTTED: 11/27/2013 11:27:13 AM

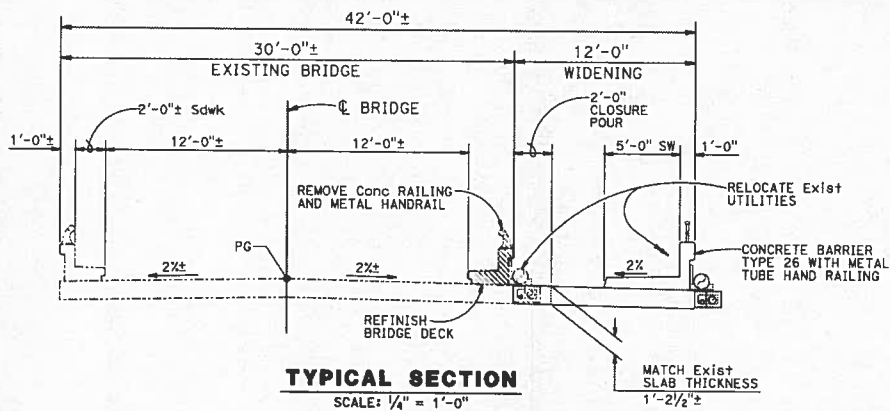

**TYPICAL SECTION**

SCALE: 1/4" = 1'-0"

**LEGEND**

- Denotes Existing Structure
- Denotes Proposed Structure

**NOTES**

1. FOR SLAB REINFORCING DETAILS NOT SHOWN SEE "SLAB REINFORCEMENT DETAILS NO. 2" SHEET.

DIST	COUNTY	ROUTE	POST MILES TOTAL PROJECT	SHEET NO	TOTAL SHEETS
07	LA	LOCAL			

REGISTERED CIVIL ENGINEER DATE \_\_\_\_\_

PLANS APPROVAL DATE \_\_\_\_\_

The State of California or its officers or agents shall not be responsible for the accuracy or completeness of scanned copies of this plan sheet.

Prepared for:  
CITY OF AGOURA HILLS  
30001 LADYFACE COURT  
AGOURA HILLS, CALIFORNIA 93101

Prepared by:  
WILLDAN ENGINEERING  
374 POLI STREET, SUITE 101  
VENTURA, CALIFORNIA 93001

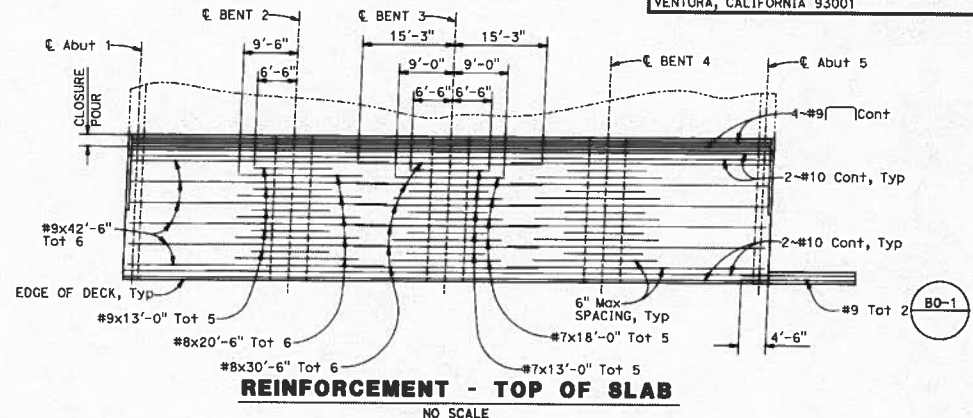

**REINFORCEMENT - TOP OF SLAB**

NO SCALE

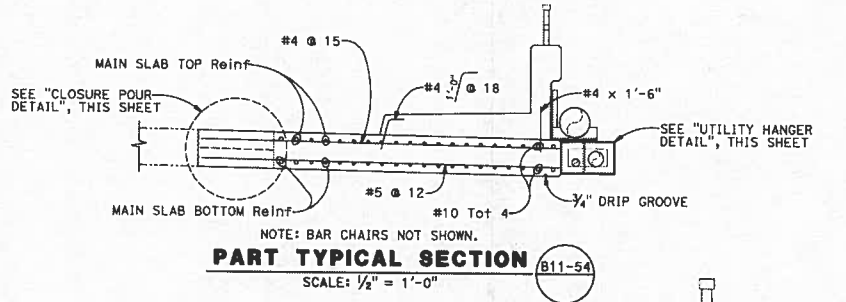

**PART TYPICAL SECTION**

SCALE: 1/2" = 1'-0"

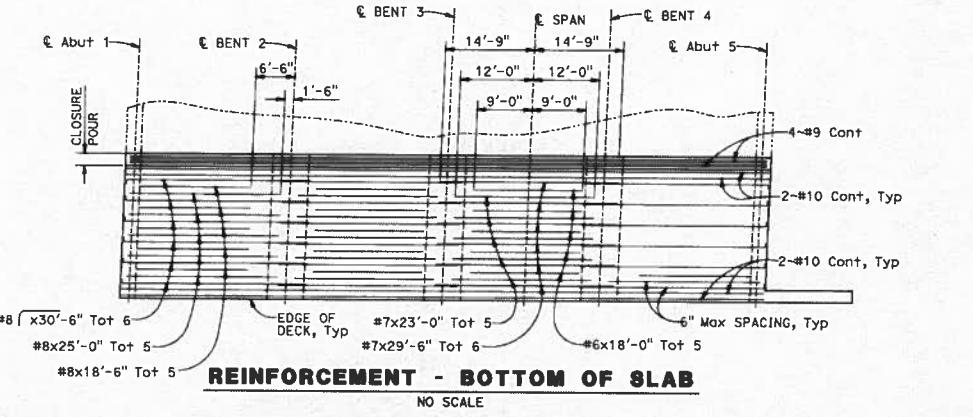

**REINFORCEMENT - BOTTOM OF SLAB**

NO SCALE

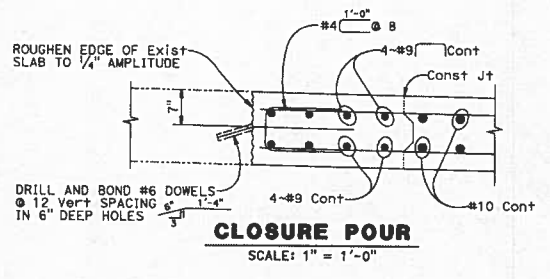

**CLOSURE POUR**

SCALE: 1" = 1'-0"

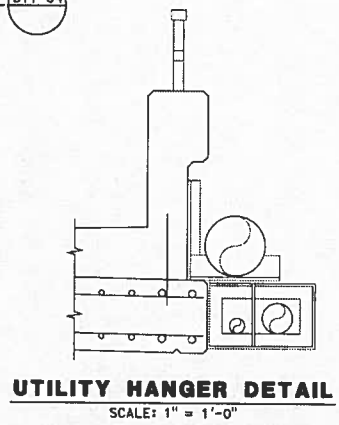

**UTILITY HANGER DETAIL**

SCALE: 1" = 1'-0"

NOTE:  
THE CONTRACTOR SHALL VERIFY ALL ONTROLLING FIELD DIMENSION BEFORE ORDERING OR FABRICATION ANY MATERIAL.

DESIGN OVERSIGHT	BY J. ENGLAND	CHECKED X
DETAILS	BY R. UHLMANN	CHECKED X
QUANTITIES	BY X	CHECKED X

DESIGN DETAIL SHEET (EMHSH) (REV. 03/14/12)	ORIGINAL SCALE 3/8" DIMS FOR REVISIONS	0	1	2	3
---	--	---	---	---	---

PREPARED FOR THE  
**STATE OF CALIFORNIA**  
DEPARTMENT OF TRANSPORTATION

JOHN ENGLAND  
PROJECT ENGINEER

PROJECT NO.: 53C0280  
POST MILES: X  
**MEDEA CREEK BRIDGE (WIDENING)**  
**SLAB REINFORCEMENT DETAILS NO. 1**

UNIT: X	PROJECT NUMBER & PHASE: X	CONTRACT NO.: X	DATE: X	REVISED DATES	BY	OF
FILE => 53C0280-v1-Slab Reinf Details No 1.dgn					X	12

TIME PLOTTED BY 2/20/13 PM