

## REPORT TO CITY COUNCIL

**DATE:** JULY 12, 2017

**TO:** HONORABLE MAYOR AND MEMBERS OF THE CITY COUNCIL

**FROM:** GREG RAMIREZ, CITY MANAGER *W.H. For G.R.*

**BY:** RAMIRO ADEVA, PUBLIC WORKS DIRECTOR/CITY ENGINEER *R.A. Adeva*

**SUBJECT:** DISCUSS AESTHETIC PLANS FOR THE KANAN/AGOURA ROAD  
ULTIMATE INTERSECTION IMPROVEMENTS PROJECT

---

In June 2016, staff presented the first draft plans for the Kanan/Agoura Road Ultimate Intersection Improvements Project (Project) to the City Council (Council). The presentation of the draft plans was a proactive effort by staff to ensure the intersection design was progressing in a direction consistent with the Council's vision for public improvements within the Agoura Village area.

During the deliberation period at the regular City Council meeting on June 8 2016, staff received feedback from Council on several items to consider with the design of the Project. Comments received covered a wide range of aesthetic issues from specific stone textures to lighting to creation of an Agoura Village logo, as well as presentation material to better aid Council in reviewing proposed design elements. Attached is a matrix summarizing the comments received during deliberation at the June 8, 2016 City Council meeting. The matrix provides comments received from each Councilmember categorized under six (6) general aesthetic topics: Pedestrian Friendly; Lighting; City Logo; Towers/Pilasters; Oak Trees and Other Issues.

Addressing the feedback received from the Council, staff has continued with the detailing of the aesthetic design for the Project. As deliberated, staff has provided Council full size drawings of the aesthetic plans, which present perspectives and placement of the tower/pilasters, material (stone and pavers) detail, and lighting and fencing details. Additionally, staff has provided a mock sample of the tower to give the Council a tactile and visual sample.

Reaching a final draft set of plans will be a multiple-step process, with a tentative schedule as follows:

1. July 12, 2017: Council meeting to receive direction and feedback from the City Council on the aesthetic details being presented in order to move forward in the design process to the 75% design plan set.
2. August 9, 2017: Council meeting to discuss the engineering details of the 75% design plans, and the pedestrian bridge option.

3. August 2017 - November 2017: Finalize plans, specifications, estimates (PS&E), and complete environmental document.
4. December 13, 2017: Council meeting for approval of the Final PS&E design package and environmental document.

## **RECOMMENDATION**

Staff respectfully recommends the City Council provide direction and feedback on the aesthetic plans set in order for staff to prepare a 75% draft.

Attachment: Matrix of City Council comments on the Design Plans at the June 8, 2016 Meeting  
Aesthetic Plans for the Kanan/Agoura Ultimate Intersection Improvements Project

**KANAN/AGOURA SIGNALIZED INTERSECTION**  
**Comments Received during Deliberation from City Council Meeting 06-08-2016**

Councilmember	Pedestrian Friendly	Lighting	City Logo	Towers/Pilasters	Oak Trees	Other Issues
<b>Denis Weber</b>	No overpass, doesn't want anything like Las Vegas					Fine with layout, was fortunate to be on PW subcommittee and had larger plans to review
<b>Linda Northrup</b>	Concurs with D. Weber, doesn't want to look like Vegas; Intersection is too big; Not pedestrian friendly; To get people to walk across the streets need to create openings; doesn't want a walkway too monumental; torn between the constraints of this being a thoroughfare versus Gateway to Santa Monica Mountains (traffic goals and pedestrian friendly)	Used East Leg of intersection to Cornell, not to over light; subtle glow is ok, maintain rural look; clearly show what and where lights	Doesn't want logo slapped on side of everything; incorporate it in a more organic way; Oak leaf as backdrop to lighting is too kitschy; doesn't like it slapped on the side of pilasters; wants subtle/understated like our City; Agreed with B. Koehler on AV logo – entering AV; if putting up large elements – branding/marketing	Not comfortable with height; ok with moving the tower to Sub-area 5;		Need Large Scale renderings, pictures to properly review and comment; This project will impact the lives of many beyond the time we are on City Council; Work closely with developers; Size of the features present with context to other surrounding landmarks to give them an idea of too big or not big enough, so people driving through don't get slammed in the face with a large object
<b>Illece Buckley-Weber</b>	During her deliberation, Illece didn't directly mention the bridge; however, during B. Koehler's deliberation, she added that she agreed with him on the bridge, but wants the bridge to be simple;	How many pilasters have lighting; LED can be bright; not comfortable with leaf in lighting – too much; keep in mind that developments will also have signs and lighting, want to avoid looking like Main Street Disneyland; no light on pilasters for south leg of the intersection, other than the sign at Cornell/Kanan;	keep in mind that developments will also have signs and lighting, want to avoid looking like Main Street Disneyland; No logo with leaf – not our brand; if it is our brand, then not a good job in branding;	Prefers much more understated; lots of towers- diff sizes; lots of diff stone; leaf everywhere; don't need all that; prefer rustic; gateway to Santa Monica mountains; elements using stone beautiful with diff texture, depths, stacked instead of flat; keep in mind that developments will also have signs and lighting, want to avoid looking like Main Street Disneyland – less pilasters; 17 ½ ft pilasters and 3 ½ for small pilasters seem large; Agree with L. Northrup – want to see perspective; Include Sub Area 5 and Whizin Center; one tower on the north leg may only be needed	Keep it understated within mountains with oaks; more oak trees; Save the oak trees at NW corner without losing service by thinking outside of box; or relocate those oak trees to the other corners; greener at the corners; But if not at the corners where (?)	Lot of nice features in the plan; glad that staff came at 65% and not at the 95%; City started fencing is a little overdone; fencing pattern in Old Agoura near equestrian park – simple 2-rail – keep that look; Can we increase size of median on the east leg without impacting tanker trucks?; liked the intersection of Cornell and Kanan – like meadows and trees;
<b>Bill Koehler</b>	Most delicate of the issues; there is a major barrier is Kanan Road between east and west village; Kanan was there when we started and will be there forever; to ask the question how to minimize Kanan is like how to put 10-lbs of sausage in 5-lbs of casing; have to reconcile east and west village; taking lanes out will not make it more appealing; must revisit the bridge over Kanan; we don't want a gaudy effect, make more tasteful; the cost of building a bridge versus failure of the village effect; we want to embrace a full village – address bridge		Don't need acorn everywhere; wants one that identifies AV, one is entering AV; towers should identify this AV, you are already in Agoura Hills; Asks his fellow Councilmembers to give thought to towers identifying AV rather than City logo	Hard to reconcile the sizes of the pilasters/towers in relation to other elements within the village plan; provide prospective to give them a better understanding of visual impact; Comfortable with the locations of the towers on the north and south legs, but would like the east one further east of Cornell and the west one to the western edge of Sub Area 5; Animal Shelter is a natural break; By putting towers @ future Marriott site, it identifies to the patrons to get them to walk because they are already in the AV	Agree that the two oaks on the north side are majestic; reducing lanes will negatively impact LOS, but we have one time to do this right; moving the oaks to the south corner or in a more prominent location would be wonderful	
<b>Harry Schwarz</b>	We want pedestrian friendly; bridge may be an expense well worth; but one change to do the right thing; not a monumental London bridge, but something more simple; need a bridge to cross all those lanes; do it right	Look at the AV in its entirety; project into the future; going to be lighting & signage; wants subtle, not overbearing; not like Calabasas Auto Mall	Don't need a logo on every element, every pilaster or tower; would like a separate logo for AV, agrees with B. Koehler	Wants natural look; not enough detail with 65%, but want to see the tower/pilaster in natural/earth tones; rustic feel for Agoura Hills; Would like to put tower with sign near closer to Ladyface Ale, shows entering into retail/etc; Not by Roadside/Hotel no idea what's in-between; Location of towers not a deal breaker for him		Overall likes the plan, but need to see larger pictures of elements; 3D renderings to sink our teeth into



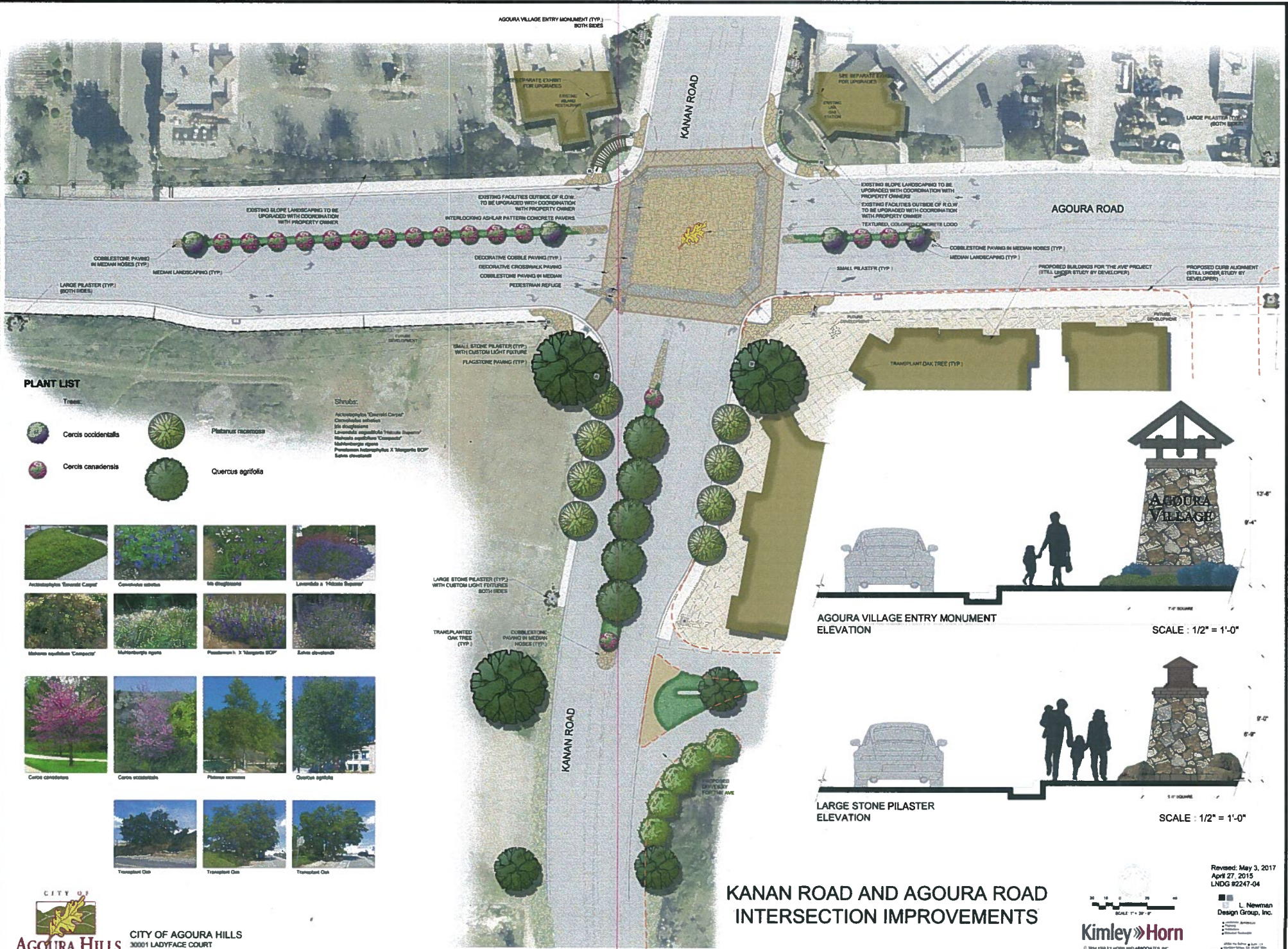

**PLANT LIST**

**Trees:**

- Cercis occidentalis*
- Cercis canadensis*
- Platanus racemosa*
- Quercus agrifolia*

**Shrubs:**

- Arctostaphylos 'Davidi Carpet'*
- Campanula medium*
- Isis douglasiana*
- Lambertia sordida 'Purple Dream'*
- Muhlenbergia 'Compact'*
- Penstemon 'S. Margarita BOP'*
- Saxifraga oppositifolia*



# KANAN ROAD AND AGOURA ROAD INTERSECTION IMPROVEMENTS



CITY OF AGOURA HILLS  
30001 LADYFACE COURT  
AGOURA HILLS, CA 91301



Revised: May 3, 2017  
April 27, 2015  
LNDG #2247-04  
L. Newman  
Design Group, Inc.  
© 2015 KIMLEY-HORN AND ASSOCIATES, INC.  
400 South Foothill Street, Suite 200, San Dimas, CA 91768  
Tel: (916) 331-4000



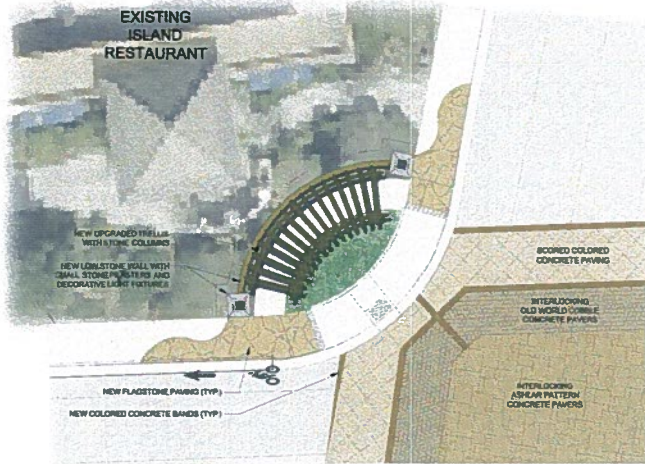

NORTHWEST CORNER PLAN

SCALE : 1/8" = 1'-0"

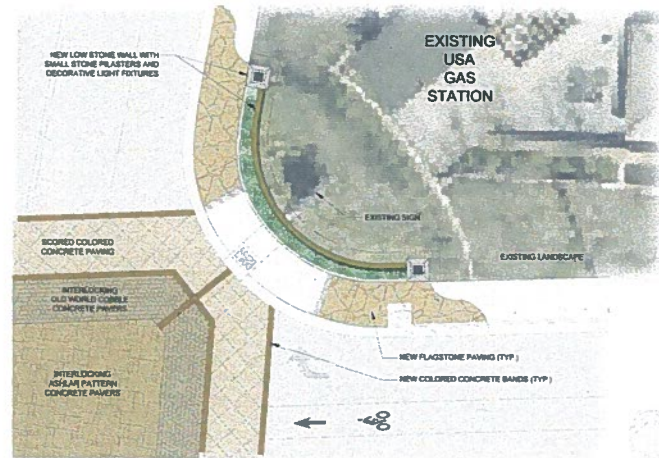

NORTHEAST CORNER PLAN

SCALE : 1/8" = 1'-0"



EXISTING SMALL WOOD TRELLIS STRUCTURES - TO BE REMOVED  
REPLACE WITH NEW UPGRADED SINGLE TRELLIS STRUCTURE  
WITH LARGER BEAMS AND STONE COLUMNS

EXISTING LOW WALL AND CITY BROWN LETTERING - TO BE REMOVED  
REPLACE WITH NEW LOW STONE WALL WITH SMALL STONE PILASTERS  
AND DECORATIVE LIGHT FIXTURES BEHIND NEW TRELLIS STRUCTURES

NEW PROPOSED PLANTING

NORTHWEST CORNER RENDERING



NEW LOW STONE WALL  
NEW SMALL STONE PILASTER (TYP)  
WITH DECORATIVE LIGHT FIXTURE  
AT ENDS OF NEW STONE WALL

NEW PROPOSED PLANTING

NORTHEAST CORNER RENDERING



SMALL STONE PILASTER AND LOW STONE WALL ELEVATION

SCALE : 1/2" = 1'-0"

# KANAN ROAD AND AGOURA ROAD INTERSECTION IMPROVEMENTS





VICINITY MAP

NOT TO SCALE

**PLANT LIST - SHRUBS**

- Muhlenbergia rigens
- Penstemon h. 'Margarita Bop'
- Salvia leucantha
- Native Wildflower Hydroseed

'GATEWAY TO THE SANTA MONICA MOUNTAINS'  
SIGN TO BE LOCATED ON NORTH SIDE OF ENTRY  
MONUMENT STRUCTURE

SMALL STONE PILASTER (TYP.)  
WITHOUT LIGHT FIXTURE

TRIPLE RAIL CONCRETE  
FENCING (TYP.)

NEW SPECIMEN PLANTED  
OAKS AND TRANSPLANTED  
VALLEY OAKS FROM THE  
AGOURA ROAD WIDENING  
IMPROVEMENT PROJECT  
(AS AVAILABLE)

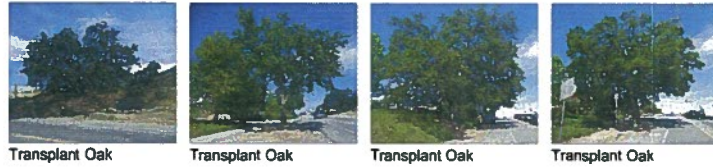

Transplant Oak Transplant Oak Transplant Oak Transplant Oak



Alternate Transplant Oak Alternate Transplant Oak Alternate Transplant Oak

LOW STONE  
WALL (TYP.)

NATIVE WILDFLOWER  
HYDROSEED (TYP.)

COLORED  
CONCRETE BAND  
(TYP.)

INTERLOCKING  
ASHLAR PATTERN  
CONCRETE  
PAVERS

INTERLOCKING  
COBBLE PAVERS

'CITY OF AGOURA HILLS'  
SIGN TO BE LOCATED ON  
SOUTH SIDE OF ENTRY  
MONUMENT STRUCTURE

KANAN ROAD

FALLOW  
SOIL

CORNELL ROAD

FALLOW  
SOIL

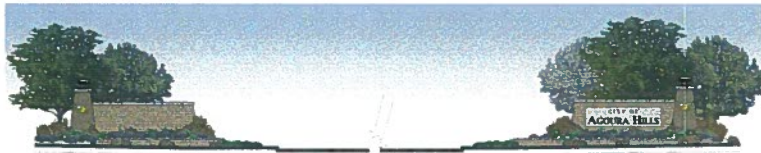

Entry Sign Section / Elevation (Looking North)

SCALE: 1/8" = 1'-0"

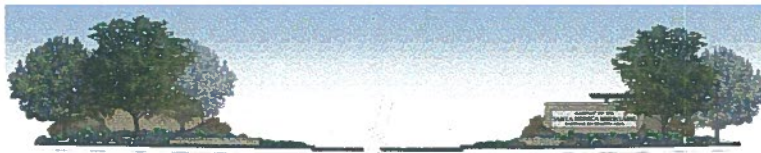

Entry Sign Section / Elevation (Looking South)

SCALE: 1/8" = 1'-0"

\*THIS OPTION IS SUBJECT TO PROPERTY OWNER'S APPROVAL  
NEGOTIATION AND LANDSCAPE MAINTENANCE EASEMENTS.

**KANAN ROAD AND AGOURA ROAD  
INTERSECTION IMPROVEMENTS  
CITY ENTRY SIGNAGE MONUMENT**



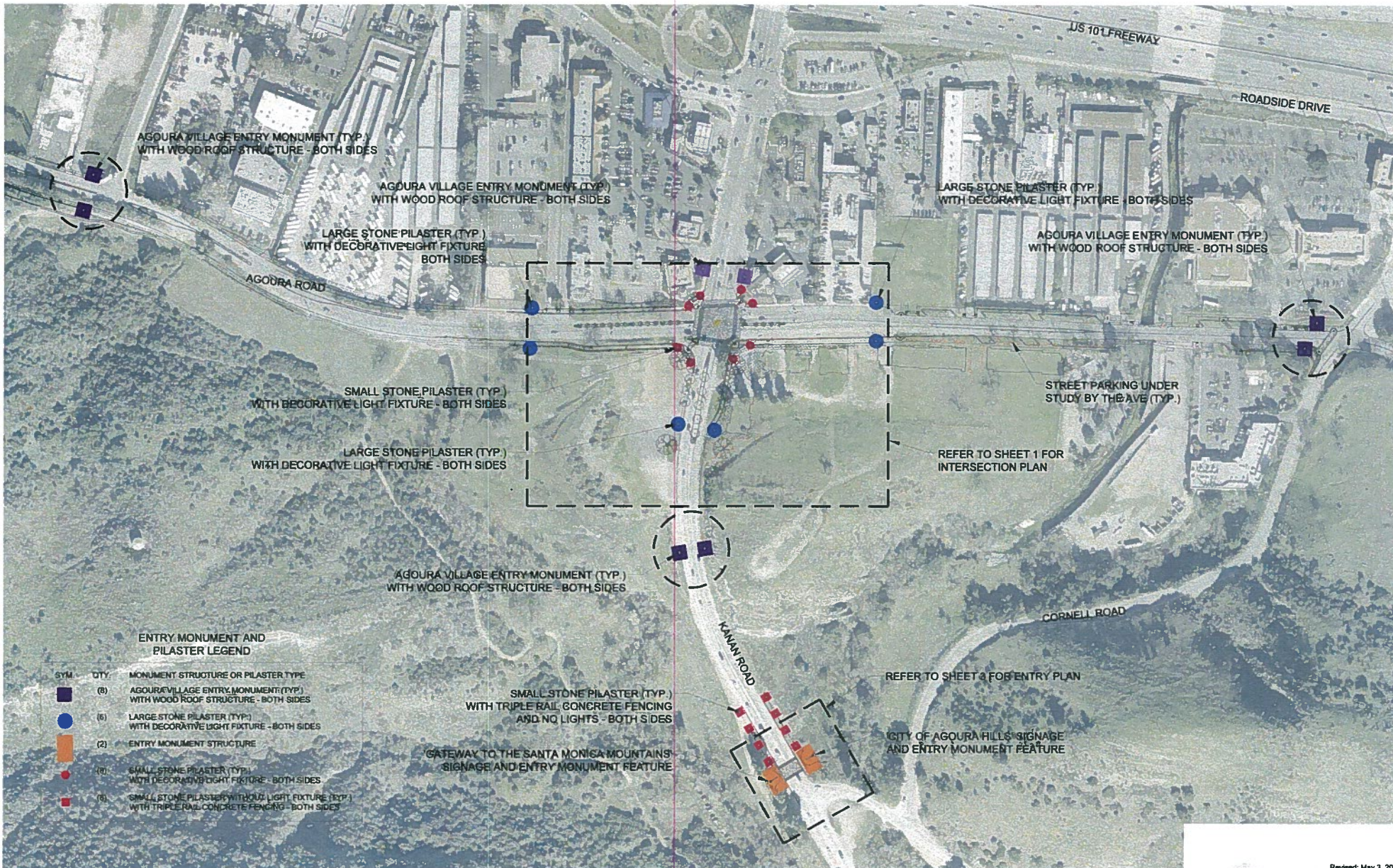

**ENTRY MONUMENT AND PILASTER LEGEND**

SYM	QTY	MONUMENT STRUCTURE OR PILASTER TYPE
■	(8)	AGOURA VILLAGE ENTRY MONUMENT (TYP.) WITH WOOD ROOF STRUCTURE - BOTH SIDES
●	(6)	LARGE STONE PILASTER (TYP.) WITH DECORATIVE LIGHT FIXTURE - BOTH SIDES
■	(2)	ENTRY MONUMENT STRUCTURE
●	(4)	SMALL STONE PILASTER (TYP.) WITH DECORATIVE LIGHT FIXTURE - BOTH SIDES
■	(6)	SMALL STONE PILASTER WITHOUT LIGHT FIXTURE (TYP.) WITH TRIPLE RAIL CONCRETE FENCING - BOTH SIDES

**KANAN ROAD AND AGOURA ROAD INTERSECTION IMPROVEMENTS ENTRY MONUMENTATION**



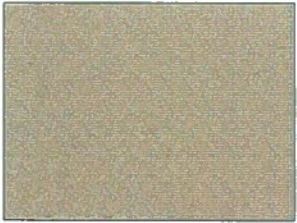

INTEGRAL COLORED CONCRETE PAVING (CROSSWALKS) - DAVIS COLOR, SANDSTONE #5237

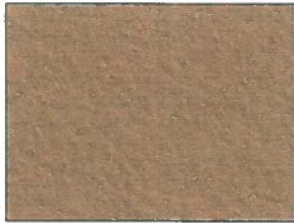

INTEGRAL COLORED CONCRETE PAVING (BANDS) - DAVIS COLOR, FLAGSTONE BROWN #641



SCORED COLOR CONCRETE WITH COLORED CONCRETE BANDS, COLORS: SEE LEFT



KEY INTERSECTIONS PAVERS - BELGARD MEGA-LAFITT ASHLAR PATTERN SLATE, COLOR: BLENDED MONTECITO



KEY INTERSECTION PAVERS (BAND) - BELGARD PAVERS OLD WORLD PAVER, COLOR: BLENDED MONTECITO



FLAGSTONE PAVERS - 1-1/2 TO 2" THICK MAX, SIZES 12" TO 18" DIAMETER, COLORS: MATCH EXISTING



STONE COBBLES (MEDIANS) - RIVER ROCK COBBLES, ROUNDED 3" TO 6" SIZE, COLOR: YOSEMITE MIX



STONE VENEER CITY WIDE - ELDORADO STONE COUNTRY RUBBLE, COLOR: BELLA



LOMPOC STONE NATURAL WALL VENEER, 6" TO 10"



WOOD TRELLIS PAINT COLOR: DUNN EDWARDS DET634 DOWING TO EARTH



PRECAST MASONRY CAP AND TRIM - ELDORADO STONE, COLOR: EARTH



MASONRY CAP AND TRIM - EL DORADO STONE ASHLAR RUSTIC WALL CAP, COLOR: SEE LEFT

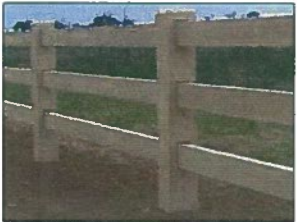

TIMBERCRETE 52" HIGH CONCRETE TRIPLE RAIL FENCE, COLOR: BEIGE



TREE GRATE - NEENAH FOUNDRY COMPANY TREE BOULEVARD - MODEL R-8711, COLOR: NATURAL PATINA



LANDSCAPE BOULDERS - SANDSTONE SIZES 2" TO 5" DIAMETER, COLOR: BROWNS

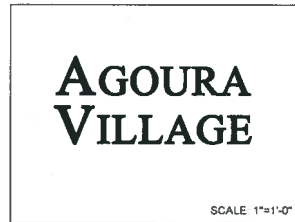

SIGN LETTERING - ALUMINUM PAINTED BLACK

AGOURA VILLAGE

SCALE 1"=1'-0"



LANDSCAPE ACCENT LIGHT - PHILLIPS HADCO B3-HLED13NFW, ALUMINUM BULLYTE W/SHROUD, BRONZE FINISH



SIGN FLOOD LIGHT - PHILIPS STONCO LPF4 LYTEPRO LED LARGE FLOODLIGHT 105W, BRONZE FINISH