

LANDSCAPE PLAN - TYPICAL FRONT YARD

Site and Irrigation Improvements

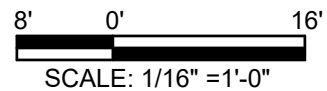
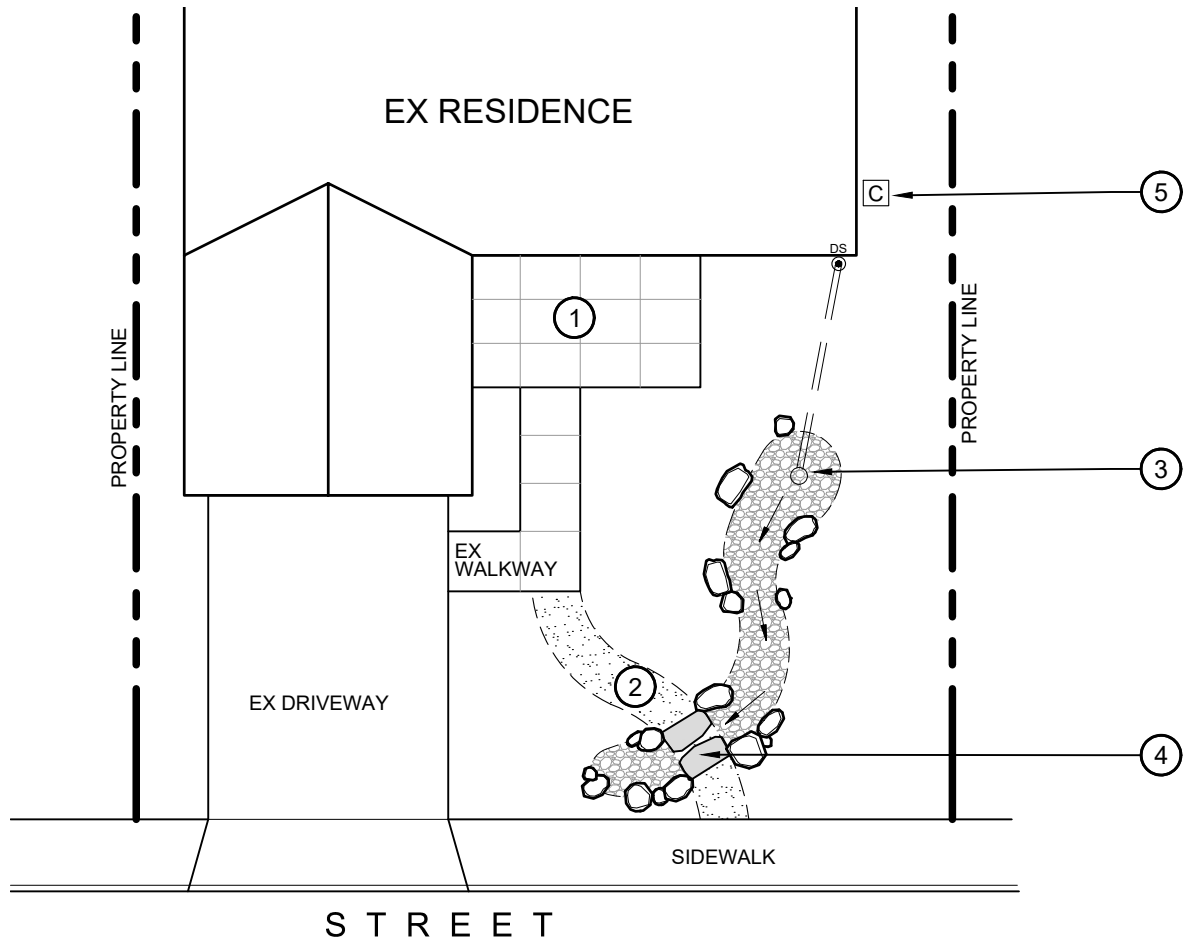

IMPROVEMENT LEGEND

- ① Patio / Outdoor gathering space - Pervious paving
- ② Sidewalk access pathway - Pervious paving / Decomposed granite
- ③ Stormwater infiltration - Dry stream with gravel + boulders (connect to downspout)
- ④ Stepping stones
- ⑤ Irrigation - Smart Controller, Flow Sensor, Master Valve



Typical front yard image

LANDSCAPE PLAN - TYPICAL FRONT YARD - 'A'

Planting Plan

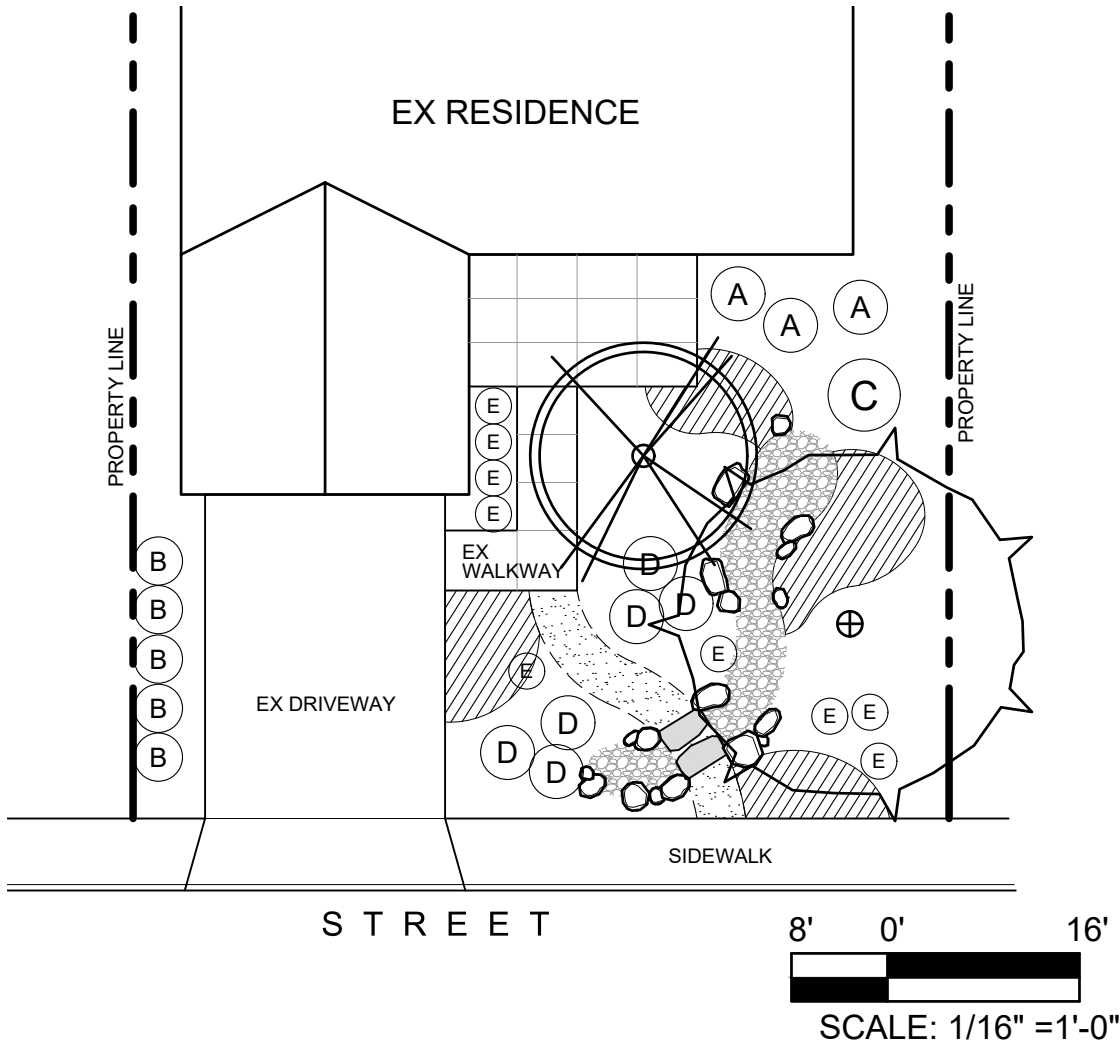

NOTES

1. Soil Preparation - Remove weeds. Many native plants thrive in poor soil conditions. Amend lightly with compost, humate and worm castings. Note that most native plants require only minimal organic matter and fertilizer should be avoided.
2. Mulch - Apply two to three inch depth of organic, well-composted mulch after planting to retain moisture and suppress weeds. Avoid synthetic materials such as weed cloth. Note that nitrogen fertilizer may be required if using mulch containing hardwood that is not fully composted.
3. Planting - Install shrubs per detail this sheet (plant crown to be 2" above adjacent grade for 15 gallon and larger plants; 1" above adjacent grade or plants smaller than 15 gallon).
4. No mulch and minimal planting allowed within 5' of structures.

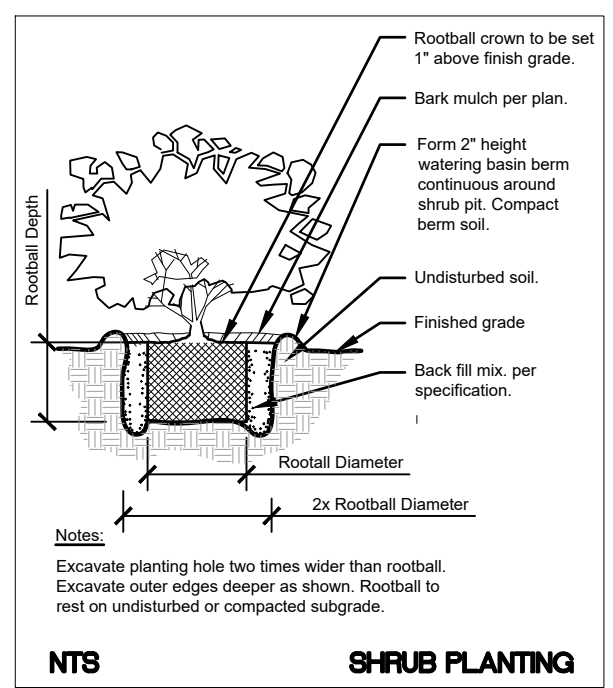

NTS

SHRUB PLANTING

LANDSCAPE PLAN - TYPICAL FRONT YARD - 'B'

Planting Plan

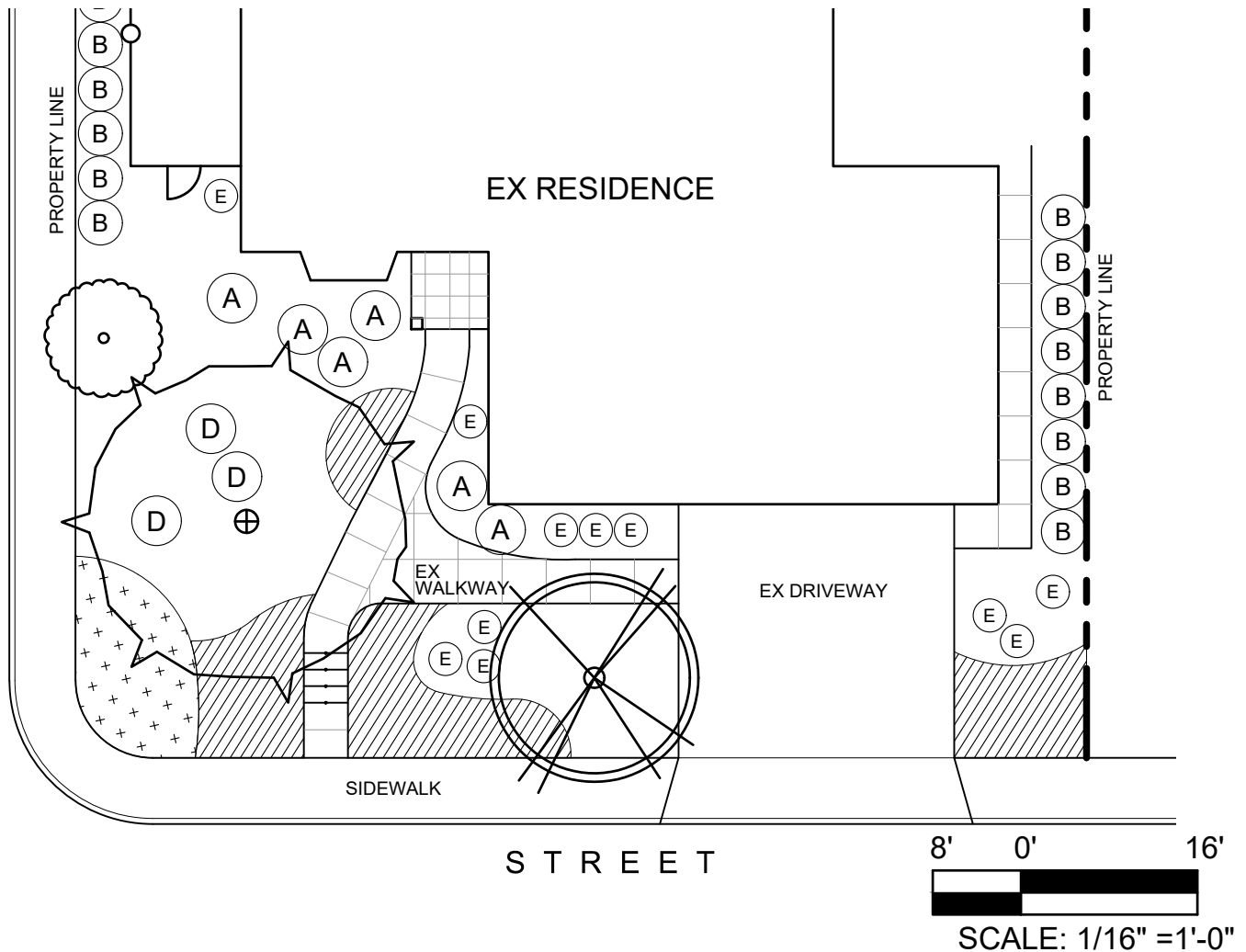

NOTES

1. Soil Preparation - Remove weeds. Many native plants thrive in poor soil conditions. Amend lightly with compost, humate and worm castings. Note that most native plants require only minimal organic matter and fertilizer should be avoided.
2. Mulch - Apply two to three inch depth of organic, well-composted mulch after planting to retain moisture and suppress weeds. Avoid synthetic materials such as weed cloth. Note that nitrogen fertilizer may be required if using mulch containing hardwood that is not fully composted.
3. Planting - Install shrubs per detail this sheet (plant crown to be 2" above adjacent grade for 15 gallon and larger plants; 1" above adjacent grade or plants smaller than 15 gallon).
4. No mulch and minimal planting allowed within 5' of structures.

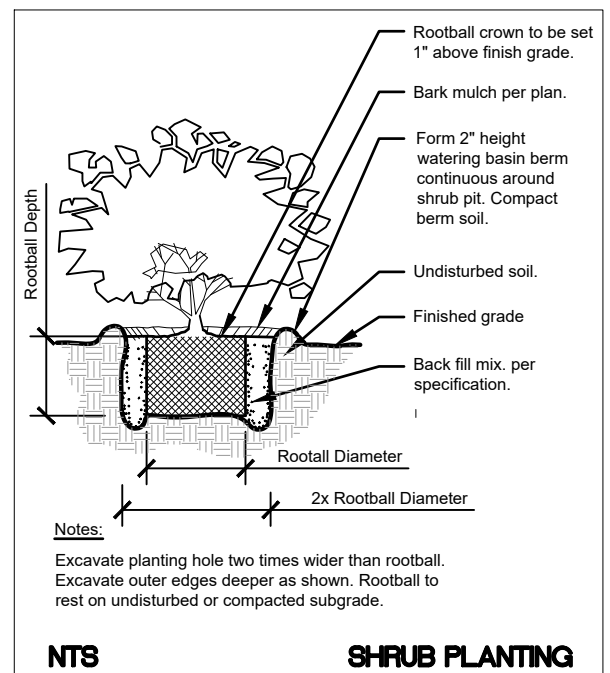

LANDSCAPE PLAN - TYPICAL FRONT YARD - 'C'

Planting Plan

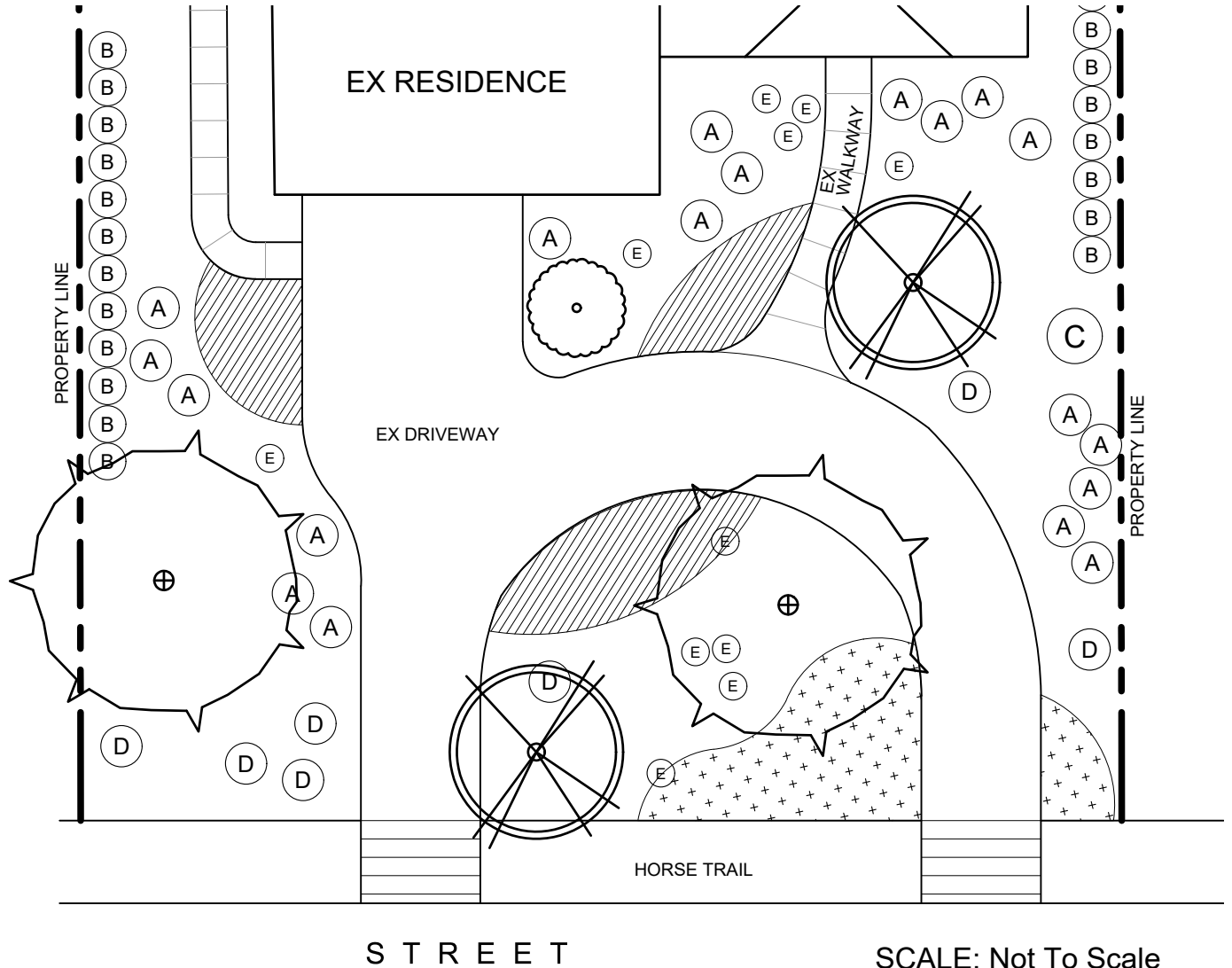

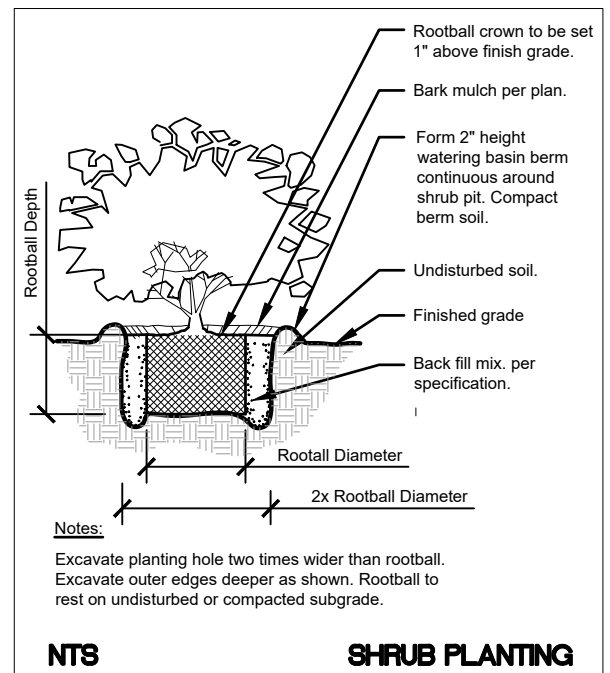

NOTES

1. Soil Preparation - Remove weeds. Many native plants thrive in poor soil conditions. Amend lightly with compost, humate and worm castings. Note that most native plants require only minimal organic matter and fertilizer should be avoided.
2. Mulch - Apply two to three inch depth of organic, well-composted mulch after planting to retain moisture and suppress weeds. Avoid synthetic materials such as weed cloth. Note that nitrogen fertilizer may be required if using mulch containing hardwood that is not fully composted.
3. Planting - Install shrubs per detail this sheet (plant crown to be 2" above adjacent grade for 15 gallon and larger plants; 1" above adjacent grade or plants smaller than 15 gallon).
4. No mulch and minimal planting allowed within 5' of structures.

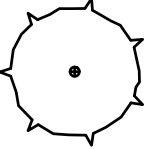
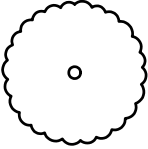

TYPICAL FRONT YARD PLANT LEGEND **

| SYMBOLS | BOTANICAL NAME | COMMON NAME | SIZE *** (Mature Ht x W) | NOTES | WATER USE * |
|--|---|-------------------------|-----------------------------|-------------------------|-------------|
| TREES - Accent | | | | | |
|  | <i>Cercis occidentalis</i> **** | Western Redbud | 15' x 10' | Native, part shade | L |
| | <i>Chilopsis linearis</i> **** | Desert Willow | 20' x 20' | Native, sun | L |
| | Citrus sp. | Citrus Tree | varies | Food plant | M |
| | <i>x Chitalpa t. 'Pink Dawn'</i> | Pink Dawn Chitalpa | 25' x 25' | Sun | L |
| | <i>Lagerstroemia indica</i> | Crape Myrtle | 25' x 25' | Sun | M |
| | <i>Pyrus kawakamii</i> | Evergreen Pear | 25' x 25' | Sun | M |
| | <i>Geijera parviflora</i> | Australian Willow | 35' x 20' | Sun, weeping form | L |
| TREES - Canopy | | | | | |
|  | <i>Arbutus 'Marina'</i> | Marina Strawberry Tree | 25' x 35' | Sun | L |
| | <i>Ginkgo biloba</i> | Maidenhair Tree | 60' x 25' | Sun | M |
| | <i>Gleditsia triacanthos var. inermis</i> | Thornless Honeylocust | 60' x 40' | Sun, part shade | M |
| | <i>Melaleuca quinquenervia</i> | Paperbark | 40' x 20' | Sun | L |
| | <i>Olea europaea 'Swan Hill'</i> | Fruitless Olive Tree | 30' x 30' | Sun | L |
| | <i>Quercus agrifolia</i> **** | Coast Live Oak | 50' x 45' | Native, sun | L |
| TREES - Small tree or Large shrub | | | | | |
|  | <i>Arbutus unedo 'Compacta'</i> | Dwarf Strawberry Tree | 8' x 6' | Sun | L |
| | <i>Heteromeles arbutifolia</i> **** | Toyon | 10' x 8' | Native, sun | L |
| SHRUBS - Foundation (Evergreen) | | | | | |
|  | <i>Abelia x grandiflora</i> | Glossy Abelia | 5 gal | Sun, light shade | M |
| | <i>Carissa species</i> | Natal Plum | varies | Sun or Shade | L |
| | <i>Carpenteria californica</i> **** | Bush Anemone | 8' x 5' | Native, sun | L |
| | <i>Mahonia aquifolium 'Compacta'</i> **** | Compact Oregon Grape | 3' x 4' | Native, sun, part shade | L |
| | <i>Myrsine africana</i> | African Boxwood | 6' x 5' | Sun | L |
| | <i>Myrtus communis 'Compacta'</i> | Dwarf Myrtle | 3' x 3' | Sun | L |
| | <i>Raphiolepis u. 'Minor'</i> | Dwarf Yeddo Hawthorn | 5' x 3' | Sun, part shade | L |
| | <i>Westringia f. 'Blue Gem'</i> | Blue Gem Coast Rosemary | 5' x 4' | Sun | L |
| SHRUBS - Perimeter / Privacy | | | | | |
|  | <i>Ligustrum japonicum 'Texanum'</i> | Waxleaf Privet | 8' x 6' | Sun | M |
| | <i>Myrsine africana</i> | African Boxwood | 6' x 5' | Sun | L |
| | <i>Myrtus communis 'Compacta'</i> | Dwarf Myrtle | 3' x 3' | Sun | L |
| | <i>Raphiolepis u. 'Minor'</i> | Dwarf Yeddo Hawthorn | 5' x 3' | Sun, part shade | L |



* L = Low water use at establishment, M = Medium water usage at establishment.

** See Los Angeles County Fuel Modification plant list to confirm distance from structure requirements.

*** Size listed is maximum mature size. Typical size is 75% of mature size.

**** California native plant

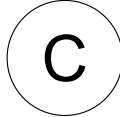
TYPICAL FRONT YARD PLANT LEGEND ** (continued)

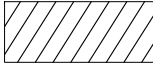
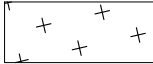
| SYMBOLS | BOTANICAL NAME | COMMON NAME | SIZE *** (Mature Ht x W) | NOTES | WATER USE * |
|--|---|-------------------------|-----------------------------|-----------------------------|-------------|
| SHRUBS - Large Flowering | | | | | |
|  | <i>Alyogyne huegelii</i> | Blue Hibiscus | 8' x 6' | Sun, adapted | L |
| | <i>Arbutus unedo</i> 'Compacta' | Dwarf Strawberry Tree | 8' x 6' | Sun, adapted | L |
| | <i>Caesalpinia gilliesii</i> | Yellow Bird of Paradise | 6' x 6' | Sun, fast growing | L |
| SHRUBS - Medium Flowering Accent | | | | | |
|  | <i>Encelia californica</i> **** | Bush Sunflower | 4' x 6' | Native, sun | L |
| | <i>Kniphofia uvaria</i> | Poker Plant | 3' x 4' | Sun | M |
| | <i>Hesperaloe parviflora</i> | Red Yucca | 3' x 5' | Sun | L |
| | <i>Lantana species</i> | Lantana | varies | Sun | L |
| | <i>Mimulus aurantiacus</i> **** | Sticky Monkey Flower | 3' x 3' | Native, light shade | L |
| | <i>Verbena lilacina</i> 'De La Mina' **** | De La Mina Verbena | 2' x 3' | Native, sun | L |
| SHRUBS - Entryway / Accent | | | | | |
|  | <i>Agapanthus species</i> | Lily of the Nile | varies | Sun, part shade | M |
| | <i>Carissa species</i> | Natal Plum | varies | Sun, part shade | L |
| | <i>Dietes grandiflora</i> | Fortnight Lily | 4' x 3' | Sun, part shade | L |
| | <i>Festuca glauca</i> | Blue Fescue | 1' x 2' | Sun | L |
| | <i>Iris douglasiana</i> **** | Douglas Iris | 2' x 3' | Native, part shade | L |
| | <i>Hemerocallis species</i> | Day Lily | varies | Sun | M |
| | <i>Nandina species</i> | Heavenly Bamboo | varies | Sun | L |
| | <i>Penstemon species</i> **** | Beard Tongue | varies | Native, sun | L |
| | <i>Pittosporum t. 'Wheeler's Dwarf'</i> | Dwarf Mock Orange | 4' x 5' | Sun or shade | M |
| GROUNDCOVER | | | | | |
|   | <i>Achillea species</i> | Yarrow | 1 gal or Flats | Sun | L |
| | <i>Dianella caerulea</i> 'Cassa Blue' | Blue Flax Lily | 2' x spreading | Part Shade | M |
| | <i>Festuca glauca</i> | Blue Fescue | 1' x 2' | Sun | L |
| | <i>Fragaria chiloensis</i> **** | Beach Strawberry | 6" x spreading | Native, Sun or shade | M |
| | <i>Gazania species</i> | Gazania | varies | Sun | L |
| | <i>Heuchera species</i> **** | Coral Bells | varies | Native, Shade/Part Shade | L/M |
| | <i>Lippia nodiflora</i> | Kurapia | 3" x spreading | Sun | L |
| | <i>Myoporum parvifolium</i> | Myoporum | 6" x spreading | Sun | L |
| | <i>Senecio mandraliscae</i> or <i>serpens</i> | Blue Chalksticks | 6+" x spreading | Sun | L |
| | <i>Trachelospermum jasminoides</i> | Star Jasmine | 3' x spreading | Sun, part shade | M |

* L = Low water use at establishment, M = Medium water usage at establishment.

** See Los Angeles County Fuel Modification plant list to confirm distance from structure requirements.

*** Size listed is maximum mature size. Typical size is 75% of mature size.

**** California native plant

PLANT IMAGES

TREES (Botanical/Common Name, Mature HxW, Sun Exposure)



Arbutus 'Marina' / Strawberry Tree
25' x 35', Sun



Arbutus unedo 'Compacta' / Dwarf Strawberry Tree
8' x 6', Sun



Cercis occidentalis / Western Redbud *
15' x 10', Partial Sun/Shade tolerant



Chilopsis linearis / Desert Willow *
25' x 25', Sun



x *Chitalpa tashkentensis* 'Pink Dawn' / Pink Dawn Chitalpa
25' x 25', Sun



Geijera parviflora / Australian Willow
35' x 20', Sun



Heteromeles arbutifolia / Toyon *
10' x 8', Sun



Melaleuca quinquenervia / Paperbark Tree
40' x 20', Sun

* California native plant

PLANT IMAGES (continued)

SHRUBS / PERENNIALS (Botanical/Common Name, Mature HxW, Sun Exposure)



Alyogyne huegelii / Blue Hibiscus
8' x 6', Sun



Caesalpinia gilliesii / Yellow Bird of Paradise
6' x 6', Sun



Carpenteria californica / Bush Anemone *
8' x 5', Partial Sun



Iris douglasiana / Douglas Iris *
2' x 3', Partial Sun/Shade tolerant



Mahonia aquifolium 'Compacta' / Compact Oregon Grape *
3' x 4', Sun/Part Shade



Mimulus aurantiacus / Sticky Monkey Flower *
3' x 3', Light Shade



Myrsine africana / African Boxwood
6' x 5', Sun



Myrtus communis 'Compacta' / Dwarf Myrtle
3' x 3', Sun

* California native plant

PLANT IMAGES (continued)

SHRUBS / PERENNIALS (Botanical/Common Name, Mature HxW, Sun Exposure)

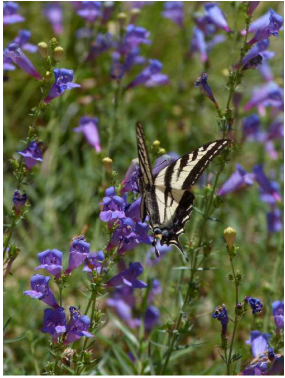

Penstemon species / Beard Tongue *
Size varies, Sun



Raphiolepis u. 'Minor' / Dwarf Yeddo Hawthorn
5' x 3', Sun/Partial shade



Verbena lilacina 'De La Mina' / De La Mina Verbena *
2' x 3', Sun



Westringia fruticosa 'Blue Gem' / Blue Gem Coast Rosemary
5' x 4', Sun

* California native plant

PLANT IMAGES (continued)

GROUNDCOVERS (Botanical/Common Name, Mature HxW, Sun Exposure)



Achillea species / Yarrow
Size Varies, Sun



Festuca glauca / Blue Fescue
1' x 2', Sun



Heuchera species / Coral Bells *
Size Varies, Partial Sun/Part Shade



Lippia nodiflora / Kurapia
3" x Spreading, Sun



Myoporum parvifolium / Myoporum
6" x spreading, Sun



Senecio mandraliscae or *serpens* / Blue Chalksticks
6"-12" x spreading, Sun

* California native plant