



**DEPARTMENT OF PLANNING AND COMMUNITY
DEVELOPMENT**

**COMMERCIAL AND RESIDENTIAL
DEVELOPMENT SUMMARY**

SEPTEMBER 2007

City of Agoura Hills' Development Summary
Table of Contents for Commercial Cases (September 2007)

Proj. No.	Project Name	Case No.(s)	Project Location
IN REVIEW			
1	Hammend	99-SPR-010	Dorothy Dr.
2	Berman, Shirlie (Burgundy Creek Bistro)	00-CUP-009 00-OTP-008	Vacant lot west of 28818 Agoura Rd.
3	Rose (Stuart Rose)	01-SPR-009	5216 Chesebro Rd.
4	E.F. Moore & Co.	03-CUP-006	SEC of Agoura and Kanan
5	Heathcote for Buckley	03-CUP-019	South of Agoura Rd., near western City Limits
6	Heathcote for Silver Reek LLP Conerstone	03-CUP-024	SEC Agoura Rd. and Cornell Rd.
7	Agoura Business Center (D. Poe)	04-CUP-002	5301 Derry Ave. No.W. corner of Derry and Canwood
8	Kim	05-VAR-006	5115 Clareton Dr.
9	Conejo Jewish Day School	05-CUP-003	29646 Agoura Rd.
10	Brian Norris for Chapter 8	05-CUP-001 Amendment	29020 Agoura Rd.
11	Carlos Khantzis	05-PSR-004	30800 Agoura Rd.
12	Sunbelt enterprises	05-CUP-005	29541 & 29555 Canwood St.
13	Shirvanian Family Investment	06-CUP-003 06-OTP-005 PM 65503	Lots between 28700 and 28811 Canwood Street
14	Danari Oak Creek, LLC for Adler Realty Investments, Inc.	06-CUP-007 06-OTP-016 06-SP-037	Five (5) commercial lots of Tr 53752 on the north side of Canwood St., east of Kanan Rd.
15	Royal Street Communicatioons LLC	06-CUP-011	28001 Dorothy Dr.
16	27489 Agoura Road LLC (Previously known as Cardinal Liberty)	06-SPR-009 PM 67397 (06-PAR-003 / 99-SPR-015)	N/W corner of Liberty Cyn & Agoura Rd.
17	Signature Signs for the Agoura Design Center	06-SP-044	28501; 28505; and 28509 Canwood St.
18	Kanan Properties	P.M. 67466	S.W. corner of Roadside Dr. and Kanan Rd. (Agoura Village Center)

City of Agoura Hills' Development Summary
Table of Contents for Commercial Cases (September 2007)

Proj. No.	Project Name	Case No.(s)	Project Location
19	Wildman Design, LLC/ Eric Rochin	06-SPR-012 06-OTP-032 06-SP-059	28340 Roadside Dr.
20	Kanan Properties	P.M. 67466	S.W. corner of Roadside Dr. and Kanan Rd. (Agoura Village Center)
21	Agoura-Kanan, LLC/ The Martin Group	07-AVDP-001	4995 Kanan Rd. (Southwest corner of Kanan and Agoura Rd.)
22	Elias Ben Hazany	07-CUP-001	5226 Palo Comado Canyon Rd.
23	Omnipoint Communications for T-Mobile USA	07-CUP-002	Approx. address, 4856 Kanan Rd. , Pole #2107098E in the Public Right-of-Way
24	Omnipoint Communications for T-Mobile USA	07-CUP-003	Approx. 228 yards north of Eagleton St. on the west side of Kanan Rd. Pole #2171948E
25	Omnipoint Communications for T-Mobile USA	07-CUP-004	Approx. 3914 Liberty Cyn. Rd. Pole #1587440E in the Public Right-of-Way
26	Meridian Telecom, Inc. for Verizon Wireless	07-CUP-006	30401 Agoura Rd.
27	Vinod & Chanresh Gupta Trust	07-PSR-001 (Ref. Cases: 07-CUP-009; 07-CUP-012)	29760 Agoura Road
28	David Myers/Ware Malcomb for Venture Corporation	07-PAR-003	29508 Roadside Dr. or 29505 Agoura Rd.
29	Rhomboid (former Minder/Samson Dev.)	01-SPR-004; Tr.53543; 02-OTP-002	5241 Colodny
30	SureSite/Omnipoint Communications for T-Mobile	07-CUP-007	5844 Larboard Lane
31	Luithly, Joseph	07-CUP-008 and 07-OTP-005	28818 Agoura Road
32	Vinod & Chanresh Gupta Trust	07-CUP-009 and 07-OTP-012	29760 Agoura Road
33	Coast Sign for Agoura Hills Investors (Gerald Collier)	07-SP-017	5667 Kanan Road

City of Agoura Hills' Development Summary
Table of Contents for Commercial Cases (September 2007)

Proj. No.	Project Name	Case No.(s)	Project Location
34	Ware/Malcomb for Agoura Business Center West, LLC/ William Poe	07-CUP-010; 07-GPA-001; 07-ZC-001; PM69426	NW corner of Canwood and Derry
35	Moe Sherif for GU	07-SPR-012; 07-VAR-003; 07-SP-024	29338 Roadside Drive
36	Dollinger Properties for Joseph Shaboni	07-PAR-004	29401 Canwood Street
37	PS Services for First Horizon	07-SP-028	28236 Roadside Drive
38	Agile Ventures, LLC	07-AVDP-003	28870 Agoura Road
39	Roger Ebrahimi	07-SP-035	29348 Road

PROJECTS REVIEWED BY THE PLANNING COMMISSION

1P	St. Paul's Lutheran Church	00-SPR-012 (Admin.)	30600 Thousand Oaks Blvd.
2P	Rasmuseen, Larry	99-CUP-006 PM 26009 99-OTP-006	N. Agoura Rd. East of Palo Comado
3P	Silagi "Canwood Plaza" Bldg. C	00-CUP-010 Amendment	NW Corner Kanan Rd. & Canwood Street
4P	Semler (Alan Hartley)	00-CUP-011 00-LLA-001 01-OTP-008 PM26239	NEC Canwood St. and Derry Ave.
5P	Development Partners	00-SPR-001 00-OTP-001	30101 Agoura Ct.
6P	Realty Bancorp Equities	01-SPR-011 02-VAR-007	29901 Agoura Rd.
7P	Infranext, Inc for AT&T	03-CUP-005	28545 Driver Ave.
8P	Stockton for Levy	02-SPR-021	288211 Canwood St.
9P	BBA Properties LLC for Michael Browers	02-SPR-016 02-OTP-011 TE#1 TE#2	28371 Agoura Road
10P	Hillel	05-SPR-015	Two lots at SE corner of Palo Comado and Chesebro Road

City of Agoura Hills' Development Summary
Table of Contents for Commercial Cases (September 2007)

Proj. No.	Project Name	Case No.(s)	Project Location
11P	Heathcote for T. R. Funding (see Development Partners)	04-SPR-005	30101 Agoura Ct.
12P	Adobe Cantina	03-SPR-010	29100 Agoura Rd.
13P	Scheu (Corp. Point)	98-CUP-012 & 98-LLA-003	S/S Agoura Rd. @Reyes Adobe Rd.
14P	BBA Properties	06-SPR-006 & 06-OTP-024 Amendment (Ref. Case No. PM27094)	28371 Agoura Road
15P	New Com. Jewish School	04-CUP-006	29903 Agoura Road
16P	Meridian for Verizon Wireless	04-CUP-005	28545 Driver Ave.
17P	Alesco Development	02-CUP-004 02-LLA-001 03-OTP-015 03-VAR-007	NEC Chesebro and Agoura Rds.
18P	Agoura Detailing Center	03-CUP-014	100 Reyes Adobe
19P	Adler Realty	04-CUP-007 04-OTP-020 04-LLA-011 PM 62245	Canwood St between Lewis and Derry Ave.
20P	California Neon Products (for Mi Pollo Loco)	04-SP-005 05-SM-002	5050 Kanan Rd.
21P	Behr Browers Properties, LLC	PM27094 reinstatement	28371 Agoura Road
22P	Scheu Development Co. for Agoura Hills Corporate point, LLC	98-CUP-012 and 98-OTP-010 Amendment	30200 and 30300 Agoura Road
23P	Conoco/Phillips	05-SP-022	28203 Dorothy Dr.
24P	Doss for Rick Principe (TR Funding) Development Partners	00-SPR-001 Amendment #1	30101 Agoura Ct.
25P	HQ Development for Agoura Hills Acquisition, LLC	05-SPR-010 05-OTP-010 05-SP-006	29621 Agoura Rd.

City of Agoura Hills' Development Summary
Table of Contents for Commercial Cases (September 2007)

Proj. No.	Project Name	Case No.(s)	Project Location
26P	Wm. Paul Companies for Archstone Smith	05-SP-059 and 05-VAR-008	29128 Oak Creek Lane
27P	GU	05-VAR-007	29338 Roadside Dr.
28P	Todd Ryzow	06-CUP-002	5653 Kanan Rd.
29P	Center Ct.Plaza/Silagi	04-CUP-010 Tr. 62211	29501 Canwood St.
30P	St Paul Lutheran Church	04-CUP-009	30600 Thousand Oaks Blvd.
31P	Agoura Equip. Rental	07-MOD-001	29149 Agoura Road
32P	Temple Beth Haverim	02-CUP-010 Amendment	29900 Ladyface Cir.
33P	Rick Principe	00-SPR-001 Amendment #2 06-VAR-003	30101 and 30077 Agoura Court
34P	Vogue Signs for Farmers Insurance	06-SP-028	30801 Agoura Rd.
35P	BBA Properties LLC for Michael Browers	06-SPR-006	28371 Agoura Rd.
36P	Conejo Jewish Day School	06-CUP-010 06-SPA-002	29001 Ladyface Ct. (Temple Beth Havarim site)
37P	Rabbi Bryski for the Chabad of the Conejo (Arch. Filiberto Gomez)	06-CUP-006 and 06-VAR-002	30345 and 30347 Canwood St.
38P	Carlos Orozco	06-CUP-012	30315 Canwood St.
39P	Ferguson, James	04-ZOA-004	City wide
40P	Michael Tuckman	02-PSR-002	29130 Roadside Drive
41P	Willy's Smokin BBQ/Marco Gauzurez	05-SPR-029	28434 Roadside Drive

MOST RECENTLY COMPLETED CONSTRUCTION

1C	AT&T Wireless Services (Novak & Assoc.)	02-CUP-003	30105-30131 Agoura Rd.
2C	Temple Beth Haverim	02-CUP-010	29900 Ladyface Cir.
3C	J.G. Management	02-SPR-023	29525 Canwood St.

City of Agoura Hills' Development Summary
Table of Contents for Commercial Cases (September 2007)

Proj. No.	Project Name	Case No.(s)	Project Location
4C	Saylor/Tireman	00-SPR-013	28117 Dorothy Drive
5C	Mahterian	02-SPR-020	28351 Agoura Rd.
6C	The Consulting Group for Cingular	02-CUP-009	29646 Agoura Rd.
7C	Gillian Anguish	03-CUP-021	28914 Roadside Dr.
8C	Reyes Adobe Partners, L.P. (Sleep Shoppe)	02-SPR-008 02-SPR-002 02-OTP-003 03-LLA-002	Reyes Adobe Rd directly south of US 101
9C	Chesebro Properties, LLC	00-SPR-018	5231 Chesebro Rd.
10C	Leader Carpets (Ugrik for Simone)	01-SPR-007 02-OTP-010	28350 Roadside Dr.
11C	J.H. Snyder	01-CUP-009 01-GPA-003 01-ZC-003 01-OTP-005 02-ZOA-001 TR 53752 03-VAR-003 03-VAR-008	North of Canwood St, east of Kanan Rd.
12C	Levy, Moshe	00-SPR-019, 00-OTP-016, 00-ABAN-003	Roadside Dr., west of Lewis Rd.
13C	Warehouse Discount	03-SPR-002	30621 Canwood St.
14C	J.G. Management	03-SPR-007	29525 Canwood St.
15C	Cingular Wireless	03-CUP-013	28545 Driver Ave.
16C	Wickman "Agoura Furniture Center"	00-SPR-020 00-OTP-017 PM 26535 00-SPR-020 Amendment 04-SP-050 Amendment 05-LLA-004	28205 & 28207 Canwood St.

City of Agoura Hills' Development Summary
Table of Contents for Commercial Cases (September 2007)

Proj. No.	Project Name	Case No.(s)	Project Location
17C	Texaco -> Shell (Ambience Engineering)	02-SPR-009 02-SP-012 03-VAR-003 03-CUP-009	5227 Palo Camodo Rd.
18C	Pacifica Property Management	04-SP-035	30301 Agoura Rd.
19C	HRS Architects for Countrywide	02-SPR-019 03-SP-027	29851 and 29701 Agoura Rd.
20C	FDSI	05-SP-047	28001 Dorothy Dr.
21C	Cimm's for Burger King	04-SM-001	29136 Roadside Dr.
22C	Signature/Wickman	04-SP-050 & Amendment	28205/29207 Canwood
23C	THQ	05-SPR-004 05-VAR-002 05-OTP-004 05-SP-023 05-SPR-004	29903 Agoura Rd.
24C	Diaz for Simply Discount Furniture	05-SP-044	28714 Canwood St.
25C	Lovelace for McDonald's	05-SPR-018 05-SP-035	29161 Canwood Street
26C	Selleck Dev. Grp.	04-SPR-020	29508 Roadside Drive
27C	Fire Station No. 89	N/A	Canwood St., east of Strawberry Hill Dr.
28C	Ball Properties (Centerpointe)	99-CUP-013 99-CUP-013 Amendment for time extension 05-LLA-001	30005 & 30009 Ladyface Cir.
29C	Joni and Friends International Disability Center	07-SP-007	30009 Ladyface Court
30C	Employer's Direct	06-SP-050	30301 Agoura Road
31C	Heyman/Finefrock	04-SPR-024 05-CUP-001 05-ODP-001 05-VAR-001	29020 Agoura Rd, Unit 14

City of Agoura Hills' Development Summary
 Table of Contents for Commercial Cases (September 2007)

Proj. No.	Project Name	Case No.(s)	Project Location
32C	N W Rugs (by 'Sign A Rama')	86-SP-045 (Amendment)	28610 Canwood St.
33C	HBF Holdings	03-CUP-018; 04-SP-047; 05-LLA-002 Amendment 06-SP-026	North of Canwood and West of Clareton Drive
34C	Mahterian for Vannelli	04-SPR-015 04-OTP-017 04-LLA-015	28205 Agoura Road
35C	Signature Signs for Ygal Levy	06-SP-023	28811 Canwood Street
36C	Zaghi	04-SPR-010 formerly: 03-CUP-008 03-VAR-004	29348 Roadside Dr.
37C	Fox for AT&T	04-CUP-004	5126 Clareton Dr.

**Commercial Cases
September 2007**

Proj. No.	Project Name	Case No.(s)	Project Location	Parcel Number	Site Size	Floor Area	Project Description	Case Planner
IN REVIEW								
1	Hammond	99-SPR-010	Dorothy Dr.	2061-012-042	N/A	N/A	Code Enforcement referral as non-conforming outdoor storage	C.A.
2	Berman, Shirlie (Burgundy Creek Bistro)	00-CUP-009 00-OTP-008	Vacant lot west of 26818 Agoura Rd.	2061-029-003-006	2 acres	11,000 sqft.	New restaurant and reception hall	A.C.
3	Rose (Stuart Rose)	01-SPR-009	5216 Chesebro Rd.	2062-008-041+042	1.5 acres	N/A	Code Enforcement: Parking, screening and landscape improvements required.	D.H.
4	E.F. Moore & Co.	03-CUP-006	SEC of Agoura and Kanan	2061-031-020	18 acres	118 du, 91,800 retail, 10,000 office	Agoura Village Mixed Use Development	A.C.
5	Heathcote for Buckley	03-CUP-019	South of Agoura Rd., near western City Limits	2064-004-022 2061-001-031	3 acres	14,075 sqft.	Commercial/Medical Building	A.C.
6	Heathcote for Silver-Reek LLP - Cornerstone	03-CUP-024	SEC Agoura Rd. and Cornell Rd.	2061-029-008 thru 16 2061-030-001 thru 013	243,172 sqft.	26,000 sqft Retail 18,000 sqft. Office 41,000 sqft Residential	Mixed-Use Development	A.C.
7	Agoura Business Center (D. Poe)	04-CUP-002	5301 Derry Ave. No.W. corner of Derry and Canwood	2048-012-022	32,169 sqft.	19,810 sq.ft.	Multi-tenant industrial building,warehouse,office,storage,light manufacturing.	V.D.
8	Kim	05-VAR-006	5115 Clareton Dr.	2048-011-039	N/A	N/A	Parking Reduction for a medical tenant.	R.M.
9	Conejo Jewish Day School	05-CUP-003	29646 Agoura Rd.	2061-033-013	N/A	N/A	Request to operate an elementary school.	V.D.
10	Brian Norris for Chapter 8	05-CUP-001 Amendment	29020 Agoura Road	2061-031-023 and 024	N/A	N/A	Amend CUP to add 3-piece band 5 p.m. to 10 p.m. Tues. through Friday nights	V.D.
11	Carlos Khantzis	05-PSR-004	30800 Agoura Rd.	2061-001-025	6.31 ac.	57,391 sq.ft.	46 senior condos	D.H.
12	Sunbelt enterprises	05-CUP-005	29541 & 29555 Canwood St.	2063-001-008	3.23 ac	25,200 sq.ft.	2 identical 12,600 sq. ft. medical & general office bldgs.	V.D
13	Shirvanian Family Investment	06-CUP-003 06-OTP-005 PM 65503	Lots between 28700 and 28811 Canwood Street	2048-012-026	10.02 acres	113,000 sqft.	Industrial park with 7 buildings	D.H.
14	Danari Oak Creek, LLC for Adler Realty Investments, Inc.	06-CUP-007; 06-OTP-016; 06-SP-037	Five (5) commercial lots of Tr 53752 on the north side of Canwood St., east of Kanan Rd.	2049-011-049; 2048-011-050; 2048-011-051; 2048-011-052; 2048-011-053; 2049-011-061;	Lot 3 has 1.2 ac. and an additional section of 16,450 sq. ft.; Lot 4 has 38,897 sq. ft.; Lot 5 has 43,470 sq. ft.; Lot 6 has 1.26 ac.; Lot 7 has 35,419 sq. ft.	Building A: 7,360 sq. ft. Building B-1: 6,000 sq. ft. Building B-2: 6,800 sq. ft. Building C-1: 7,500 sq. ft. Building C-2: 7,000 sq. ft.	Construct 5 buildings, totaling 34,680 sq. ft: 2 retail buildings of 6,000 sq.ft. and 7,000 sq.ft., with a 1,420 sq.ft. portion for multi-use; and 3 restaurant buildings of 5,940 sq.ft., 6,800 sq.ft. and 7,500 sq. ft. And implement a sign program.	D.H.
15	Royal Street Communications LLC	06-CUP-011	28001 Dorothy Dr.	2061-011-021			6 panel antennas, 1 GPS antenna, 1 microwave antenna, 4 equipment cabinets	V.D.
16	27489 Agoura Road LLC (Previously known as Cardinal Liberty)	06-SPR-009 PM 67397 (06-PAR-003 /99-SPR-015)	N/W corner of Liberty Cyn & Agoura Rd.	2064-006-006,007,009, 016,018,019	5 empty lots and one developed lot for a site total of approx. 4.18 acres	30,000 sq. ft. (existing bldg. on site is 24,450 sq. ft.)	2 bldgs. One single-story, 10,000 sq.ft. and one two-story, 20,400 sq. ft. + Parcel Map to combine the 6 lots.	V.D.
17	Signature Signs for the Agoura Design Center	06-SP-044	28501; 28505; and 28509 Canwood St.	2048-012-017; 018			Sign Program for the Agoura Design Center	R.M.

**Commercial Cases
September 2007**

Proj. No.	Project Name	Case No.(s)	Project Location	Parcel Number	Site Size	Floor Area	Project Description	Case Planner
18	Kanan Properties	P.M. 67466	Southwest corner of Roadside Dr. and Kanan Rd. (Agoura Village Center)	2061-004-032; 2061-004-033	Orig.lot(s) 3.75 ac. and 22,650 sq. ft.	3.29 ac. and .52 ac. and .64 ac. and .77 ac.	A Tent. Parcel Map to subdivide one property into 4 separate lots	V.D.
19	Wildman Design, LLC/ Eric Rochin	06-SPR-012 06-OTP-032 06-SP-059	28340 Roadside Dr.	2061-009-044	.079 ac.	21,590	Construction of new Commercial Building	V.D.
20	Kanan Properties	P.M. 67466	Southwest corner of Roadside Dr. and Kanan Rd. (Agoura Village Center)	2061-004-032;2061-004-033	Orig.lot(s) 3.75 ac. and 22,650 sq. ft.	3.29 ac. and .52 ac. and .64 ac. and .77 ac.	A Tent. Parcel Map to subdivide one property into 4 separate lots	V.D.
21	Agoura-Kanan, LLC/ The Martin Group	07-AVDP-001	4995 Kanan Rd. (Southwest corner of Kanan and Agoura Rd.)	2061-033-016	21.58 acres	107 residential units of (?) sq.ft. and a total of 167,000 sq. ft. of retail/commercial space.	First phase of development & parcelization of site includes 107 res.units over 62,000sq.ft. of retail space. (other phases to include 30,000 sq.ft. of retail and 75,000 sq.ft. of commercial space).	A.C.
22	Elias Ben Hazany	07-CUP-001	5226 Palo Comado Canyon Rd.	2052-008-030	0.45 ac.	1,454.7 sq. ft.	Remodel existing gas station building and remove the service-bay facilities in order to convert entire building to a Food Mart.	R.M.
23	Omnipoint Communications for T-Mobile USA	07-CUP-002	Approx. address, 4856 Kanan Rd. , Pole #2107098E in the Public Right-of-Way	N/A	N/A	N/A	Install 3 antennas on the existing utility pole with cross arms 25 ft. above grade. Associated radio equip. will also be mounted on the pole. Electric meter pedestal	V.D.
24	Omnipoint Communications for T-Mobile USA	07-CUP-003	Approx. 228 yards north of Eagleton St. on the west side of Kanan Rd. Pole #2171948E	N/A	N/A	N/A	Install 3 antennas above a new 29 ft. 6 in. replacement utility light pole. (Total proposed pole height is 32 ft. 6 in.) Associated radio equip. at grade adjacent to the existing transformer. Electric meter pedestal at grade.	V.D.
25	Omnipoint Communications for T-Mobile USA	07-CUP-004	Approx. 3914 Liberty Cyn. Rd. Pole #1587440E in the Public Right-of-Way	N/A	N/A	N/A	Install 3 antennas on existing 75 ft. utility with cross arms to mount antennas 30 ft. above grade. Associated radio equip. mounted on pole. Electric meter pedestal at grade.	V.D.
26	Meridian Telecom, Inc. for Verizon Wireless	07-CUP-006	30401 Agoura Rd.	2061-002-047	N/A	N/A	Install rooftop wireless communications site consisting of 12 panel antennas(4 antennas per sector-3 sectors) Each antenna's size is 4'x1'x6" and 4 outdoor radio equip. cabinets. Entire facility to be screened to match existing.	V.D.-R.M.

**Commercial Cases
September 2007**

Proj. No.	Project Name	Case No.(s)	Project Location	Parcel Number	Site Size	Floor Area	Project Description	Case Planner
27	Vinod & Chanresh Gupta Trust	07-PSR-001 (Ref.Cases: 07-CUP-009 07-CUP-012)	29760 Agoura Road	2061-033-015	1.65 acre	15,000 sq. ft.	A Pre-Screen Review application to have the Council consider a Specific Plan Amendment to allow a 15,000 sq.ft. building instead of an 8,000 sq. ft. bldg., which is required by the Ladyface Mtn. Specific Plan.	D.H.
28	David Myers/Ware Malcomb for Venture Corporation	07-PAR-003	29508 Roadside Drive or 29505 Agoura Road based upon the project orientation	2061-004-030	5.71 acres	73,800 sq. ft.	A proposed commercial condominium development consisting of 38 individual properties which will range in size from 1,100 to 3,413 sq. ft.	V.D.
29	Rhomboid (former Minder/Samson Dev.)	01-SPR-004; Tr.53543; 02-OTP-002	5241 Colodny				Amendment to approved application due to developer revisions to approved elevations and site plan and landscaping plan for 19 condos	V.D.
30	SureSite/Omnipoint Communications for T-Mobile	07-CUP-007	5844 Larboard Lane	2056-015-900			Install six(6) antennas flush mounted in a new 50 ft. high monopole. The installation includes six(6) equipment cabinets adjacent to the monopole, surrounded by a masonry equipment enclosure on the Lindero Cyn. Middle School site.	R.M.
31	Luilthly, Joseph	07-DUP-008 and 07-OTP-005	28818 Agoura Road	2061-029-002		1,062 sq. ft.	Convert existing non-conforming S.F. D.U in BP-OR Zone to Com. Bldg. and add a 113 sq.ft. 1st floor addition; a 729 sq. ft. 2nd floor addition and a new 220 sq. ft. covered patio; convert existing lattice patio cover to solid roof and convert the 684 sq.ft. garage to work area.	V.D.
32	Vinod & Chanresh Gupta Trust	07-CUP-009 and 07-OTP-012	29760 Agoura Road	2061-033-015	1.65 ac.	12,700 sq.ft.	Two-story, 12,700 sq. ft. office building	
33	Coast Sign for Agoura Hills Investors (Gerald Collier)	07-SP-017	5667 Kanan Raod	2053-007-025			New Sign Program for the Bank of America	
34	Ware/Malcomb for Agoura Business Center West, LLC / William Poe	07-CUP-010; 07-GPA-001; 07-ZC-001; PM 69426	Northwest corner of Canwood & Derry	2048-012-022 and 2048-012-027	The entire Lot 2 of Tr.33249 is 8.82 buildable area; however, with the new Parcel Map, the project site is proposed to be 1.93 ac.	21,782 sq. ft.	A GPA and ZC app.to change project site from Bus.Manufacturing to Commercial Retail and a CUP app.to construct 3 retail buildings totalling 21,782 sq.ft.	

Commercial Cases
September 2007

Proj. No.	Project Name	Case No.(s)	Project Location	Parcel Number	Site Size	Floor Area	Project Description	Case Planner
35	Moe Sherif for GU	07-SPR-012; 07-VAR-003; 07-SP-024	29338 Roadside Drive	2061-004-025	.62 acres	2,612 sq. ft.	Proposal to eliminate self-service washing stalls & tunnel; maintain two lube bays & add new retail area & office. A Variance is requested to reduce the rear yard setbacks. A Sign Program approval is also requested.	V.D.
36	Dollinger Properties for Joseph Shaboni	07-PAR-004	29401 Canwood St.	2053-001-005	6.05 acres	50,000 sq.ft.	A Pre-application to discuss the issues relative to building a 50,000 sq. ft. health club	V.D.
37	PS Services for First Horizon	07-SP-028	28236 Roadside Drive	2061-008-051	N/A	N/A	A request to amend an approved sign program	B.T.
38	Agile Ventures, LLC	07-AVDP-003	28870 Agoura Road	2061-029-003 and 2061-029-004	Approx. 48,709 sq. ft.	17,045 sq. ft.	Construct a two-story office condo (17 units) (Tr.Map required) on two lots (PM required to combine lots for project.	A.C.
39	Roger Ebrahimi	07-SP-035	29348 Roadside Dr.	2061-004-023	N/A	N/A	Sign Program for center at 29348 Roadside Dr.	B.T.
PROJECTS REVIEWED BY THE PLANNING COMMISSION								
1P	St. Paul's Lutheran Church	00-SPR-012 (Admin.)	30600 Thousand Oaks Blvd.	2054-017-016	N/A	690 sqft. addition	Office Addition to existing church	A.H.
2P	Rasmussen Larry	99-CUP-006 PM 26009 99-OTP-006	N. Agoura Rd. East of Palo Comado	2061-013-045	3.27 acres	45,000sqft.	Office building	J.P.
3P	Silagi "Canwood Plaza" Bldg. C	00-CUP-010 Amendment	NW Corner Kanan Rd. & Canwood Street	2053-001-804	2.03 acres	22,896 sqft.	Office Building	D.H.
4P	Semler (Alan Hartley)	00-CUP-011 00-LLA-001 01-OTP-008 PM26239	NEC Canwood St. and Derry Ave.	2055-003-064 2048-012-017 & 018	6.7 acres	125,000 sqft.	2 Office Buildings	Staff
5P	Development Partners	00-SPR-001 00-OTP-001	30101 Agoura Ct.	2061-003-035	4.3 acres	31,160 sqft.	2 Story office building	D.H.
6P	Realty Bancorp Equities	01-SPR-011; 02-VAR-007; 02-CUP-008	29901 Agoura Rd.	2061-003-023	6.98 acres	76,750 sqft.	Two-story commercial building	D.H.
7P	Infranext, Inc for AT&T	03-CUP-005	28545 Driver Ave.	2048-008-901	n/a	n/a	Wireless telecommunications antenna & equipment bldg.	V.D.
8P	Stockton for Levy	02-SPR-021	288211 Canwood St.	2048-011-032	38,376 sqft.	16,700 sqft.	10,000 Furniture Store, 6,000 sqft. Office Space, 700 sqft. Miscellaneous Uses	D.H.
9P	BBA Properties LLC for Michael Browers	02-SPR-016 02-OTP-011 TE#1 TE#2	28371 Agoura Rd.	2061-009-41,42,45,47 & 49	0.67 acre	9,000 sqft.	Office Building	D.H.
10P	Hillel	05-SPR-015	Two lots at SEC of Palo Comado and Chesebro Road	2055-008-017&019- 2052-008-017&019	1 acre	8,605 sqft.	Car Wash and lube facility	V.D.
11P	Heathcote for T. R. Funding (see Development Partners)	04-SPR-005	30101 Agoura Ct.	2064-003-0332061-003-035	4.3 acres	N/A	Parking lot redesign to replace approved building.	D.H.

**Commercial Cases
September 2007**

Proj. No.	Project Name	Case No.(s)	Project Location	Parcel Number	Site Size	Floor Area	Project Description	Case Planner
12P	Adobe Cantina	03-SPR-010	29100 Agoura Rd.	2061-031-022	33,698 sqft.	682+460 sq.ft.	Enclose outdoor dining patio + add to Kitchen area.	R.M.
13P	Scheu (Corp. Point)	98-CUP-012 & 98-LLA-003	S/S Agoura Rd. @Reyes Adobe Rd.	2061-002-022	87 acres	81,000 sqft.	2 new buildings	D.H.
14P	BBA Properties	06-SPR-006 + 06-OTP-024 Amendment (Reference Case No. PM 27094)	28371 Agoura Rd.	2061-009-041, 042, 045, 047, & 049	.67 acres merged	9,440 sqft.	A request for a time extension for an SPR which approved the construction of an office building.	V.D.
15P	New Com.Jewish Sch	04-CUP-006	29903 Agoura Road	2061-003-029	4.84 ac	103,000 sq.ft.	Sch. Use of building	Staff
16P	Meridian for Verizon Wireless	04-CUP-005	28545 Driver Ave.	2048-008-001-2048-008-901	N/A	N/A	Wireless telecommunications antenna & equipment bldg.	V.D
17P	Alesco Development	02-CUP-004 02-LLA-001 03-OTP-015 03-VAR-007	NEC Chesebro and Agoura Rds.	2061-013-011-031-041-042-043-044-045-028.	4.13 acres	8 Office Buildings: 63,208 sqft.	New office buildings	D.H.
18P	Agoura Detailing Center	03-CUP-014	100 Reyes Adobe	2053-026-078	44,330 sqft.	10,333 sqft.	Auto detailing center with offices	D.H.
19P	Adler Realty	04-CUP-007 04-OTP-020 04-LLA-011 PM 62245	Canwood St between Lewis and Derry Ave.	2055-003-064 2048-012-017 & 018	292,065 sqft.	120,230 sqft.	Furniture/Home Decorating Center	D.H.
20P	California Neon Products (for Mi Pollo Loco)	04-SP-005 05-SM-002	5050 Kanan Rd.	2061-006-045	N/A	N/A	New Sign Program for El Pollo Loco	V.D.
21P	Behr Browers Properties, LLC	PM 27094 reinstatement	28371 Agoura Rd.	2061-009-041; 042; 045; 047; 049			Combine 5 lots into one (1) lot for the purpose of building an office building. Related case is 06-SPR-006	V.D.
22P	Scheu Development Co. for Agoura Hills Corporate point, LLC	98-CUP-012 and 98-OTP-010 Amendment	30200 and 30300 Agoura Road	2061-022-022	26 acres	71,844	Amendment to approved application to extend the approval beyond the allowed extension already granted for two com.office buildings on 5.23 ac. The balance of the site to be deed restricted to prevent development.	D.H.
23P	Conoco/Phillips	05-SP-022	28203 Dorothy Dr.	2061-010-011	.75 acres	N/A	Sign Program Upgrade for a 76 gas station.	V.D.
24P	Doss for Rick Principe (TR Funding) Development Partners	00-SPR-001 Amendment #1	30101 Agoura Ct.	2061-003-035	4.78 net ac.	30,000 sq. ft.	Add a two-story bldg to a site which has an existing building on it. An amendment to the approval, asking to extend the expired approval.	R.M.
25P	HQ Development for Agoura Hills Acquisition, LLC	05-SPR-010, 05-OTP-010, 05-SP-006	29621 Agoura Rd.	2061-003-027	5.17 ac.	95,215 sq.ft.	2-story commercial office bldg.	V.C.
26P	Wm.Paul Companies for Archstone Smith	05-SP-059 and 05-VAR-008	29128 Oak Creek Lane	2048-011-045,046,047,048,057			Replace 2 monument signs (Var. is for more than 1 sign)	V.D.
27P	GU	05-VAR-007	29338 Roadside Dr.	2061-004-025 & 026	24,090 sqft.	N/A	Lot line Adjustment for two commercial parcels.	V.D.

**Commercial Cases
September 2007**

Proj. No.	Project Name	Case No.(s)	Project Location	Parcel Number	Site Size	Floor Area	Project Description	Case Planner
28P	Todd Ryzow	06-CUP-002	5653 Kanan Rd.	2053-007-226	n/a	n/a	Request for a Live Entertainment Permit	V.D.
29P	Center Ct.Plaza/Silagi	04-CUP-010 Tr. 62211	29501 Canwood St.	2053-001-006	3.24 ac.	49,350 sq.ft.	1 Two-story office building	D.H.
30P	St Paul Lutheran Church	04-CUP-009	30600 Thousand Oaks Blvd.	2054-017-016	1,9 acres	960 sqft.	Modular building	V.D.
31P	Agoura Equip. Rental	07-MOD-001	29149 Agoura Road	2061-006-008			Request to allow an existing non-conforming sign to remain larger than Code allows when a portion of the existing letters are changed to re-name the business	B.T.
32P	Temple Beth Haverim	02-CUP-010 Amendment	29900 Ladyface Cir.	2061-005-031	N/A	N/A	Request to extend the life of the temporary sanctuary	J.R.
33P	Rick Principe	00-SPR-001 Amendment #2 06-VAR-003	30101 and 30077 Agoura Court	2061-003-035	N/A	N/A	Request to change colors, materials and architectural features and increase height.	R.M.
34P	Vogue Signs for Farmers Ins.	06-SP-028	30801 Agoura Rd.	2061-001-029			Two wall signs	V.D.
35P	BBA Properties LLC for Michael Browers	06-SPR-006	28371 Agoura Rd.	2061-009-041; 042; 045; 047; 049	Approx. 30,000 sq.ft.	9,400 sq.ft.	TE for case # 02-SPR-016: a new 9,400 sq.ft. office building + parking	V.D.
36P	Conejo Jewish Day School	06-CUP-010 06-SPA-002	29001 Ladyface Ct. (Temple Beth Havarim site)	2061-005-031			A Specific Plan Amendment and a Cond.Use Permit to allow a school to operate on the existing Temple site.	J.R.
37P	Rabbi Bryski for the Chabad of the Conejo (Arch. Filiberto Gomez)	06-CUP-006 and 06-VAR-002	30345 and 30347 Canwood St.	2054-020-038 and 2054-020-039	Existing bldg.lot is 9,970 sq.ft. Proposed bldg. lot is 15,390 sq.ft.	6,999 sq. ft.	Remodel existing Chabad Center bldg. and construct a 6,999 sq.ft. bldg. on rear lot for offices and class rooms.	V.D.
38P	Carlos Orozco	06-CUP-012	30315 Canwood St.	2054-020-040	Two lots, each having 60,760 sq. ft. and 53,940 sq. ft. respectively	Tenant in the Reyes Adobe Shopping Center	Application for a Live Entertainment Permit	V.D. to Britteny
39P	Furguson, James	04-ZOA-004	City wide	N/A	N/A	N/A	Zoning Ordinance Amendment regarding reconstruction of non-conforming buildings.	J.P.
40P	Michael Tuckman	02-PSR-002	29130 Roadside Dr.	2061-006-903	N/A	N/A	Old Library Site: Zone Text Amendment for expansion of the lumber yard and showroom	D.H.
41P	Willy's Smokin BBQ/Marca Gauzurez	05-SPR-029	28434 Roadside Dr.	2061-008-048		273 sq.ft.	Add 273 sq. ft. of office space and kitchen storage	R.M.
MOST RECENTLY COMPLETED CONSTRUCTION								
1C	AT&T Wireless Services (Novak & Assoc.)	02-CUP-003	30105-30131 Agoura Rd.	2061-005-026	1.66 acres	n/a	Wall mounted antennas and related roof-mounted equipment in an existing shopping center	V.D.
2C	Temple Beth Haverim	02-CUP-010	29900 Ladyface Cir.	2061-005-031	n/a	n/a	Tent for worship for a period of three years.	V.D. to Jared

**Commercial Cases
September 2007**

Proj. No.	Project Name	Case No.(s)	Project Location	Parcel Number	Site Size	Floor Area	Project Description	Case Planner
3C	J.G. Management	02-SPR-023	29525 Canwood St.	2053-001-007	170,755 sqft.	n/a	Parking lot redesign.	R.H.
4C	Saylor/Tireman	00-SPR-013	28117 Dorothy Drive	2061-011-018+017+020	0.914 acre	8,000 sqft.	2 Tire Retail Buildings	Staff
5C	Mahterian	02-SPR-020	28351 Agoura Rd.	2061-009-054	6,098 sqft.	1660 sqft. Building	Rehab existing building for an architectural firm	R.H.
6C	The Consulting Group for Cingular	02-CUP-009	29646 Agoura Rd.	2061-033-013	n/a	n/a	Wireless telecommunications antenna & equipment bldg.	V.D.
7C	Gillian Anguish	03-CUP-021	28914 Roadside Dr.	2061-007-041 & 052	N/A	N/A	Request to operate a flea market on the first Saturday of every month.	V.D.
8C	Reyes Adobe Partners, L.P. (Sleep Shoppe)	02-SPR-008 02-SPR-002 02-OTP-003 03-LLA-002	Reyes Adobe Rd directly south of US 101	2061-005-022 and 906	75,000 sqft.	14,500 sqft.	Mattress and bedroom showroom	R.H.
9C	Chesebro Properties, LLC	00-SPR-018	5231 Chesebro Rd.	2052-008-040	19,500 sqft.	8,000 sqft.	New office building	E.B.
10C	Leader Carpets (Ugnik for Simone)	01-SPR-007 02-OTP-010	28350 Roadside Dr.	2061-009-043	35,490 sqft.	14,080sqft.	New carpet/flooring store	E.B.
11C	J.H. Snyder	01-CUP-009 01-GFA-003 01-ZC-003 01-OTP-005 02-ZOA-001 TR 53752 03-VAR-003 03-VAR-008	North of Canwood St, east of Kanan Rd.	2048-011-008 2048-011-009 2048-011-010 2048-011-033 2048-011-036 2048-011-037 2048-011-902	29 acres	Residential = 356,000 sqft. Other components under separate applications	336 apartments	D.H.
12C	Levy, Moshe	00-SPR-019, 00-OTP-016, 00-ABAN-003	Roadside Dr., west of Lewis Rd.	2061-009-050	31,452 sqft. (7.22 acres)	20,830 sqft.	New office building with underground parking	E.B.
13C	Warehouse Discount	03-SPR-002	30621 Canwood St.	2054-005-010	N/A	N/A	Facade Remodel	E.B.
14C	J.G. Management	03-SPR-007	29525 Canwood St.	2053-001-007	N/A	N/A	Revise parking lot grading	R.H.
15C	Cingular Wireless	03-CUP-013	28545 Driver Ave.	2048-008-901	N/A	N/A	Wireless telecommunications antenna & equipment bldg.	V.D.
16C	Wickman "Agoura Furniture Center"	00-SPR-020 00-OTP-017 PM 26535 00-SPR-020 Amendt. 04-SP-050 Amendt. 05-LLA-004	28205 & 28207 Canwood St.	2055-007-119-123+127	2.2 acres	38,760 sqft.	New furniture sales center; Bldg A 17,260 s.f., Bldg B 21,500 sf	D.H.
17C	Texaco -> Shell (Ambience Engineering)	02-SPR-009 02-SP-012 03-VAR-003 03-CUP-009	5227 Palo Camodo Rd.	2052-008-030	0.45 acres	N/A	Remodel, monument sign, minimart.	E.B.
18C	Pacifica Property Management	04-SP-035	30301 Agoura Rd.	2061-002-046	N/A	N/A	Establish a new sign program	V.D.
19C	HRS Architects for Countrywide	02-SPR-019 03-SP-027	29851 and 29701 Agoura Rd.	2061-003-025, 026, 027, 028	328,442 + 206,474 sqft.	N/A	Exterior Improvements to an existing structure.	E.B.
20C	FDSI	05-SP-047	28001 Dorothy Dr.	2061-011-021	0.39 acres	15,000 sqft.	Sign Program	V.D.
21C	Cimm's for Burger King	04-SM-001	29136 Roadside Dr.	2061-006-039	N/A	N/A	Amend the sign program	V.D.

**Commercial Cases
September 2007**

Proj. No.	Project Name	Case No.(s)	Project Location	Parcel Number	Site Size	Floor Area	Project Description	Case Planner
22C	Signature/Wickman	04-SP-050 & Amendment	28205/29207 Canwood	2055-007-119, 120, 121 and 122	N/A	N/A	Signs for Center	V.D.
23C	THQ	05-SPR-004 05-VAR-002 05-OTP-004 05-SP-023 05-SPR-004	29903 Agoura Rd.	2061-003-029	5.18 acres	Existing 103,400 sq.ft. bldg.	Exteropr remodel and add parking on site and off site	D.H.
24C	Diaz for Simply Discount Furniture	05-SP-044	28714 Canwood St.	2048-042-028- 2048-012-022	4.66 acres	6,100 sqft.	Sign Program Amendment for Simply Discount Furniture	V.D.
25C	Lovelace for McDonald's	05-SPR-018 05-SP-035	29161 Canwood Street	2048-011-029	47,589 sq.ft.	5,586 sq.ft.	Building and parking remodel for McDonald's Restaurant.	R.M.
	Selleck Dev. Grp.	04-SPR-020	29508 Roadside Dr.	2061-004-030		12,000 cu.ft.	Dirt stockpile site	D.H.
27C	Fire Station No. 89	N/A	Canwood St., east of Strawberry Hill Dr.	2053-001-900	3.26 acres	12,500 sqft.	New Fire Station (County Project)	M.K.
28C	Bali Properties (Centerpointe)	99-CUP-013 99-CUP-013 Amend. for time extension 05-LLA-001	30005 & 30009 Ladyface Cir.	2061-005-908+909	4.2 acres	Building 1: 27,340sqft Building 2: 33,700sqft	2 office buildings	D.H.
29C	Joni and Friends International Disability Center	07-SP-007	30009 Ladyface Ct	2061-005-063			Sign Program, including a wall sign and a monument sign for the existing building	B.T.
30C	Employer's Direct	06-SP-050	30301 Agoura Road	2061-002-046			Addmendment to existing sign	B.T.
31C	Heyman/Finefrock	04-SPR-024 05-CUP-001 05-ODP-001 05-VAR-001	29020 Agoura Rd, Unit 14	2061-031-023 & 024	1.86 acres	6,000 sqft Tenant Space	1077 sq.ft. Outdoor dining patio and live entertainment at existing restaurant	V.D.
32C	N W Rugs (by 'Sign A Rama')	86-SP-045	28610 Canwood St.	2048-012-016			Request for a new sign program for the existing store	V.D.
33C	HBF Holdings	03-CUP-018 04-SP-047 05-LLA-002 Amendment 06-SP-026	North of Canwood, west of Clareton Dr.	2048-011-033	3 acres	88,108 sqft.	125-Unit Hotel Homewood Suites	D.H.
34C	Mahterian for Vannelli	04-SPR-015 04-OTP-017 04-LLA-015	28205 Agoura Rd.	2061-012-044 & 2061-012-024	2 lots/total of 10,000 sq.ft.	1,019 sq.ft.	1-story addition to an existing office	V.D.
35C	Signature Signs for YGAL LEVY	06-SP-023	28811 Canwood St.	2048-011-032	n/a	n/a	Sign Program for Levy building	V.D.
36C	Zaghi	04-SPR-010 formerly: 03-CUP-008 03-VAR-004	29348 Roadside Dr.	2061-004-023	38,768 sqft.	11,636 sqft.	One-story warehouse and light manufacturing	D.H.
37C	Fox for AT&T	04-CUP-004	5126 Clareton Dr.	2048-011-024	N/A	N/A	Wireless telecommunications antenna & equipment bldg.	V.D.

Commercial Cases In Review
September 2007

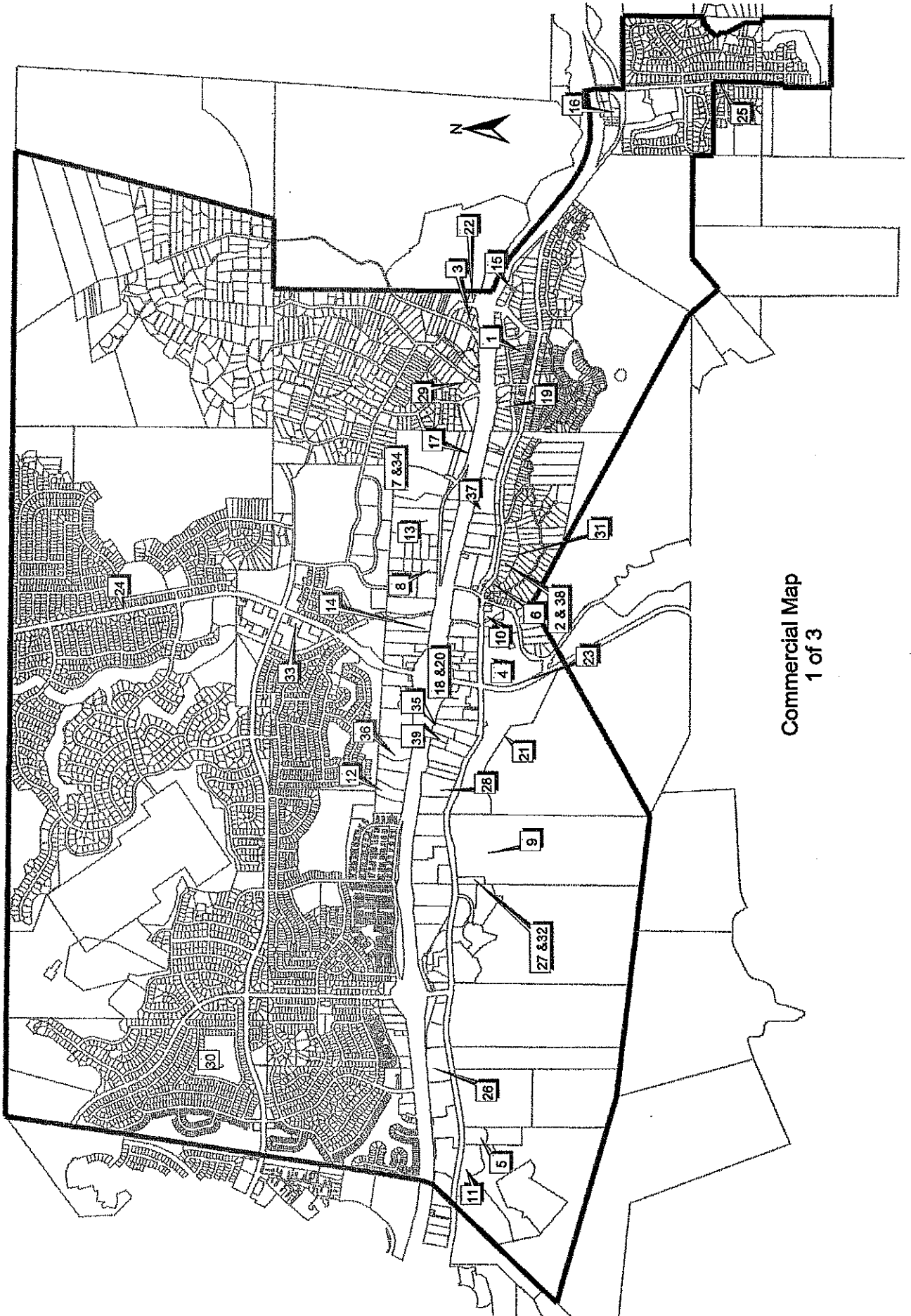

**Commercial Cases
Reviewed by the Planning Commission
September 2007**

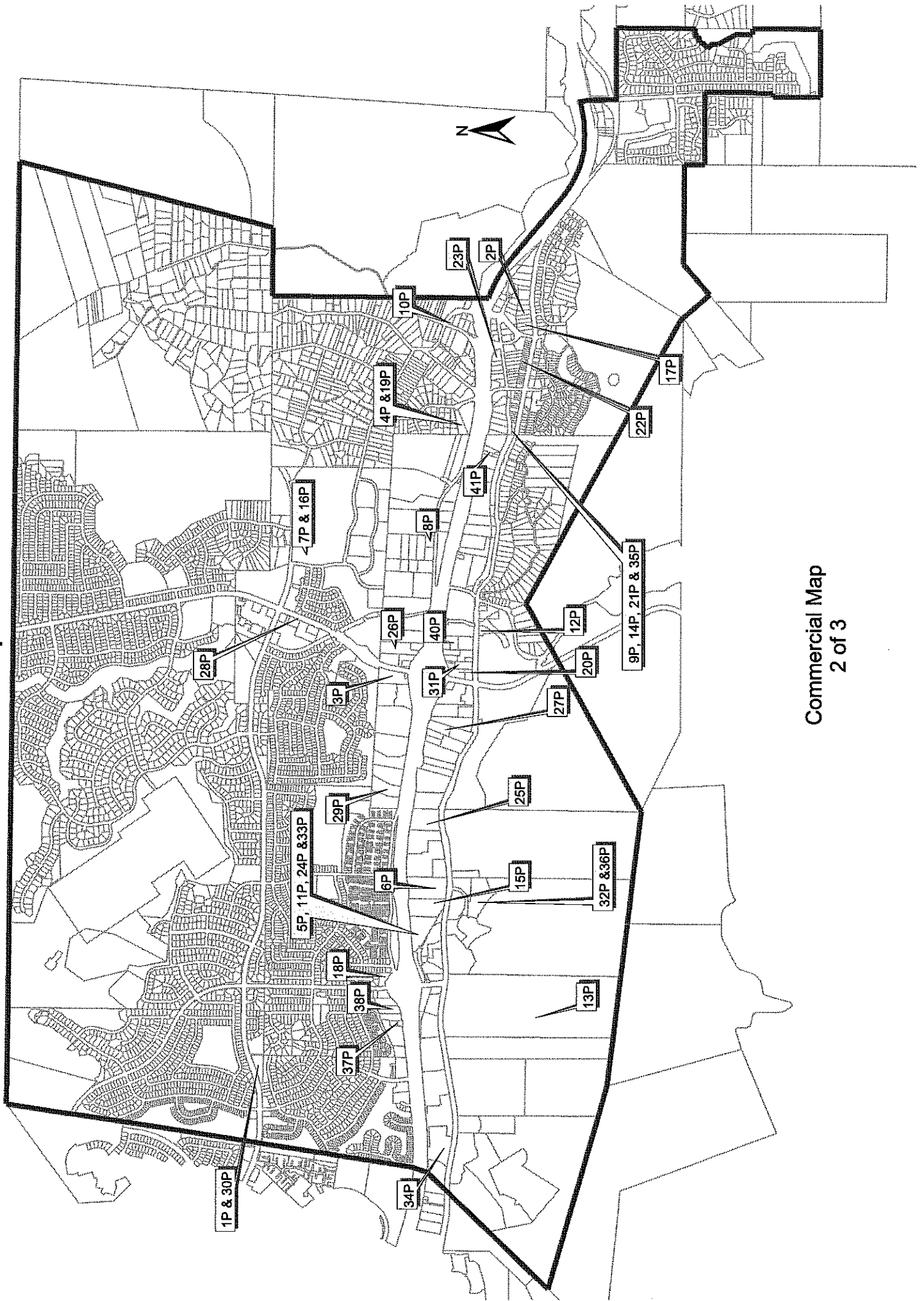

Completed Commercial Cases
September 2007

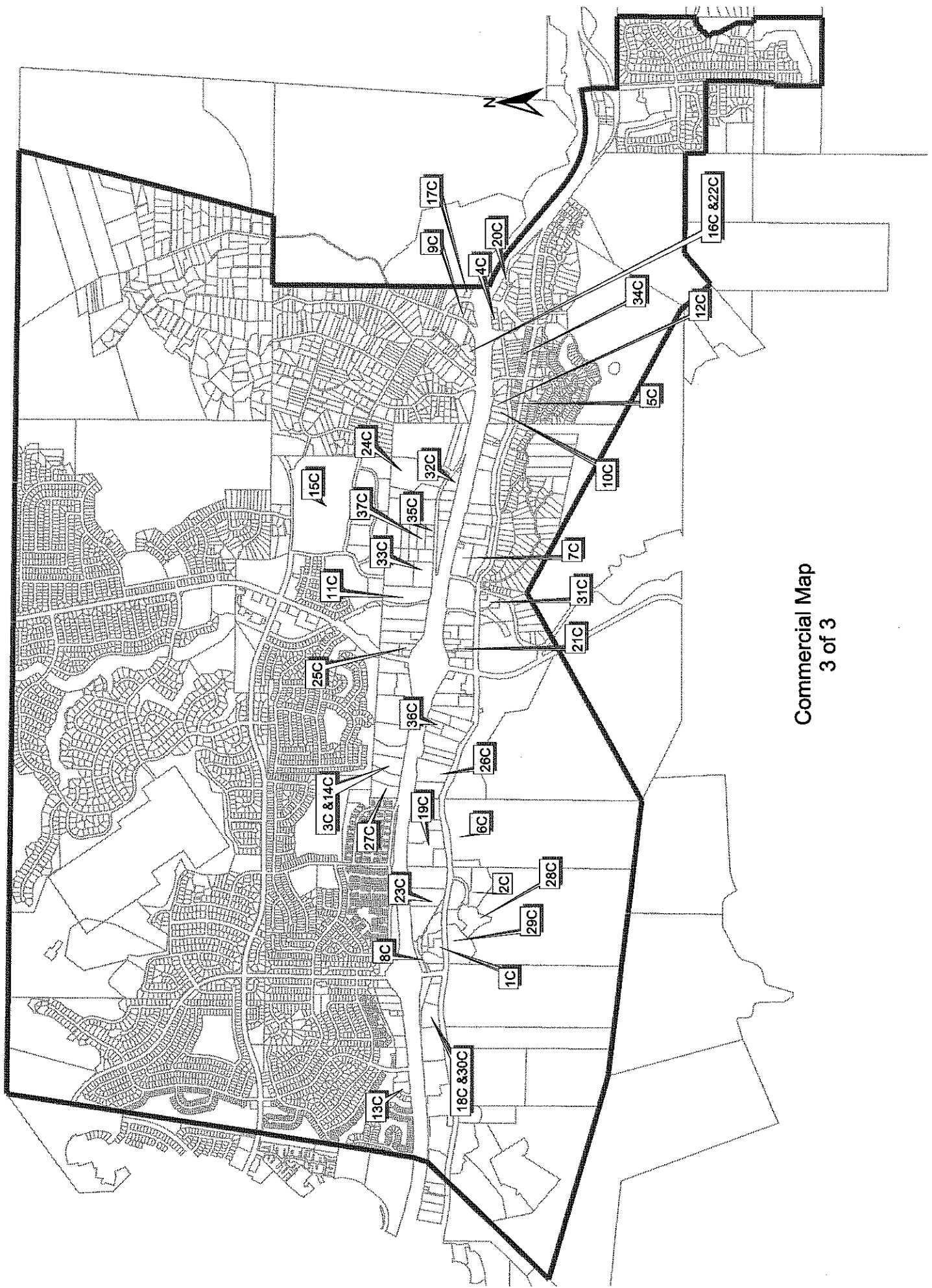

City of Agoura Hills' Development Summary
Table of Contents for Residential Cases (September 2007)

Proj. No.	Project Name	Case No.(s)	Project Location
IN REVIEW			
1	Fillon	02-SPR-007	28220 Foothill Dr.
2	Finkelstein Waters	03-CUP-002 03-OTP-002	28031 Balkins Dr.
3	Scheff	03-SPR-006	28314 Foothill Dr.
4	Stockton/lamburg	03-CUP-016 03-OTP-017	6149 Palo Comado Canyon Rd.
5	Ashnoor Pirouti	03-CUP-022	28454 Renee Dr.
6	Ashnoor Pirouti	03-CUP-023	28458 Renee Dr.
7	Lampert, Greg	04-LLA-013 To be upgraded to a Parcel Map	5911 Fairview Pl.
8	Yvanova for Laura La Plante LLC	05-CUP-002 05-VAR-003 05-LLA-003 05-OTP-015	28221 Laura LaPlante Dr.
9	Holmes for Morse	05-SPR-022 and 05-OTP-029	5810 Colodny Dr.
10	McAfee, Jane	05-SPR-026	5451 Colodny Dr.
11	Siboni	05-SPR-028	5446 Lewis Rd.
12	CC&R for Henry Halimi	06-PSR-002	Lot G no. of T.O.Blvd.,east of Carell
13	Dawson for Sharon	06-CUP-001	28243 Balkins Dr.
14	Steve Potter for John Manos	PM65552	2 parcels on the west side of Foothill, east of Easterly, south of Fountain Pl.
15	Steve and Marguerite Edwards	06-CUP-008 and 06-OTP-017	5952 Lapworth Dr. N.E. corner of Lapworth and Balkins
16	Asa Arava	06-CUP-018 and 06-OTP-025	28443 Foothill Drive
17	Terry and Brian Condon	06-LLA-001	5656 Colodny Dr.

City of Agoura Hills' Development Summary
Table of Contents for Residential Cases (September 2007)

Proj. No.	Project Name	Case No.(s)	Project Location
18	Abudalu, Joseph (Architect: Studio by Design)	06-CUP-019	28303 Laura La Plante Drive
19	DNA Construction for Albaum, David	06-SPR-010	5866 Fairview Place
20	Mike Millett	06-SPR-011 and 06-OTP-031	5446 Fairview Place
21	M. Fredric & Co. (Fred and Lisa Levine)	06-PAR-006	6475 Chesebro Road
22	Hedva Ergas	07-SPR-004	5490 Fairview Pl.
23	Ginsburg, Moty and Margo	07-CUP-005 and 07-OTP-003	5643 Colodny Dr.
24	Shuken, Jonathan (Architect, David Rhea)	07-PAR-001	6491 Chesebro Rd.
25	Ginsburg, Moty and Margo	07-INT-001	5643 Colodny Dr.
26	Jager Associates for Michael Palache	07-PAR-002	Balkins Drive, 3 lots west of Lapworth, behind 2055-021-044
27	Mahterian for Heslen	07-SPR-008	5575 Micaela Dr.
28	Sitin for Daniel Bouganim	07-SPR-009	5519 Lewis Ln.
29	Francisco Vazquez for Janice Atkins	04-SPR-022	28506 Driver Ave.
30	Araujo, Ruben and Debra/ Brent Schneider, Architect	07-SPR-010	6021 Colodny Dr.
31	Sharon, Rafi and Orit	07-SPR-011 and 07-OTP-018	28220 Foothill Dr.
32	Chuck Francoeur for 'Montage Dev.'	Tr. 69073 (related cases 01-SPR-008 and 06-SPR-003)	5310 Colodny Dr.
33	Moshe and Matty Bryski	07-DCP-001	5662 Middlecrest Dr.

City of Agoura Hills' Development Summary
Table of Contents for Residential Cases (September 2007)

Proj. No.	Project Name	Case No. (s)	Project Location
34	Larry Pollock	07-SPR-013	5734 Fairview Pl.
35	Bardai, Nevin (Gary Bardovi Architect/LCE Group, Inc.)	07-CUP-011	Balkins Drive
36	Thomas Brewer	07-PAR-005	4833 Canyon Way
PROJECTS APPROVED & UNDER CONSTRUCTION			
1P	Golenberg	02-SPR-010 02-OTP-008	5927 Colodny Dr.
2P	Minder Rhombold	01-SPR-004 TR53543	5241 Colodny Dr.
3P	Stockton	01-SPR-008	5310 Colodny Dr.
4P	Aviezer	03-CUP-007	27901 Blythdale
5P	Mineo	01-CUP-006 01-VAR-005	Lot 3 on Canyon Wy.
6P	Feehan, Tim	04-SPR-004	5472 Fairview Pl.
7P	San Juan for Sherman	03 -CUP-011	Lewis Rd. (So.of Driver
8P	Ryan	04-MOD-001	29029 Acanthus Ct.
9P	Schwartzberg for Datner	04-SPR-012	6137 Braemar Ct.
10P	Mandler	04-SPR-009	5445 Meadow Vista
11P	Biddison, M	04-SPR-003	28359 Driver Ave.
12P	Jim Hamilton	04-SPR-023 04-MOD-003	5675 Slicers Cir.
13P	Waters Diamond	04-SPR-011	5833 Lapworth Dr.
14P	Swenson and Nadel	03-CUP-011 03-OTP-008	28354 Balkins Dr.
15P	Adivi formerly Levy	03-CUP-003	6029 Fairview Dr.
16P	Schaub for Leggett	04-SPR-018 04-OTP-021	5939 Colodny Dr.
17P	Dawson for Sharon	04-SPR-017	28314 Foothill Dr.
18P	Sears & Chase	04-LLA-014	30020&30014 Trail Creek Drive & HOA Common Area

City of Agoura Hills' Development Summary
Table of Contents for Residential Cases (September 2007)

Proj. No.	Project Name	Case No.(s)	Project Location
19P	Falcone/Garces	05-SPR-006 05-MOD-003	27411 Freetown Ln.
20P	Cooper for Stitt	05-SPR-005 & 05-OTP-007	28037 Balkins Dr.
21P	John/Linda Quinn	05-SPR-007	5703 Willowtree Dr.
22P	Von Buck	03-CUP-017 03-OTP-016	27801 Blythedale Rd.
23P	Blahosky/Mallach	05-SPR-008	5533 Gladehollow Ct.
24P	Linda Rich	05-SPR-009	5626 Fairview Pl.
25P	David Hazlett	05-SPR-013	4956 Vejar Dr.
26P	Cooper/Medvene	05-SPR-003 Refer to 07- SPR-005 and 05-OTP-008	5857 Fairview Pl.
27P	Sisso	05-SPR-017	5415 Lewis Rd. (So.of Driver Ave.)
28P	Roit, Leo	06-CUP-013; 06-VAR-006; 06-OTP-030	28161 Laura LaPlanete
29P	Benton (former Swift Construction for Coglin)	03-CUP-001 03-VAR-001	Lot 18 on Laura La Plante Dr.
30P	Raymond	04-SPR-007	5344 Lewis Rd.
31P	Zoldan	05-SPR-016	5950 Lapworth Dr.
32P	Leininger, Bart & Laura	05-SPR-025	6162 Lake Lindero Dr.
33P	Jacob	05-SPR-002 now 05-CUP-005 + 05-VAR-008 and 05-OTP-003	North of 5847 Colodny Dr.
34P	ARC Design/Ewing	05-SPR-011	28080 Balkins Dr.
35P	Murphy for Morgan Blinkinsoph for Thompson	04-CUP-003 03-LLA-001 03-PAR-001	Lewis Pl.

City of Agoura Hills' Development Summary
Table of Contents for Residential Cases (September 2007)

Proj. No.	Project Name	Case No.(s)	Project Location
36P	Vasquez for Atkins	04-LLA-012 04-SPR-022 04-CFC-001	28506 Driver Ave.
37P	Mahterian for Turley	05-SPR-001	6144 3/4 Chesebro Rd.
38P	Payan	04-CUP-001 04-VAR-001	28254 Laura La Plante Dr.
39P	Mahterian for Mogan	05-CUP-004 05-MOD-005 05-LLA-008	28250 Laura LaPlante Dr.
40P	Rooney	05-SPR-021 05-MOD-006	5515 Rocktree Dr.
41P	Stockton for Sisso	06-SPR-004	5415 Lewis Rd. (So.of Driver Ave.)
42P	Scott Berg for Kearns	06-SPR-002	5740 Colodny Dr.
43P	Dembsky for Almany	05-MOD-006	3945 United Rd.
44P	McCann for Anav	05-SPR-027	5533 Fairview Pl.
45P	Pendlebury for Barnett	06-SPR-001	6044 Chesebro Rd.
46P	Bezalel for Beckerman	06-SPR-005	27862 Blythdale Rd.
47P	CJF Development Consultants for "Montage"	06-SPR-003	5310 Colodny Dr.
48P	Frank LaRosa and Emily Prano	06-SPR-007	5348 Chesebro Rd.
49P	Roser	03-CUP-020	28537 Fountain Pl.
50P	Foster	04-SPR-019	5545 Foothill Dr.
51P	Riopharm USA Inc.	03-CUP-010 03-VAR-005 TR 48901	South side of Agoura Rd between Palo Comado and Liberty Canyon
52P	Riopharm 2	TT48901 90-CUP-010 98-CUP-007	27650 Agoura Rd.
53P	Mogan, Tom/Susan	05-CUP-004	28259 Laura LaPlante
54P	Vladimir Zlatkov	06-CUP-004 refer to 05-PAR-003	28331 Laura LaPlante Dr.

City of Agoura Hills' Development Summary
Table of Contents for Residential Cases (September 2007)

Proj. No.	Project Name	Case No.(s)	Project Location
55P	Agoura TNT LLC/Terry Gray	06-CUP-005 and 06-OTP-008	6170 Fairview Pl.
56P	N.E. Designs for Bar family	06-SPR-008	28466 Foothill Dr.
57P	Bagwell Construction for Joel Rizor	07-SPR-001	5709 Fairview Pl.
58P	Linda Medvene	07-SPR-005 and 05-OTP-002 (related case: 05-SPR-003)	5857 Fairview Pl.
59P	Carroll, Gerald	07-SPR-006	5730 Fairview Pl.
60P	Bailey for Tamara Friend	07-SPR-007 and 07-OTP-009	6350 Chesebro Rd.
61P	Charles Blaugrund for Mr. and Mrs. Joey Butson	07-SPR-002 and 07-VAR-001	5619 Slicers Circle
62P	Zev Beckerman	07-SPR-003	27862 Blythdale Rd.
63P	Leo Feierelsen for Garner	07-SPR-014	29004 Indian Ridge Court

MOST RECENTLY COMPLETED CONSTRUCTION

1C	Gniadek/ Bullmer for Rasmussen	02-SPR-016	28611 Bamfield Ct.
2C	Crosby	01-CUP-010 01-VAR-011	28357 Foothill Dr.
3C	Parrott/ Green	03-SPR-004	29734 Blythedale Rd.
4C	Rosas	02-SPR-01	28366 Agoura Rd.
5C	Cardoni Group for Heflin	02-SPR-001	5626 Colodny Dr.
6C	Casey	02-SPR-013	5560 Fairview Pl.
7C	Ybanez	01-SPR-003 (Admin.)	5505 Foothill Dr.
8C	Littman	02-SPR-022	5401 Fairview Dr.
9C	Sorgenstein/ Parrot	03-CUP-004 and Amendt.	5364 Lewis Rd.

City of Agoura Hills' Development Summary
Table of Contents for Residential Cases (September 2007)

Proj. No.	Project Name	Case No.(s)	Project Location
10C	Tamaye	03-MOD-002	3955 Patrick Henry Rd.
11C	Palo Comado Ranch	97-CUP-012 TT52397	w/s of Chesebro Rd. at northerly city limits
12C	Marlow for Schiffman	04-SPR-006	28461 Driver Ave.
13C	Gray	03-CUP-012	5936 Fairview Pl.
14C	Moraga	02-CUP-001	6000 Fairview Pl.
15C	ARC Inc.	02-SPR-012	29236 Laro Dr.
16C	Dan Sheldon	00-CUP-005	28232 Driver Ave.
17C	Phillips	03-PAR-006 03-CUP-015 03-OTP-006	5743 Fairview Pl.
18C	Stockton for Britton	03-SPR-005	27918 Blythedale Rd.
19C	Oak View Ranch	03-LLA-004 03-LLA-005 03-LLA-006	Various properties on Amelia Drive, Erta Court-Evita Court, Adelina Court Lots 46 of Tract 36749 and 62,63 & 64 of Tract 36746
20C	Gaines	03-SPR-009	6070 Chesebro Rd.
21C	Carpenter for Danielson	01-CUP-013	28428 Lewis Pl.
22C	DNA Construction for Mahler	04-SPR-013	5732 Rainbow Hill Rd.
23C	Linda Tatum	03-CUP-004 Amendment	5364 Lewis Rd.
24C	Odney	05-SPR-019	30716 Lakefront Dr.
25C	Forest Construction for M/M Mohammadi	04-SPR-014	29033 Woodcreek Ct
26C	Richard Goodman	05-LLA-005	5437 and 5445 Colodny Dr.
27C	Shifman, Alan	04-SPR-016 & Amendment	5539 Fairview Pl.
28C	RJ Builders for Kupfer	05-MOD-001	29679 Kimberly Dr.
29C	Benhaim for Alkoby	04-SPR-021	28326 Foothill Dr.
30C	Mahterian for Clark	04-SPR-008	28242 Foothill Dr.

City of Agoura Hills' Development Summary
 Table of Contents for Residential Cases (September 2007)

Proj. No.	Project Name	Case No.(s)	Project Location
31C	Ryan & Lynette Lee	05-MOD-004	29577 Fountainwood St.
32C	Schneider	00-SPR-007 01-OTP-011	5276 Colodny Dr.
33C	JOR Development for Rocca	04-SPR-001	5425 Lewis Rd.
34C	Darryl Levine	05-SPR-023	5540 Colodny Dr.
35C	Scaglioni	00-CUP-004	28331 Foothill Dr.
36C	CC&R for Henry Halimi	06-PSR-002	Lot G no. of T.O.Blvd.,east of Carell
37C	Richard Goodman	05-LLA-010	5437 and 5445 Colodny Dr.
38C	Peter Stern	04-SPR-025 05-MOD-002	5544 Colodny Dr.
39C	Flint	05-SPR-020	5552 Colodny Dr.
40C	Kersey	04-CUP-008 04-VAR-003 04-PAR-001	28406 Lewis Pl.

Residential Cases
September 2007

Proj. No.	Project Name	Case No.(s)	Project Location	Parcel Number	Site Size	Floor Area	Project Description	Case Planner
IN REVIEW								
1	Fillon	02-SPR-007	28220 Foothill Dr.	2055-016-023	31,306 sqft.	1,575 sqft.	Single-family detached residence	R.M.
2	Finkelstein Waters	03-CUP-002 03-OTP-002	28031 Balkins Dr.	2055-023-065	1.59 acres or 69,260 sqft.	5,096 sqft. W/ 790 sqft. Garage	Custom house on hillside lot	V.D.
3	Scheff	03-SPR-006	28314 Foothill Dr.	2055-016-033	22,433 sqft.	2,498 sqft.	Room addition to an existing single-family residence	V.D.
4	Stockton/lamburg	03-CUP-016 03-OTP-017	6149 Palo Comado Canyon Rd.	2055-023-073	40,080 sqft.	4,688 sqft.	A two-story custom house with three car garage	V.D.
5	Ashnoor Pirouti	03-CUP-022	28454 Renee Dr.	2061-021-005	5,040 sq. ft.	1,534 sq. ft.	two-story S.F. D.U	V.D.
6	Ashnoor Pirouti	03-CUP-023	28458 Renee Dr.	2061-021-023	6,452 sq. ft.	1,219 sq. ft.	two-story S.F. D.U	V.D.
7	Lampert, Greg	04-LLA-013 To be upgraded to a Parcel Map	5911 Fairview Pl.	2055-025-060 through 064	N/A	N/A	combine 5 lots	S.S.
8	Yvanova for Laura La Plante LLC	05-CUP-002 05-VAR-003 05-LLA-003 05-OTP-015	28221 Laura LaPlante Dr.	2061-016-063 & 2061-016-072	16,390 sq.ft. (2 lots)	3,400 sq. ft.	SFR, Variance for frontyard setback, lot merger and removal of oak trees	V.D.
9	Holmes for Morse	05-SPR-022 and 05-OTP-029	5810 Colodny Dr.	2055-023-046	2.5 ac.	Square footage was not indicated for all the new structures to be added to the site.	New barn, garage, horse shelters, horse pen, corrals, arena, retaining walls.	V.D.
10	McAfee, Jane	05-SPR-026	5451 Colodny Dr.	2055-013-032	20,512 sq.ft.	771 sq.ft.	Add 771 sq.ft. (2 bedrooms and 2 baths) to existing 3,000 sq.ft. D.U. with a 455 sq.ft. garage.	R.M.
11	Siboni	05-SPR-028	5446 Lewis Rd.	205-005-070 2055-005-070	27,440 sqft.	6,335 sqft.	A 4,995 sqft. Single-family detached residence with 852 sqft. garage and a 488 sqft. pool house.	R.M.
12	CC&R for Henry Halimi	06-PSR-002	Lot G no. of T.O.Blvd., east of Carol	2048-003-002			Pre-screen Review requesting City to vacate easterly portion of T.O. Blvd., to allow a SFR on a Open Space lot	D.H.
13	Dawson for Sharon	06-CUP-001	28243 Balkins Dr.	2055-022-080	1.13 acres	5,678 sqft.	A 4,968 sqft. Single-family detached residence with 710 sqft. garage with pool and spa.	R.M.
14	Steve Potter for John Manos	PM65552	2 parcels on the west side of Foothill, east of Easterly, south of Fountain Pl.	2055-018-022 and 2055-018-023	one lot is 27,880 sq.ft. and one lot is 1.97 ac.	one lot proposed to be 48,295 sq. ft., one lot proposed to be 24,890 sq.ft. and one lot proposed to be 21,815 sq.ft.	A Parcel Map to create 3 lots from 2 hillside lots. Parcel 3 has 2 D.U. and 2 accessory bldgs. One D.U. is to be removed. The one to remain is only 2 to 3 feet from the south property line.	RM
15	Steve and Marguerite Edwards	06-CUP-008 and 06-OTP-017	5952 Lapworth Dr. N.E. corner of Lapworth and Balkins	2055-022-073	Approx. 59,983 sq. ft.	4,950 sq.ft. , 908 sq.ft., 347 sq. ft., and 1,502 sq. ft. Total of 7,707 sq. ft.	A 2-story 4,950 sq.ft. D.U. w/908 sq.ft. attached 3-car garage w/347 sq.ft. studio above garage and 1,502 sq. ft. barr	R.M.

Residential Cases
September 2007

Proj. No.	Project Name	Case No.(s)	Project Location	Parcel Number	Site Size	Floor Area	Project Description	Case Planner
16	Asa Arava	06-CUP-018 and 06-OTP-025	28443 Foothill Drive	2055-019-036	1 acre	4,266 sq. ft.	Three (3) story, 35 ft. high, single-family residence on a hillside lot.	R.M.
17	Terry and Brian Condon	06-LLA-001	5656 Colodny Dr.	2055-011-043 and 2055-011-044	One lot is 21,340 sq. ft. and one lot is 20,470 sq. ft.	Adjust lot lines so that one lot is 21,728 sq. ft. and one lot is 20,150 sq. ft.	Adjust lot lines to accommodate a pool on a lot without a primary structure.	S.S. and Ken Berkman
18	Abudalu, Joseph (Architect: Studio by Design)	06-CUP-019	28303 Laura La Plante Drive	2061-022-051	23,090 sq. ft.	3,630 sq. ft.	Construct 3,230 sq. ft., 2-story S.F.D. with a 400 sq. ft. attached garage.	R.M.
19	DNA Construction for Albaum, David	06-SPR-010	5866 Fairview Place	2055-027-074	81,020 gross sq. ft., 41,810 net sq.ft. after road and flood hazard is subtracted	494 sq. ft.	Construct a 494 sq. ft. single-story room addition to a 2,966 sq. ft. S.F.D. and remodel kitchen	B.T.
20	Mike Millott	06-SPR-011 and 06-OTP-031	5446 Fairview Place	2055-014-018	41,500 sq. ft.	1,399 sq. ft.	Room additions and replacement of master bedroom and bath. Add porch to rear of property	B.T.
21	M. Fredric & Co. (Fred and Lisa Levine)	06-PAR-006	6475 Chesebro Road	2055-029-008	4.52 ac. (.06 ac is driveway and 2.79 ac. is restricted use area. Buildable area is 1.67 ac.)	12,092 sq. ft.	A Pre-App. to discuss issues relative to building a 8,727 sq. ft., 2-story S.F.D. w/ a 779 sq.ft. detached garage, a 429 sq. ft. pool pavilion, a 1,520 sq. ft. pool & deck and a 637 sq. ft. "Art Studio".	V.D.
22	Hedva Ergas	07-SPR-004	5490 Fairview Pl.	2055-014-027	45,005 sq.ft.	799 sq. ft.	Add a 342 sq.ft. family rm. And a 457 sq. ft. office and gym to existing 1,702 sq.ft. D.U. w/ 499 sq.ft. garage.	B.T.
23	Ginsburg, Moty and Margo	07-CUP-005 and 07-OTP-003	5643 Colodny Dr.	2055-012-051	18,840 sq. ft. minus 5,130 sq.ft. of flood hazard area, leaving 13,710 sq.ft. of buildable area	6,752 sq.ft.	Build a 6,752 sq.ft. single-family house. (1st flr. 2,929 sq.ft.; 2nd flr. 2,034 sq.ft.; basement 1,790 sq.ft.)	R.M.
24	Shuken, Jonathan (Architect, David Rhea)	07-PAR-001	6491 Chesebro Rd.	2055-029-003	1.46 ac.	6,546 sq.ft.	Pre-app. to discuss issues re building a 6,546 sq.ft. D.U. (5,109 sq.ft. living area, 1,437 sq.ft. garage)	V.D.
25	Ginsburg, Moty and Margo	07-INT-001	5643 Colodny Dr.	2055-012-051			Interpretation by P.C. Does a 1,790 sq.ft. basement count as a floor and add to height of building	R.M.
26	Jager Associates for Michael Palache	07-PAR-002	Balkins Drive, 3 lots west of Lapworth, behind 2055-021-044	2055-021-018	42,250 sq.ft.	5,500 sq. ft. building area, 690 sq.ft. garage	Pre-app. to discuss issues re building a 5,500 sq.ft., 2-story, single-story D.U. with a 690 sq.ft. garage. Bldg. footprint is 3,444 sq.ft. Paved area is 3,493 sq.ft. Paved driveway area is 11,149 sq.ft.	R.M.

Residential Cases
September 2007

Proj. No.	Project Name	Case No.(s)	Project Location	Parcel Number	Site Size	Floor Area	Project Description	Case Planner
27	Mahterian for Hesen	07-SPR-008	5575 Micaela Dr.	2053-024-097		1,672 sq. ft.	Add 1st. & 2nd. floor bedrooms & a garage totalling 1,672 sq.ft. to an existing 2,857 sq. ft. D.U. with an existing garage.	B.T.
28	Silin for Daniel Bouganim	07-SPR-009	5519 Lewis Lane	2055-017-028	21,490 sq.ft.	694 sq.ft.	Add a 694 sq.ft., first floor master bdrm. & bath to the existing first floor sq. footage of 2,668.	B.T.
29	Francisco Vazquez for Janice Atkins	04-SPR-022 Amendment	28506 Driver Ave.	2055-004-011 and 032	62,820 sq.ft.	426 sq.ft.	Add 426 sq.ft. to an approved project and revise the grading plan to include both of the combined lots.	R.M.
30	Araujo, Ruben and Debra / Brent Schneider, Architect	07-SPR-010	6021 Colodny Drive	2055-028-036	41,820 sq. ft.	8,634 sq.ft.	Construct 2-story, 5,962 sq.ft. S.F.R. with attached 1,622 sq.ft. garage; a 1,050 sq.ft. barn; a driveway motorcourt, a pool, horse riding ring, corrals and horse turn-out area.	R.M.
31	Sharon, Rafi and Ori	07-SPR-011 and 07-OTP-018	28220 Foothill Dr.	2055-016-023	31,360 sq.ft.	5,750 sq.ft.	Construct a 2-story, 3,751 sq. ft. S.F.R. with a 1,259 sq.ft. attached garage and 740 sq. ft. of patios.	R.M.
32	Chuck Francoeur for 'Montage Dev.'	Tr. 69073 (related to 01-SPR-008 and 06-SPR-003)	5310 Colodny Dr.	2055-007-053			Convert the approved (unconstructed) apt. units to condos	R.M.
33	Moshe and Matty Bryski	2007-DCP-001	5662 Middlecrest Dr.	2056-027-002			Application for a large family Day Care Permit	R.M.
34	Larry Pollock	07-SPR-013	5734 Fairview Pl.	2055-012-035	.96 ac.	336 sq. ft.	Application to remodel and add 336 sq. ft. to the existing 2,605 sq. ft. single-family residence	B.T.
35	Bardai, Nevin (Gary Bardovi, Architect/LCE Group, Inc.)	07-CUP-011	Balkins Drive	2055-021-044	1.08 ac., minus .07 for slope easement; buildable lot is 1.01 ac.	5,772 sq. ft.	Construct a multi-level (two and three stories), 5,772 sq. ft. residence with attached garage; project includes a spa and future equestrian facilities.	R.M.
36	Thomas Brewer	07-PAR-005	4833 Canyon Way	2061-018-061 and 2061-018-062	Two (2) lots. One lot is 8,460 sq. ft. and the other lot is 7,900 sq. ft.	4,100 sq. ft.	Construct a multi-level (two stories over a full basement/parking level), single-family residence on two hillside lots which will be combined by a future Lot Line Adjustment application.	R.M.
PROJECTS APPROVED & UNDER CONSTRUCTION								
1P	Golenberg	02-SPR-010 02-OTP-008	5927 Colodny Dr.	2055-028-040	45,372 sqft.	476 sqft.	Room addition to an existing single-family dwelling	V.D.
2P	Minder Rhombold	01-SPR-004 TR53543	5241 Colodny Dr.	2055-006-026	.88 acre	1600-1700 sqft. Total: App. 31,000sqft	New 19 unit condo project	(E.B.) D.H.

Residential Cases
September 2007

Proj. No.	Project Name	Case No.(s)	Project Location	Parcel Number	Site Size	Floor Area	Project Description	Case Planner
3P	Stockton	01-SPR-008	5310 Colodny Dr.	2055-007-053	13,650 sqft.	8,068 sqft.	4-unit apartment building	D.H.
4P	Aviezer	03-CUP-007	27901 Blythdale	2055-001-038	6.45 acres or 280,962 sqft.	6,238 sqft. With 875 sqft. Garage	Custom house on hillside lot	V.D.
5P	Mineo	01-CUP-006 01-VAR-005	Lot 3 on Canyon Wy.	2061-017-003	6,824 sqft.	2,968 sqft.	New single-family dwelling	(R.H.) D.H
6P	Feehan, Tim	04-SPR-004	5472 Fairview Pl.	2055-014-028	21000 sqft.	700 sq. ft.	second story rm addition	D.H.
7P	San Juan for Sherman	03-CUP-011	Lewis Rd. (So.of Driver Ave.)	2055-004-020	23,021 sqft.	5,430 incl. Garage	Single-family D.U.	V.D.
8P	Ryan	04-MOD-001	29029 Acanthus Ct.	2051-003-006	6,758 sq.ft.	457 sq. ft.	Mod. For 2nd story room add.	V.D.
9P	Schwartzberg for Datner	04-SPR-012	6137 Braemar Ct.	2056-050-044	20,140sq.ft.	1,904 sq.ft.	2-story rm. Add	V.D.
10P	Mandler	04-SPR-009	5445 Meadow Vista	2053-019-007	5676 sq. ft.	1,593 sq.ft.	One and two-story room addition	V.D.
11P	Biddison, M	04-SPR-003	28359 Driver Ave.	2055-015-063	.96 acres	3,080/865 sq.ft.	1 story SF DU	D.H.
12P	Jim Hamilton	04-SPR-023 04-MOD-003	5675 Slicers Cir.	2054-018-149	3,690 sqft.	371 sqft.	371 sq.ft.rm.add.	W.W.
13P	Waters Diamond	04-SPR-011	5833 Lapworth Dr.	2055-021-028	1 acre	1,369 sqft.	One-story room addition	V.D.
14P	Swenson and Nadel	03-CUP-011 03-OTP-008	28354 Balkins Dr.	2055-021-042	39,247 sqft.	4,627 sqft.	A custom house with attached three car garage	(E.B.) D.H.
15P	Adivi formerly Levy	03-CUP-003	6029 Fairview Dr.	2055-022-047	2.56 acres	6,917 sqft.	Custom house on hillside lot	(D.H.) R.M.
16P	Schaub for Leggett	04-SPR-018 04-OTP-021	5939 Colodny Dr.	2055-028-039	40,950 sq.ft.	1,779 sq. ft.	One story room addition	V.D.
17P	Dawson for Sharon	04-SPR-017	28314 Foothill Dr.	2055-016-033	22,440	1,268 sq. ft.	Two-story room addition	V.D.
18P	Sears & Chase	04-LLA-014	30020&30014 Trail Creek Drive & HOA Common Area	2053-029-040 & 041 & 2053-018-033	N/A	N/A	Adjust south property line of two lots	Eng. Dept.
19P	Falcone/Garces	05-SPR-006 05 MOD-003	27411 Freetown Ln.	2064-009-037	9401 sqft.	add 1,206 sq.ft.	1 & 2 story rm.add & garage add.	R.M.
20P	Cooper for Stitt	05-SPR-005 & 05-OTP-007	28037 Balkins Dr.	2055-023-080	1.6 acres	add 735 sq.ft. and 1,052 sq.ft. interior remodel	1st & 2nd story add. And remodel	R.M.
21P	John/Linda Quinn	05-SPR-007	5703 Willowtree Dr.	2056-037-014	20,741 sqft.	add 1,428 sq.ft.	1 story add. & remodel 780 sq. ft. kitchen	R.M.
22P	Von Buck	03-CUP-017 03-OTP-016	27801 Blythdale Rd.	2055-001-035	4.27 acres	4,274 sqft with 1,272 sqft. Garage	A two-story custom house with three car garage	V.D.
23P	Blahosky/Mallach	05-SPR-008	5533 Gladhollow Ct.	2053-002-003	6,098 sqft.	add 1,142 sq.ft.	2nd story rm.add.	R.M.
24P	Linda Rich	05-SPR-009	5626 Fairview Pl.	2055-012-049	26,136 sq.ft.	add 233 sq.ft.	2-story add.& remodel interior	R.M.
25P	David Hazlett	05-SPR-013	4956 Vejar Dr.	2061-025-036	14,360 sq.ft.	720 sq. ft.	1 & 2 story rm.add	R.M.
26P	Cooper/Medvene	05-SPR-003	5857 Fairview Pl.	2055-027-066	1.26 acres	add 3,287 sq.ft.	Remodel, demolish, add barn and rm additions & garage	V.D.
27P	Sisso	05-SPR-017	5415 Lewis Rd. (So.of Driver Ave.)	2055-004-020	23,021 sqft.	a 4,065 sqft house with a 440 sqft. garage, 600 sqft. guest house and 350 sqft. cabana	A request to modify an existing approved residence; increase sqft and change gardening.	V.D.
28P	Roit, Leo	06-CUP-013; 06-VAR-006; 06-OTP-030	28161 Laura LaPlante	2061-016-053	8,000 sq. ft.	2,604 sq. ft.	Construct a 2,172 sq. ft. , one-story, single-family D.U. with a 432 sq. ft. attached garage	R.M.

Residential Cases
September 2007

Proj. No.	Project Name	Case No.(s)	Project Location	Parcel Number	Site Size	Floor Area	Project Description	Case Planner
29P	Benton (former Swift Construction for Coglin)	03-CUP-001 03-VAR-001	Lot 18 on Laura La Plante Dr.	2061-016-054	.271 acres or 11,801.76	3000 sqft.	Custom House on hillside lot	V.D.
30P	Raymond	04-SPR-007	5344 Lewis Rd.	2055-005-058	19,520 sq.ft.	1,663 sq.ft.	2nd.flr.room add.	V.D.
31P	Zoldan	05-SPR-016	5950 Lapworth Dr.	2055-027-065	40,281 sq.ft.	6,590 sq. ft.	A request to build a 5,830 sq.ft.D.U. with a 760 sq. ft. garage	V.D.
32P	Lelninger, Bart & Laura	05-SPR-025	6162 Lake Lindero Dr.	2056-054-009	9,639 sq.ft.	385 sq.ft. addition to be added to a prior 327 sq.ft. addition built in 2005.	First and second story room addition to existing single-family residence	C.A.
33P	Jacob	05-SPR-002 now 05-CUP-005 + 05-VAR-008 and 05-OTP-003	North of 5847 Colodny Dr.	2055-028-042	27,880 sq.ft.	4,061+518+864 s.f.	2 story S.F.D.U.w/porch,garage, barn + future pool	V.D.
34P	ARC Design/Ewing	05-SPR-011	28080 Balkins Dr.	waiting for correct #— 2055-023-098	44,965 sq.ft.	4,037 sq.ft. + 1,408	2 story SFR w/garage + acc. Bldg.	R.M.
35P	Murphy for Morgan-Blinkinsoph for Thompson	04-CUP-003 03-LLA-001 03-PAR-001	Lewis Pl.	2061-022-029,30	13,129 sq. ft.	2,567 sq. ft.	single-fam D.U.	V.D.
36P	Vasquez for Atkins	04-LLA-012 04-SPR-022 04-CFC-001	28506 Driver Ave.	2055-004-032	N/A	N/A	combine 2 lots + 2,098 sqft. room addition	V.D.
37P	Mahterian for Turley	05-SPR-001	6144 3/4 Chesebro Rd	2055-024-053	44,431 sqft.	5,296 sq.ft. & 592 sq.ft.	S.F. res. w/ detached bldg.	R.M.
38P	Payan	04-CUP-001 04-VAR-001	28254 Laura La Plante Dr.	2061-017-007	6,68 sqft.	3,154 sq.ft.	two-story SFDU	V.D.
39P	Mahterian for Mogan	05-CUP-004 05-MOD-005 05-LLA-008	28250 Laura LaPlante Dr.	2061-17-29;43;44;46	.51 acres Merge 4 lots	Add 1,015 sq.ft to an existing 1,339 sqft. DU with a 362 sqft. garage	Mod. Request to reduce front yard setback from 25' to 20'. Total finished sq.ft. of D.U. will be 2,354 sq.ft., plus 362 sq.ft. garage.	R.M.
40P	Rooney	05-SPR-021 05-MOD-007	5515 Rocktree Dr.	2048-005-007	6,300 sq.ft.	1,631 sq.ft.	One and two story addition: 1st: 104 sqft and 2nd: 1,527s qft.	C.A.
41P	Stockton for Sisso	06-SPR-004	5415 Lewis Rd. (So.of Driver Ave.)	2055-004-020	approx. 23,000 sq.ft.	3,850 sq. ft. D.U. & 650 sq. ft. garage	Single-story, single-family D.U. with attached 2 car garage.	V.D.
42P	Scott Berg for Kearns	06-SPR-002	5740 Colodny Dr.	2055-011-039	19,600 sq.ft.	222 sq.ft.	222 sq.ft. room addition to existing D.U.	R.M.
43P	Dembsky for Almany	05-MOD-006	3945 United Rd.	2064-018-006	N/A	846 sq.ft.	A Mod. Request to reduce the required front yard setback from 25 ft. to 21 feet.	C.A.
44P	McCann for Anav	05-SPR-027	5533 Fairview Pl.	2055-016-026	42,690 sq.ft.	1,039 sq.ft.	1,039 sq.ft. add. To existing 1,009 sq.ft. D.U. and a 586 sq.ft. covered porch	R.M.
45P	Pendlebury for Barnett	06-SPR-001	6044 Chesebro Rd.	2055-026-030	1.02 ac.	415 sq.ft.	415 sq.ft. addition	R.M.
46P	Bezalel for Beckerman	06-SPR-005	27862 Blythdale Rd.	2055-024-004	1.00 ac.	665 sq. ft.	665 sq. ft. addition to existing 2,223 sq.ft. house	R.M.
47P	CJF Development Consultants for "Montage"	06-SPR-003	5310 Colodny Dr.	2055-007-053	13,650 sqft.	8,068 sqft.	Time extension on 4 units. Former case number 01-SPR-008	R.M.

Residential Cases
September 2007

Proj. No.	Project Name	Case No.(s)	Project Location	Parcel Number	Site Size	Floor Area	Project Description	Case Planner
48P	Frank LaRosa and Emily Prano	06-SPR-007	5348 Chesebro Rd.	2052-007-007	21,699 sq.ft.	2,092 sq.ft.	695 sq.ft. garage conversion. 191 sq.ft. 1st flr add. And 576 sq.ft. 1st flr garage add. & 630 sq. ft. 2nd flr.addition	R.M.
49P	Roser	03-CUP-020	28537 Fountain Pl.	2055-019-025	5.25 acres	4,736 sqft.	A two-story custom house	A.C.
50P	Foster	04-SPR-019	5545 Foothill Dr.	2055-018-041	24,480 sq. ft.	2,998 sq. ft.	1 story, S.F. D.U.	V.D.
51P	Riopharm USA Inc.	03-CUP-010 03-VAR-005 TR 48901	South side of Agoura Rd between Palo Comado and Liberty Canyon	2061-014-007 through 015 & 2061-014-18 through 20 & 2061-014-23 through 26	10.58 acres	Three models from 2,777 to 3,235 sqft.	Renew CUP for 13 Single-family residences	D.H.
52P	Riopharm 2	TT48901 90-CUP-010 98-CUP-007	27650 Agoura Rd.	2061-014-027 through 042	10.58 acres	Three models from 2,777 to 3,235 sqft.	Renew CUP for 14 Single-family residences	D.H.
53P	Mogan, Tom/Susan	05-CUP-004	28259 Laura LaPlante	2061-017-046	.51 ac.	1,015 sq. ft.	1,015 sq.ft. 1st.& 2nd.floor add. To existing SFD. (See related MOD & LLA	R.M.
54P	Vladimir Zlatkov	06-CUP-004 refer to 05-PAR-003	28331 Laura LaPlante Dr.	2061-022-016	7,000 sq.ft.	3,235 sq.ft. D.U. with a 682 sq. ft. garage	Two-story single-family dwelling unit	R.M.
55P	Agoura TNT LLC/Terry Gray	06-CUP-005 and 06-OTP-008	6170 Fairview Pl.	2055-023-096	1.25 ac.	5,764 sq.ft.	New 5,764 sq. ft., two-story, single-family D.U. with a 1,008 sq.ft. attached garage and a 532 sq. ft. detached garage with future "pool house" above the detached garage structure.	R.M.
56P	N.E. Designs for Bar family	06-SPR-008	28466 Foothill Dr.	2055-017-009	28,700 sq.ft.	840 sq.ft.	840 sq.ft., one-story addition to existing 2,157 sq. ft. D.U.	RM
57P	Bagwell Construction for Joel Rizor	07-SPR-001	5709 Fairview Pl	2055-020-064	20,262 sq.ft.	716 sq. ft., plus 1,266 sq. ft.	Add 716 sq. ft. rm.addition to existing 2,428 sq.ft. D.U., plus add a 1st & 2nd story deck totaling 1,266 sq. ft.	B.T.
58P	Linda Medvene	07-SPR-005 and 05-OTP-002 (related case: 05-SPR-003)	6857 Fairview Pl.	2055-027-066	1.26 ac.	589.75 sq.ft.	Add 589.75 sq. ft. to existing 3,831 sq.ft. residence and add a 672 sq.ft. garage and a 600 sq. ft. barn.	B.T.
59P	Carroll, Gerald	07-SPR-006	5730 Fairview Place	2055-012-031		576 sq. ft.	Addition of a 576 sq. ft. storage building in rear yard	B.T.
60P	Bailey for Tamara Friend	07-SPR-007 and 07-OTP-009	6350 Chesebro Road	2055-001-041	3.29 ac	685 sq.ft.	Add a new 499 sq.ft.garage & a new 186 sq.ft. porch, convert an exist. 1,901sq.ft. garage to living space & convert an exist.breezeway to 573 sq.ft of living space to exist. D.U.	B.T.

Residential Cases
September 2007

Proj. No.	Project Name	Case No.(s)	Project Location	Parcel Number	Site Size	Floor Area	Project Description	Case Planner
61P	Charles Blaugrund for Mr. & Mrs. Joey Butson	07-SPR-002 and 07-VAR-001	5619 Slicers Circle	2054-018-132	4,070 sq.ft.	1,866 sq. ft.	Add a 1,645 sq.ft. 2nd story w/a 156 sq.ft. balcony and a 65 sq.ft. addition to the first floor of an existing 1,667 sq.ft. D.U. and a Variance app. requesting a reduction of side & rear yard setbacks	R.M.
62P	Zev Beckerman (Sasson Bezalel for Zev)	07-SPR-003; Related case: 06-SPR-005 (admin)	27862 Blythdale Rd.	2055-024-004	1.04 ac.	3,055 sq.ft.	Construct a new 3,055 sq. ft. D.U. in same area as former "tear-down". The lot has an existing garage and pool.	R.M.
63P	Leo Feierelsen for Garner	07-SPR-014	29004 Indian Ridge Ct	2051-002-034		869 sq. ft.	Add 212 sq. ft. to 1st floor, 234 sq. ft. to 2nd floor & a 423 sq. ft. covered patio	B.T.
MOST RECENTLY COMPLETED CONSTRUCTION								
1C	Gniadek/ Bullmer for Rasmussen	02-SPR-016	28611 Bamfield Ct.	2050-022-001	16.84 acres	5,200 sqft.	1,186 sqft room addition.	V.D.
2C	Crosby	01-CUP-010 01-VAR-011	28357 Foothill Dr.	2055-019-035	20,473 sqft.	1,700 sqft.	New SF House and Variance to allow private septic	Staff
3C	Parrot/ Green	03-SPR-004	29734 Blythdale Rd.	2055-024-007	1 acre	5,100 sqft	Custom house with three car garage	Staff
4C	Rosas	02-SPR-01	28366 Agoura Rd.	2061-022-034	8,799 sqft.	N/A	Slope Repairs with retaining walls.	V.D.
5C	Cardoni Group for Heflin	02-SPR-001	5626 Colodny Dr.	2055-009-011	40,946 sqft.	327 sqft.	327 sqft room addition to single family	Staff
6C	Casey	02-SPR-013	5560 Fairview Pl.	2055-012-016, 2055-013-027, 2055-012-015	1.56 acres	1,277 sqft.	Addition to an existing residence	Staff
7C	Ybanez	01-SPR-003 (Admin.)	5505 Foothill Dr.	2055-018-031	20,081 sqft.	578 sqft. 2nd fl. 165 sqft. 1st flr.	1st and 2nd addition to existing SFR	Staff
8C	Littman	02-SPR-022	5401 Fairview Dr.	2055-015-047	26,223 sqft.	1,306 sqft.	Room Addition.	Staff
9C	Sorgenstein/ Parrot and Amendt.	03-CUP-004 and Amendt.	5364 Lewis Rd.	2055-005-052	0.5 acre	2,471 sqft.	One single-family detached	D.H.
10C	Tamayel	03-MOD-002	3955 Patrick Henry Rd.	2064-015-022	8,293 sqft.	1,550+216 sqft.	Modification from required setbacks for a 216 sqft. addition.	Staff
11C	Palo Comado Ranch	97-CUP-012 TT52397	w/s of Chesebro Rd. at northerly city limits	2055-001-028	91 acres	N/A	8 residential lots	D.H.
12C	Marlow for Schiffman	04-SPR-006	28461 Driver Ave.	2055-017-036	22,240 sq.dr.	529 sq. ft.	Room addition to an existing dwelling unit	Staff
13C	Gray	03-CUP-012	5936 Fairview Pl.	2055-028-048	1.01 acres	5,610 sqft.	A custom house with attached three car garage	V.D.
14C	Moraga	02-CUP-001	6000 Fairview Pl.	2055-028-047	1.01 acres	3,663 sqft	One single-family detached	Staff
15C	ARC Inc.	02-SPR-012	29236 Laro Dr.	2056-042-011	33,400 sqft.	4,975 sqft.	Single-family detached residence	Staff
16C	Dan Sheldon	00-CUP-005	28232 Driver Ave.	2055-005-043	.50 acre	3,700 sqft.	One single-family detached	Staff
17C	Phillips	03-PAR-006 03-CUP-015 03-OTP-006	5743 Fairview Pl.	2055-020-068	1.01 acres	5,610 sqft.	A custom house with attached car garage and amendt. to add a 820 sqft. second story.	D.H.

Residential Cases
September 2007

Proj. No.	Project Name	Case No.(s)	Project Location	Parcel Number	Site Size	Floor Area	Project Description	Case Planner
18C	Stockton for Britton	03-SPR-005	27918 Blythedale Rd.	2055-024-006	43,916 sqft.	3,82 sqft. + 537 sqft. Garage	Custom house and accessory building	Staff
19C	Oak View Ranch	03-LLA-004 03-LLA-005 03-LLA-006	Various properties on Amelia Drive, Erta Court-Evita Court, Adelina Court Lots 46 of Tract 36749 and 62,63 & 64 of Tract 36746	N/A	N/A	N/A	Lot line adjustments to comply with existing fence lines	S.S.
20C	Gaines	03-SPR-009	6070 Chesebro Rd.	2055-026-035	1 acre	4,197 sqft.	A one-story custom house	V.D.
21C	Carpenter for Danielson	01-CUP-013	28428 Lewis Pl.	2061-022-044	3,720 sqft.	2,610 sqft.	Single-family detached residence	Staff
22C	DNA Construction for Mahler	04-SPR-013	5732 Rainbow Hill Rd.	2056-014-010	7,006	611 sq.ft.	One and two-story room addition	R.M.
23C	Linda Tatum	03-CUP-004 Amendment	5364 Lewis Rd.	2055-005-052	25,700 sqft.	n/a	Re-alignment of approved driveway	R.M.
24C	Odney	05-SPR-019	30716 Lakefront Dr.	2054-006-050	0.11 acres	1,083 sq. ft.	A 952 sqft. addition	C.A.
25C	Forest Construction for M/M Mohammadi	04-SPR-014	29033 Woodcreek Ct	2051-003-027	7,085	835 sq.ft.	One and two-story room addition	R.M.
26C	Richard Goodman	05-LLA-005	5437 and 5445 Colodny Dr.	2055-013-016	1 acre	N/A	Lot Line Adjustment for two residential parcels	S.S.
27C	Shifman, Alan	04-SPR-016 & Amendment	5639 Fairview Pl.	2055-016-032	20,025.39 sq.ft.	308 sq.ft.	Library/laundry rm addition to existing single-family residence	R.M.
28C	RJ Builders for Kupfer	05-MOD-001	29679 Kimberly Dr.	2056-053-035	44,792 sqft.	59 sq.ft.add.	Request for side yard reduction	W.W.
29C	Benhaim for Alkoby	04-SPR-021	28326 Foothill Dr.	2055-016-011	21,780 sqft.	364 sqft.	364 sqft. Room Addition	R.M.
30C	Mahlerian for Clark	04-SPR-008	28242 Foothill Dr.	2055-016-020	20,040 sq. ft.	337 sq. ft.	single-story rm addition	D.H.
31C	Ryan & Lynette Lee	05-MOD-004	29577 Fountainwood St.	2051-013-017	10,972 sqft.	470 sq. ft.	2nd story rm.add. With reduced set-back	R.M.
32C	Schneider	00-SPR-007 01-OTP-011	5276 Colodny Dr.	2055-007-050	.253 acre	6,688 sqft.	4 unit condominium project	R.H.
33C	JOR Development for Rocca	04-SPR-001	5425 Lewis Rd.	2055-004-019	0.525 acres	4,595 sqft.	Single-family dwelling unit	D.H.
34C	Darryl Levine	05-SPR-023	5540 Colodny Dr.	2055-009-024	20,020 sq.ft.	775 sq ft	339 sq. ft. single-story addition & 436 sq.ft. covered patio	C.A.
35C	Scaglioni	00-CUP-004	28331 Foothill Dr.	2055-020-058	22,169 sqft.	3,784 sqft.	New single-family dwelling	D.H.
36C	CC&R for Henry Halimi	06-PSR-002	Lot G no. of T.O.Blvd.,east of Carel	2048-003-002			Pre-screen Review requesting City to vacate easterly portion of T.O. Blvd., to allow a SFR on a Open Space lot	D.H.
37C	Richard Goodman	05-LLA-010	5437 and 5445 Colodny Dr.	2055-013-033; 042,043	N/A	2/20,000 sqft. Lots	Revise Lot Line Adjustment for 2 res. Parcels	S.S. and Ken Berkman
38C	Peter Stern	04-SPR-025	5544 Colodny Dr.	2055-009-025	21,370	4,105 sq.ft, 482 sq. ft. garage plus acc.	D.U. , garage,barn	V.D.
39C	Flint	05-SPR-020	5552 Colodny Dr.	2055-009-016	21,780 sq.ft.	3,438 sq.ft.	A 1,650 sqft. addition with a 1,788s sqft. barn	C.A.
40C	Kersey	04-CUP-008 04-VAR-003 04-PAR-001	28406 Lewis Pl.	2061-022-018	5619 sqft.	2,089 sq.ft.	2-story, single-family D.U.	R.M.

Residential Cases in Review
September 2007

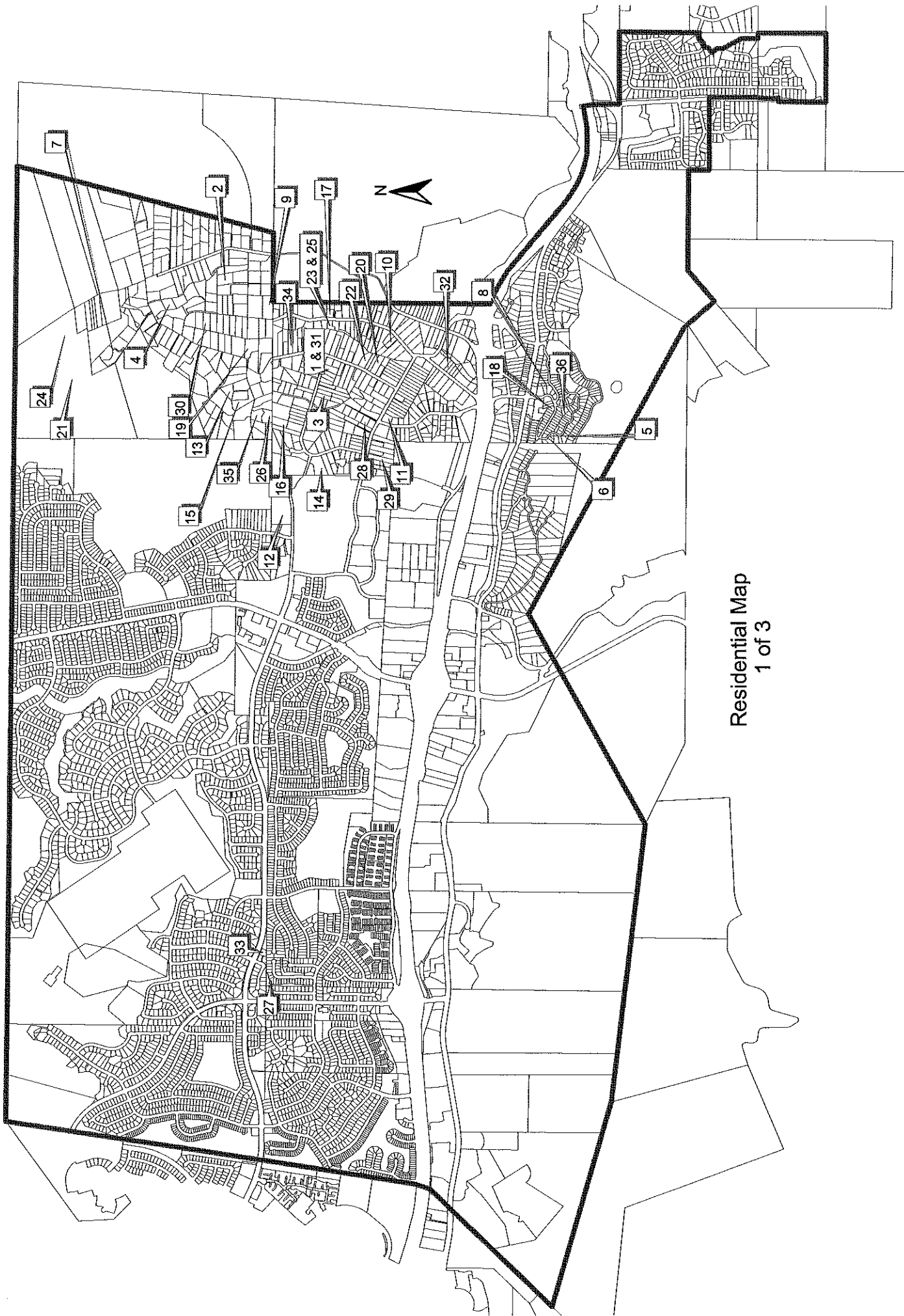

**Residential Cases Approved
and Under Construction
September 2007**

