

PLANT SCHEDULE

TREES	BOTANICAL/COMMON	SIZE
	CERCIS OCCIDENTALIS / WESTERN REDBUD	15 GAL
	EXISTING TREE TO REMAIN	15 GAL
	JUGLANS CALIFORNICA / SOUTHERN CALIFORNIA BLACK WALNUT	5 GAL
	LAGERSTROEMIA FAURIEI "MUSKOGEE" / CRAPE MYRTLE LIGHT LAVENDER	24"BOX
	LIQUIDAMBAR STYRACIFLUA "ROTUNDILOBA" / ROTUNDILOBA SWEET GUM	24"BOX
	PISTACIA CHINENSIS / CHINESE PISTACHE STANDARD	24"BOX
	PLATANUS RACEMOSA / CALIFORNIA SYCAMORE STANDARD	24"BOX
	QUERCUS AGRIFOLIA / COAST LIVE OAK	15 GAL
	QUERCUS AGRIFOLIA / COAST LIVE OAK	36"BOX
	QUERCUS AGRIFOLIA / COAST LIVE OAK	48"BOX
	QUERCUS AGRIFOLIA / COAST LIVE OAK	60"BOX
	QUERCUS LOBATA / VALLEY OAK	48"BOX
	SHRUBS	
	BOTANICAL/COMMON	SIZE
	BACCHARIS PILULARIS "TWIN PEAKS" / TWIN PEAKS COYOTE BRUSH	1 GAL
	CISTUS PURPUREUS / ORCHID ROCKROSE	5 GAL
	CISTUS SKANBERGII / CORAL ROCKROSE	5 GAL
	GREVILLEA LANIGERA "COASTAL GEM" / COASTAL GEM GREVILLEA	5 GAL
	HEMEROCALLIS HYBRID "LITTLE BOBO" / LITTLE BOBO DAYLILY	1 GAL
	HETEROMELES ARBUTIFOLIA / TOYON	5 GAL
	KECKIELLA CORDIFOLIA / CLIMBING PENSTEMON	1 GAL
	LIRIOPE MUSCARI / LILY TURFS	1 GAL
	PHORMIUM "CREAM DELIGHT" / CREAM DELIGHT FLAX	5 GAL
	RHAMNUS CALIFORNICA / CALIFORNIA COFFEE BERRY	1 GAL
	RHAMNUS CROCEA / REDBERRY	1 GAL
	RHAPHIOLEPIS INDICA "SPRINGTIME" TM / SPRINGTIME INDIAN HAWTHORNE	5 GAL
	ROSA CALIFORNICA / CALIFORNIA WILD ROSE	5 GAL
	ROSMARINUS OFFICINALIS "PROSTRATUS" / DWARF ROSEMARY	5 GAL
	SALVIA GREGGII "FURMAN'S RED" / FURMAN'S RED SALVIA	5 GAL
	SALVIA LEUCOPHYLLA / PURPLE LEAF SAGE	1 GAL
	TRACHELOSPERMUM JASMINOIDES / STAR JASMINE	5 GAL
	VINE/ESPAJIER	
	BOTANICAL/COMMON	SIZE
	PARTHENOCISSUS TRICUSPIDATA / BOSTON IVY	5 GAL
	GROUND COVERS	
	BOTANICAL/COMMON	SIZE
	CAREX SENTA / SEDGE	1 GAL@ 12" OC
	JUNCUS PATENS / CALIFORNIA GRAY RUSH	1 GAL@ 12" OC
	MELICA IMPERFECTA / IMPERFECT MELIC	1 GAL@ 24" OC
	MULCH	MULCH
	NASSELLA PULCHRA / PURPLE NEEDLE GRASS	1 GAL@ 24" OC
	SALIX LASIOLEPIS / ARROYO WILLOW	CUTTINGS@ 12" OC

Proposed Landscape Plan

Figure 6B



LEGEND:

EXIST 72" RCP STORM DRAIN PER PD 1350 (PUBLIC).
EXIST WATER.
EXIST. RECLAIM IRRIGATION WATER MAIN.
EXIST SEWER LATERAL.
EXIST. STORM DRAIN.
PROP. RECLAIM IRRIGATION SERVICE.
PROP. SEWER LATERAL.
PROP. WATER
PROP. ELECTR. PAD

- CONSTRUCTION LEGEND:**
- 1 CONSTRUCT 6" CONC. CURB.
 - 2 CONSTRUCT 6" CONC. CURB & GUTTER.
 - 3 CONSTRUCT 3" WIDE CONC. RIBBON GUTTER.
 - 4 CONSTRUCT RETAINING WALL.
 - 5 SAWCUT LINE.
 - 6 CONSTRUCT CURB DRAIN.
 - 7 PLACE 2" A.C. OVERLAY OVER EXIST A.C. PAVEMENT
 - 8 RELOCATE EXIST. POWER POLE & ELECTRICAL TO BE UNDERGROUNDED.
 - 9 CONSTRUCT BIO-SWALE PER DETAIL HEREON.
 - 10 INSTALL SEWER LATERAL FOR PROPOSED BLDG.
 - 11 INSTALL WATER SERVICE FOR EXIST BLDG. "A".
 - 12 INSTALL WATER SERVICE FOR PEOP. BLDG.
 - 13 INSTALL RECLAIMED WATER SERVICE FOR IRRIGATION.
 - 14 CONSTRUCT NEW A.C. 3" PAVEMENT ON 6" BASE.
 - 15 EXIST ELECTRICAL TO REMAIN.
 - 16 REQUIRED 8' MIN CLEARANCE IN FRONT OF TRANSFORMER FOR OPERATION.
 - 17 CONSTRUCT GARDEN WALL
 - 18 INSTALL SEWER CLEANOUT AT EXIST. ANGLE POINT ON EXIST. SEWER LATERAL
 - 19 CONSTRUCT PERMEABLE PAVEMENT ON SAND BASE PER SOILS ENGINEER RECOMMENDATIONS.
 - 20 DECORATIVE PAVING PER ARCHITECTURAL PLANS.
 - 21 CONSTRUCT PERMEABLE PAVERS WALKWAY ON SAND BASE PER SOILS ENGINEER RECOMMENDATIONS.
 - 22 RESTRIPE PARKING TO PROVIDE ADA ACCESS TO EXIST. BLDG. ELEVATORS.

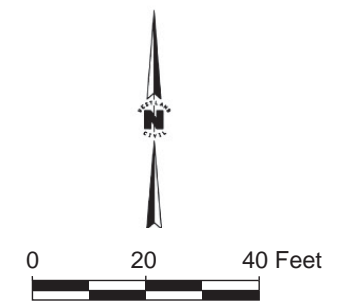

Source: Westland Civil, Inc., November 2007.

Proposed Grading Plan - Southern Portion of Site
Figure 7A
City of Agoura Hills

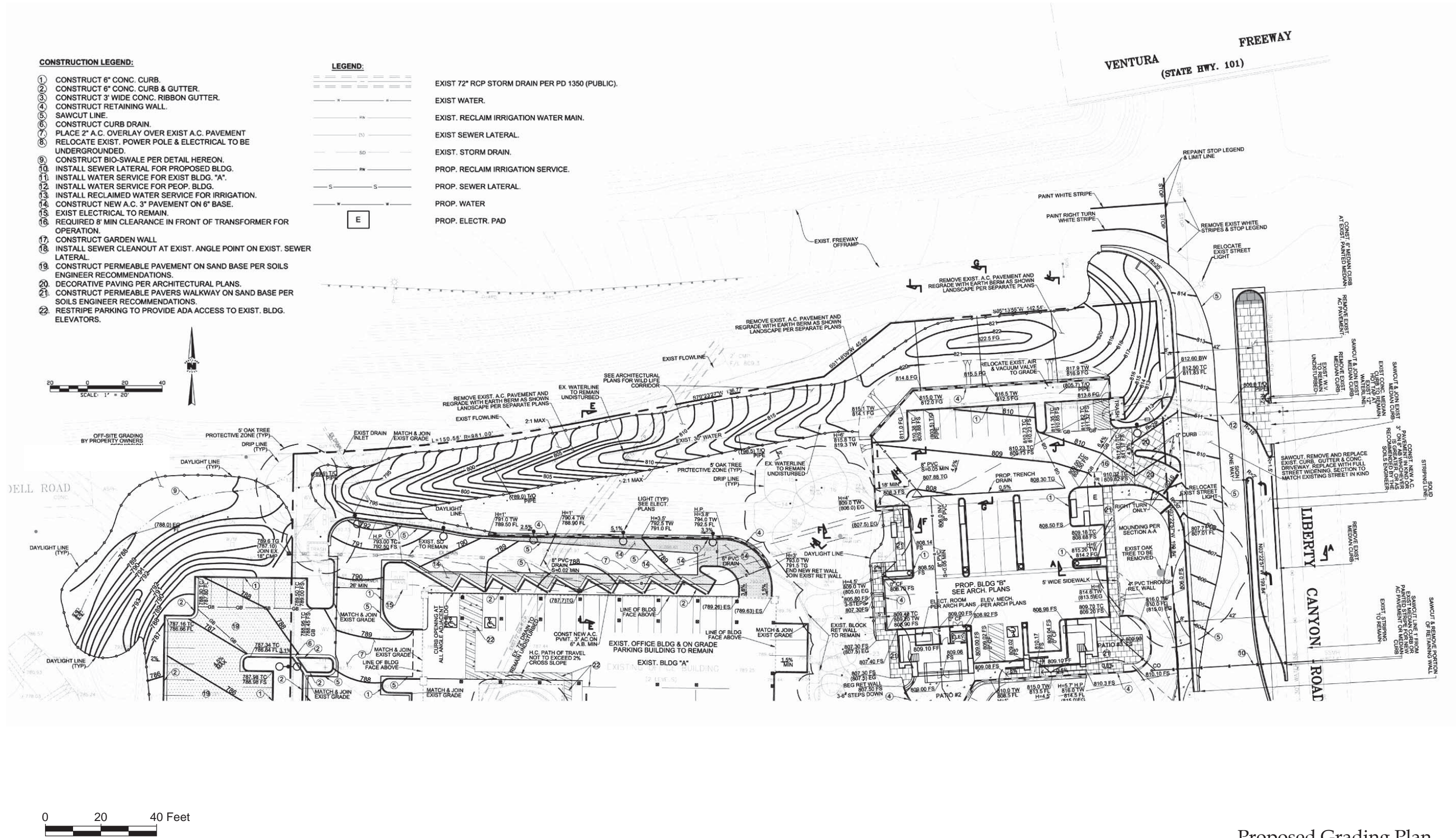

- CONSTRUCTION LEGEND:**
- 1 CONSTRUCT 6" CONC. CURB.
 - 2 CONSTRUCT 6" CONC. CURB & GUTTER.
 - 3 CONSTRUCT 3" WIDE CONC. RIBBON GUTTER.
 - 4 CONSTRUCT RETAINING WALL.
 - 5 SAWCUT LINE.
 - 6 CONSTRUCT CURB DRAIN.
 - 7 PLACE 2" A.C. OVERLAY OVER EXIST. A.C. PAVEMENT
 - 8 RELOCATE EXIST. POWER POLE & ELECTRICAL TO BE UNDERGROUNDED.
 - 9 CONSTRUCT BIO-SWALE PER DETAIL HEREON.
 - 10 INSTALL SEWER LATERAL FOR PROPOSED BLDG.
 - 11 INSTALL WATER SERVICE FOR EXIST. BLDG. "A".
 - 12 INSTALL WATER SERVICE FOR PROP. BLDG.
 - 13 INSTALL RECLAIMED WATER SERVICE FOR IRRIGATION.
 - 14 CONSTRUCT NEW A.C. 3" PAVEMENT ON 6" BASE.
 - 15 EXIST. ELECTRICAL TO REMAIN.
 - 16 REQUIRED 8' MIN CLEARANCE IN FRONT OF TRANSFORMER FOR OPERATION.
 - 17 CONSTRUCT GARDEN WALL.
 - 18 INSTALL SEWER CLEANOUT AT EXIST. ANGLE POINT ON EXIST. SEWER LATERAL.
 - 19 CONSTRUCT PERMEABLE PAVEMENT ON SAND BASE PER SOILS ENGINEER RECOMMENDATIONS.
 - 20 DECORATIVE PAVING PER ARCHITECTURAL PLANS.
 - 21 CONSTRUCT PERMEABLE PAVERS WALKWAY ON SAND BASE PER SOILS ENGINEER RECOMMENDATIONS.
 - 22 RESTRIPE PARKING TO PROVIDE ADA ACCESS TO EXIST. BLDG. ELEVATORS.

LEGEND:

	EXIST 72" RCP STORM DRAIN PER PD 1350 (PUBLIC).
	EXIST WATER.
	EXIST. RECLAIM IRRIGATION WATER MAIN.
	EXIST SEWER LATERAL.
	EXIST. STORM DRAIN.
	PROP. RECLAIM IRRIGATION SERVICE.
	PROP. SEWER LATERAL.
	PROP. WATER
	PROP. ELECTR. PAD

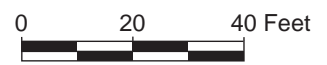
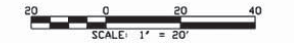

Proposed Grading Plan - Northern Portion of Site

Figure 7B

Source: Westland Civil, Inc., November 2007.



Source: Behr Browsers Architects, Inc., February 2008.

Post-Project View from Southbound US 101 Freeway

Figure 8
City of Agoura Hills





Source: Behr Browsers Architects, Inc., February 2008.

Post-Project View from Agoura Road & Liberty Canyon

Figure 9
City of Agoura Hills





Source: Behr Browsers Architects, Inc., February 2008.

Post-Project View from Agoura Road Looking North

Figure 10
City of Agoura Hills



Luminaire Schedule					
Qty	Label	Arrangement	Lumens	LLF	Description
10	DL	SINGLE	12500	0.720	OMEGA DM20H50E17H45PL-FL
3	SAB	BACK-BACK	12500	0.720	GARCO CA17-FM-150MH
3	SA	SINGLE	12500	0.720	GARCO CA17-FM-150MH
8	SAH	SINGLE	12500	0.720	GARCO CA17-FM-150MH
2	SB	SINGLE	19100	0.720	GARCO CAB2-FM-250MH
1	SCB	BACK-BACK	19100	0.720	GARCO CAB2-FM-250MH
7	SC	SINGLE	19100	0.720	GARCO CAB2-FM-250MH

Statistical Area Summary					
Label	Avg	Max	Min	Avg/Min	Max/Min
East Area	1.66	11.40	0.01	166.00	1140
North East Area	2.54	6.78	0.27	9.41	25.11
South Area	2.16	7.68	0.29	7.45	26.48
North West Area	1.86	6.72	0.05	37.20	134.40

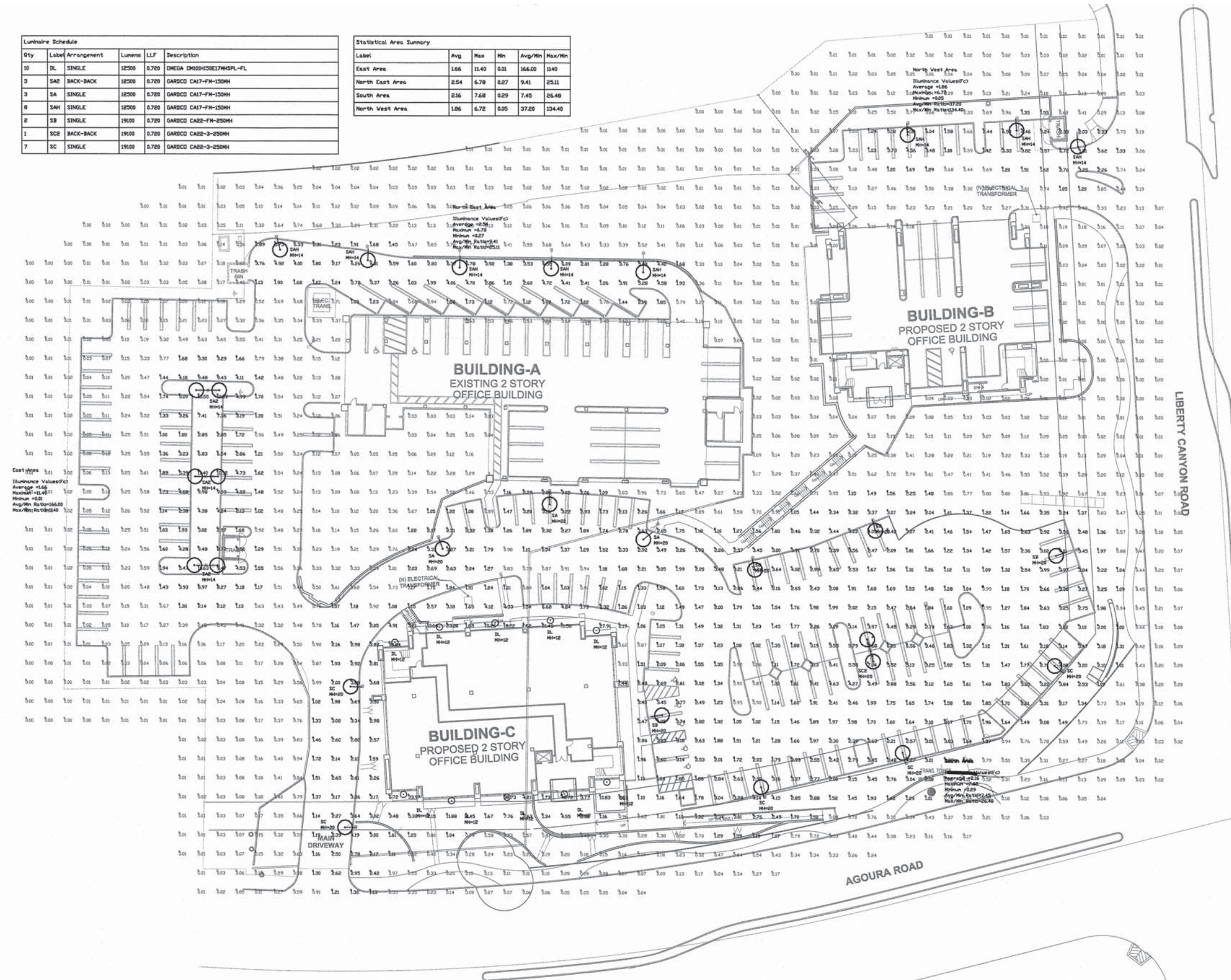

Photometric Lighting Plan
Figure 11
City of Agoura Hills

Source: Behr Browsers Architects, Inc., February, 2008.

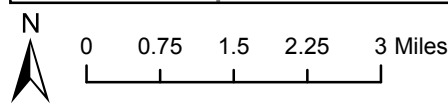
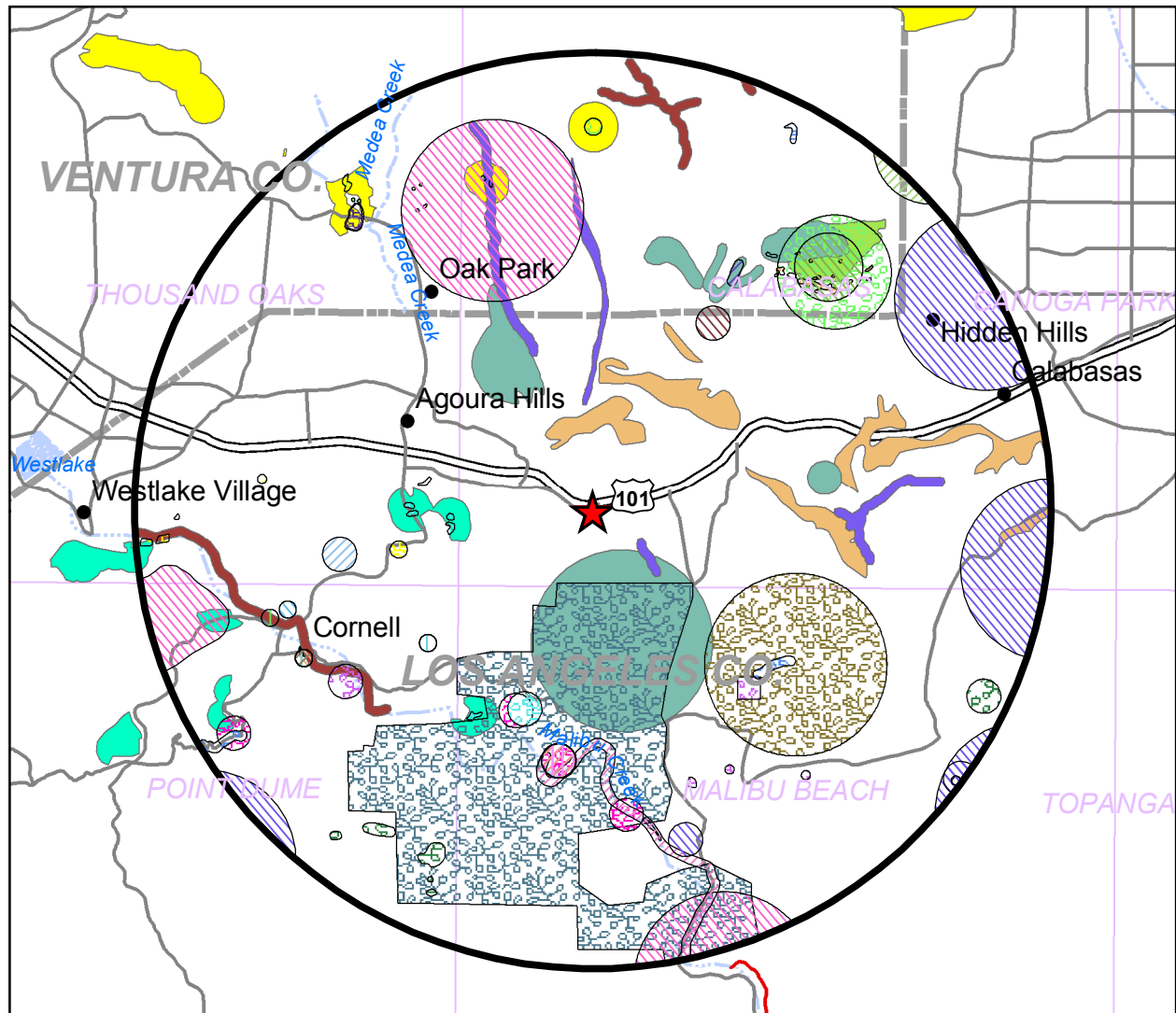

Sources: California Natural Diversity Database, January, 2008; Rincon Consultants, 2008; U.S. Fish and Wildlife Service, December 2007; U.S. Bureau of the Census TIGER 2000 data; and ESRI, 2002. Critical habitat shown is that most recently available from U.S. FWS. Check with U.S. FWS or Federal Register to confirm.
 Note: Map to be printed in color, due to subtleties in symbology noticeable only on color version.

★ Project Location	coast (San Diego) horned lizard	Plants	Habitats
5-Mile Radius Buffer	coastal California gnatcatcher	Agoura Hills dudleya	California Walnut Woodland
Animals	coastal western whiptail	Braunton's milk-vetch	Southern Coast Live Oak Riparian Forest
California leaf-nosed bat	golden eagle	Lyon's pentachaeta	Southern Sycamore Alder Riparian Woodland
California red-legged frog	hoary bat	Malibu baccharis	Valley Needlegrass Grassland
Gertsch's socialchemmis spider	spotted bat	Plummer's mariposa-lily	Valley Oak Woodland
Santa Monica grasshopper	two-striped garter snake	San Fernando Valley spineflower	Critical Habitat
Yuma myotis	western mastiff bat	Santa Susana tarplant	S Calif Steelhead FCH
arroyo chub	western red bat	chaparral nolina	Braunton's Milk Vetch FCH
burrowing owl	western small-footed myotis	marcescent dudleya	Lyon's Pentachaeta FCH
		round-leaved filaree	
		slender mariposa-lily	

Sensitive Elements Reported by the
 California Natural Diversity Database

Figure 12
 City of Agoura Hills