



**DEPARTMENT OF PLANNING AND COMMUNITY  
DEVELOPMENT**

**COMMERCIAL AND RESIDENTIAL  
DEVELOPMENT SUMMARY**

**JUNE 2008**

City of Agoura Hills Development Summary  
Table of Contents for Commercial Cases (June 2008)

No.	Applicant	Project Location
<b>IN REVIEW</b>		
1	Rose (Stuart Rose)	5216 Chesebro Rd.
2	E.F. Moore & Co.	SEC of Agoura and Kanan
3	Heathcote for Buckley	South of Agoura Rd., near western City Limits
4	Conerstone	SEC Agoura Rd. and Cornell Rd.
5	Kim	5115 Clareton Dr.
6	Canwood Storage	28661 Canwood St.
7	Brian Norris for Chaper 8	29020 Agoura Road
8	Carlos Khantzis	30800 Agoura Rd.
9	Sunbelt enterprises	29541 & 29555 Canwood St.
10	Danari Oak Creek, LLC for Adler Realty Investments, Inc.	Five (5) commercial lots of Tr 53752 on the north side of Canwood St., east of Kanan Rd.
11	Royal Street Communications LLC	28001 Dorothy Dr.
12	27489 Agoura Road LLC (Previously known as Cardinal Liberty)	N/W corner of Liberty Cyn & Agoura Rd.
13	Wildman Design, LLC/ Eric Rochin	28340 Roadside Dr.
14	Agoura-Kanan, LLC/ The Martin Group	4995 Kanan Rd. (Southwest corner of Kanan and Agoura Rd.)
15	Signature Signs for Agoura Design Center	28501, 28505, 28509 Canwood St.
16	Cornerstone Heathcote & Associates	Southeast corner of Agoura Road and Cornell Road
17	Meridian Telecom, Inc. for Verizon Wireless	30401 Agoura Rd.
18	Vinod & Chanresh Gupta Trust	29760 Agoura Road
19	David Myers/Ware Malcomb for Venture Corporation	29508 Roadside Drive or 29505 Agoura Road based upon the project orientation
20	SureSite/ Omnipoint Communications for T-Mobile	5844 Larboard Lane

City of Agoura Hills Development Summary  
Table of Contents for Commercial Cases (June 2008)

No.	Applicant	Project Location
21	Luithly, Joseph	28818 Agoura Road
22	Vinod & Chanresh Gupta Trust	29760 Agoura Road
23	Ware/Malcomb for Agoura Business Center West, LLC / William Poe	Northwest corner of Canwood & Derry
24	Moe Sherif for GU	29338 Roadside Drive
25	Coastal Satellite (Marvin Kanarek for property owner, Robert Adler)	Two lots: One located at 28222 Dorothy Dr. One located at 28131 Agoura Rd.
26	Agile Ventures, LLC	28870 Agoura Road
27	Agoura Medical Partners, LLC	Northwest corner of Agoura Rd. and Chesebro Rd.
28	Agoura Landmark, LP	29621 Agoura Rd.
29	Sherlie Bermann (Architect, Sorin Done)	28900 Agoura Road (Lots 46 and 47)
30	Daly Owens Group for Kanan Properties East LLC	5000 Kanan Road and 5050 Kanan Road
31	Joe Bednar	5506 Colodny Drive
32	Coastal Satellite (Marvin Kanarek for property owner, Robert Adler)	Two lots: One located at 28222 Dorothy Dr. One located at 28131 Agoura Rd.

**APPROVED PROJECT**

1P	Rasmussen Larry	N. Agoura Rd. East of Palo Comado
2P	Willy's Smokin BBQ/Marca Gauzarez	28434 Roadside Dr.
3P	Elias Ben Hazany	5226 Palo Comado Canyon Rd.
4P	Realty Bancorp Equities	29901 Agoura Rd.
5P	Infranext, Inc for AT&T	28545 Driver Ave.
6P	BBA Properties LLC for Michael Browers	28371 Agoura Rd.
7P	Scheu (Corp. Point)	S/S Agoura Rd. @Reyes Adobe Rd.
8P	Shirvanian Family Investment	Lots between 28700 and 28811 Canwood Street
9P	Meridian for Verizon Wireless	28545 Driver Ave.

City of Agoura Hills Development Summary  
Table of Contents for Commercial Cases (June 2008)

No.	Applicant	Project Location
10P	Alesco Development	NEC Chesebro and Agoura Rds.
11P	Agoura Detailing Center	100 Reyes Adobe
12P	Signature Signs for the Agoura Design Center	28501; 28505; and 28509 Canwood St.
13P	Scheu Development Co. for Agoura Hills Corporate point, LLC	30200 and 30300 Agoura Road
14P	Conoco/Phillips	28203 Dorothy Dr.
15P	HQ Development for Agoura Hills Acquisition, LLC	29621 Agoura Rd.
16P	Wm.Paul Companies for Archstone Smith	29128 Oak Creek Lane
17P	GU	29338 Roadside Dr.
18P	California Neon Products (for Mi Pollo Loco)	5050 Kanan Rd.
19P	Center Ct.Plaza/Silagi	29501 Canwood St.
20P	St Paul Lutheran Church	30600 Thousand Oaks Blvd.
21P	Vogue Signs for Farmers Ins.	30801 Agoura Rd.
22P	BBA Properties LLC for Michael Browers	28371 Agoura Rd.
23P	Conejo Jewish Day School	29001 Ladyface Ct. (Temple Beth Havarim site)
24P	Rabbi Bryski for the Chabad of the Conejo (Arch. Filiberto Gomez)	30345 and 30347 Canwood St.

---

**COMPLETED PROJECTS**

---

1C	AT&T Wireless Services (Novak & Assoc.)	30105-30131 Agoura Rd.
2C	Temple Beth Haverim	29900 Ladyface Cir.
3C	J.G. Management	29525 Canwood St.
4C	Saylors/Tireman	28117 Dorothy Drive
5C	Mahterian	28351 Agoura Rd.

City of Agoura Hills Development Summary  
Table of Contents for Commercial Cases (June 2008)

No.	Applicant	Project Location
6C	The Consulting Group for Cingular	29646 Agoura Rd.
7C	Gillian Anguish	28914 Roadside Dr.
8C	Reyes Adobe Partners, L.P. (Sleep Shoppe)	Reyes Adobe Rd directly south of US 101
9C	Chesebro Properties, LLC	5231 Chesebro Rd.
10C	Leader Carpets (Ugrik for Simone)	28350 Roadside Dr.
11C	J.H. Snyder	North of Canwood St, east of Kanan Rd.
12C	Levy, Moshe	Roadside Dr., west of Lewis Rd.
13C	Warehouse Discount	30621 Canwood St.
14C	J.G. Management	29525 Canwood St.
15C	Cingular Wireless	28545 Driver Ave.
16C	Wickman "Agoura Furniture Center"	28205 & 28207 Canwood St.
17C	Texaco -> Shell (Ambience Engineering)	5227 Palo Camodo Rd.
18C	Pacifica Property Management	30301 Agoura Rd.
19C	HRS Architects for Countrywide	29851 and 29701 Agoura Rd.
20C	FDSI	28001 Dorothy Dr.
21C	Cimm's for Burger King	29136 Roadside Dr.
22C	Signature/Wickman	28205/29207 Canwood
23C	THQ	29903 Agoura Rd.
24C	Diaz for Simply Discount Furniture	28714 Canwood St.
25C	Lovelace for McDonald's	29161 Canwood Street
26C	Selleck Dev. Grp.	29508 Roadside Dr.
27C	Fire Station No. 89	Canwood St., east of Strawberry Hill Dr.
28C	Ball Properties (Centerpointe)	30005 & 30009 Ladyface Cir.
29C	Joni and Friends International Disability Center	30009 Ladyface Ct

City of Agoura Hills Development Summary  
Table of Contents for Commercial Cases (June 2008)

No.	Applicant	Project Location
30C	Employer's Direct	30301 Agoura Road
31C	Heyman/Finefrock	29020 Agoura Rd, Unit 14
32C	N W Rugs (by 'Sign A Rama')	28610 Canwood St.
33C	HBF Holdings	North of Canwood, west of Clareton Dr.
34C	Mahterian for Vannelli	28205 Agoura Rd.
35C	Signature Signs for YGAL LEVY	28811 Canwood St.
36C	Zaghi	29348 Roadside Dr.
37C	Fox for AT&T	5126 Clareton Dr.
38C	Doss for Rick Principe (TR Funding) Development Partners	30101 Agoura Ct.
39C	Rhomboid (former Minder/Samson Dev.)	5241 Colodny
40C	PS Services for First Horizon	28236 Roadside Drive
41C	Roger Ebrahimi	29348 Roadside Dr.
42C	Development Partners	30101 Agoura Ct.
43C	Stockton for Levy	288211 Canwood St.
44C	Todd Ryzow	5653 Kanan Rd.
45C	Agoura Equip. Rental	29149 Agoura Road
46C	Temple Beth Haverim	29900 Ladyface Cir.
47C	Rick Principe	30101 and 30077 Agoura Court
48C	Carlos Orozco	30315 Canwood St.
49C	Coast Sign for Agoura Hills Investors (Gerald Collier)	5667 Kanan Raod
50C	Silagi "Canwood Plaza" Bldg.C	NW Corner Kanan Rd. & Canwood Street
51C	Adler Realty	Canwood St between Lewis and Derry Ave.

**Commercial Cases  
June 2008**

Proj. No.	Project Name	Case No.(s)	Project Location	Parcel Number	Site Size	Floor Area	Project Description	Case Planner
<b>IN REVIEW</b>								
1	Rose (Stuart Rose)	01-SPR-009	5216 Chesebro Rd.	2052-008-041 and 042	1.5 acres	N/A	Code Enforcement: Parking, screening and landscape improvements required.	D.H.
2	E.F. Moore & Co.	03-CUP-006	SEC of Agoura and Kanan	2061-031-020	18 acres	118 du, 91,800 retail, 10,000 office	Agoura Village Mixed Use Development	A.C.
3	Heathcote for Buckley	03-CUP-019	South of Agoura Rd., near western City Limits	2061-001-031	3 acres	14,075 sqft.	Commercial/Medical Building	V.D.
4	Conerstone	03-CUP-024	SEC Agoura Rd. and Cornell Rd.	2061-029-008 thru 16 2061-030-001 thru 013	243,172 sqft.	26,000 sqft Retail 18,000 sqft. Office 41,000 sqft Residential	Mixed-Use Development	A.C.
5	Kim	05-VAR-006	5115 Claretton Dr.	2048-011-039	N/A	N/A	Parking Reduction for a medical tenant.	R.M.
6	Canwood Storage	05-ZOA-002	28661 Canwood St.	2048-012-025			ZOA to allow storage in the FC Overlay	D.H.
7	Brian Norris for Chapter 8	05-CUP-001 Amendment	29020 Agoura Road	2061-031-023 and 024	N/A	N/A	Amend CUP to add 3-piece band 5 p.m. to 10 p.m. Tues. through Friday nights	V.D.
8	Carlos Khantzis	05-PSR-004	30800 Agoura Rd.	2061-001-025	6.31 ac.	57,391 sq.ft.	46 senior condos	D.H.
9	Sunbelt enterprises	05-CUP-005	29541 & 29555 Canwood St.	2053-001-008	3.23 ac	25,200 sq.ft.	2 identical 12,600 sq. ft. medical & general office bldgs.	V.D
10	Danari Oak Creek, LLC for Adler Realty Investments, Inc.	06-CUP-007 06-OTP-016 06-SP-037	Five (5) commercial lots of Tr 53752 on the north side of Canwood St., east of Kanan Rd.	2048-011-049; 2048-011-050; 2048-011-051; 2048-011-052; 2048-011-053; 2048-011-061;	Lot 3 has 1.2 ac. and an additional section of 16,450 sq. ft.; Lot 4 has 38,897 sq. ft.; Lot 5 has 43,470 sq. ft.; Lot 6 has 1.26 ac.; Lot 7 has 35,419 sq. ft.	Building A: 7,360 sq. ft. Building B-1: 6,000 sq. ft. Building B-2: 6,800 sq. ft. Building C-1: 7,500 sq. ft. Building C-2: 7,000 sq. ft.	Construct 5 buildings, totaling 34,660 sq. ft. 2 retail buildings of 6,000 sq.ft. and 7,000 sq.ft., with a 1,420 sq.ft. portion for multi-use; and 3 restaurant buildings of 5,940 sq.ft., 6,800 sq.ft. and 7,500 sq. ft. And implement a sign program.	D.H.
11	Royal Street Communications LLC	06-CUP-011	28001 Dorothy Dr.	2061-011-021			6 panel antennas, 1 GPS antenna, 1 microwave antenna, 4 equipment cabinets	V.D.
12	27489 Agoura Road LLC (Previously known as Cardinal Liberty)	06-SPR-009 PM 67397 (06-PAR-003 /99-SPR-015)	N/W corner of Liberty Cyn & Agoura Rd.	2064-006-006,007,009, 016,018,019	5 empty lots and one developed lot for a site total of approx. 4.18 acres	30,000 sq. ft. (existing bldg. on site is 24,450 sq. ft.)	2 bldgs. One single-story, 10,000 sq.ft. and one two-story, 20,400 sq. ft. + Parcel Map to combine the 6 lots.	V.D.
13	Wildman Design, LLC/ Eric Rochin	06-SPR-012 06-OTP-032 06-SP-059	28340 Roadside Dr.	2061-009-044	.079 ac.	21,590	Construction of new Commercial Building	V.D.
14	Agoura-Kanan, LLC/ The Martin Group	07-AVDP-001	4995 Kanan Rd. (Southwest corner of Kanan and Agoura Rd.)	2061-033-016	21.58 acres	107 residential units of (?) sq.ft. and a total of 167,000 sq. ft. of retail/commercial space.	First phase of development & parcelization of site includes 107 res. units over 62,000sq.ft. of retail space. (other phases to include 30,000 sq.ft. of retail and 75,000 sq.ft. of commercial space).	A.C.

**Commercial Cases  
June 2008**

Proj. No.	Project Name	Case No.(s)	Project Location	Parcel Number	Site Size	Floor Area	Project Description	Case Planner
15	Signature Signs for Agoura Design Center	08-SP-024 (related cases: 06-SP-044 and 04-CUP-007)	28501, 28505, 28509 Canwood St.	2048-012-017 & 018			Per Planning Commission request: A monument sign program for the Design Center	R.M.
16	Cornerstone Heathcote & Associates	07-AVDP-002	Southeast corner of Agoura Road and Cornell Road	2061-029-008 through 016 and 2061-030-001 through 013	Multiple lot square footage	67,155 sq. feet plus 35 residential units	Proposal for a 7 bldg., mixed-use development located on 8 acres of hillside property. 67,155 sq. ft. of retail/office use and 35 residential units. A Parcel Map will be required to merge lots or a Tract Map will be required to re-subdivide the property.	A.C.
17	Meridian Telecom, Inc. for Verizon Wireless	07-CUP-006	30401 Agoura Rd.	2061-002-047	N/A	N/A	Install rooftop wireless communications site consisting of 12 panel antennas(4 antennas per sector-3 sectors) Each antenna's size is 4'x1'x6" and 4 outdoor radio equip. cabinets. Entire facility to be screened to match existing.	R.M.
18	Vinod & Chanresh Gupta Trust	07-PSR-001 (Ref.Cases: 07-CUP-009 07-CUP-012)	29760 Agoura Road	2061-033-015	1.65 acre	15,000 sq. ft.	A Pre-Screen Review application to have the Council consider a Specific Plan Amendment to allow a 15,000 sq.ft. building instead of an 8,000 sq. ft. bldg., which is required by the Ladyface Mtn. Specific Plan.	V.D.
19	David Myers/Ware Malcomb for Venture Corporation	07-PAR-003	29508 Roadside Drive or 29505 Agoura Road based upon the project orientation	2061-004-030	5.71 acres	73,800 sq. ft.	A proposed commercial condominium development consisting of 38 individual properties which will range in size from 1,100 to 3,413 sq. ft.	V.D.
20	SureSite/ Omnipoint Communications for T-Mobile	07-CUP-007	5844 Larboard Lane	2056-015-900			Install six(6) antennas flush mounted in a new 50 ft. high monopole. The installation includes six(6) equipment cabinets adjacent to the monopole, surrounded by a masonry equipment enclosure on the Linderro Cyn. Middle School site.	R.M.
21	Lulthly, Joseph	07-CUP-008 07-OTP-005	28818 Agoura Road	2061-029-002		1,062 sq. ft.	Convert existing non-conforming S.F. D.U in BP-OR Zone to Com. Bldg. and add a 113 sq.ft. 1st floor addition; a 729 sq. ft. 2nd floor addition and a new 220 sq. ft. covered patio; convert existing lattice patio cover to solid roof and convert the 684 sq.ft. garage to work area.	V.D.
22	Vinod & Chanresh Gupta Trust	07-CUP-009 07-OTP-012	29760 Agoura Road	2061-033-015	1.65 ac.	12,700 sq.ft.	Two-story, 12,700 sq. ft. office building	V.D.
23	Ware/Malcomb for Agoura Business Center West,LLC / William Poe	07-CUP-010 07-GPA-001 07-ZC-001 PM 69426	Northwest corner of Canwood & Derry	2048-012-022 and 2048-012-027	The entire Lot 2 of Tr.33249 is 8.82 buildable area; however, with the new Parcel Map, the project site is proposed to be 1.93 ac.	21,782 sq. ft.	A GPA and ZC app.to change project site from Bus.Manufacturing to Commercial Retail and a CUP app.to construct 3 retail buildings totalling 21,782 sq.ft.	V.D.



**Commercial Cases  
June 2008**

Proj. No.	Project Name	Case No.(s)	Project Location	Parcel Number	Site Size	Floor Area	Project Description	Case Planner
24	Moe Sherif for GU	07-SPR-012 07-VAR-003 07-SP-024	29338 Roadside Drive	2061-004-025	.62 acres	2,612 sq. ft.	Proposal to eliminate self-service washing stalls & tunnel; maintain two lube bays & add new retail area & office. A Variance is requested to reduce the rear yard setbacks. A Sign Program approval is also requested.	V.D.
25	Coastal Satellite (Marvin Kanarek for property owner, Robert Adler)	08-PAR-001	Two lots: One located at 28222 Dorothy Dr. One located at 28131 Agoura Rd.	2061-012-020 and 2061-012-042	Two lots totaling approx. 26,000 sq. ft.	13,000 sq. ft.	A Pre-App. To discuss the issues re constructing a 13,000 sq.ft. office & production facility on two lots that are in two separate zones.	VD
26	Agile Ventures, LLC	07-AVDP-003	28870 Agoura Road	2061-029-003 and 2061-029-004	Approx. 48,709 sq. ft.	17,249sq. ft.	Construct a two-story office condo (17 units) (Tr.Map required) on two-lots (PM required to combine lots for project.)	A.C.
27	Agoura Medical Partners, LLC	07-SPR-015 PM 70096 07-GPA-002 07-ZOA-002	Northwest corner of Agoura Rd. and Chesebro Rd.	2061-012-012; 014; 015; 018;047;048;049	Per application, 79,194 sq. ft.	40,733 sq. ft.	Medical office building	V.D.
28	Agoura Landmark, LP	07-PAR-006	29621 Agoura Rd.	2061-003-027	5.17 gross acres, minus .52 ac for S.D. and minus .35 ac for F.H. leaves 4.30 net acres of developable land.	128,863 sq. ft.	Proposal to construct 7 buildings, two and three stories in height. A parking structure is incorporated into the design.	V.D.
29	Sherlie Bermann (Architect, Sorin Done)	07-AVDP-004	28900 Agoura Road (Lots 46 and 47)	2061-029-005 and 2061-029-006	Per application, the lot is 0.9 plus or minus acres	24,220 sq. ft.	A mixed occupancy, commercial bldg./ banquet hall/ office and one residential unit. An outdoor wedding terrace and wine cellar are proposed.	A.C.
30	Daly Owens Group for Kanan Properties East LLC	07-LLA-004	5000 Kanan Road and 5050 Kanan Road	2061-006-045 and 2061-006-046	30,000 sq. ft.	Proposed increase in lot square footage to 40,00 sq. ft.	A Lot Line Adjustment to move the existing lot line northerly to include the existing car wash with the existing gas station to comply with the lease agreement.	Ramiro Adeva
31	Joe Bednar	98-CUP-001 Amendment	5506 Colodny Drive	2055-009-027			Amend approved CUP to allow 28 rooms to be converted to "special care" in the existing retirement facility.	R.M.
32	Coastal Satellite (Marvin Kanarek for property owner, Robert Adler)	08-PAR-001	Two lots: One located at 28222 Dorothy Dr. One located at 28131 Agoura Rd.	2061-012-020 and 2061-012-042	Two lots totaling approx. 26,000 sq. ft.	13,000 sq. ft.	A Pre-App. To discuss the issues re constructing a 13,000 sq.ft. office & production facility on two lots that are in two separate zones.	V.D.
<b>APPROVED PROJECTS</b>								
1P	Rasmussen Larry	99-CUP-006 PM 26009 99-OTP-006	N. Agoura Rd. East of Palo Comado	2061-013-045	3.27 acres	45,000sqft.	Office building	J.P.
2P	Willy's Smokin BBQ/Marca Gauzurez	05-SPR-029	28434 Roadside Dr.	2061-008-048		273 sq.ft.	Add 273 sq. ft. of office space and kitchen storage	R.M.

**Commercial Cases  
June 2008**

Proj. No.	Project Name	Case No.(s)	Project Location	Parcel Number	Site Size	Floor Area	Project Description	Case Planner
3P	Elias Ben Hazany	07-CUP-001	5226 Palo Comado Canyon Rd.	2052-008-030	0.45 ac.	1,454.7 sq. ft.	Remodel existing gas station building and remove the service-bay facilities in order to convert entire building to a Food Mart.	R.M.
4P	Realty Bancorp Equities	01-SPR-011 02-VAR-007 02-CUP-008	29901 Agoura Rd.	2061-003-023	8.98 acres	76,750 sqft.	Two-story commercial building	D.H.
5P	Infranext, Inc for AT&T	03-CUP-005	28545 Driver Ave.	2048-008-901	n/a	n/a	Wireless telecommunications antenna & equipment bldg.	V.D.
6P	BBA Properties LLC for Michael Browers	02-SPR-016 02-OTP-011 TE#1 TE#2; 06-SPR-006 and 06-OTP-024 Amendment (Reference Case No. PM 27094); reinstatement	28371 Agoura Rd.	2061-009-41,42,45,47 and 49	0.67 acre	9,440 sqft.	Office Building; and request for a time extension for an SPR which approved the construction of an office building. Combine 5 lots into one (1) lot for the purpose of building an office building. Related case is 06-SPR-006	D.H.
7P	Scheu (Corp. Point)	98-CUP-012 & 98-LLA-003	S/S Agoura Rd. @Reyes Adobe Rd.	2061-002-022	87 acres	81,000 sqft.	2 new buildings	D.H.
8P	Shirvanian Family Investment	06-CUP-003 06-OTP-005 PM 65503	Lots between 28700 and 28811 Canwood Street	2048-012-026	10.02 acres	103,000 sq.ft.	Industrial park with 7 buildings	D.H.
9P	Meridian for Verizon Wireless	04-CUP-005	28545 Driver Ave.	2048-008-901	N/A	N/A	Wireless telecommunications antenna & equipment bldg.	V.D.
10P	Alesco Development	02-CUP-004 02-LLA-001 03-OTP-015 03-VAR-007	NEC Chesebro and Agoura Rds.	2061-013-011; -031; -041; -042; -043; -044; -045; -028.	4.13 acres	8 Office Buildings: 63,208 sqft.	New office buildings	D.H.
11P	Agoura Detailing Center	03-CUP-014	100 Reyes Adobe	2053-026-078	44,330 sqft.	10,333 sqft.	Auto detailing center with offices	D.H.
12P	Signature Signs for the Agoura Design Center	06-SP-044	28501; 28505; and 28509 Canwood St.	2048-012-017; 018			Sign Program for the Agoura Design Center	R.M.
13P	Scheu Development Co. for Agoura Hills Corporate point, LLC	98-CUP-012 98-OTP-010 Amendment	30200 and 30300 Agoura Road	2061-022-022	26 acres	71,844	Amendment to approved application to extend the approval beyond the allowed extension already granted for two com.office buildings on 5.23 ac. The balance of the site to be deed restricted to prevent development.	D.H.
14P	Conoco/Phillips	05-SP-022	28203 Dorothy Dr.	2061-010-011	.75 acres	N/A	Sign Program Upgrade for a 76 gas station.	V.D.
15P	HQ Development for Agoura Hills Acquisition, LLC	05-SPR-010 05-OTP-010 05-SP-006	29621 Agoura Rd.	2061-003-027	5.17 ac.	95,215 sq.ft.	2-story commercial office bldg.	V.D.
16P	Wm.Paul Companies for Archstone Smith	05-SP-059 05-VAR-008	29128 Oak Creek Lane	2048-011-045,046,047,048,057			Replace 2 monument signs (Var. is for more than 1 sign)	V.D.
17P	GU	05-VAR-007	29338 Roadside Dr.	2061-004-025 and 026	24,090 sqft.	N/A	Lot line Adjustment for two commercial parcels.	V.D.
18P	California Neon Products (for Mi Pollo Loco)	04-SP-005 05-SM-002	5050 Kanan Rd.	2061-006-045	N/A	N/A	New Sign Program for El Pollo Loco	V.D.
19P	Center Ct.Plaza/Silag	04-CUP-010 Tr. 62211	29501 Canwood St.	2053-001-006	3.24 ac.	49,350 sq.ft.	1 Two-story office building	D.H.
20P	St Paul Lutheran Church	04-CUP-009	30600 Thousand Oaks Blvd.	2054-017-016	1,9 acres	960 sqft.	Modular building	V.D.

**Commercial Cases  
June 2008**

Proj. No.	Project Name	Case No.(s)	Project Location	Parcel Number	Site Size	Floor Area	Project Description	Case Planner
21P	Vogue Signs for Farmers Ins.	06-SP-028	30801 Agoura Rd.	2061-001-029			Two wall signs	V.D.
22P	BBA Properties LLC for Michael Browers	06-SPR-006	28371 Agoura Rd.	2061-009-041; 042; 045; 047; 049	Approx. 30,000 sq.ft.	9,400 sq.ft.	TE for case # 02-SPR-016: a new 9,400 sq.ft. office building + parking	V.D.
23P	Conejo Jewish Day School	06-CUP-010 06-SPA-002	29001 Ladyface Ct. (Temple Beth Havarim site)	2061-005-031			A Specific Plan Amendment and a Cond.Use Permit to allow a school to operate on the existing Temple site.	J.R.
24P	Rabbi Bryski for the Chabad of the Conejo (Arch. Fillberto Gomez)	06-CUP-006 06-VAR-002	30345 and 30347 Canwood St.	2054-020-038 and 2054-020-039	Existing bldg. lot is 9,970 sq.ft. Proposed bldg. lot is 15,390 sq.ft.	6,999 sq. ft.	Remodel existing Chabad Center bldg. and construct a 6,999 sq.ft. bldg. on rear lot for offices and class rooms.	V.D.
<b>COMPLETED PROJECTS</b>								
1C	AT&T Wireless Services (Novak & Assoc.)	02-CUP-003	30105-30131 Agoura Rd.	2061-005-026	1.66 acres	n/a	Wall mounted antennas and related roof-mounted equipment in an existing shopping center	V.D.
2C	Temple Beth Haverim	02-CUP-010	29900 Ladyface Cir.	2061-005-031	n/a	n/a	Tent for worship for a period of three years.	V.D. to Jared
3C	J.G. Management	02-SPR-023	29525 Canwood St.	2053-001-007	170,755 sqft.	n/a	Parking lot redesign.	R.H.
4C	Saylor/Tireman	00-SPR-013	28117 Dorothy Drive	2061-011-018+017+020	0.914 acre	8,000 sqft.	2 Tire Retail Buildings	E.B.
5C	Mahterian	02-SPR-020	28351 Agoura Rd.	2061-009-054	6,098 sqft.	1660 sqft. Building	Rehab existing building for an architectural firm	R.H.
6C	The Consulting Group for Cingular	02-CUP-009	29646 Agoura Rd.	2061-033-013	n/a	n/a	Wireless telecommunications antenna & equipment bldg.	V.D.
7C	Gillan Anguish	03-CUP-021	28914 Roadside Dr.	2061-007-041 & 052	N/A	N/A	Request to operate a flea market on the first Saturday of every month.	V.D.
8C	Reyes Adobe Partners, L.P. (Sleep Shoppe)	02-SPR-008 02-SPR-002 02-OTP-003 03-LLA-002	Reyes Adobe Rd directly south of US 101	2061-005-022 and 906	75,000 sqft.	14,500 sqft.	Mattress and bedroom showroom	R.H.
9C	Chesebro Properties, LLC	00-SPR-018	5231 Chesebro Rd.	2052-008-040	19,500 sqft.	8,000 sqft.	New office building	E.B.
10C	Leader Carpets (Ugrik for Simone)	01-SPR-007 02-OTP-010	28350 Roadside Dr.	2061-009-043	35,490 sqft.	14,080sqft.	New carpet/flooring store	E.B.
11C	J.H. Snyder	01-CUP-009 01-GPA-003 01-ZC-003 01-OTP-005 02-ZOA-001 TR 53752 03-VAR-003 03-VAR-008	North of Canwood St, east of Kanan Rd.	2048-011-008 2048-011-009 2048-011-010 2048-011-033 2048-011-036 2048-011-037 2048-011-902	29 acres	Residential = 356,000 sqft. Other components under separate applications	336 apartments	D.H.
12C	Levy, Moshe	00-SPR-019 00-OTP-016 00-ABAN-003	Roadside Dr., west of Lewis Rd.	2061-009-050	31,452 sqft. (7.22 acres)	20,830 sqft.	New office building with underground parking	E.B.
13C	Warehouse Discount	03-SPR-002	30621 Canwood St.	2054-005-010	N/A	N/A	Façade Remodel	E.B.
14C	J.G. Management	03-SPR-007	29525 Canwood St.	2053-001-007	N/A	N/A	Revise parking lot grading	R.H.

**Commercial Cases  
June 2008**

Proj. No.	Project Name	Case No.(s)	Project Location	Parcel Number	Site Size	Floor Area	Project Description	Case Planner
15C	Cingular Wireless	03-CUP-013	28545 Driver Ave.	2048-008-901	N/A	N/A	Wireless telecommunications antenna & equipment bldg.	V.D.
16C	Wickman "Agoura Furniture Center"	00-SPR-020 00-OTP-017 PM 26535 00-SPR-020 Amendt. 04-SP-050 Amendt. 05-LLA-004	28205 & 28207 Canwood St.	2055-007-119-123+127	2.2 acres	38,760 sqft.	New furniture sales center; Bldg A 17,260 s.f., Bldg B 21,500 sf	D.H.
17C	Texaco -> Shell (Ambience Engineering)	02-SPR-009 02-SP-012 03-VAR-003 03-CUP-009	5227 Palo Camodo Rd.	2052-008-030	0.45 acres	N/A	Remodel, monument sign, minimart.	E.B.
18C	Pacifica Property Management	04-SP-035	30301 Agoura Rd.	2061-002-046	N/A	N/A	Establish a new sign program	V.D.
19C	HRS Architects for Countrywide	02-SPR-019 03-SP-027	29851 and 29701 Agoura Rd.	2061-003-025, 026, 027, 028	328,442 + 206,474 sqft.	N/A	Exterior Improvements to an existing structure.	E.B.
20C	FDSI	05-SP-047	28001 Dorothy Dr.	2061-011-021	0.39 acres	15,000 sqft.	Sign Program	V.D.
21C	Cimm's for Burger King	04-SM-001	29136 Roadside Dr.	2061-006-039	N/A	N/A	Amend the sign program	V.D.
22C	Signature/Wickman	04-SP-050 & Amendment	28205/29207 Canwood	2055-007-119, 120, 121 and 122	N/A	N/A	Signs for Center	V.D.
23C	THQ	05-SPR-004 05-VAR-002 05-OTP-004 05-SP-023 05-SPR-004	29903 Agoura Rd.	2061-003-029	5.18 acres	Existing 103,400 sq.ft. bldg.	Exteropr remodel and add parking on site and off site	D.H.
24C	Diaz for Simply Discount Furniture	05-SP-044	28714 Canwood St.	2048-012-022	4.66 acres	6,100 sqft.	Sign Program Amendment for Simply Discount Furniture	V.D.
25C	Lovelace for McDonald's	05-SPR-018 05-SP-035	29161 Canwood Street	2048-011-029	47,589 sq.ft.	5,586 sq.ft.	Building and parking remodel for McDonald's Restaurant.	R.M.
26C	Selleck Dev. Grp.	04-SPR-020	29508 Roadside Dr.	2061-004-030		12,000 cu.ft.	Dirt stockpile site	D.H.
27C	Fire Station No. 89	N/A	Canwood St., east of Strawberry Hill Dr.	2053-001-900	3.26 acres	12,500 sqft.	New Fire Station (County Project)	M.K.
28C	Ball Properties (Centerpointe)	99-CUP-013 99-CUP-013 Amendt. for time extension 05-LLA-001	30005 & 30009 Ladyface Cir.	2061-005-908+909	4.2 acres	Building 1: 27,340sqft Building 2: 33,700sqft	2 office buildings	D.H.
29C	Joni and Friends International Disability Center	07-SP-007	30009 Ladyface Ct	2061-005-063			Sign Program, including a wall sign and a monument sign for the existing building	B.T.
30C	Employer's Direct	06-SP-050	30301 Agoura Road	2061-002-046			Addmendment to existing sign	B.T.
31C	Heyman/Finefrock	04-SPR-024 05-CUP-001 05-ODP-001 05-VAR-001	29020 Agoura Rd, Unit 14	2061-031-023 & 024	1.86 acres	6,000 sqft Tenant Space	1077 sq.ft. Outdoor dining patio and live entertainment at existing restaurant	V.D.

**Commercial Cases  
June 2008**

Proj. No.	Project Name	Case No.(s)	Project Location	Parcel Number	Site Size	Floor Area	Project Description	Case Planner
32C	N W Rugs (by 'Sign A Rama')	86-SP-045	28610 Canwood St.	2048-012-016			Request for a new sign program for the existing store	V.D.
33C	HBF Holdings	03-CUP-018 04-SP-047 05-LLA-002 Amendment 06-SP-026	North of Canwood, west of Clareton Dr.	2048-011-033	3 acres	88,108 sqft.	125-Unit Hotel Homewood Suites	D.H.
34C	Mahterian for Vannelli	04-SPR-015 04-OTP-017 04-LLA-015	28205 Agoura Rd.	2061-012-044 & 2061-012-024	2 lots/total of 10,000 sq.ft.	1,019 sq.ft.	1-story addition to an existing office	V.D.
35C	Signature Signs for YGAL LEVY	06-SP-023	28811 Canwood St.	2048-011-032	n/a	n/a	Sign Program for Levy building	V.D.
36C	Zaghi	04-SPR-010 formerly: 03-CUP-008 03-VAR-004	29348 Roadside Dr.	2061-004-023	38,768 sqft.	11,636 sqft.	One-story warehouse and light manufacturing	D.H.
37C	Fox for AT&T	04-CUP-004	5126 Clareton Dr.	2048-011-024	N/A	N/A	Wireless telecommunications antenna & equipment bldg.	V.D.
38C	Doss for Rick Principe (TR Funding) Development Partners	00-SPR-001 Amendment #1	30101 Agoura Ct.	2061-003-035	4.78 net ac.	30,000 sq. ft.	Add a two-story bldg to a site which has an existing building on it. An amendment to the approval, asking to extend the expired approval.	R.M.
39C	Rhomboid (former Minder/Samson Dev.)	01-SPR-004; Tr.53543; 02-OTP-002	5241 Colodny	2055-006-204 2055-006-189 2055-006-202 2055-006-206 2055-006-191 2055-006-199 2055-006-198 2055-006-203 2055-006-190 2055-006-201 2055-006-205 2055-006-207 2055-006-200 2055-006-193 2055-006-192			Amendment to approved application due to developer revisions to approved elevations and site plan and landscaping plan for 19 condos	V.D.
40C	PS Services for First Horizon	07-SP-028	28236 Roadside Drive	2061-008-051	N/A	N/A	A request to amend an approved sign program	B.T.
41C	Roger Ebrahimi	07-SP-035	29348 Roadside Dr.	2061-004-023	N/A	N/A	Sign Program for center at 29348 Roadside Dr.	B.T.
42C	Development Partners	00-SPR-001 00-OTP-001	30101 Agoura Ct.	2061-003-035	4.3 acres	31,160 sqft.	2 Story office building	D.H.
43C	Stockton for Levy	02-SPR-021	288211 Canwood St.	2048-011-032	38,376 sqft.	16,700 sqft.	10,000 Furniture Store, 6,000 sqft. Office Space, 700 sqft. Miscellaneous Uses	D.H.
44C	Todd Ryzow	06-CUP-002	5653 Kanan Rd.	2053-007-026	n/a	n/a	Request for a Live Entertainment Permit	V.D.

**Commercial Cases  
June 2008**

Proj. No.	Project Name	Case No.(s)	Project Location	Parcel Number	Site Size	Floor Area	Project Description	Case Planner
45C	Agoura Equip. Rental	07-MOD-001	29149 Agoura Road	2061-006-008			Request to allow an existing non conforming sign to remain larger than Code allows when a portion of the existing letters are changed to re-name the business	B.T.
46C	Temple Beth Haverim	02-CUP-010 Amendment	29900 Ladyface Cir.	2061-005-031	N/A	N/A	Request to extend the life of the temporary sanctuary	J.R.
47C	Rick Principe	00-SPR-001 Amendment #2 06-VAR-003	30101 and 30077 Agoura Court	2061-003-035	N/A	N/A	Request to change colors, materials and architectural features and increase height.	R.M.
48C	Carlos Orozco	06-CUP-012	30315 Canwood St.	2054-020-040	Two lots, each having 60,760 sq. ft. and 53,940 sq. ft. respectively	Tenant in the Reyes Adobe Shopping Center	Application for a Live Entertainment Permit	B.T.
49C	Coast Sign for Agoura Hills Investors (Gerald Collier)	07-SP-017	5667 Kanan Raod	2053-007-025			New Sign Program for the Bank of America	B.T.
50C	Silagi "Canwood Plaza" Bldg. C	00-CUP-010 Amendment	NW Corner Kanan Rd. & Canwood Street	2053-001-804	2.03 acres	22,896 sqft.	Office Building	D.H.
51C	Adler Realty	04-CUP-007 04-OTP-020 04-LLA-011 PM 62245	Canwood St between Lewis and Derry Ave.	2055-003-064 ; 2048-012-017 and -018	292,065 sqft.	120,230 sqft.	Furniture/Home Decorating Center	D.H.

Projects In Review  
June 2008

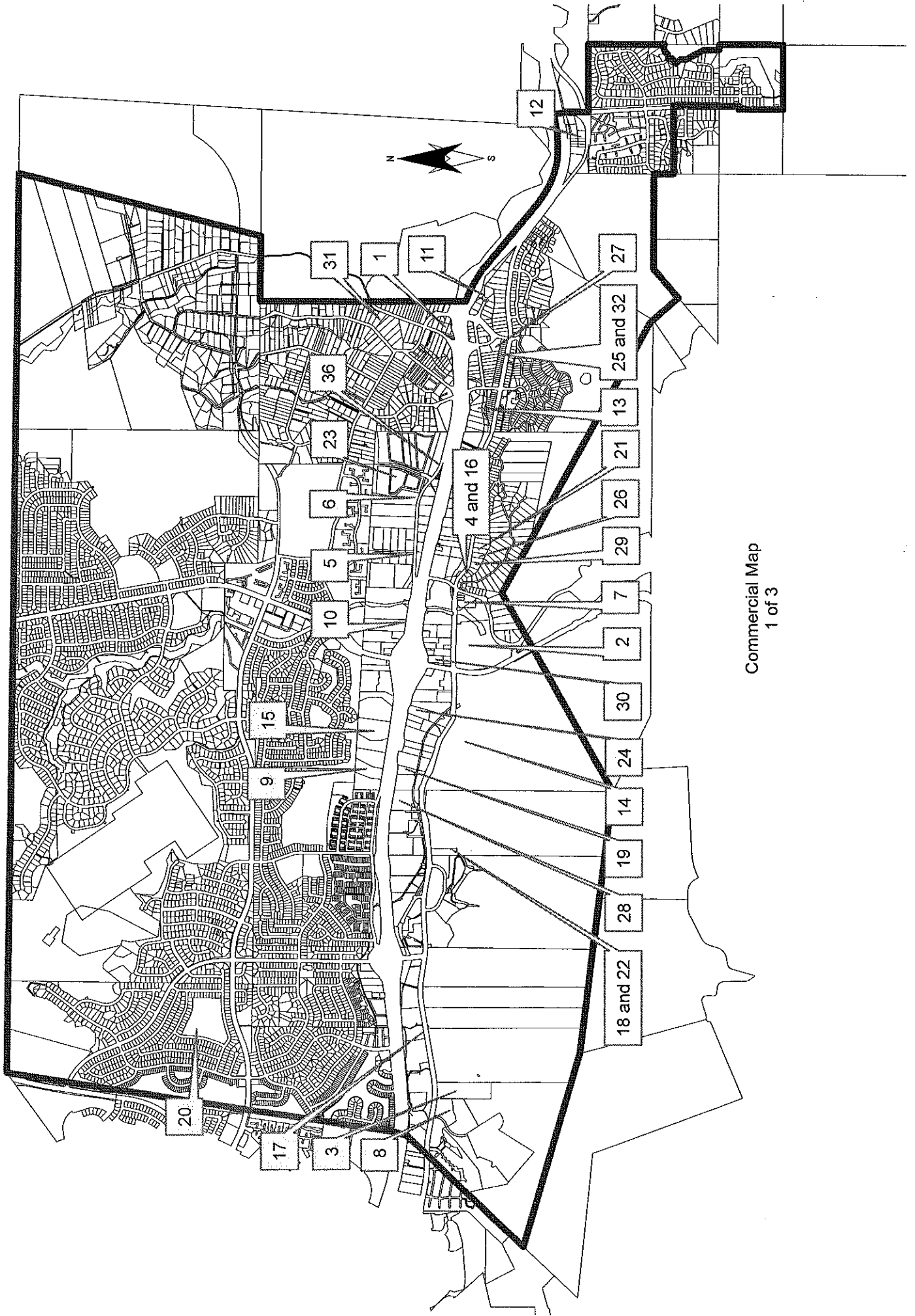

Approved Projects  
June 2008

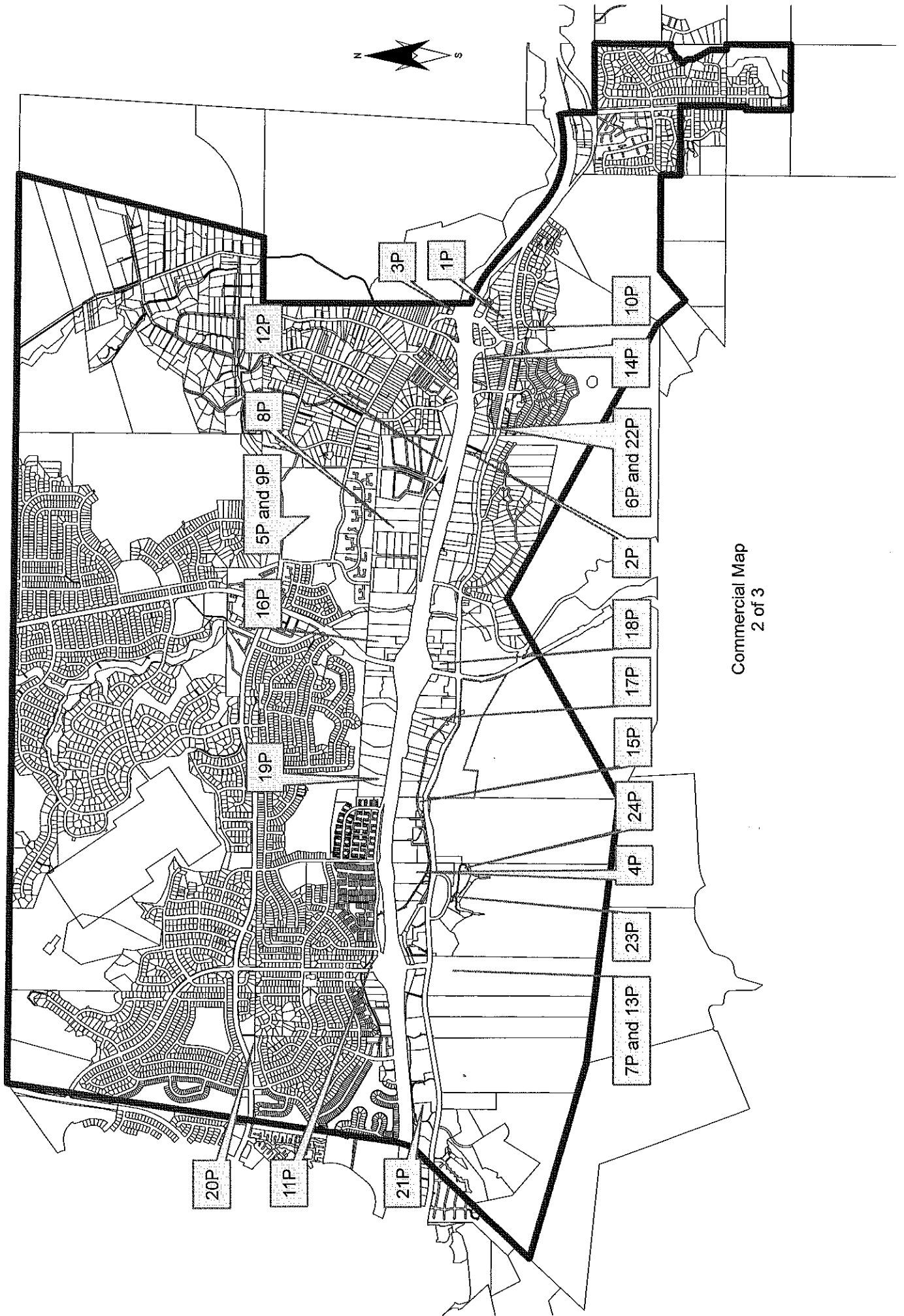



Completed Projects  
June 2008

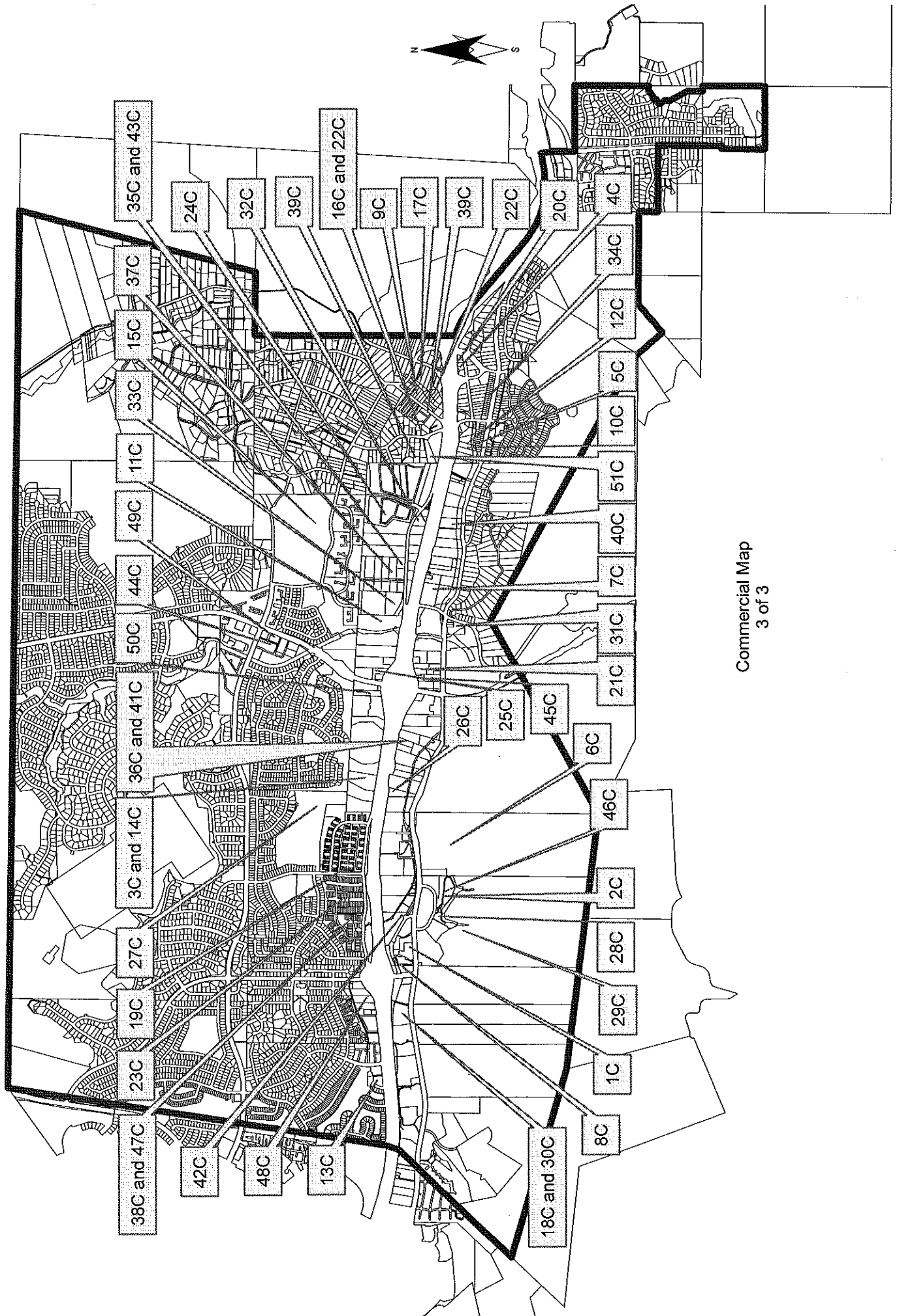

City of Agoura Hills Development Summary  
Table of Contents for Residential Cases (June 2008)

No.	Applicant	Project Location
<b>IN REVIEW</b>		
1	Ron Waters	28031 and 28031 Balkins Dr.
2	Scheff	28314 Foothill Dr.
3	Stockton/Iamburg	6149 Palo Comado Canyon Rd.
4	Ashnoor Pirouti	28454 Renee Dr.
5	Ashnoor Pirouti	28458 Renee Dr.
6	Lampert, Greg	5911 Fairview Pl.
7	Holmes for Morse	5810 Colodny Dr.
8	McAfee, Jane	5451 Colodny Dr.
9	Siboni	5446 Lewis Rd.
10	Steve Potter for John Manos	2 parcels on the west side of Foothill, east of Easterly, south of Fountain Pl.
11	Asa Arava	28443 Foothill Drive
12	Terry and Brian Condon	5656 Colodny Dr.
13	Abudalu, Joseph (Architect: Studio by Design)	28303 Laura La Plante Drive
14	M. Fredric & Co. (Fred and Lisa Levine)	6475 Chesebro Road
15	Ginsburg, Moty and Margo	5643 Colodny Dr.
16	Shuken, Jonathan (Architect, David Rhea)	6491 Chesebro Rd.
17	Ginsburg, Moty and Margo	5643 Colodny Dr.
18	Jager Associates for Michael Palache	Balkins Drive, 3 lots west of Lapworth, behind 2055-021-044
19	Kolve, Patrick	28250 Driver Ave.
20	Araujo, Ruben and Debra / Brent Schneider, Architect	6021 Colodny Drive
21	Sharon, Rafi and Orit	28220 Foothill Dr.
22	Bardaj, Nevin (Gary Bardovi, Architect/LCE Group, Inc.)	Balkins Drive
23	Thomas Brewer	4833 Canyon Way
24	Ahern	28401 Renee Dr.

City of Agoura Hills Development Summary  
Table of Contents for Residential Cases (June 2008)

No.	Applicant	Project Location
25	Profitable Sales Strategies/Terry Ahern	28401 Renee Dr.
26	Jon Shuken	6491 Chesebro Rd. (Lot 3 of Tr. 52396)
27	Ron Waters	28025 and 28031 Balkins
28	Janice Atkins	28506 Driver Ave.
29	Weireter, Philip & Sheryl (David Raider, Architect)	30645 Janlor Drive
30	Monte Vende Development	So.side of Agoura Rd, east of Cornell Rd.
31	Carlos Khantzis and Steve Rice	30800 Agoura Road
32	Cook, Joseph & Jill	5940 Chesebro Rd.
33	M. Kamal & Associates, LLC for Henry M. Halimi	28700 Thousand Oaks Blvd. (Park zoned lot east of Carell, north side of Thousand Oaks Blvd.)
34	Bailey for Tamara Friend	6350 Chesebro Road
35	Torres for Chris Haarhoff	6033 Colodny Drvie
36	Reza Nasr for Gerald Silver	5747 Fairview Pl.
37	Thomas Brewer and Ana Cullen	4833 Canyon Way

**APPROVED PROJECTS**

1P	Riopharm 2	27650 Agoura Rd.
2P	Rhombold	5241 Colodny Dr.
3P	Stockton	5310 Colodny Dr.
4P	Golenberg	5927 Colodny Dr.
5P	Benton (former Swift Construction for Coglin)	Lot 18 on Laura La Plante Dr.
6P	Adivi formerly Levy	6029 Fairview Dr.
7P	Riopharm USA Inc.	South side of Agoura Rd between Palo Comado and Liberty Canyon
8P	Moshe and Matty Bryski	5662 Middlecrest Dr.
9P	Swenson and Nadel	28354 Balkins Dr.
10P	Von Buck	27801 Blythedale Rd.
11P	Roser	28537 Fountain Pl.
12P	Ryan	29029 Acanthus Ct.

City of Agoura Hills Development Summary  
Table of Contents for Residential Cases (June 2008)

No.	Applicant	Project Location
13P	Francisco Vazquez for Janice Atkins	28506 Driver Ave.
14P	Feehan, Tim	5472 Fairview Pl.
15P	Raymond	5344 Lewis Rd.
16P	Mandler	5445 Meadow Vista
17P	Diamond	5833 Lapworth Dr.
18P	Schwartzberg for Datner	6137 Braemar Ct.
19P	Dawson for Sharon	28314 Foothill Dr.
20P	Schaub for Leggett	5939 Colodny Dr.
21P	Vasquez for Atkins	28506 Driver Ave.
22P	Chuck Francoeur for 'Montage Dev.'	5310 Colodny Dr.
23P	Foster	5545 Foothill Dr.
24P	Payan	28254 Laura La Plante Dr.
25P	Blinkinsoph for Thompson	Lewis Pl.
26P	Sears & Chase	30020 and 30014 Trail Creek Drive & HOA Common Area
27P	Linda Medvene	5857 Fairview Pl.
28P	Yvanova for Laura La Plante LLC	28221 Laura LaPlante Dr.
29P	DNA Construction for Albaum, David	5866 Fairview Place
30P	ARC Design/Ewing	28080 Balkins Dr.
31P	Millett, Mike and Darin	5446 Fairview Place
32P	Leininger, Bart & Laura	6162 Lake Lindero Dr.
33P	Sitin for Daniel Bouganim	5519 Lewis Lane
34P	Mahterian for Turley	6144 3/4 Chesebro Rd.
35P	Elbaum, Lisa and Steve. (Bagwell Construction)	29100 Quail Run Drive
36P	Steve and Marguerite Edwards	5952 Lapworth Dr. N.E. corner of Lapworth and Balkins
37P	Neil Pennywitt for Ron and Trish Burr	6129 Chesebro Road
38P	Alfonso Stanley Sosa	6317 Langhall Ct.

City of Agoura Hills Development Summary  
Table of Contents for Residential Cases (June 2008)

No.	Applicant	Project Location
39P	Scott Berg for Kearns	5740 Colodny Dr.
40P	Dembsky for Almany	3945 United Rd.
41P	McCann for Anav	5533 Fairview Pl.
42P	Pendlebury for Barnett	6044 Chesebro Rd.
43P	CJF Development Consultants for "Montage"	5310 Colodny Dr.
44P	Zev Beckerman (Sasson Bezalel for Zev)	27862 Blythdale Rd.
45P	Frank LaRosa and Emily Prano	5348 Chesebro Rd.
46P	N.E. Designs for Bar family	28466 Foothill Dr.
47P	Vladimir Zlatkov	28331 Laura LaPlante Dr.
48P	Agoura TNT LLC/Terry Gray	6170 Fairview Pl.
49P	David Rocca	6044 Lake Nadine Pl
50P	Bagwell Construction for Joel Rizor	5709 Fairview Pl
51P	Charles Blaugrund for Mr. & Mrs. Joey Butson	5619 Slicers Circle
52P	Robin, Louis & Lisa	5779 Willowtree Dr.
53P	Carroll, Gerald	5730 Fairview Place
54P	Leo Feierelsen for Garner	29004 Indian Ridge Ct.
55P	Dawson for Sharon	28243 Balkins Dr.
56P	Hedva Ergas	5490 Fairview Pl.
57P	Christopher Haarhoff (Jonathan Azal and B A Construction)	6033 Colodny Drvie

**COMPLETED PROJECTS**

1C	Gniadek/ Bullmer for Rasmussen	28611 Bamfield Ct.
2C	Crosby	28357 Foothill Dr.
3C	Parrott/ Green	29734 Blythedale Rd.
4C	Rosas	28366 Agoura Rd.
5C	Cardoni Group for Heflin	5626 Colodny Dr.
6C	Casey	5560 Fairview Pl.

City of Agoura Hills Development Summary  
Table of Contents for Residential Cases (June 2008)

No.	Applicant	Project Location
7C	Ybanez	5505 Foothill Dr.
8C	Littman	5401 Fairview Dr.
9C	Sorgenstein/ Parrot	5364 Lewis Rd.
10C	Tamayei	3955 Patrick Henry Rd.
11C	Palo Comado Ranch	w/s of Chesebro Rd. at northerly city limits
12C	Marlow for Schiffman	28461 Driver Ave.
13C	Gray	5936 Fairview Pl.
14C	Moraga	6000 Fairview Pl.
15C	ARC Inc.	29236 Laro Dr.
16C	Dan Sheldon	28232 Driver Ave.
17C	Phillips	5743 Fairview Pl.
18C	Stockton for Britton	27918 Blythedale Rd.
19C	Oak View Ranch	Various properties on Amelia Drive, Evita Court, Adelina Court Lots 46 of Tract 36749 and 62,63 & 64 of Tract 36746
20C	Gaines	6070 Chesebro Rd.
21C	Carpenter for Danielson	28428 Lewis Pl.
22C	DNA Construction for Mahler	5732 Rainbow Hill Rd.
23C	Linda Tatum	5364 Lewis Rd.
24C	Odney	30716 Lakefront Dr.
25C	Forest Construction for M/M Mohammadi	29033 Woodcreek Ct
26C	Richard Goodman	5437 and 5445 Colodny Dr.
27C	Shifman, Alan	5539 Fairview Pl.
28C	RJ Builders for Kupfer	29679 Kimberly Dr.
29C	Benhaim for Alkoby	28326 Foothill Dr.
30C	Mahterian for Clark	28242 Foothill Dr.
31C	Ryan & Lynette Lee	29577 Fountainwood St.
32C	Schneider	5276 Colodny Dr.
33C	JOR Development for Rocca	5425 Lewis Rd.
34C	Darryl Levine	5540 Coldny Dr.

City of Agoura Hills Development Summary  
Table of Contents for Residential Cases (June 2008)

No.	Applicant	Project Location
35C	Scaglioni	28331 Foothill Dr.
36C	CC&R for Henry Halimi	Lot G no. of T.O.Blvd.,east of Carell
37C	Richard Goodman	5437 and 5445 Colodny Dr.
38C	Peter Stern	5544 Colodny Dr.
39C	Flint	5552 Colodny Dr.
40C	Kersey	28406 Lewis Pl.
41C	Blahosky/Mallach	5533 Gladehollow Ct.
42C	Linda Rich	5626 Fairview Pl.
43C	David Hazlett	4956 Vejar Dr.
44C	Zoldan	5950 Lapworth Dr.
45C	Falcone/Garces	27411 Freetown Ln.
46C	Mineo	Lot 3 on Canyon Wy.
47C	Bailey for Tamara Friend	6350 Chesebro Road
48C	Stockton for Sisso	5415 Lewis Rd. (So.of Driver Ave.)
49C	Roit, Leo	28161 Laura LaPlante
50C	Larry Pollock	5734 Fairview Pl.
51C	Biddison, M	28359 Driver Ave.
52C	Cooper for Stitt	28037 Balkins Dr.
53C	John/Linda Quinn	5703 Willowtree Dr.
54C	Jacob	North of 5847 Colodny Dr.
55C	Mahterian for Mogan	28250 Laura LaPlante Dr.

**Residential Cases  
June 2008**

Proj. No.	Project Name	Case No.(s)	Project Location	Parcel Number	Site Size	Floor Area	Project Description	Case Planner
<b>IN REVIEW</b>								
1	Ron Waters	03-CUP-002 03-OTP-002 07-LLA-003	28031 and 28031 Balkins Dr.	2055-023-065 and 2055-023-062	1.59 acres or 69,260 sqft. (LLA refers to 1.50 and 1.37 NET ac.)	5,096 sqft. W/ 790 sqft. Garage	Custom house and Lot Line Adjustment on hillside lots.	V.D. and Ramiro Adeva for LLA
2	Scheff	03-SPR-006	28314 Foothill Dr.	2055-016-033	22,433 sqft.	2,498 sqft.	Room addition to an existing single-family residence	V.D.
3	Stockton/lamburg	03-CUP-016 03-OTP-017	6149 Palo Comado Canyon Rd.	2055-023-073	40,080 sqft.	4,688 sqft.	A two-story custom house with three car garage	V.D.
4	Ashnoor Pirouti	03-CUP-022	28454 Renee Dr.	2061-021-005	5,040 sq. ft.	1,534 sq. ft.	two-story S.F. D.U	V.D.
5	Ashnoor Pirouti	03-CUP-023	28458 Renee Dr.	2061-021-023	6,452 sq, ft,	1,219 sq. ft.	two-story S.F. D.U	V.D.
6	Lampert, Greg	04-LLA-013 To be upgraded to a Parcel Map	5911 Fairview Pl.	2055-025-060 through 064	N/A	N/A	combine 5 lots	S.S.
7	Holmes for Morse	05-SPR-022 and 05-OTP-029	5810 Colodny Dr.	2055-023-046	2.5 ac.	Square footage was not indicated for all the new structures to be added to the site.	New barn, garage, horse shelters, horse pen, corrals, arena, retaining walls.	V.D.
8	McAfee, Jane	05-SPR-026	5451 Colodny Dr.	2055-013-032	20,512 sq.ft.	771 sq.ft.	Add 771 sq.ft. (2 bedrooms and 2 baths) to existing 3,000 sq.ft. D.U. with a 455 sq.ft. garage.	R.M.
9	Siboni	05-SPR-028	5446 Lewis Rd.	2055-005-070	27,440 sqft.	6,335 sqft.	A 4,995 sqft. Single-family detached residence with 852 sqft. garage and a 488 sqft. pool house.	R.M.
10	Steve Potter for John Manos	PM65552	2 parcels on the west side of Foothill, east of Easterly, south of Fountain Pl.	2055-018-022 and 2055-018-023	one lot is 27,880 sq.ft. and one lot is 1.97 ac.	one lot proposed to be 48,295 sq. ft., one lot proposed to be 24,890 sq.ft. and one lot proposed to be 21,815 sq.ft.	A Parcel Map to create 3 lots from 2 hillside lots. Parcel 3 has 2 D.U. and 2 accessory bldgs. One D.U. is to be removed. The one to remain is only 2 to 3 feet from the south property line.	RM
11	Asa Arava	06-CUP-018 and 06-OTP-025	28443 Foothill Drive	2055-019-036	1 acre	4,266 sq. ft.	Three (3) story, 35 ft. high, single-family residence on a hillside lot.	R.M.
12	Terry and Brian Condon	06-LLA-001	5656 Colodny Dr.	2055-011-043 and 2055-011-044	One lot is 21,340 sq. ft. and one lot is 20,470 sq. ft.	Adjust lot lines so that one lot is 21,728 sq. ft. and one lot is 20,150 sq. ft.	Adjust lot lines to accommodate a pool on a lot without a primary structure.	S.S. and Ken Berkman
13	Abudalu, Joseph (Architect: Studio by Design)	06-CUP-019	28303 Laura La Plante Drive	2061-022-051	23,090 sq. ft.	3,630 sq. ft.	Construct 3,230 sq. ft., 2-story S.F.D. with a 400 sq. ft. attached garage.	R.M.
14	M. Fredric & Co. (Fred and Lisa Levine)	06-PAR-006	6475 Chesebro Road	2055-029-008	4.52 ac. (.06 ac is driveway and 2.79 ac. is restricted use area. Buildable area is 1.67 ac.)	12,092 sq. ft.	A Pre-App. to discuss issues relative to building a 8,727 sq. ft., 2-story S.F.D. w/ a 779 sq.ft. detached garage, a 429 sq. ft. pool pavilion, a 1,520 sq. ft. pool & deck and a 637 sq. ft. "Art Studio".	V.D.



**Residential Cases  
June 2008**

Proj. No.	Project Name	Case No.(s)	Project Location	Parcel Number	Site Size	Floor Area	Project Description	Case Planner
15	Ginsburg, Moty and Margo	07-CUP-005 and 07-OTP-003	5643 Colodny Dr.	2055-012-051	18,840 sq. ft. minus 5,130 sq.ft. of flood hazard area, leaving 13,710 sq.ft. of buildable area	6,752 sq.ft.	Build a 6,752 sq.ft. single-family house. ( 1st flr. 2,929 sq.ft.; 2nd flr. 2,034 sq.ft.; basement 1,790 sq.ft.	R.M.
16	Shuken, Jonathan (Architect, David Rhea)	07-PAR-001	6491 Chesebro Rd.	2055-029-003	1.46 ac.	6,546 sq.ft.	Pre-app. to discuss issues re building a 6,546 sq.ft. D.U. (5,109 sq.ft. living area, 1,437 sq.ft. garage)	V.D.
17	Ginsburg, Moty and Margo	07-INT-001	5643 Colodny Dr.	2055-012-051			Interpretation by P.C. Does a 1,790 sq.ft. basement count as a floor and add to height of building	R.M.
18	Jager Associates for Michael Palache	07-PAR-002	Balkins Drive, 3 lots west of Lapworth, behind 2055-021-044	2055-021-018	42,250 sq.ft.	5,500 sq. ft. building area, 690 sq.ft. garage	Pre-app. to discuss issues re building a 5,500 sq.ft., 2-story, single-story D.U. with a 690 sq.ft. garage. Bldg. footprint is 3,444 sq.ft. Paved area is 3,493 sq.ft. Paved driveway area is 11,149 sq.ft.	R.M.
19	Kolve, Patrick	08-SPR-008	28250 Driver Ave.	2055-005-040	21,700 sq. ft.	360 sq. ft.	Add a 360 sq. ft. bedroom, bath and closet to existing dwelling unit	B.T.
20	Araujo, Ruben and Debra / Brent Schneider, Architect	07-SPR-010	6021 Colodny Drive	2055-028-036	41,820 sq. ft.	8,634 sq.ft.	Construct 2-story, 5,962 sq.ft. S.F.R. with attached 1,622 sq.ft. garage; a 1,050 sq.ft. barn; a driveway motorcourt, a pool, horse riding ring, corrals and horse turn-out area.	R.M.
21	Sharon, Rafi and Orit	07-SPR-011 and 07-OTP-018	28220 Foothill Dr.	2055-016-023	31,360 sq.ft.	5,750 sq.ft.	Construct a 2-story, 3,751 sq. ft. S.F.R. with a 1,259 sq. ft. attached garage and 740 sq. ft. of patios.	R.M.
22	Bardai, Nevin (Gary Bardovi, Architect/LCE Group, Inc.)	07-CUP-011	Balkins Drive	2055-021-044	1.08 ac., minus .07 for slope easement; buildable lot is 1.01 ac.	5,772 sq. ft.	Construct a multi-level (two and three stories), 5,772 sq. ft. residence with attached garage; project includes a spa and future equestrian facilities.	R.M.
23	Thomas Brewer	07-PAR-005	4833 Canyon Way	2061-018-061 and 2061-018-062	Two (2) lots. One lot is 8,460 sq. ft. and the other lot is 7,900 sq. ft.	4,100 sq. ft.	Construct a multi-level (two stories over a full basement/parking level), single-family residence on two hillside lots which will be combined by a future Lot Line Adjustment application.	R.M.
24	Ahern	01-CUP-018 01-VAR-015	28401 Renee Dr.	2061-018-026,027	12,678 sqft.	2,669 sqft.	2,669 sqft. addition to an existing 2,583 sqft. house	R.H. V.D.
25	Profitable Sales Strategies/Terry Ahern	07-LLA-002	28401 Renee Dr.	2061-018-026 and 2061-018-027 (Note that the current, updated APN is 2061-018-079 because the applicant asked the Assessor to combine the lots for tax payment.			A Lot Line Adjustment application to merge two hillside lots into one lot.	Ramiro Adeva

**Residential Cases  
June 2008**

Proj. No.	Project Name	Case No.(s)	Project Location	Parcel Number	Site Size	Floor Area	Project Description	Case Planner
26	Jon Shuken	07-CUP-012 and 07-OTP-025 (prior related case: 07-PAR-001)	6491 Chesebro Rd. (Lot 3 of Tr. 52396)	2055-029-003	1.46 ac.	8,196 sq.ft.	Construct a 2-story, single-family residence with a 5 car garage. Living area is 5,109 sq. ft.; garage area is 1,437 sq. ft.; porches are 1,650 sq. ft.	V.D.
27	Ron Waters	07-LLA-003	28025 and 28031 Balkins	2055-023-062 and 065	1.50 NET ac. And 1.37 NET ac.		A Lot Line Adjustment app. To change the line between the two hillside lots	Ramiro Adeva
28	Janice Atkins	07-LLA-005	28506 Driver Ave.	2055-004-009 and 2055-004-038	1.44 ac. And 22,650 sq. ft.	21,781 sq. ft. and 63,715 sq. ft.	A Lot Line Adjustment app. To change the line between the two hillside lots	Ramiro Adeva
29	Weireter, Phillip & Sheryl (David Raider, Architect)	08-SPR-001	30645 Janlor Drive	2056-012-008	Approx. 7,236 sq.ft.	1,260 sq. ft.	A 1,260 sq. ft. first and second story addition to existing 1,736 sq. ft. residence.	B.T.
30	Monte Vende Development	04-PAR-006	So.side of Agoura Rd, east of Cornell Rd.	2061-025-001 to 007 2061-025-021 to 025 2061-025-038 to 040 2061-024-001 to 004 2061-026-015			16 Single-Family Lots	D.H.
31	Carlos Khantzis and Steve Rice	08-CUP-001; 08-SPA-001; 08-VAR-002; 08-OTP-004	30800 Agoura Road	2061-001-025	7.1 acres (buildable acres are 6.31)	104,138 sq. ft.	46 res. Condo units in 2 two-story, 34 ft.high buildings, including 6 affordable units; 2,786 sq.ft. of common area (multi-purpose rooms, offices) A separate 3,004 sq. ft. senior recreation center building; 129 parking spaces; A Specific Plan Amend.to permit residential use; A Variance to reduce front,side & rear set-backs and to increase retaining wall heights. Tent.Tr. Map & OakTree Permit	D.H.
32	Cook, Joseph & Jill	08-SPR-005	5940 Chesebro Rd.	2055-026-039	43,560 sq. ft. lot minus 190 sq. ft. for street = 43,370 sq. ft. buildable area	1,374 sq. ft.	Single-story room addition of 1,374 sq. ft. to existing 1,550 single-story house w/666 sq. ft. garage. A new porch, outdoor fireplace and gazebo will be added.	B.T.
33	M. Kamal & Associates, LLC for Henry M. Halimi	09-CUP-002; 08-ZC-001; 08-GPA-001; PM 69698 (former pre-application, 06-PAR-002)	28700 Thousand Oaks Blvd. (Park zoned lot east of Carell, north side of Thousand Oaks Blvd.)	2048-003-002	8.06 acres minus 0.26 acre future street, minus 7.80 acres of slope easement.	6,850 sq. ft.	A Parcel Map to subdivide one lot into two lots to construct a 6,850 sq. ft. D. U. on a hillside, donate one lot for park purposes, change the zone, amend the Gen. Plan.	R.M.
34	Bailey for Tamara Friend	08-CUP-003 (related cases: 07-OTP-009 and 07-SPR-007)	6350 Chesebro Road	2055-001-041	Approx. 3 ac.	Square footage was not indicated for all the new structures to be added to the site.	Demo existing concrete driveway, construct new access, barn structure w/12 stalls, tackroom, storage and office in the SEA area. A 5 ft. wooden fence around a new riding arena.	B.T.

**Residential Cases  
June 2008**

Proj. No.	Project Name	Case No.(s)	Project Location	Parcel Number	Site Size	Floor Area	Project Description	Case Planner
35	Torres for Chris Haarhoff	08-SPR-007 Related case is 08-SPR-002	6033 Colodny Drive	2055-028-035	40,950 sq. ft.	2,058 sq. ft.	Addition of 2,058 sq. ft. to existing 2,603 sq. ft. residence with a 418 sq. ft. garage.	B.T.
36	Reza Nasr for Gerald Silver	08-CUP-004 (There is a related case: 03-LLA-003)	5747 Fairview Pl.	2055-020-054	1.31 ac	4,747 sq. ft.	Add 2,412 sq.ft. to existing 2,011 sq.ft. D.U., enclose existing 943 sq.ft. atrium and convert to living & dining area. Add new 742 sq.ft. lower floor living area and a 1,593 sq.ft., 8-car garage. Note: This property has an approved(court ordered) Lot Line Adjustment 03-LLA-003 that has not yet been legally recorded to date.	R.M.
37	Thomas Brewer and Ana Cullen	08-CUP-005 and 08-LLA-001	4833 Canyon Way	2061-018-061 and 2061-018-062	Parcel 61 (lot 13) is 8,460 sq.ft. Parcel 62 (lot 14) is 7,900 sq.ft.	6,533 sq.ft.	New single-family D.U. with a 2,140 first floor, a 1,767 second floor and a 2,726 sq. ft. garage. A Lot Line Adjustment application to combine 2 lots	R.M.
<b>APPROVED PROJECTS</b>								
1P	Riopharm 2	TT48901, 90-CUP-010, 98-CUP-007	27650 Agoura Rd.	2061-014-027 through 042	10.58 acres	Three models from 2,777 to 3,235 sqft.	Renew CUP for 14 Single-family residences	D.H.
2P	Rhombold	01-SPR-004 TR53543	5241 Colodny Dr.	2055-006-194 through 197	.88 acre	1600-1700 sqft. Total: App. 31,000sqft	New 19 unit condo project	(E.B.) D.H.
3P	Stockton	01-SPR-008	5310 Colodny Dr.	2055-007-053	13,650 sqft.	8,068 sqft.	4-unit apartment building	(D.H.) R.M.
4P	Golenberg	02-SFR-010 02-OTP-008	5927 Colodny Dr.	2055-028-040	45,372 sqft.	476 sqft.	Room addition to an existing single-family dwelling	V.D.
5P	Benton (former Swift Construction for Coglin)	03-CUP-001 03-VAR-001	Lot 18 on Laura La Plante Dr.	2061-016-054	.271 acres or 11,801.76	3000 sqft.	Custom House on hillside lot	V.D.
6P	Adivi formerly Levy	03-CUP-003	6029 Fairview Dr.	2055-022-047	2.56 acres	6,917 sqft.	Custom house on hillside lot	(D.H.) R.M.
7P	Riopharm USA Inc.	03-CUP-010 03-VAR-005 TR 48901	South side of Agoura Rd between Palo Comado and Liberty Canyon	2061-014-007 through 015 & 2061-014-18 through 20 & 2061-014-23 through 26	10.58 acres	Three models from 2,777 to 3,235 sqft.	Renew CUP for 13 Single-family residences	D.H.
8P	Moshe and Matty Bryski	2007-DCP-001	5662 Middlecrest Dr.	2056-027-002			Application for a large family Day Care Permit	R.M.
9P	Swenson and Nadel	03-CUP-011 03-OTP-008	28354 Balkins Dr.	2055-021-042	39,247 sqft.	4,627 sqft.	A custom house with attached three car garage	(E.B.) D.H.
10P	Von Buck	03-CUP-017 03-OTP-016	27801 Blythedale Rd.	2055-001-035	4.27 acres	4,274 sqft with 1,272 sqft. Garage	A two-story custom house with three car garage	V.D.
11P	Roser	03-CUP-020	28537 Fountain Pl.	2055-019-025	5.25 acres	4,736 sqft.	A two-story custom house	R.M.
12P	Ryan	04-MOD-001	29029 Acanthus Ct.	2051-003-006	6,758 sq.ft.	457 sq. ft.	Mod. For 2nd story room add.	V.D.
13P	Francisco Vazquez for Janice Atkins	04-SPR-022 Amendment	28506 Driver Ave.	2055-004-011 and 032	62,820 sq.ft.	426 sq. ft.	Add 426 sq.ft. to an approved project and revise the grading plan to include both of the combined lots.	R.M.

**Residential Cases  
June 2008**

Proj. No.	Project Name	Case No.(s)	Project Location	Parcel Number	Site Size	Floor Area	Project Description	Case Planner
14P	Feehan, Tim	04-SPR-004	5472 Fairview Pl.	2055-014-028	21000 sqft.	700 sq. ft.	second story rm addition	D.H.
15P	Raymond	04-SPR-007	5344 Lewis Rd.	2055-005-058	19,520 sq.ft.	1,663 sq.ft.	2nd.flr.room add.	V.D.
16P	Mandler	04-SPR-009	5445 Meadow Vista	2053-019-007	5676 sq. ft.	1,593 sq.ft.	One and two-story room addition	V.D.
17P	Diamond	04-SPR-011	5833 Lapworth Dr.	2055-021-028	1 acre	1,369 sqft.	One-story room addition	V.D.
18P	Schwartzberg for Datner	04-SPR-012	6137 Braemar Ct.	2056-050-044	20,140sq.ft.	1,904 sq.ft.	2-story rm. Add	V.D.
19P	Dawson for Sharon	04-SPR-017	28314 Foothill Dr.	2055-016-033	22,440	1,268 sq. ft.	Two-story room addition	V.D.
20P	Schaub for Leggett	04-SPR-018 04-OTP-021	5939 Colodny Dr.	2055-028-039	40,950 sq.ft.	1,779 sq. ft.	One story room addition	V.D.
21P	Vasquez for Atkins	04-LLA-012 04-SPR-022 04-CFC-001	28506 Driver Ave.	2055-004-032	N/A	N/A	combine 2 lots + 2.098 sqft. room addition	V.D.
22P	Chuck Francoeur for 'Montage Dev.'	Tr. 69073 (related to 01-SPR-008 and 06-SPR-003)	5310 Colodny Dr.	2055-007-053			Convert the approved (unconstructed) apt.units to condos	R.M.
23P	Foster	04-SPR-019	5545 Foothill Dr.	2055-018-041	24,480 sq. ft.	2,998 sq. ft.	1 story, S.F. D.U.	V.D.
24P	Payan	04-CUP-001 04-VAR-001	28254 Laura La Plante Dr.	2061-017-007	6,68 sqft.	3,154 sq.ft.	two-story SFDU	V.D.
25P	Blinkinsoph for Thompson	04-CUP-003 03-LLA-001 03-PAR-001	Lewis Pl.	2061-022-029 and 30	13,129 sq. ft.	2,567 sq. ft.	single-fam D.U.	V.D.
26P	Sears & Chase	04-LLA-014	30020 and 30014 Trail Creek Drive & HOA Common Area	2053-029-040 & 041 & 2053-018-033	N/A	N/A	Adjust south property line of two lots	Eng. Dept.
27P	Linda Medvene	07-SPR-005 and 05-OTP-002 (related case: 05-SPR-003)	5857 Fairview Pl.	2055-027-066	1.26 ac.	589.75 sq.ft.	Add 589,75 sq. ft. to existing 3,831 sq.ft. residence and add a 672 sq.ft. garage and a 600 sq. ft. barn.	B.T.
28P	Yvanova for Laura La Plante LLC	05-CUP-002 05-VAR-003 05-LLA-003 05-OTP-015	28221 Laura LaPlante Dr.	2061-016-063 & 2061-016-072	16,390 sq.ft. (2 lots)	3,400 sq. ft.	SFR, Variance for frontyard setback, lot merger and removal of oak trees	V.D.
29P	DNA Construction for Albaum, David	06-SPR-010	5866 Fairview Place	2055-027-074	81,020 gross sq. ft., 41,810 net sq.ft. after road and flood hazard is subtracted	494 sq. ft.	Construct a 494 sq. ft. single-story room addition to a 2,966 sq. ft. S.F.D. and remodel kitchen	B.T.
30P	ARC Design/Ewing	05-SPR-011	28080 Balkins Dr.	2055-023-098	44,965 sq.ft.	4,037 sq.ft. + 1,408	2 story SFR w/garage + acc. Bldg.	R.M.
31P	Millett, Mike and Darin	06-SPR-011 06 OTP-031 and 08-VAR-001	5446 Fairview Place	2055-014-018	41, 500 sq. ft.	1,399 sq. ft.	Request to reduce the non-conforming south side yard setback of 9'11" to 7'4" for a proposed 1,399 sq.ft. room addition and a 500 sq.ft. porch to the existing dwelling unit.	B.T.
32P	Leininger, Bart & Laura	05-SPR-025	6162 Lake Lindero Dr.	2056-054-009	9,639 sq.ft.	365 sq.ft. addition to be added to a prior 327 sq.ft. addition built in 2005.	First and second story room addition to existing single-family residence	C.A.

**Residential Cases  
June 2008**

Proj. No.	Project Name	Case No.(s)	Project Location	Parcel Number	Site Size	Floor Area	Project Description	Case Planner
33P	Sitin for Daniel Bouganim	07-SPR-009	5519 Lewis Lane	2055-017-028	21,490 sq.ft.	694 sq.ft.	Add a 694 sq.ft., first floor master bdrm. & bath to the existing first floor sq. footage of 2,668.	B.T.
34P	Mahterian for Turley	05-SPR-001	6144 3/4 Chesebro Rd.	2055-024-053	44,431 sq.ft.	5,296 sq.ft. & 592 sq.ft.	S.F. res. w/ detached bldg.	R.M.
35P	Elbaum, Lisa and Steve. (Bagwell Construction)	08-MOD-001	29100 Quail Run Drive	2053-005-038	8,498 sq. ft.	193 sq. ft.	A Yard Modification app. Requesting to decrease the rear yard from the required 20' to 16' for 193 sq. ft. addition to the kitchen.	B.T.
36P	Steve and Marguerite Edwards	06-CUP-008 and 06-OTP-017	5952 Lapworth Dr. N.E. corner of Lapworth and Balkins	2055-022-073	Approx.59,983 sq. ft.	4,950 sq.ft. , 908 sq.ft. , 347 sq. ft., and 1,502 sq. ft. Total of 7,707 sq. ft.	A 2-story 4,950 sq.ft. D.U. w/908 sq.ft. attached 3-car garage w/347 sq.ft. studio above garage and 1,502 sq. ft. barn	R.M.
37P	Neil Pennywitt for Ron and Trish Burr	07-SPR-016 related cases 01-CUP-002; 01-MOD-001 and 01-OTP-003	6129 Chesebro Road	2055-023-075	26,572 sq. ft.	280 sq. ft.	Enclose a second floor roof deck, creating a 280 sq. foot addition to the existing master bedroom.	B.T.
38P	Alfonso Stanley Sosa	08-SPR-006	6317 Langhall Ct.	2051-013-046	9,420 sq. ft.	578 sq. ft.	Remodel 659 sq. ft. of existing 3,548 sq. ft. D.U. and construct a 578 sq. ft. addition.	B.T.
39P	Scott Berg for Kearns	06-SPR-002	5740 Colodny Dr.	2055-011-039	19,600 sq.ft.	222 sq.ft.	222 sq.ft. room addition to existing D.U.	R.M.
40P	Dembsky for Almany	05-MOD-006	3945 United Rd.	2064-018-006	N/A	846 sq.ft.	A Mod. Request to reduce the required front yard setback from 25 ft. to 21 feet.	C.A.
41P	McCann for Anav	05-SPR-027	5533 Fairview Pl.	2055-016-026	42,690 sq.ft.	1,039 sq.ft.	1,039 sq.ft. add. To existing 1,009 sq.ft. D.U. and a 586 sq.ft. covered porch	R.M.
42P	Pendlebury for Barnett	06-SPR-001	6044 Chesebro Rd.	2055-026-030	1.02 ac.	415 sq.ft.	415 sq.ft. addition	R.M.
43P	CJF Development Consultants for "Montage"	06-SPR-003	5310 Colodny Dr.	2055-007-053	13,650 sqft.	8,068 sqft.	Time extension on 4 units. Former case number 01-SPR-008	R.M.
44P	Zev Beckerman (Sasson Bezalet for Zev)	07-SPR-003; Related case: 06-SPR-005 (admin)	27862 Blythdale Rd.	2055-024-004	1.04 ac.	3,055 sq.ft.	Construct a new 3,055 sq. ft. D.U. in same area as former "tear-down". The lot has an existing garage and pool.	R.M.
45P	Frank LaRosa and Emily Prano	06-SPR-007	5348 Chesebro Rd.	2052-007-007	21,699 sq.ft.	2,092 sq.ft.	695 sq.ft. garage conversion. 191 sq.ft. 1st flr add. And 576 sq.ft. 1st flr garage add. & 630 sq. ft. 2nd flr.addition	R.M.
46P	N.E. Designs for Bar family	06-SPR-008	28466 Foothill Dr.	2055-017-009	28,700 sq.ft.	840 sq.ft.	840 sq.ft., one-story addition to existing 2,157 sq. ft. D.U.	RM
47P	Vladimir Zlatkov	06-CUP-004 refer to 05-PAR-003	28331 Laura LaPlante Dr.	2061-022-016	7,000 sq.ft.	3,235 sq.ft. D.U. with a 682 sq. ft. garage	Two-story single-family dwelling unit	R.M.

**Residential Cases  
June 2008**

Proj. No.	Project Name	Case No.(s)	Project Location	Parcel Number	Site Size	Floor Area	Project Description	Case Planner
48P	Agoura TNT LLC/Terry Gray	06-CUP-005 and 06-OTP-008	6170 Fairview Pl.	2055-023-096	1.25 ac.	5,764 sq.ft.	New 5,764 sq. ft., two-story, single-family D.U. with a 1,008 sq. ft. attached garage and a 532 sq. ft. detached garage with future "pool house" above the detached garage structure.	R.M.
49P	David Rocca	08-SPR-004	6044 Lake Nadine Pl	2056-025-020	7,336 sq. ft.	520 sq. ft.	520 sq. ft. addition and new front porch to existing 1,920 sq.ft. residence.	B.T.
50P	Bagwell Construction for Joel Rizer	07-SPR-001	5709 Fairview Pl	2055-020-064	20,262 sq.ft.	716 sq. ft., plus 1,266 sq. ft.	Add 716 sq. ft. rm. addition to existing 2,428 sq.ft. D.U., plus add a 1st & 2nd story deck totaling 1,266 sq. ft.	B.T.
51P	Charles Blaugrund for Mr. & Mrs. Joey Butson	07-SPR-002 and 07-VAR-001	5619 Slicers Circle	2054-018-132	4,070 sq.ft.	1,866 sq. ft.	Add a 1,645 sq.ft. 2nd story w/a 156 sq.ft. balcony and a 65 sq.ft. addition to the first floor of an existing 1,667 sq.ft. D.U. and a Variance app. requesting a reduction of side & rear yard setbacks	R.M.
52P	Robin, Louis & Lisa	08-SPR-003	5779 Willowtree Dr.	2056-036-023	20,258 sq. ft.	2,600 sq. ft.	Addition of 2,600 sq. ft. to the existing residence. Total finished sq. ft. will be 5,600.	B.T.
53P	Carroll, Gerald	07-SPR-006	5730 Fairview Place	2055-012-031		576 sq. ft.	Addition of a 576 sq. ft. storage building in rear yard	B.T.
54P	Leo Felerelsen for Garner	07-SPR-014	29004 Indian Ridge Ct.	2051-002-034		869 sq. ft.	Add 212 sq. ft. to 1st floor, 234 sq. ft. to 2nd floor & a 423 sq. ft. covered patio	B.T.
55P	Dawson for Sharon	06-CUP-001	28243 Balkins Dr.	2055-022-080	1.13 acres	5,678 sqft.	A 4,968 sqft. Single-family detached residence with 710 sqft. garage with pool and spa.	R.M.
56P	Hedva Ergas	07-SPR-004	5490 Fairview Pl.	2055-014-027	45,005 sq.ft.	799 sq. ft.	Add a 342 sq.ft. family rm. And a 457 sq. ft. office and gym to existing 1,702 sq.ft. D.U. w/ 499 sq.ft. garage.	B.T.
57P	Christopher Haarhoff (Jonathan Azal and B A Construction)	08-SPR-002	6033 Colodny Drive	2055-028-035	40,950 sq. ft.	580 sq/ ft/	Add 580 sq. ft. to existing 2021 sq. ft. residence with a 418 sq. ft. garage	B.T.
<b>COMPLETED PROJECTS</b>								
1C	Gniadek/ Bullmer for Rasmussen	02-SPR-016	28611 Bamfield Ct.	2050-022-001	16.84 acres	5,200 sqft.	1,186 sqft room addition.	V.D.
2C	Crosby	01-CUP-010 01-VAR-011	28357 Foothill Dr.	2055-019-035	20,473 sqft.	1,700 sqft.	New SF House and Variance to allow private septic	R.H.
3C	Parrot/ Green	03-SPR-004	29734 Blythedale Rd.	2055-024-007	1 acre	5,100 sqft	Custom house with three car garage	E.B.
4C	Rosas	02-SPR-01	28366 Agoura Rd.	2061-022-034	8,799 sqft.	N/A	Slope Repairs with retaining walls.	V.D.
5C	Cardoni Group for Heflin	02-SPR-001	5626 Colodny Dr.	2055-009-011	40,946 sqft.	327 sqft.	327 sqft room addition to single family	R.H.
6C	Casey	02-SPR-013	5560 Fairview Pl.	2055-012-016, 2055-013-027, 2055-012-015	1.56 acres	1,277 sqft.	Addition to an existing residence	R.H.
7C	Ybanez	01-SPR-003 (Admin.)	5505 Foothill Dr.	2055-018-031	20,081 sqft.	578 sqft. 2nd fl. 165 sqft. 1st flr.	1st and 2nd addition to existing SFR	R.H.

**Residential Cases  
June 2008**

Proj. No.	Project Name	Case No.(s)	Project Location	Parcel Number	Site Size	Floor Area	Project Description	Case Planner
8C	Littman	02-SPR-022	5401 Fairview Dr.	2055-015-047	26,223 sqft.	1,306 sqft.	Room Addition.	R.H.
9C	Sorgenstein/ Parrot	03-CUP-004 and Amendt.	5364 Lewis Rd.	2055-005-052	0.5 acre	2,471 sqft.	One single-family detached	D.H.
10C	Tamayel	03-MOD-002	3955 Patrick Henry Rd.	2064-015-022	8,293 sqft.	1,550+216 sqft.	Modification from required setbacks for a 216 sqft. addition.	R.H.
11C	Paio Comado Ranch	97-CUP-012 TT52397	w/s of Chesebro Rd. at northerly city limits	2055-001-028	91 acres	N/A	8 residential lots	D.H.
12C	Marlow for Schiffman	04-SPR-006	28461 Driver Ave.	2055-017-036	22,240 sq.dr.	529 sq. ft.	Room addition to an existing dwelling unit	R.H.
13C	Gray	03-CUP-012	5936 Fairview Pl.	2055-028-048	1.01 acres	5,610 sqft.	A custom house with attached three car garage	V.D.
14C	Moraga	02-CUP-001	6000 Fairview Pl.	2055-028-047	1.01 acres	3,663 sqft	One single-family detached	R.H.
15C	ARC Inc.	02-SPR-012	29236 Laro Dr.	2056-042-011	33,400 sqft.	4,975 sqft.	Single-family detached residence	R.H.
16C	Dan Sheldon	00-CUP-005	28232 Driver Ave.	2055-005-043	.50 acre	3,700 sqft.	One single-family detached	J.J.
17C	Phillips	03-PAR-006 03-CUP-015 03-OTP-006	5743 Fairview Pl.	2055-020-068	1.01 acres	5,610 sqft.	A custom house with attached car garage and amendt. to add a 820 sqft. second story.	D.H.
18C	Stockton for Britton	03-SPR-005	27918 Blythedale Rd.	2055-024-006	43,916 sqft.	3,62 sqft. + 537 sqft. Garage	Custom house and accessory building	R.H.
19C	Oak View Ranch	03-LLA-004 03-LLA-005 03-LLA-006	Various properties on Amelia Drive, Erta-Court-Evita Court, Adelina Court Lots 46 of Tract 36749 and 62,63 & 64 of Tract 36746	N/A	N/A	N/A	Lot line adjustments to comply with existing fence lines	S.S.
20C	Gaines	03-SPR-009	6070 Chesebro Rd.	2055-026-035	1 acre	4,197 sqft.	A one-story custom house	V.D.
21C	Carpenter for Danielson	01-CUP-013	28428 Lewis Pl.	2061-022-044	3,720 sqft.	2,610 sqft.	Single-family detached residence	R.H.
22C	DNA Construction for Mahler	04-SPR-013	5732 Rainbow Hill Rd.	2056-014-010	7,006	611 sq.ft.	One and two-story room addition	R.M.
23C	Linda Tatum	03-CUP-004 Amendment	5364 Lewis Rd.	2055-005-052	25,700 sqft.	n/a	Re-alignment of approved driveway	R.M.
24C	Odney	05-SPR-019	30716 Lakefront Dr.	2054-006-050	0.11 acres	1,083 sq. ft.	A 952 sqft. addition	C.A.
25C	Forest Construction for M/M Mohammadi	04-SPR-014	29033 Woodcreek Ct	2051-003-027	7,085	835 sq.ft.	One and two-story room addition	R.M.
26C	Richard Goodman	05-LLA-005	5437 and 5445 Colodny Dr.	2055-013-016	1 acre	N/A	Lot Line Adjustment for two residential parcels	S.S.
27C	Shifman, Alan	04-SPR-016 & Amendment	5539 Fairview Pl.	2055-016-032	20,025.39 sq.ft.	308 sq.ft.	Library/laundry rm addition to existing single-family residence	R.M.
28C	RJ Builders for Kupfer	05-MOD-001	29679 Kimberly Dr.	2056-053-036	44,,792 sqft.	59 sq.ft.add.	Request for side yard reduction	W.W.
29C	Benham for Alkoby	04-SPR-021	28326 Foothill Dr.	2055-016-011	21,780 sqft.	364 sqft.	364 sqft. Room Addition	R.M.
30C	Mahterian for Clark	04-SPR-008	28242 Foothill Dr.	2055-016-020	20,040 sq. ft.	337 sq. ft.	single-story rm addition	D.H.
31C	Ryan & Lynette Lee	05-MOD-004	29577 Fountainwood St.	2051-013-017	10,972 sqft.	470 sq. ft.	2nd story rm.add. With reduced set-back	R.M.
32C	Schneider	00-SPR-007 01-OTP-011	5276 Colodny Dr.	2055-007-050	.253 acre	6,688 sqft.	4 unit condominium project	R.H.

**Residential Cases  
June 2008**

Proj. No.	Project Name	Case No.(s)	Project Location	Parcel Number	Site Size	Floor Area	Project Description	Case Planner
33C	JOR Development for Rocca	04-SPR-001	5425 Lewis Rd.	2055-004-019	0.525 acres	4,595 sqft.	Single-family dwelling unit	D.H.
34C	Darryl Levine	05-SPR-023	5540 Coldny Dr.	2055-009-024	20,020 sq.ft.	775 sq ftl	339 sq. ft. single-story addition & 436 sq.ft. covered patio	C.A.
35C	Scaglioni	00-CUP-004	28331 Foothill Dr.	2055-020-058	22,169 sqft.	3,784 sqft.	New single-family dwelling	D.H.
36C	CC&R for Henry Halimi	06-PSR-002	Lot G no. of T.O.Blvd.,east of Carell	2048-003-002			Pre-screen Review requesting City to vacate easterly portion of T.O. Blvd., to allow a SFR on a Open Space lot	D.H.
37C	Richard Goodman	05-LLA-010	5437 and 5445 Colodny Dr.	2055-013-033; 042,043	N/A	2/20,000 sqft. Lots	Revise Lot Line Adjustment for 2 res. Parcels	S.S. and Ken Berkman
38C	Peter Stern	04-SPR-025	5544 Colodny Dr.	2055-009-025 (2055-013-047)	21,370	4,105 sq.ft, 482 sq. ft. garage plus acc.	D.U. , garage,barn	V.D.
39C	Flint	05-SPR-020	5552 Colodny Dr.	2055-009-016	21,780 sq.ft.	3,438 sq.ft.	A 1,650 sqft. addition with a 1,788s sqft. barn	C.A.
40C	Kersey	04-CUP-008 04-VAR-003 04-PAR-001	28406 Lewis Pl.	2061-022-018	5619 sqft.	2,089 sq.ft.	2-story, single-family D.U.	R.M.
41C	Blahosky/Mallach	05-SPR-008	5533 Gladehollow Ct.	2053-002-003	6,098 sqft.	add 1,142 sq.ft.	2nd story rm.add.	R.M.
42C	Linda Rich	05-SPR-009	5626 Fairview Pt.	2055-012-049	26,136 sq.ft,	add 233 sq.ft.	2-story add.& remodel interior	R.M.
43C	David Hazlett	05-SPR-013	4956 Vejar Dr.	2061-025-036	14,360 sq.ft.	720 sq. ft.	1 & 2 story rm.add	R.M.
44C	Zoldan	05-SPR-016	5950 Lapworth Dr.	2055-027-065	40,281 sq.ft.	6,590 sq. ft.	A request to build a 5,830 sq.ft.D.U. with a 760 sq. ft. garage	V.D.
45C	Falcone/Garces	05-SPR-006 05 MOD-003	27411 Freetown Ln.	2064-009-037	9401 sqft.	add 1,206 sq.ft.	1 & 2 story rm.add & garage add.	R.M.
46C	Mineo	01-CUP-006 01-VAR-005	Lot 3 on Canyon Wy.	2061-017-003	6,824 sqft.	2,968 sqft.	New single-family dwelling	(R.H.) D.H
47C	Bailey for Tamara Friend	07-SPR-007 and 07-OTP-009	6350 Chesebro Road	2055-001-041	3.29 ac	685 sq.ft.	Add a new 499 sq.ft.garage & a new 186 sq.ft. porch, convert an exist. 1,901sq.ft. garage to living space & convert an exist.breezeway to 573 sq.ft of living space to exist. D.U.	B.T.
48C	Stockton for Sisso	06-SPR-004	5415 Lewis Rd. (So.of Driver Ave.)	2055-004-020	approx. 23,000 sq.ft.	3,850 sq. ft. D.U. & 650 sq. ft. garage	Single-story, single-family D.U. with attached 2 car garage.	V.D.
49C	Roit, Leo	06-CUP-013; 06-VAR-006; 06-OTP-030	28161 Laura LaPlante	2061-016-053	8,000 sq. ft.	2,604 sq. ft.	Construct a 2,172 sq. ft. , one-story, single-family D.U. with a 432 sq. ft. attached garage	R.M.
50C	Larry Pollock	07-SPR-013	5734 Fairview Pl.	2055-012-035	.96 ac.	336 sq. ft.	Applicallion to remodel and add 336 sq. ft. to the existing 2,605 sq. ft. single-family residence	B.T.
51C	Biddison, M	04-SPR-003	28359 Driver Ave.	2055-015-063	.96 acres	3,080/865 sq.ft.	1 story SF DU	D.H.
52C	Cooper for Stitt	05-SPR-005 & 05-OTP-007	28037 Balkins Dr.	2055-023-080	1.6 acres	add 735 sq.ft, and 1,052 sq.ft. interior remodel	1st & 2nd story add. And remodel	R.M.



**Residential Cases  
June 2008**

Proj. No.	Project Name	Case No.(s)	Project Location	Parcel Number	Site Size	Floor Area	Project Description	Case Planner
53C	John/Linda Quinn	05-SPR-007	5703 Willowtree Dr.	2056-037-014	20,741 sqft.	add 1,428 sq.ft.	1 story add. & remodel 780 sq. ft. kitchen	R.M.
54C	Jacob	05-CUP-005, 05-VAR-008, and 05-OTP-003	North of 5847 Colodny Dr.	2055-028-042	27,880 sq.ft.	4,061+518+864 s.f.	2 story S.F.D.U.w/porch,garage, barn + future pool	V.D.
55C	Mahterian for Mogan	05-CUP-004 05-MOD-005 05-LLA-008	28250 Laura LaPlante Dr.	2061-17-29;43;44;46	.51 acres Merge 4 lots	Add 1,015 sq.ft to an existing 1,339 sqft. DU with a 362 sqft. garage	Mod. Request to reduce front yard setback from 25' to 20'. Total finished sq.ft. of D.U. will be 2,354 sq.ft., plus 362 sq.ft. garage.	R.M.

**Projects In Review  
June 2008**

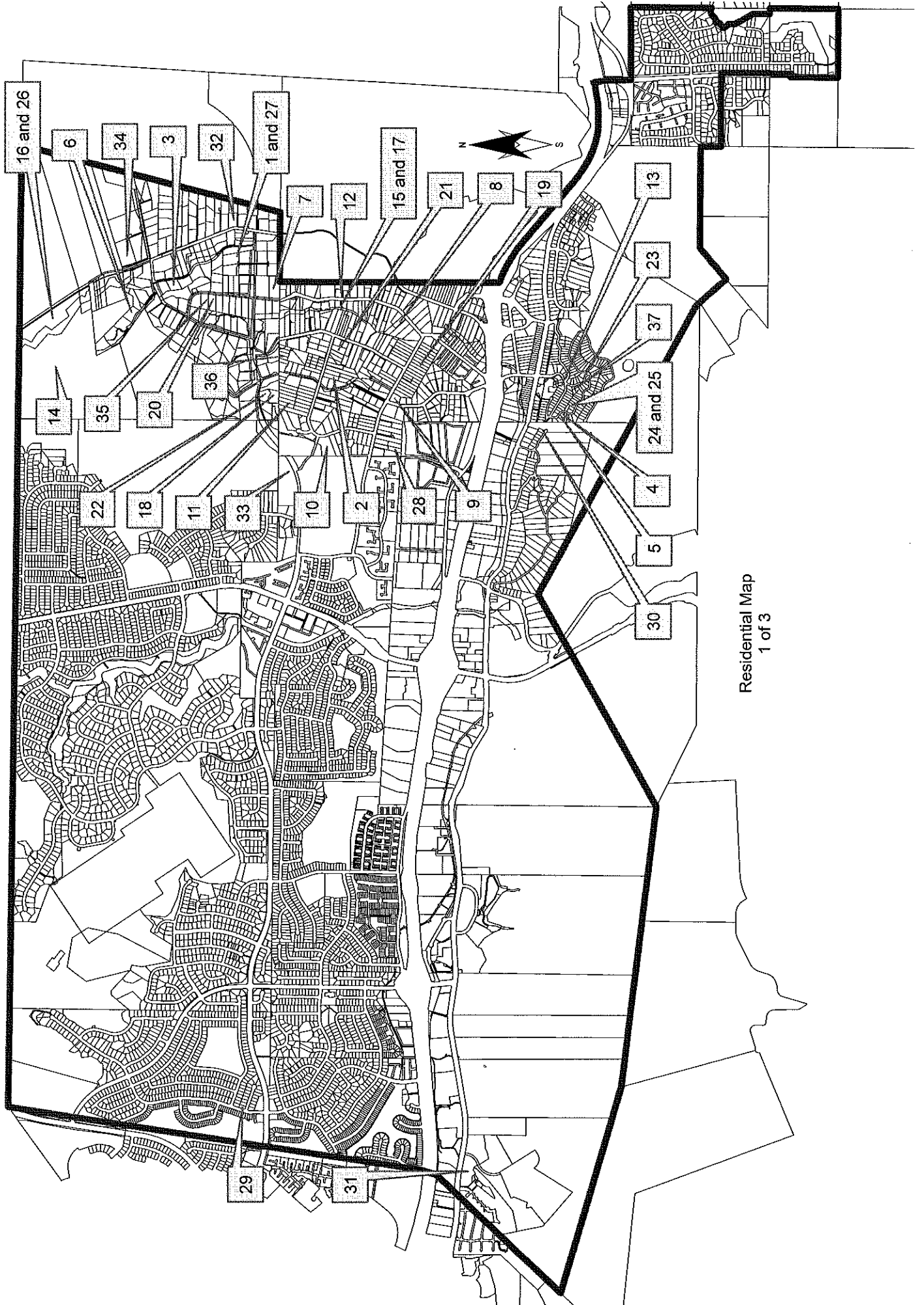

Approved Projects  
June 2008

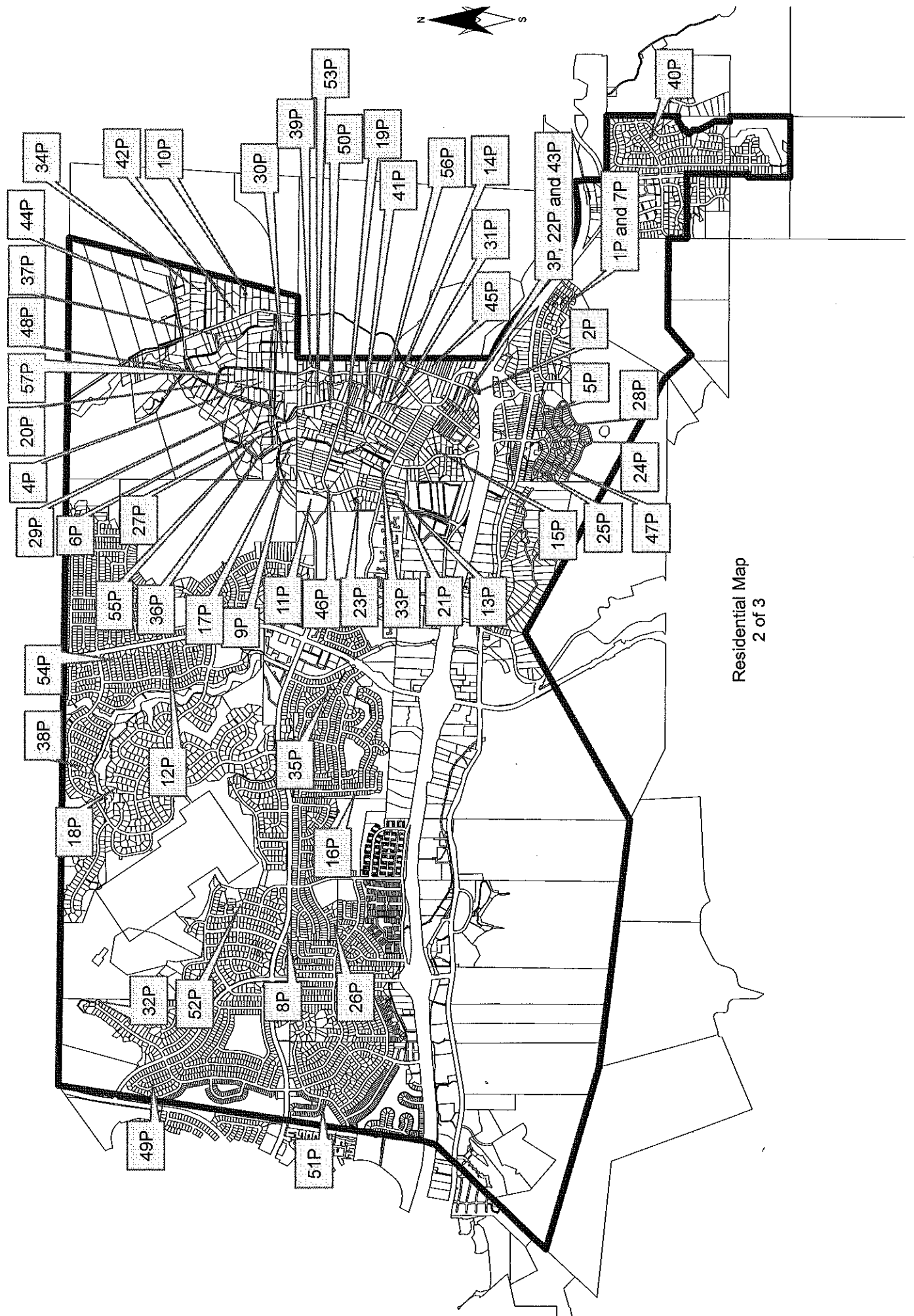

**Completed Projects  
June 2008**

