



**DEPARTMENT OF PLANNING AND COMMUNITY
DEVELOPMENT**

**COMMERCIAL AND RESIDENTIAL
DEVELOPMENT SUMMARY**

SEPTEMBER 2008

City of Agoura Hills Development Summary
Table of Contents for Commercial Cases (September 2008)

No.	Applicant	Project Location
IN REVIEW		
1	Rose (Stuart Rose)	5216 Chesebro Rd.
2	E.F. Moore & Co.	SEC of Agoura and Kanan
3	Heathcote for Buckley	South of Agoura Rd. near western City Limits
4	Conerstone	SEC Agoura Rd. and Cornell Rd.
5	Sunbelt Enterprises	29541 and 29555 Canwood St.
6	Royal Street Communications LLC	28001 Dorothy Dr.
7	Wildman Design, LLC/ Eric Rochin	28340 Roadside Dr.
8	Agoura-Kanan, LLC/ The Martin Group	4995 Kanan Rd. (Southwest corner of Kanan and Agoura Rd.)
9	Meridian Telecom, Inc. for Verizon Wireless	30401 Agoura Rd.
10	David Myers/Ware Malcomb for Venture Corporation	29508 Roadside Drive or 29505 Agoura Road based upon the project orientation
11	SureSite/ Omnipoint Communications for T-Mobile	5844 Larboard Lane
12	Vinod & Chanresh Gupta Trust	29760 Agoura Road
13	Ware/Malcomb for Agoura Business Center West., LLC/ William Poe	Northwest corner of Canwood & Derry
14	Moe Sherif for GU	29338 Roadside Drive
15	Agile Ventures, LLC	28870 Agoura Road
16	Agoura Medical Partners, LLC	N/W corner of Agoura Rd. and Chesebro Rd.
17	Agoura Landmark, LP	29621 Agoura Rd.
18	Sherlie Bermann (Architect, Sorin Done)	28900 Agoura Road (Lots 46 and 47)
19	Marvin Kanarek for Robert Adler	28222 Dorothy Dr. and 28131 Agoura Rd.
20	Whizin Market Square, LLC/ Tucker Investment Group, LLC	28888 thru 28914 Roadside Dr.
21	Kanan Road Oil, Inc. / Agoura Hills Black Gold, LLC Natanzi	5051 Kanan Road existing Chevron Station

City of Agoura Hills Development Summary
Table of Contents for Commercial Cases (September 2008)

No.	Applicant	Project Location
22	Apple Seven Hospitality Ownership, Inc. for Homewood Suites	28901 Canwood St.
APPROVED PROJECTS		
1P	Willy's Smokin BBQ/Marca Gauzurez	28434 Roadside Dr.
2P	Elias Ben Hazany	5226 Palo Comado Canyon Rd.
3P	Realty Bancorp Equities	29901 Agoura Rd.
4P	Scheu (Corp. Point)	S/S Agoura Rd. @Reyes Adobe Rd.
5P	Shirvanian Family Investment	Lots between 28700 and 28811 Canwood St
6P	Meridian for Verizon Wireless	28545 Driver Ave.
7P	Alesco Development	5030 Chesebro Rd.
8P	Agoura Detailing Center	100 Reyes Adobe
9P	Scheu Development Co. for Agoura Hills Corporate point, LLC	30200 and 30300 Agoura Road
10P	HQ Development for Agoura Hills Acquisition, LLC	29621 Agoura Rd.
11P	Wm.Paul Companies for Archstone Smith	29128 Oak Creek Lane
12P	GU	29338 Roadside Dr.
13P	Center Ct.Plaza/Silagi	29501 Canwood St.
14P	St Paul Lutheran Church	30600 Thousand Oaks Blvd.
15P	BBA Properties LLC for Michael Browers	28371 Agoura Rd.
16P	Signature Signs for Agoura Design Center	28501, 28505, 28509 Canwood St.
17P	Rabbi Bryski for the Chabad of the Conejo (Arch. Filiberto Gomez)	30345 and 30347 Canwood St.
18P	Luithly, Joseph	28818 Agoura Road
19P	Danari Oak Creek, LLC for Adler Realty Investments, Inc.	Five (5) commercial lots of Tr 53752 on the north side of Canwood St., east of Kanan Rd.
20P	27489 Agoura Road LLC (Previously known as Cardinal Liberty)	N/W corner of Liberty Cyn & Agoura Rd.

City of Agoura Hills Development Summary
Table of Contents for Commercial Cases (September 2008)

No.	Applicant	Project Location
21P	Whizin Market Square, LLC/ Tucker Investment Group, LLC	28888-28914 Roadside Dr.
22P	Vinod & Chanresh Gupta Trust	29760 Agoura Road

COMPLETED PROJECTS

1C	Coast Sign for Agoura Hills Investors (Gerald Collier)	5667 Kanan Raod
2C	Silagi "Canwood Plaza" (Bldg.C)	NW Corner Kanan Rd. & Canwood Street
3C	Adler Realty	Canwood St between Lewis and Derry Ave.
4C	Brian Norris for Chapter 8	29020 Agoura Road
5C	Joe Bednar	5506 Colodny Drive
6C	Daly Owens Group for Kanan Properties East LLC	5000 Kanan Road and 5050 Kanan Road
7C	Conejo Jewish Day School	29001 Ladyface Ct. (Temple Beth Havarim site)

**Commercial Cases
September 2008**

Proj. No.	Project Name	Case No.(s)	Project Location	Parcel Number	Site Size	Floor Area	Project Description	Case Planner
IN REVIEW								
1	Rose (Stuart Rose)	01-SPR-009	5216 Chesebro Rd.	2052-008-041 and 042	1.5 acres	N/A	Code Enforcement: Parking, screening and landscape improvements required.	D.H.
2	E.F. Moore & Co.	03-CUP-006	SEC of Agoura and Kanan	2061-031-020	18 acres	118 du, 91,800 retail, 10,000 office	Agoura Village Mixed Use Development	A.C.
3	Heathcote for Buckley	03-CUP-019	South of Agoura Rd., near western City Limits	2061-001-031	3 acres	14,075 sqft.	Commercial/Medical Building	V.D.
4	Conerstone	07-AVDP-002	SEC Agoura Rd. and Cornell Rd.	2061-029-008 thru 16 2061-030-001 thru 013	(243,172 sqft.) Multiple lot square footage	(26,000 sqft Retail 18,000 sqft. Office 41,000 sqft Residential) (estimated): 67,155 sq. ft. plus 35 residential units	Proposal for a 7 bldg., mixed-use development located on 8 acres of hillside property. 67,155 sq.ft. of retail/office use and 35 residential units. A Parcel Map will be required to merge lots or a Tract Map will be required to re-subdivide the property.	A.C.
5	Sunbelt Enterprises	05-CUP-005 05-OTP-032	29541 & 29555 Canwood St.	2053-001-008	3.23 ac	25,200 sq.ft.	2 identical 12,600 sq. ft. medical & general office bldgs.	V.D.
6	Royal Street Communications LLC	06-CUP-011	28001 Dorothy Dr.	2061-011-021			6 panel antennas, 1 GPS antenna, 1 microwave antenna, 4 equipment cabinets	V.D.
7	Wildman Design, LLC/ Eric Rochin	06-SPR-012 06-OTP-032 06-SP-059	28340 Roadside Dr.	2061-009-044	.079 ac.	21,590	Construction of new Commercial Building	V.D.
8	Agoura-Kanan, LLC/ The Martin Group	07-AVDP-001	4995 Kanan Rd. (Southwest corner of Kanan and Agoura Rd.)	2061-033-016	21.58 acres	107 residential units of (?) sq.ft. and a total of 167,000 sq. ft. of retail/commercial space.	First phase of development & parcelization of site includes 107 res.units over 62,000sq.ft. of retail space. (other phases to include 30,000 sq.ft. of retail and 75,000 sq.ft. of commercial space).	A.C.
9	Meridian Telecom, Inc. for Verizon Wireless	07-CUP-006	30401 Agoura Rd.	2061-002-047	N/A	N/A	Install rooftop wireless communications site consisting of 12 panel antennas(4 antennas per sector-3 sectors) Each antenna's size is 4'x1'x6" and 4 outdoor radio equip. cabinets. Entire facility to be screened to match existing.	V.D.
10	David Myers/Ware Malcomb for Venture Corporation	07-PAR-003	29508 Roadside Drive or 29505 Agoura Road based upon the project orientation	2061-004-030	5.71 acres	73,800 sq. ft.	A proposed commercial condominium development consisting of 38 individual properties which will range in size from 1,100 to 3,413 sq. ft.	V.D.
11	SureSite/ Omnipoint Communications for T-Mobile	07-CUP-007	5844 Larboard Lane	2056-015-900			Install six(6) antennas flush mounted in a new 50 ft. high monopole. The installation includes six(6) equipment cabinets adjacent to the monopole, surrounded by a masonry equipment enclosure on the Lindero Cyn. Middle School site.	R.M.
12	Vinod & Chanresh Gupta Trust	07-CUP-009 07-OTP-012 formerly (07-PSR 001)	29760 Agoura Road	2061-033-015	1.65 ac.	12,700 sq.ft.	2-story 12,700sf office building; formerly a Pre-Screen Review to allow a 15,000 sf building instead of 8,000sf as limited by Ladyface Mt SP	V.D.
13	Ware/Malcomb for Agoura Business Center West, LLC / William Poe	07-CUP-010 07-GPA-001 07-ZC-001 PM 69426	Northwest corner of Canwood & Derry	2048-012-022 and 2048-012-027	The entire Lot 2 of Tr.33249 is 8.82 buildable area; however, with the new Parcel Map, the project site is proposed to be 1.93 ac.	21,782 sq. ft.	A GPA and ZC app.to change project site from Bus.Manufacturing to Commercial Retail and a CUP app.to construct 3 retail buildings totalling 21,782 sq.ft.	V.D.
14	Moe Sherif for GU	07-SPR-012 07-VAR-003 07-SP-024	29338 Roadside Drive	2061-004-025	.62 acres	2,612 sq. ft.	Proposal to eliminate self-service washing stalls & tunnel; maintain two tube bays & add new retail area & office. A Variance is requested to reduce the rear yard setbacks. A Sign Program approval is also requested.	V.D.

**Commercial Cases
September 2008**

Proj. No.	Project Name	Case No.(s)	Project Location	Parcel Number	Site Size	Floor Area	Project Description	Case Planner
15	Agile Ventures, LLC	07-AVDP-003	28870 Agoura Road	2061-029-003 and 2061-029-004	Approx. 48,709 sq. ft.	17,249sq. ft.	Construct a two-story office condo (17 units) (Tr.Map required) on two-lots (PM required to combine lots for project.)	A.C.
16	Agoura Medical Partners, LLC	07-SPR-015 PM 70096 07-GPA-002 07-ZOA-002	Northwest corner of Agoura Rd. and Chesebro Rd.	2061-012-012; 014; 015; 018; 047;048;049	Per application, 79,194 sq. ft.	40,733 sq. ft.	Medical office building	V.D.
17	Agoura Landmark, LP	VTTTr Map 70707;08-SPR-011;08-OTP-021;08-SP-036;related case 07-PAR-006	29621 Agoura Rd.	2061-003-027	5.17 ac. minus .52 ac. for S.D. easement and .35 ac. for F.H. area. Buildable acres: 4.30 ac.	99,194 sq. ft.	Divide property into 6 lots for 5 bldgs. and 1 common lot w/parking structure(1 level underground) Bldg.A 2 flrs,14,536 sq. ft.Bldg.B 3 flrs, 25,418 sq. ft.Bldg.C 2 flrs, 8,306 sq. ft.Bldg.D 3 flrs, 25,484 sq. ft.Bldg.E 2 flrs, 25,450 sq.ft. OTP to reconstruct wall around oak and correct drainage pattern, no project encroachment	V.D.
18	Sherlie Bermann (Architect, Sorin Done)	07-AVDP-004	28900 Agoura Road (Lots 46 and 47)	2061-029-005 and 2061-029-006	Per application, the lot is 0.9 plus or minus acres	24,220 sq. ft.	A mixed occupancy, commercial bldg./ banquet hall/ office and one residential unit; outdoor wedding terrace and wine cellar are proposed.	A.C.
19	Marvin Kanarek for Robert Adler	08-SPR-010	28222 Dorothy Dr. and 28131 Agoura Rd.	2061-012-020 and 2061-012-042	approx. 26,302 sq. ft.	13,426 sq. ft.	Construct a 13,426 sq. ft. video production facility with indoor parking on two contiguous lots in two commercial zones. 28222 Dorothy Dr. is in CRS-OA-FC zone. 28131 Agoura Rd. is in BP-OR-OA-FC zone.	R.M.
20	Whizin Market Square, LLC/ Tucker Investment Group, LLC	08-AVDP-001	28888-28914 Roadside Dr.	2061-007-041, 051, 052, 054, 055	389,890 sq. ft.	100,000 sq.ft. existing floor area, 14,850 sq.ft. of new fir.area and 5,800 sq.ft. of new outdoor dining areas.	Conceptual commercial mixed-use project, includes approx.100,000sq.ft.of existing fir.area, 14,850 sq.ft.of new retail & restaurant fir.area, add 88 new parking spaces to existing 515 parking spaces & demolish baseball batting cages. Project to reconfigure open/parking areas to provide 5,800 sq.ft. of outdoor dining, public seating, play areas, open space for outdoor entertainment & community gathering uses.	D.H.
21	Kanan Road Oil, Inc. / Agoura Hills Black Gold, LLC / Natanzi, Parviz (David)	08-CUP-006	5051 Kanan Road existing Chevron Station	2061-004-040	22.510 sq.ft.	2,672	Demo existing food kiosk, bathroom/storage building & construct new 2,672 sq.ft.building with 702 sq. feet of office and 1,970 sq.feet of retail/mini mart. Multiple tree and landscape removal. New landscape plan proposed. Additional fuel dispenser proposed.	R.M.
22	Apple Seven Hospitality Ownership, Inc. for Homewood Suites	03-CUP-018 Amendment	28901 Canwood St.	2048-011-062			Amend CUP approval to allow 35 rms to be occupied 31-180 days each by same individual and 5 rms to be occupied 365 days each by same individual.	D.H.
APPROVED PROJECTS								
1P	Willy's Smokin BBQ/Marca Gauzurez	05-SPR-029	28434 Roadside Dr.	2061-008-048		273 sq.ft.	Add 273 sq. ft. of office space and kitchen storage	R.M.
2P	Elias Ben Hazany	07-CUP-001	5226 Palo Comado Canyon Rd.	2052-008-030	0.45 ac.	1,454.7 sq. ft.	Remodel existing gas station building and remove the service-bay facilities in order to convert entire building to a Food Mart.	R.M.
3P	Realty Bancorp Equities	01-SPR-011 02-VAR-007 02-CUP-008	29901 Agoura Rd.	2061-003-023	6.98 acres	76,750 sqft.	Two-story commercial building	D.H.
4P	Scheu (Corp. Point)	98-CUP-012 & 98-LLA-003	S/S Agoura Rd. @Reyes Adobe Rd.	2061-002-022	87 acres	81,000 sqft.	2 new buildings	D.H.
5P	Shirvanian Family Investment	06-CUP-003 06-OTP-005 PM 65503	Lots between 28700 and 28811 Canwood Street	2048-012-026	10.02 acres	103,000 sq.ft.	Industrial park with 7 buildings	D.H.

**Commercial Cases
September 2008**

Proj. No.	Project Name	Case No.(s)	Project Location	Parcel Number	Site Size	Floor Area	Project Description	Case Planner
6P	Meridian for Verizon Wireless	04-CUP-005	28545 Driver Ave.	2048-008-901	N/A	N/A	Wireless telecommunications antenna & equipment bldg.	V.D
7P	Alesco Development	02-CUP-004 02-LLA-001 03- OTP-015 03- VAR-007	5030 Chesebro Rd.	2061-013-011; - 031; -041; -042; 043; -044; -045; 028.	4.13 acres	8 Office Buildings: 63,208 sqft.	New office buildings	D.H.
8P	Agoura Detailing Center	03-CUP-014	100 Reyes Adobe	2053-026-078	44,330 sqft.	10,333 sqft.	Auto detailing center with offices	D.H.
9P	Scheu Development Co. for Agoura Hills Corporate point, LLC	98-CUP-012 98- OTP-010 Amendment	30200 and 30300 Agoura Road	2061-002-022	26 acres	71,844	Amendment to approved application to extend the approval beyond the allowed extension already granted for two com.office buildings on 5.23 ac. The balance of the site to be deed restricted to prevent development.	D.H.
10P	HQ Development for Agoura Hills Acquisition, LLC	05-SPR-010 05- OTP-010 05-SP- 006	29621 Agoura Rd.	2061-003-027	5.17 ac.	95,215 sq.ft.	2-story commercial office bldg.	V.D.
11P	Wm.Paul Companies for Archstone Smith	05-SP-059 05- VAR-008	29128 Oak Creek Lane	2048-011- 045,046,047,04 8,057			Replace 2 monument signs (Var. is for more than 1 sign)	V.D.
12P	GU	05-VAR-007	29338 Roadside Dr.	2061-004-025 and 026	24,090 sqft.	N/A	Lot line Adjustment for two commercial parcels.	V.D.
13P	Center Ct.Plaza/Silagi	04-CUP-010 Tr. 62211	29501 Canwood St.	2053-001-006	3.24 ac.	49,350 sq.ft.	1 Two-story office building	D.H.
14P	St Paul Lutheran Church	04-CUP-009	30600 Thousand Oaks Blvd.	2054-017-016	1,9 acres	960 sqft.	Modular building	V.D.
15P	BBA Properties LLC for Michael Browers	06-SPR-006 Reference Cases: 02-SPR- 016, 02-OTP- 011 TE#1 TE#2; 06-SPR- 006 and 06-OTP 024 Amendment (Reference Case No. PM 27094); reinstatement	28371 Agoura Rd.	2061-009-041; 042; 045; 047; 049	Approx. 30,000 sq.ft.	9,400 sq.ft.	TE for case # 02-SPR-016: a new 9,400 sq.ft. office building + parking	V.D.
16P	Signature Signs for Agoura Design Center	08-SP-024 (related cases: 06-SP-044 and 04-CUP-007	28501, 28505, 28509 Canwood St.	2048-012-017 & 018			Per Planning Commission request: A monument sign program for the Design Center	R.M.
17P	Rabbi Bryski for the Chabad of the Conejo (Arch. Filliberto Gomez)	06-CUP-006 06- VAR-002	30345 and 30347 Canwood St.	2054-020-038 and 2054-020- 039	Existing bldg.lot is 9,970 sq.ft. Proposed bldg. lot is 15,390 sq.ft.	6,999 sq. ft.	Remodel existing Chabad Center bldg. and construct a 6,999 sq.ft. bldg. on rear lot for offices and class rooms.	V.D.
18P	Luthly, Joseph	07-CUP-008 07- OTP-005	28818 Agoura Road	2061-029-002		1,062 sq. ft.	Convert existing non-conforming S.F. D.U in BP-OR Zone to Com. Bldg. and add a 113 sq.ft. 1st floor addition; a 729 sq. ft. 2nd floor addition and a new 220 sq. ft. covered patio; convert existing lattice patio cover to solid roof and convert the 684 sq.ft. garage to work area.	V.D.
19P	Danari Oak Creek, LLC for Adler Realty Investments, Inc.	06-CUP-007 06- OTP-016 06-SP- 037	Five (5) commercial lots of Tr 53752 on the north side of Canwood St., east of Kanan Rd.	2048-011-049; 2048-011-050; 2048-011-051; 2048-011-052; 2048-011-053; 2048-011-061;	Lot 3 has 1.2 ac. and an additional section of 16,450 sq. ft.; Lot 4 has 38,897 sq. ft.; Lot 5 has 43,470 sq. ft.; Lot 6 has 1.26 ac.; Lot 7 has 35,419 sf	Building A:7,360 sq. ft. Building B-1: 6,000 sq. ft. Building B-2: 6,800 sq. ft. Building C-1: 7,500 sq. ft. Building C- 2: 7,000 sq. ft.	Construct 5 buildings, totaling 34,660 sq. ft: 2 retail buildings of 6,000 sq.ft.and 7,000 sq.ft., with a 1,420 sq.ft.portion for multi-use; and 3 restaurant buildings of 5,940 sq.ft., 6,800 sq.ft. and 7,500 sq. ft. And implement a sign program.	D.H.

**Commercial Cases
September 2008**

Proj. No.	Project Name	Case No.(s)	Project Location	Parcel Number	Site Size	Floor Area	Project Description	Case Planner
20P	27489 Agoura Road LLC (Previously known as Cardinal Liberty)	06-SPR-009 PM 67397 (06-PAR-003 /99-SPR-015)	N/W corner of Liberty Cyn & Agoura Rd.	2064-006-006,007,009, 016,018,019	5 empty lots and one developed lot for a site total of approx. 4.18 acres	30,000 sq. ft. (existing bldg. on site is 24,450 sq. ft.)	2 bldgs. One single-story, 10,000 sq. ft. and one two-story, 20,400 sq. ft. + Parcel Map to combine the 6 lots.	V.D.
21P	Whizin Market Square, LLC/ Tucker Investment Group, LLC	08-SPR-009	28888-28914 Roadside Dr.	2061-007-041, 051, 052, 054, 055	4.80 ac	Renovate existing 3,500 sq. ft. plus 300 sq.ft. plus 600 sq.ft. renovation and expansion	Renovate existing 3,500 sf restaurant, enclose and expand existing 300 sq.ft. exterior patio to create 600 sf of in/outdoor dining patio renovate/reconfigure and enhance the existing interior Atrium courtyard and creat 200 sq.ft. landing area for food service.	D.H.
22P	Vinod & Chanresh Gupta Trust	07-PSR-001 (Ref. Cases: 07-CUP-009 07-OTP-012)	29760 Agoura Road	2061-033-015	1.65 acre	15,000 sq. ft.	A Pre-Screen Review application to have the Council consider a Specific Plan Amendment to allow a 15,000 sq.ft. building instead of an 8,000 sq. ft. bldg., which is required by the Ladyface Mtn. Specific Plan.	D.H.
COMPLETED PROJECTS								
1C	Coast Sign for Agoura Hills Investors (Gerald Collier)	07-SP-017	5667 Kanan Raod	2053-007-025			New Sign Program for Bank of America	B.T.
2C	Silagi "Canwood Plaza" Bldg. C	00-CUP-010 Amendment	NW Corner Kanan Rd. & Canwood Street	2053-001-804	2.03 acres	22,896 sqft.	Office Building	D.H.
3C	Adler Realty	04-CUP-007 04-OTP-020 04-LLA-011 PM 62245	Canwood St between Lewis and Derry Ave.	2055-003-064 ; 2048-012-017 and -018	292,065 sqft.	120,230 sqft.	Furniture/Home Decorating Center	D.H.
4C	Brian Norris for Chaper 8	05-CUP-001 Amendment	29020 Agoura Road	2061-031-023 and 024	N/A	N/A	Amend CUP to add 3-piece band 5 p.m. to 10 p.m. Tues. through Friday nights	V.D.
5C	Joe Bednar	98-CUP-001 Amendment	5506 Colodny Drive	2055-009-027			Amend approved CUP to allow 28 rooms to be converted to "special care" in the existing retirement facility.	R.M.
6C	Daly Owens Group for Kanan Properties East LLC	07-LLA-004	5000 Kanan Road and 5050 Kanan Road	2061-006-045 and 2061-006-046	30,000 sq. ft.	Proposed increase in lot square footage to 40,00 sq. ft.	A Lot Line Adjustment to move the existing lot line northerly to include the existing car wash with the existing gas station to comply with the lease agreement.	Ramiro Adeva & S.S.
7C	Conejo Jewish Day School	06-CUP-010 06-SPA-002	29001 Ladyface Ct. (Temple Beth Havarim site)	2061-005-031			A Specific Plan Amendment and a Cond.Use Permit to allow a school to operate on the existing Temple site.	J.R.

Projects in Review
September 2008

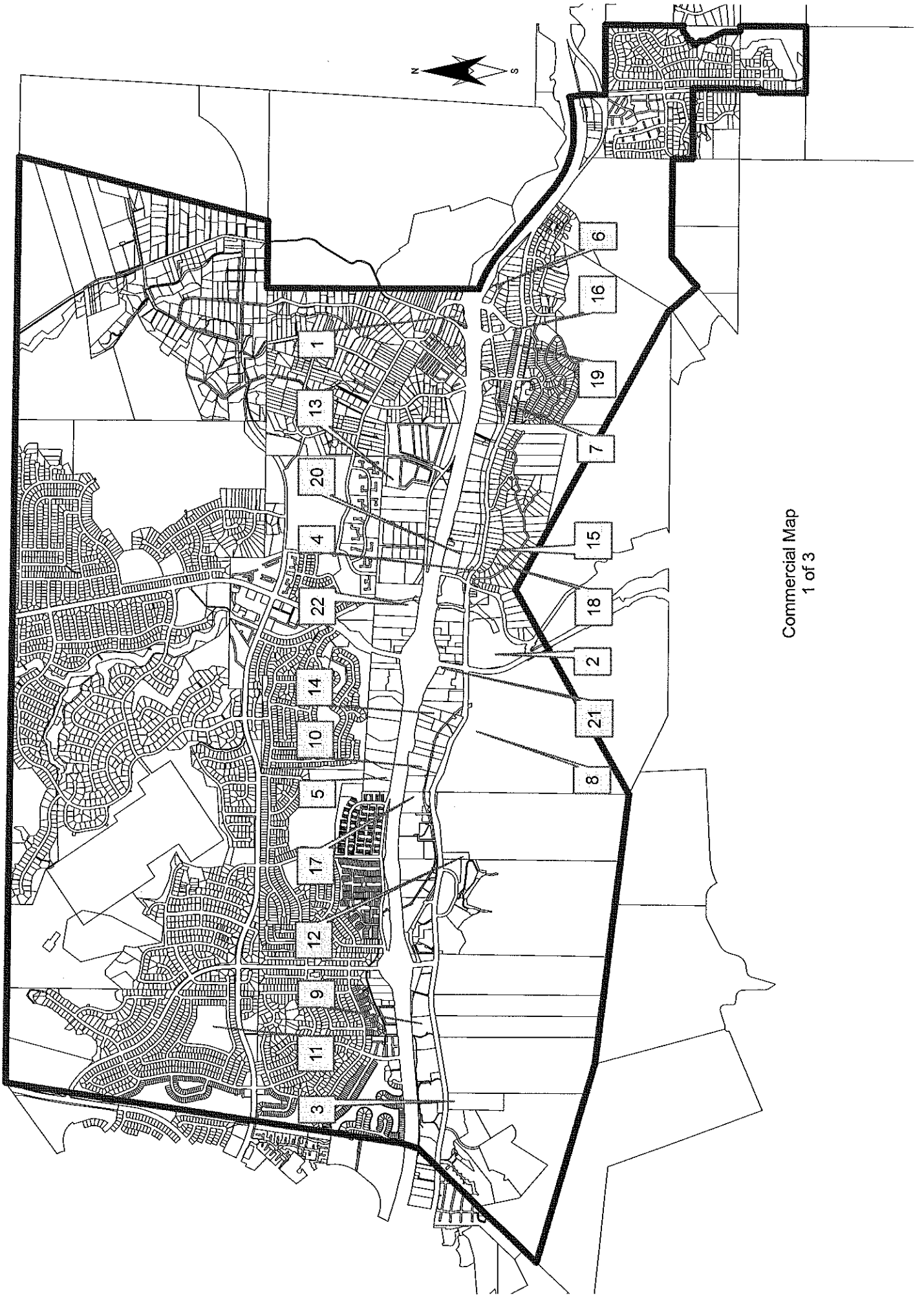

Approved Projects
September 2008

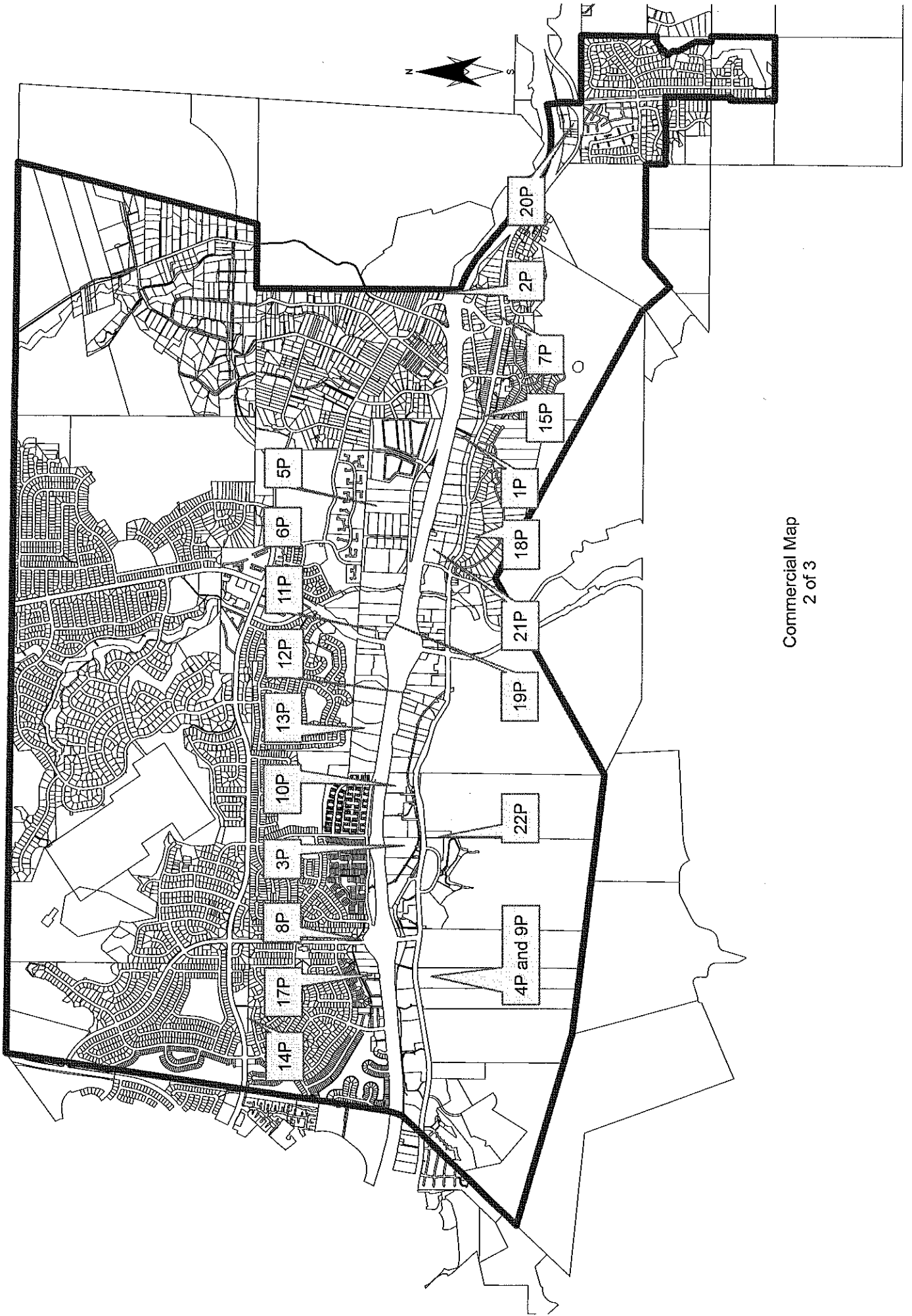

Completed Projects
September 2008

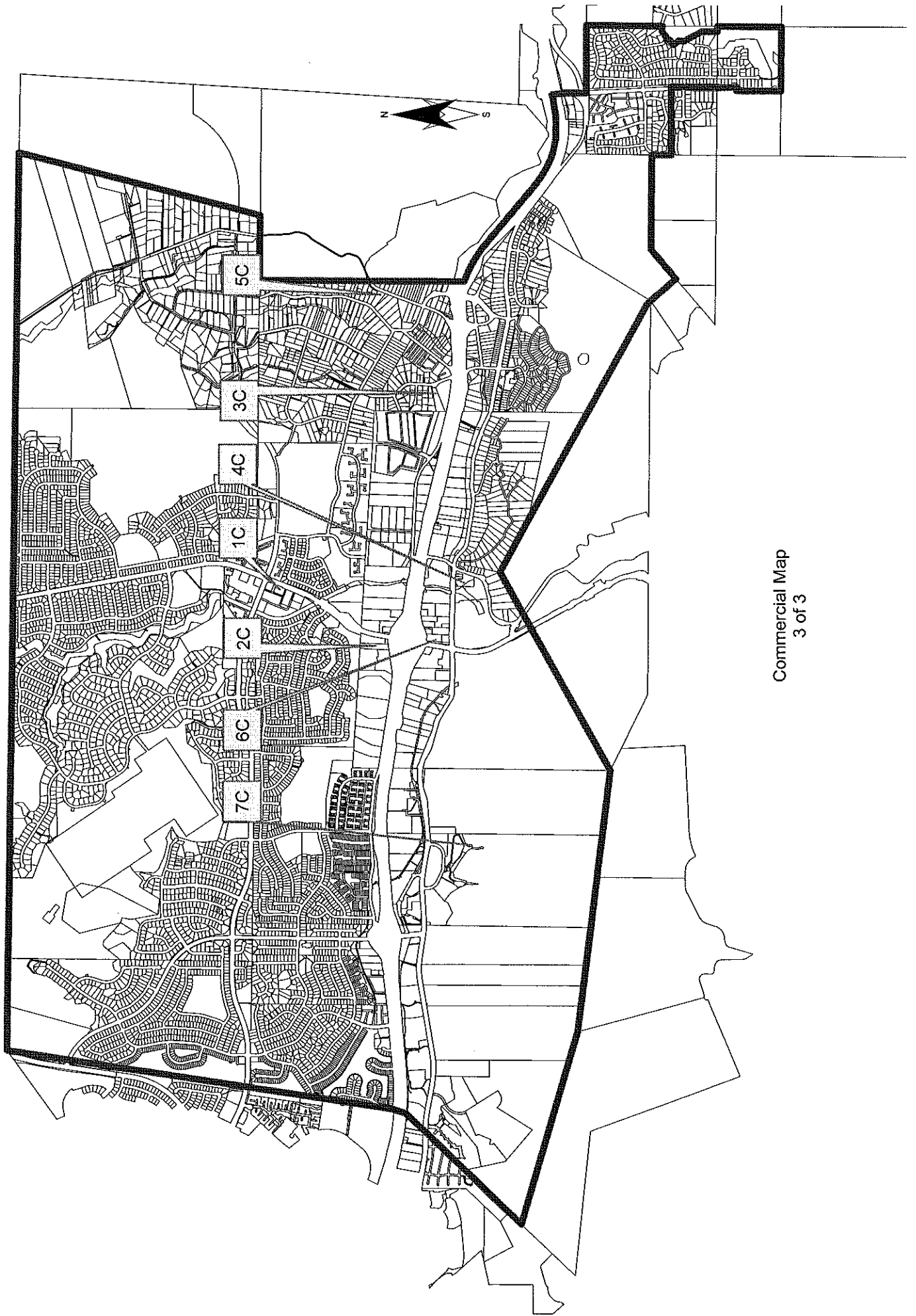

City of Agoura Hills Development Summary
Table of Contents for Residential Cases (September 2008)

No.	Applicant	Project Location
IN REVIEW		
1	Profitable Sales Strategies/Terry Ahern	28401 Renee Dr.
2	Scheff	28314 Foothill Dr.
3	Stockton/lamburg (Ben Menahem)	6149 Palo Comado Canyon Rd.
4	Lampert, Greg	5911 Fairview Pl.
5	Holmes for Morse	5810 Colodny Dr.
6	Siboni	5446 Lewis Rd.
7	Steve Potter for John Manos	2 parcels on the west side of Foothill, east of Easterly, south of Fountain Pl.
8	Asa Arava	28443 Foothill Drive
9	Abudalu, Joseph (Architect: Studio by Design)	28303 Laura La Plante Drive
10	Ginsburg, Moty and Margo	5643 Colodny Dr.
11	Janice Atkins	28506 Driver Ave.
12	Reza Nasr for Gerald Silver	5747 Fairview Pl.
13	Torres for Chris Haarhoff	6033 Colodny Drvie
14	Thomas Brewer and Ana Cullen	4833 Canyon Way
15	Carlos Khantzis and Steve Rice	30800 Agoura Road
16	Cook, Joseph & Jill	5940 Chesebro Rd.
17	Bailey for Tamara Friend	6350 Chesebro Road
18	M. Kamal & Associates, LLC for Henry M. Halimi	28700 Thousand Oaks Blvd. (Park zoned lot east of Carell, north side of Thousand Oaks Blvd.)
APPROVED PROJECTS		
1P	Riopharm USA Inc.	27650 Agoura Rd.
2P	Ron Waters	28031 and 28031 Balkins Dr.
3P	Jon Shuken	6491 Chesebro Rd. (Lot 3 of Tr. 52396)
4P	Dawson for Sharon	28243 Balkins Dr.
5P	Benton (former Swift Construction for Coglin)	Lot 18 on Laura La Plante Dr.
6P	Adivi formerly Levy	6029 Fairview Dr.

City of Agoura Hills Development Summary
Table of Contents for Residential Cases (September 2008)

No.	Applicant	Project Location
7P	Moshe and Matty Bryski	5662 Middlecrest Dr.
8P	Hedva Ergas	5490 Fairview Pl.
9P	Von Buck	27801 Blythedale Rd.
10P	Roser	28537 Fountain Pl.
11P	Kolve, Patrick	28250 Driver Ave.
12P	Feehan, Tim	5472 Fairview Pl.
13P	Raymond	5344 Lewis Rd.
14P	Sharon, Rafi and Orit	28220 Foothill Dr.
15P	Agoura TNT LLC/Terry Gray	5936 Fairview Place
16P	Schwartzberg for Datner	6137 Braemar Ct.
17P	Bardai, Nevin (Gary Bardovi, Architect/LCE Group, Inc.)	Balkins Drive
18P	Schaub for Leggett	5939 Colodny Dr.
19P	Vasquez for Atkins	28506 Driver Ave.
20P	Chuck Francoeur for 'Montage Dev.'	5310 Colodny Dr.
21P	Foster	5545 Foothill Dr.
22P	Payan	28254 Laura La Plante Dr.
23P	Blinkinsoph for Thompson	Lewis Pl.
24P	Sears & Chase	30020 and 30014 Trail Creek Drive & HOA Common Area
25P	Linda Medvene	5857 Fairview Pl.
26P	Yvanova for Laura La Plante LLC	28221 Laura LaPlante Dr.
27P	DNA Construction for Albaum, David	5866 Fairview Place
28P	ARC Design/Ewing	28080 Balkins Dr.
29P	Millett, Mike and Darin	5446 Fairview Place
30P	Leininger, Bart & Laura	6162 Lake Lindero Dr.
31P	Sitin for Daniel Bouganim	5519 Lewis Lane
32P	Mahterian for Turley	6144 3/4 Chesebro Rd.
33P	Elbaum, Lisa and Steve. (Bagwell Construction)	29100 Quail Run Drive

City of Agoura Hills Development Summary
Table of Contents for Residential Cases (September 2008)

No.	Applicant	Project Location
34P	Steve and Marguerite Edwards	5952 Lapworth Dr. N.E. corner of Lapworth and Balkins
35P	Neil Pennywitt for Ron and Trish Burr	6129 Chesebro Road
36P	Alfonso Stanley Sosa	6317 Langhall Ct.
37P	Carroll, Gerald	5730 Fairview Place
38P	Dembsky for Almany	3945 United Rd.
39P	McCann for Anav	5533 Fairview Pl.
40P	Pendlebury for Barnett	6044 Chesebro Rd.
41P	CJF Development Consultants for "Montage"	5310 Colodny Dr.
42P	Zev Beckerman (Sasson Bezalel for Zev)	27862 Blythdale Rd.
43P	Robin, Louis & Lisa	5779 Willowtree Dr.
44P	Weireter, Philip & Sheryl (David Raider, Architect)	30645 Janlor Drive
45P	Vladimir Zlatkov	28331 Laura LaPlante Dr.
46P	Agoura TNT LLC/Terry Gray	6170 Fairview Pl.
47P	David Rocca	6044 Lake Nadine Pl
48P	Bagwell Construction for Joel Rizor	5709 Fairview Pl
49P	Charles Blaugrund for Mr. & Mrs. Joey Butson	5619 Slicers Circle
50P	Ashnoor Pirouti	28454 Renee Dr.
51P	Ashnoor Pirouti	28458 Renee Dr.
52P	M. Fredric & Co. (Fred and Lisa Levine)	6475 Chesebro Road
53P	Monte Vende Development	So. side of Agoura Rd, east of Cornell Rd.
54P	Jager Associates for Michael Palache	Balkins Drive, 3 lots west of Lapworth, behind 2055-021-044
55P	Araujo, Ruben and Debra / Brent Schneider, Architect	6021 Colodny Drive
COMPLETED PROJECTS		
1C	Gniadek/ Bullmer for Rasmussen	28611 Bamfield Ct.
2C	Mineo	Lot 3 on Canyon Wy.

City of Agoura Hills Development Summary
Table of Contents for Residential Cases (September 2008)

No.	Applicant	Project Location
3C	Bailey for Tamara Friend	6350 Chesebro Road
4C	Stockton for Sisso	5415 Lewis Rd. (So.of Driver Ave.)
5C	Roit, Leo	28161 Laura LaPlante
6C	Larry Pollock	5734 Fairview Pl.
7C	Biddison, M	28359 Driver Ave.
8C	Cooper for Stitt	28037 Balkins Dr.
9C	John/Linda Quinn	5703 Willowtree Dr.
10C	Jacob	North of 5847 Colodny Dr.
11C	Mahterian for Mogan	28250 Laura LaPlante Dr.
12C	Christopher Haarhoff (Jonathan Azal and B A Construction)	6033 Colodny Drvie
13C	Rhombold	5241 Colodny Dr.
14C	Stockton	5310 Colodny Dr.
15C	Ryan	29029 Acanthus Ct.
16C	Diamond	5833 Lapworth Dr.
17C	Golenberg	5927 Colodny Dr.
18C	Swenson and Nadel	28354 Balkins Dr.
19C	Mandler	5445 Meadow Vista
20C	Dawson for Sharon	28314 Foothill Dr.
21C	Scott Berg for Kearns	5740 Colodny Dr.
22C	Frank LaRosa and Emily Prano	5348 Chesebro Rd.
23C	N.E. Designs for Bar family	28466 Foothill Dr.
24C	Leo Feierelsen for Garner	29004 Indian Ridge Ct.

**Residential Cases
September 2008**

Proj. No.	Project Name	Case No.(s)	Project Location	Parcel Number	Site Size	Floor Area	Project Description	Case Planner
IN REVIEW								
1	Profitable Sales Strategies/Terry Ahern	01-CUP-018 01-VAR-015; 07-LLA-002	28401 Renee Dr.	2061-018-026, 027	12,678 sqft.	2,669 sqft.	2,669 sqft. addition to an existing 2,583 sqft. house	V.D. and Ramiro Adeva
2	Scheff	03-SPR-006	28314 Foothill Dr.	2055-016-033	22,433 sqft.	2,498 sqft.	Room addition to an existing single-family residence	V.D.
3	Stockton/lamburg (Ben Menahem)	03-CUP-016 03-OTP-017	6149 Palo Comado Canyon Rd.	2055-023-073	40,080 sqft.	4,688 sqft.	A two-story custom house with three car garage	V.D.
4	Lampert, Greg	04-LLA-013 To be upgraded to a Parcel Map	5911 Fairview Pl.	2055-025-060 through 064	N/A	N/A	combine 5 lots	S.S.
5	Holmes for Morse	05-SPR-022 and 05-OTP-029	5810 Colodny Dr.	2055-023-046	2.5 ac.	Square footage was not indicated for all the new structures to be added to the site.	New barn, garage, horse shelters, horse pen, corrals, arena, retaining walls.	V.D.
6	Siboni	05-SPR-028	5446 Lewis Rd.	2055-005-070	27,440 sqft.	6,335 sqft.	A 4,995 sqft. Single-family detached residence with 852 sqft. garage and a 488 sqft. pool house.	R.M.
7	Steve Potter for John Manos	PM65552	2 parcels on the west side of Foothill, east of Easterly, south of Fountain Pl.	2055-018-022 and 2055-018-023	one lot is 27,880 sq.ft. and one lot is 1.97 ac.	one lot proposed to be 48,295 sq. ft., one lot proposed to be 24,890 sq.ft. and one lot proposed to be 21,815sf	A Parcel Map to create 3 lots from 2 hillside lots. Parcel 3 has 2 D.U.and 2 accessory bldgs. One D.U. is to be removed. The one to remain is only 2 to 3 feet from the south property line.	RM
8	Asa Arava	06-CUP-018 and 06-OTP-025	28443 Foothill Drive	2055-019-036	1 acre	4,266 sq. ft.	Three (3) story, 35 ft. high, single-family residence on a hillside lot.	R.M.
9	Abudalu, Joseph (Architect: Studio by Design)	06-CUP-019	28303 Laura La Plante Drive	2061-022-051	23,090 sq. ft.	3,630 sq. ft.	Construct 3,230 sq. ft., 2-story S.F.D. with a 400 sq. ft. attached garage.	R.M.
10	Ginsburg, Moty and Margo	07-INT-001 07-CUP-005 and 07-OTP-003	5643 Colodny Dr.	2055-012-051	18,840 sq. ft. minus 5,130 sq.ft. of flood hazard area, leaving 13,710 sq.ft. of buildable area	6,752 sq.ft.	Interpretation by P.C. Does a 1,790 sq.ft. basement count as a floor and add to height of building. Build a 6,752 sq.ft. single-family house. (1st flr.2,929 sq.ft.; 2nd flr. 2,034 sq.ft.; basement 1,790 sq.ft.	R.M.
11	Janice Atkins	07-LLA-005	28506 Driver Ave.	2055-004-009 and 2055-004-038	1.44 ac. And 22,650 sq. ft.	21,781 sq. ft. and 63,715 sq. ft.	A Lot Line Adjustment app. To change the line between the two hillside lots	Ramiro Adeva
12	Reza Nasr for Gerald Silver	08-CUP-004 (There is a related case: 03-LLA-003)	5747 Fairview Pl.	2055-020-054	1.31 ac	4,747 sq. ft.	Add 2,412 sq.ft. to (ex) 2,011 sq.ft. D.U., enclose existing 943sf atrium, convert to living & dining area. Add new 742sf lower floor living area and add 1,593 sf, 8-car garage. Note: This property has an approved(court ordered) Lot Line Adjustment 03-LLA-003 that has not yet been legally recorded to date.	R.M.
13	Torres for Chris Haarhoff	08-SPR-007 Related case is 08-SPR-002	6033 Colodny Drvie	2055-028-035	40,950 sq. ft.	2,058 sq. ft.	Addition of 2,058 sq. ft. to existing 2,603 sq. ft. residence with a 418 sq. ft. garage.	B.T.
14	Thomas Brewer and Ana Cullen	08-CUP-005 and 08-LLA-001; (07-PAR-005 preapplication review approved)	4833 Canyon Way	2061-018-061 2061-018-062	Parcel 61 (lot 13)is 8,460 sq.ft. Parcel 62(lot 14) is 7,900 sq.ft.	6,533 sq.ft.	New single-family D.U. with a 2,140 first floor, a 1,767 second floor and a 2,726 sq. ft. garage. A Lot Line Adjustment application to combine 2 lots	R.M.

**Residential Cases
September 2008**

Proj. No.	Project Name	Case No.(s)	Project Location	Parcel Number	Site Size	Floor Area	Project Description	Case Planner
15	Carlos Khantzis and Steve Rice	08-CUP-001; 08-SPA-001; 08-VAR-002; 08-OTP-004	30800 Agoura Road	2061-001-025	7.1 acres (buildable acres are 6.31)	104,138 sq. ft.	46 res. Condo units in 2 two-story, 34 ft. high buildings, including 6 affordable units; 2,786 sq.ft. of common area (multi-purpose rooms, offices) A separate 3,004 sq. ft. senior recreation center building; 129 parking spaces; A Specific Plan Amend. to permit residential use; A Variance to reduce front, side & rear set-backs and to increase retaining wall heights. Tent. Tr. Map & Oak Tree Permit	D.H.
16	Cook, Joseph & Jill	08-SPR-005	5940 Chesebro Rd.	2055-026-039	43,560 sq. ft. lot minus 190 sq. ft. for street = 43,370 sq. ft. buildable area	1,374 sq. ft.	Single-story room addition of 1,374 sq. ft. to existing 1,550 single-story house w/666 sq. ft. garage. A new porch, outdoor fireplace and gazebo will be added.	B.T.
17	Bailey for Tamara Friend	08-CUP-003 (related cases: 07-OTP-009 and 07-SPR-007)	6350 Chesebro Road	2055-001-041	Approx. 3 ac.	Square footage was not indicated for all the new structures to be added to the site.	Demo existing concrete driveway, construct new access, barn structure w/12 stalls, tackroom, storage and office in the SEA area. A 5 ft. wooden fence around a new riding arena.	B.T.
18	M. Karnal & Associates, LLC for Henry M. Halimi	08-CUP-002; 08-ZC-001; 08-GPA-001; PM 69698 (former pre-application, 06-PAR-002)	28700 Thousand Oaks Blvd. (Park zoned lot east of Carell, north side of Thousand Oaks Blvd.)	2048-003-002	8.06 acres minus 0.26 acre future street, minus 7.80 acres of slope easement.	6,850 sq. ft.	A Parcel Map to subdivide one lot into two lots to construct a 6,850 sq. ft. D. U. on a hillside, donate one lot for park purposes, change the zone, amend the Gen. Plan.	R.M.

APPROVED PROJECTS

1P	Riopharm USA Inc.	03-CUP-010 03-VAR-005 TR 48901 (Formerly: TT48901, 90-CUP-010, 98-CUP-007)	27650 Agoura Rd.	2061-014-007 through 015 & 2061-014-18 through 20 & 2061-014-23 through 26	10.58 acres	Three models from 2,777 to 3,235 sqft.	Renew CUP for 13 Single-family residences	D.H.
2P	Ron Waters	03-CUP-002 03-OTP-002 07-LLA-003	28031 and 28031 Balkins Dr.	2055-023-065 and 2055-023-062	1.59 acres or 69,260 sqft. (LLA refers to 1.50 and 1.37 NET ac.)	5,096 sqft. W/ 790 sqft. Garage	Custom house and Lot Line Adjustment on hillside lots.	V.D. and Ramiro Adeva for LLA
3P	Jon Shuken	07-CUP-012 and 07-OTP-025 (prior related case: 07-PAR-001)	6491 Chesebro Rd. (Lot 3 of Tr. 52396)	2055-029-003	1.46 ac.	8,196 sq.ft.	Construct a 2-story, single-family residence with a 5 car garage. Living area is 5,109 sq. ft.; garage area is 1,437 sq. ft.; porches are 1,650 sq. ft.	V.D.
4P	Dawson for Sharon	06-CUP-001	28243 Balkins Dr.	2055-022-080	1.13 acres	5,678 sqft.	A 4,968 sqft. Single-family detached residence with 710 sqft. garage with pool and spa.	R.M.
5P	Benton (former Swift Construction for Coglin)	03-CUP-001 03-VAR-001	Lot 18 on Laura La Plante Dr.	2061-016-054	.271 acres or 11,801.76	3000 sqft.	Custom House on hillside lot	V.D.
6P	Adivi formerly Levy	03-CUP-003	6029 Fairview Dr.	2055-022-047	2.56 acres	6,917 sqft.	Custom house on hillside lot	(D.H.) R.M.
7P	Moshe and Matty Bryski	07-DCP-001	5662 Middlecrest Dr.	2056-027-002			Application for a large family Day Care Permit	R.M.
8P	Hedva Ergas	07-SPR-004	5490 Fairview Pl.	2055-014-027	45,005 sq.ft.	799 sq. ft.	Add a 342 sq.ft. family rm. And a 457 sq. ft. office and gym to existing 1,702 sq.ft. D.U. w/ 499 sq.ft. garage.	B.T.
9P	Von Buck	03-CUP-017 03-OTP-016	27801 Blythedale Rd.	2055-001-035	4.27 acres	4,274 sqft with 1,272 sqft. Garage	A two-story custom house with three car garage	V.D.
10P	Roser	03-CUP-020	28537 Fountain Pl.	2055-019-025	5.25 acres	4,736 sqft.	A two-story custom house	R.M.

**Residential Cases
September 2008**

Proj. No.	Project Name	Case No.(s)	Project Location	Parcel Number	Site Size	Floor Area	Project Description	Case Planner
11P	Kolve, Patrick	08-SPR-008	28250 Driver Ave.	2055-005-040	21,700 sq. ft.	360 sq. ft.	Add a 360 sq. ft. bedroom, bath and closet to existing dwelling unit	B.T.
12P	Feehan, Tim	04-SPR-004	5472 Fairview Pl.	2055-014-028	21000 sqft.	700 sq. ft.	second story rm addition	R.M.
13P	Raymond	04-SPR-007	5344 Lewis Rd.	2055-005-058	19,520 sq.ft.	1,663 sq.ft.	2nd.flr.room add.	V.D.
14P	Sharon, Rafi and Orit	07-SPR-011 and 07-OTP-018	28220 Foothill Dr.	2055-016-023	31,360 sq.ft.	5,750 sq.ft.	Construct a 2-story, 3,751 sq. ft. S.F.R. with a 1,259 sq.ft. attached garage and 740 sq. ft. of patios.	R.M.
15P	Agoura TNT LLC/Terry Gray	Amendment to 06-CUP-005 and Amendment to 06-OTP-008	5936 Fairview Place	2055-023-096	1.25 ac.	5,764 sq. ft.	Amend the approved CUP and amend the approved OTP due to grading and walls not in compliance with approvals	R.M.
16P	Schwartzberg for Datner	04-SPR-012	6137 Braemar Ct.	2056-050-044	20,140sq.ft.	1,904 sq.ft.	2-story rm. Add	V.D.
17P	Bardai, Nevin (Gary Bardovi, Architect/LCE Group, Inc.)	07-CUP-011	Balkins Drive	2055-021-044	1.08 ac., minus .07 for slope easement; buildable lot is 1.01 ac.	5,772 sq. ft.	Construct a multi-level (two and three stories), 5,772 sq. ft. residence with attached garage; project includes a spa and future equestrian facilities.	R.M.
18P	Schaub for Leggett	04-SPR-018 04-OTP-021	5939 Colodny Dr.	2055-028-039	40,950 sq.ft.	1,779 sq. ft.	One story room addition	V.D.
19P	Vasquez for Atkins	04-LLA-012 04-SPR-022 04-CFC-001	28506 Driver Ave.	2055-004-032	N/A	N/A	combine 2 lots + 2.098 sqft. room addition	V.D.
20P	Chuck Francoeur for 'Montage Dev.'	Tr. 69073 (related to 01-SPR-008 and 06-SPR-003)	5310 Colodny Dr.	2055-007-053			Convert the approved (unconstructed) apt.units to condos	R.M.
21P	Foster	04-SPR-019	5545 Foothill Dr.	2055-018-041	24,480 sq. ft.	2,998 sq. ft.	1 story, S.F. D.U.	V.D.
22P	Payan	04-CUP-001 04-VAR-001	28254 Laura La Plante Dr.	2061-017-007	6,68 sqft.	3,154 sq.ft.	two-story SFDU	V.D.
23P	Blinkinsoph for Thompson	04-CUP-003 03-LLA-001 03-PAR-001	Lewis Pl.	2061-022-029 and 30	13,129 sq. ft.	2,567 sq. ft.	single-fam D.U.	V.D.
24P	Sears & Chase	04-LLA-014	30020 and 30014 Trail Creek Drive & HOA Common Area	2053-029-040 & 041 & 2053-018 033	N/A	N/A	Adjust south property line of two lots	Eng. Dept.
25P	Linda Medvene	07-SPR-005 and 05-OTP-002 (related case: 05-SPR-003)	5857 Fairview Pl.	2055-027-066	1.26 ac.	589.75 sq.ft.	Add 589,75 sq. ft. to existing 3,831 sq.ft. residence and add a 672 sq.ft. garage and a 600 sq. ft. barn.	B.T.
26P	Yvanova for Laura La Plante LLC	05-CUP-002 05-VAR-003 05-LLA-003 05-OTP-015	28221 Laura LaPlante Dr.	2061-016-063 & 2061-016-072	16,390 sq.ft. (2 lots)	3,400 sq. ft.	SFR, Variance for frontyard setback, lot merger and removal of oak trees	V.D.
27P	DNA Construction for Albaum, David	06-SPR-010	5866 Fairview Place	2055-027-074	81,020 gross sq. ft., 41,810 net sq.ft. after road and flood hazard is subtracted	494 sq. ft.	Construct a 494 sq. ft. single-story room addition to a 2,966 sq. ft. S.F.D. and remodel kitchen	B.T.
28P	ARC Design/Ewing	05-SPR-011	28080 Balkins Dr.	2055-023-098	44,965 sq.ft.	4,037 sq.ft. + 1,408	2 story SFR w/garage + acc. Bldg.	R.M.
29P	Millett, Mike and Darin	06-SPR-011 06-OTP-031 and 08-VAR-001	5446 Fairview Place	2055-014-018	41,500 sq. ft.	1,399 sq. ft.	Request to reduce the non-conforming south side yard setback of 9'11" to 7'4" for a proposed 1,399 sq.ft. room addition and a 500 sq.ft. porch to the existing dwelling unit.	B.T.

**Residential Cases
September 2008**

Proj. No.	Project Name	Case No.(s)	Project Location	Parcel Number	Site Size	Floor Area	Project Description	Case Planner
30P	Leininger, Bart & Laura	05-SPR-025	6162 Lake Lindero Dr.	2056-054-009	9,639 sq.ft.	365 sq.ft. addition to be added to a prior 327 sq.ft. addition built in 2005.	First and second story room addition to existing single-family residence	C.A.
31P	Sitin for Daniel Bouganim	07-SPR-009	5519 Lewis Lane	2055-017-028	21,490 sq.ft.	694 sq.ft.	Add a 694 sq.ft., first floor master bdrm. & bath to the existing first floor sq. footage of 2,668.	B.T.
32P	Mahterian for Turley	05-SPR-001	6144 3/4 Chesebro Rd.	2055-024-053	44,431 sqft.	5,296 sq.ft. & 592 sq.ft.	S.F. res. w/ detached bldg.	R.M.
33P	Elbaum, Lisa and Steve. (Bagwell Construction)	08-MOD-001	29100 Quail Run Drive	2053-005-038	8,498 sq. ft.	193 sq. ft.	A Yard Modification app. Requesting to decrease the rear yard from the required 20' to 16' for 193 sq. ft. addition to the kitchen.	B.T.
34P	Steve and Marguerite Edwards	06-CUP-008 and 06-OTP-017	5952 Lapworth Dr. N.E. corner of Lapworth and Balkins	2055-022-073	Approx.59,983 sq. ft.	4,950 sq.ft. , 908 sq.ft., 347 sq. ft., and 1,502 sq. ft. Total of 7,707 sq. ft.	A 2-story 4,950 sq.ft. D.U. w/908 sq.ft. attached 3-car garage w/347 sq.ft. studio above garage and 1,502 sq. ft. barn	R.M.
35P	Neil Pennywitt for Ron and Trish Burr	07-SPR-016 related cases 01-CUP-002; 01-MOD-001 and 01-OTP-002	6129 Chesebro Road	2055-023-075	26,572 sq. ft.	280 sq. ft.	Enclose a second floor roof deck, creating a 280 sq. foot addition to the existing master bedroom.	B.T.
36P	Alfonso Stanley Sosa	08-SPR-006	6317 Langhall Ct.	2051-013-046	9,420 sq. ft.	578 sq. ft.	Remodel 659 sq. ft. of existing 3,548 sq. ft. D.U. and construct a 578 sq. ft. addition.	B.T.
37P	Carroll, Gerald	07-SPR-006	5730 Fairview Place	2055-012-031		576 sq. ft.	Addition of a 576 sq. ft. storage building in rear yard	B.T.
38P	Dembsky for Almany	05-MOD-006	3945 United Rd.	2064-018-006	N/A	846 sq.ft.	A Mod. Request to reduce the required front yard setback from 25 ft. to 21 feet.	C.A.
39P	McCann for Anav	05-SPR-027	5533 Fairview Pl.	2055-016-026	42,690 sq.ft.	1,039 sq.ft.	1,039 sq.ft. add. To existing 1,009 sq.ft. D.U. and a 586 sq.ft. covered porch	R.M.
40P	Pendlebury for Barnett	06-SPR-001	6044 Chesebro Rd.	2055-026-030	1.02 ac.	415 sq.ft.	415 sq.ft. addition	R.M.
41P	CJF Development Consultants for "Montage"	06-SPR-003	5310 Colodny Dr.	2055-007-053	13,650 sqft.	8,068 sqft.	Time extension on 4 units. Former case number 01-SPR-008	R.M.
42P	Zev Beckerman (Sasson Bezalet for Zev)	07-SPR-003; Related case: 06-SPR-005 (admin)	27862 Blythdale Rd.	2055-024-004	1.04 ac.	3,055 sq.ft.	Construct a new 3,055 sq. ft. D.U. in same area as former "tear-down". The lot has an existing garage and pool.	R.M.
43P	Robin, Louis & Lisa	08-SPR-003	5779 Willowtree Dr.	2056-036-023	20,258 sq. ft.	2,600 sq. ft.	Addition of 2,600 sq. ft. to the existing residence. Total finished sq. ft. will be 5,600.	B.T.
44P	Weireter, Philip & Sheryl (David Raider, Architect)	08-SPR-001	30645 Janlor Drive	2056-012-008	Approx. 7,236 sq.ft.	1,260 sq. ft.	A 1,260 sq. ft. first and second story addition to existing 1,736 sq. ft. residence.	B.T.
45P	Vladimir Zlatkov	06-CUP-004 refer to 05-PAR-003	28331 Laura LaPlante Dr.	2061-022-016	7,000 sq.ft.	3,235 sq.ft. D.U. with a 682 sq. ft. garage	Two-story single-family dwelling unit	R.M.
46P	Agoura TNT LLC/Terry Gray	06-CUP-005 and 06-OTP-008	6170 Fairview Pl.	2055-023-096	1.25 ac.	5,764 sq.ft.	New 5,764 sq. ft., two-story, single-family D.U. with a 1,008 sq.ft. attached garage and a 532 sq. ft. detached garage with future "pool house" above the detached garage structure.	R.M.
47P	David Rocca	08-SPR-004	6044 Lake Nadine Pl	2056-025-020	7,336 sq. ft.	520 sq. ft.	520 sq. ft. addition and new front porch to existing 1,920 sq.ft. residence.	B.T.

**Residential Cases
September 2008**

Proj. No.	Project Name	Case No.(s)	Project Location	Parcel Number	Site Size	Floor Area	Project Description	Case Planner
48P	Bagwell Construction for Joel Rizor	07-SPR-001	5709 Fairview Pl	2055-020-064	20,262 sq.ft.	716 sq. ft., plus 1,266 sq. ft.	Add 716 sq. ft. rm.addition to existing 2,428 sq.ft. D.U., plus add a 1st & 2nd story deck totaling 1,266 sq. ft.	B.T.
49P	Charles Blaugrund for Mr. & Mrs. Joey Butson	07-SPR-002 and 07-VAR-001	5619 Slicers Circle	2054-018-132	4,070 sq.ft.	1,866 sq. ft.	Add a 1,645 sq.ft. 2nd story w/a 156 sq.ft. balcony and a 65 sq.ft. addition to the first floor of an existing 1,667 sq.ft. D.U. and a Variance app. requesting a reduction of side & rear yard setbacks	R.M.
50P	Ashnoor Pirouti	03-CUP-022	28454 Renee Dr.	2061-021-005	5,040 sq. ft.	1,534 sq. ft.	two-story S.F. D.U	V.D.
51P	Ashnoor Pirouti	03-CUP-023	28458 Renee Dr.	2061-021-023	6,452 sq. ft.	1,219 sq. ft.	two-story S.F. D.U	V.D.
52P	M. Fredric & Co. (Fred and Lisa Levine)	06-PAR-006	6475 Chesebro Road	2055-029-008	4.52 ac. (.06 ac is driveway and 2.79 ac. is restricted use area. Buildable area is 1.67 ac.)	12,092 sq. ft.	A Pre-App. to discuss issues relative to building a 8,727 sq. ft., 2-story S.F.D. w/ a 779 sq.ft. detached garage, a 429 sq. ft. pool pavilion, a 1,520 sq. ft. pool & deck and a 637 sq. ft. "Art Studio".	V.D.
53P	Monte Vende Development	04-PAR-006	So. side of Agoura Rd, east of Cornell Rd.	2061-025-001 thru 007 2061-025-021 thru 025 2061-025-038 thru 040 2061-024-001 thru 004 2061-026-015			16 Single-Family Lots	D.H.
54P	Jager Associates for Michael Palache	07-PAR-002	Balkins Drive, 3 lots west of Lapworth, behind 2055-021-044	2055-021-018	42,250 sq.ft.	5,500 sq. ft. building area, 690 sq.ft. garage	Pre-app. to discuss issues re building a 5,500 sq.ft., 2-story, single-story D.U. with a 690 sq.ft. garage. Bldg. footprint is 3,444 sq.ft. Paved area is 3,493 sq.ft. Paved driveway area is 11,149 sf	R.M.
55P	Araujo, Ruben and Debra / Brent Schneider, Architect	07-SPR-010	6021 Colodny Drive	2055-028-036	41,820 sq. ft.	8,634 sq.ft.	Construct 2-story, 5,962 sq.ft.s.f.r. w/ attached 1,622sf garage; 1,050sf barn driveway motorcourt, pool, horse riding ring, corrals&horse turn-out area.	R.M.
COMPLETED PROJECTS								
1C	Gniadek/ Bullmer for Rasmussen	02-SPR-016	28611 Bamfield Ct.	2050-022-001	16.84 acres	5,200 sqft.	1,186 sqft room addition.	V.D.
2C	Mineo	01-CUP-006 01-VAR-005	Lot 3 on Canyon Wy.	2061-017-003	6,824 sqft.	2,968 sqft.	New single-family dwelling	(R.H.) D.H
3C	Bailey for Tamara Friend	07-SPR-007 and 07-OTP-009	6350 Chesebro Road	2055-001-041	3.29 ac	685 sq.ft.	Add a new 499 sq.ft.garage & a new 186 sq.ft. porch, convert an exist. 1,901sq.ft. garage to living space & convert an exist.breezeway to 573 sq.ft of living space to exist. D.U.	B.T.
4C	Stockton for Sisso	06-SPR-004	5415 Lewis Rd. (So. of Driver Ave.)	2055-004-020	approx. 23,000 sq.ft.	3,850 sq. ft. D.U. & 650 sq. ft. garage	Single-story, single-family D.U. with attached 2 car garage.	V.D.
5C	Roit, Leo	06-CUP-013; 06-VAR-006; 06-OTP-030	28161 Laura LaPlante	2061-016-053	8,000 sq. ft.	2,604 sq. ft.	Construct a 2,172 sq. ft. , one-story, single-family D.U. with a 432 sq. ft. attached garage	R.M.
6C	Larry Pollock	07-SPR-013	5734 Fairview Pl.	2055-012-035	.96 ac.	336 sq. ft.	Application to remodel and add 336 sq. ft. to the existing 2,605 sq. ft. single-family residence	B.T.
7C	Biddison, M	04-SPR-003	28359 Driver Ave.	2055-015-063	.96 acres	3,080/865 sq.ft.	1 story SF DU	D.H.
8C	Cooper for Stitt	05-SPR-005 & 05-OTP-007	28037 Balkins Dr.	2055-023-080	1.6 acres	add 735 sq.ft. and 1,052 sq.ft. interior remodel	1st & 2nd story add. And remodel	R.M.
9C	John/Linda Quinn	05-SPR-007	5703 Willowtree Dr.	2056-037-014	20,741 sqft.	add 1,428 sq.ft.	1 story add. & remodel 780 sq. ft. kitchen	R.M.
10C	Jacob	05-CUP-005, 05-VAR-008, and 05-OTP-003	North of 5847 Colodny Dr.	2055-028-042	27,880 sq.ft.	4,061+518+864 s.f.	2 story S.F.D.U.w/porch,garage, barn + future pool	V.D.

**Residential Cases
September 2008**

Proj. No.	Project Name	Case No.(s)	Project Location	Parcel Number	Site Size	Floor Area	Project Description	Case Planner
11C	Mahterian for Mogan	05-CUP-004 05-MOD-005 05-LLA-008	28250 Laura LaPlante Dr.	2061-17-29;43;44;46	.51 acres Merge 4 lots	Add 1,015 sq.ft to an existing 1,339 sqft. DU with a 362 sqft. garage	Mod. Request to reduce front yard setback from 25' to 20'. Total finished sq.ft. of D.U. will be 2,354 sq.ft., plus 362 sq.ft. garage.	R.M.
12C	Christopher Haarhoff (Jonathan Azal and B A Construction)	08-SPR-002	6033 Colodny Drvie	2055-028-035	40,950 sq. ft.	580 sq/ ft/	Add 580 sq. ft. to existing 2021 sq. ft. residence with a 418 sq. ft. garage	B.T.
13C	Rhombold	01-SPR-004 TR53543	5241 Colodny Dr.	2055-006-194 through 197	.88 acre	1600-1700 sqft. Total: App. 31,000sqft	New 19 unit condo project	(E.B.) D.H.
14C	Stockton	01-SPR-008	5310 Colodny Dr.	2055-007-053	13,650 sqft.	8,068 sqft.	4-unit apartment building	(D.H.) R.M.
15C	Ryan	04-MOD-001	29029 Acanthus Ct.	2051-003-006	6,758 sq.ft.	457 sq. ft.	Mod. For 2nd story room add.	V.D.
16C	Diamond	04-SPR-011	5833 Lapworth Dr.	2055-021-028	1 acre	1,369 sqft.	One-story room addition	V.D.
17C	Golenberg	02-SPR-010 02-OTP-008	5927 Colodny Dr.	2055-028-040	45,372 sqft.	476 sqft.	Room addition to an existing single-family dwelling	V.D.
18C	Swenson and Nadel	03-CUP-011 03-OTP-008	28354 Balkins Dr.	2055-021-042	39,247 sqft.	4,627 sqft.	A custom house with attached three car garage	(E.B.) D.H.
19C	Mandler	04-SPR-009	5445 Meadow Vista	2053-019-007	5676 sq. ft.	1,593 sq.ft.	One and two-story room addition	V.D.
20C	Dawson for Sharon	04-SPR-017	28314 Foothill Dr.	2055-016-033	22,440	1,268 sq. ft.	Two-story room addition	V.D.
21C	Scott Berg for Kearns	06-SPR-002	5740 Colodny Dr.	2055-011-039	19,600 sq.ft.	222 sq.ft.	222 sq.ft. room addition to existing D.U.	R.M.
22C	Frank LaRosa and Emily Prano	06-SPR-007	5348 Chesebro Rd.	2052-007-007	21,699 sq.ft.	2,092 sq.ft.	695 sq.ft. garage conversion. 191 sq.ft. 1st flr add. And 576 sq.ft. 1st flr garage add. & 630 sq. ft. 2nd flr.addition	R.M.
23C	N.E. Designs for Bar family	06-SPR-008	28466 Foothill Dr.	2055-017-009	28,700 sq.ft.	840 sq.ft.	840 sq.ft., one-story addition to existing 2,157 sq. ft. D.U.	RM
24C	Leo Felerelsen for Garner	07-SPR-014	29004 Indian Ridge Ct.	2051-002-034		869 sq. ft.	Add 212 sq. ft. to 1st floor, 234 sq. ft. to 2nd floor & a 423 sq. ft. covered patio	B.T.

Projects in Review
September 2008

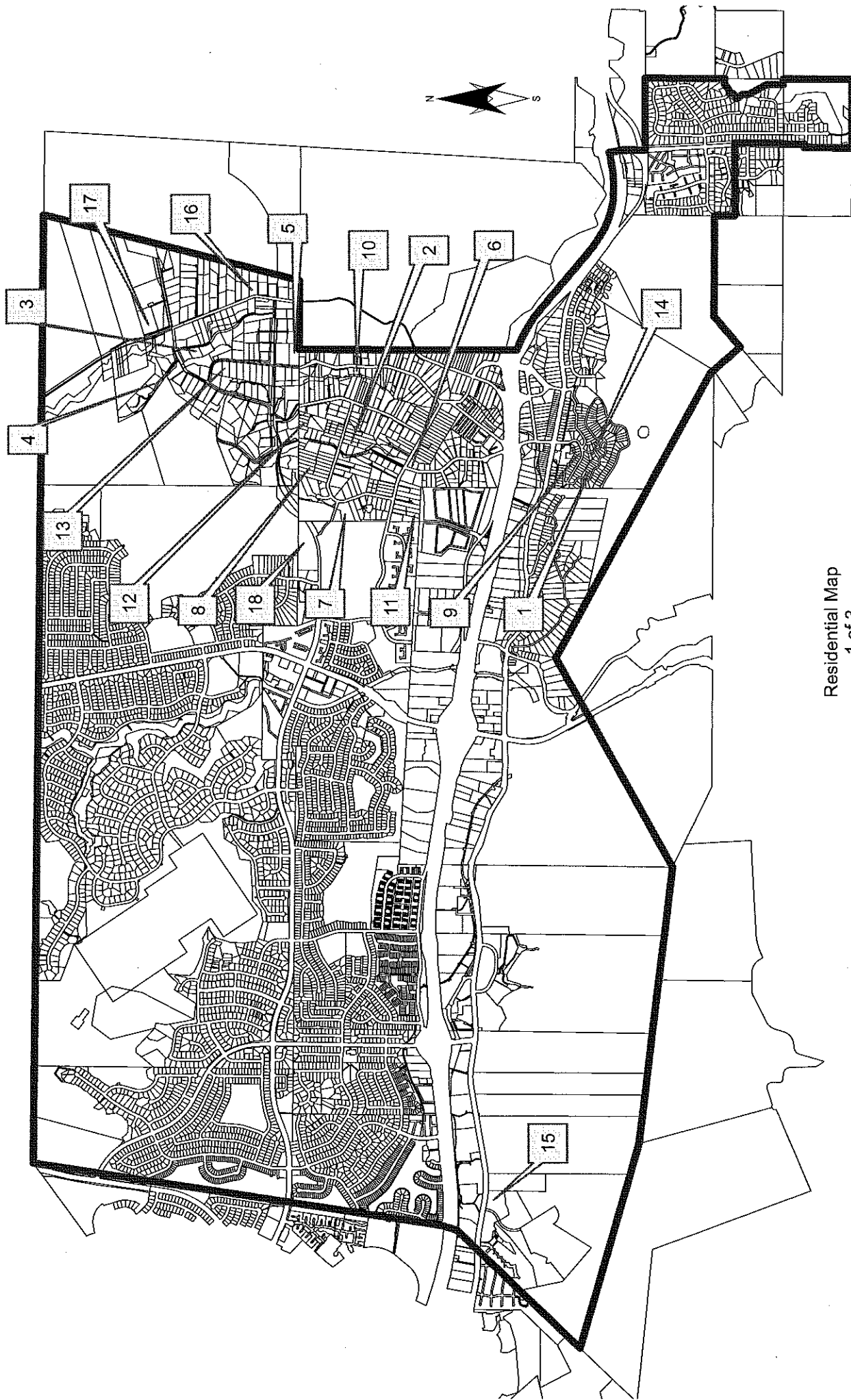

Approved Projects
September 2008

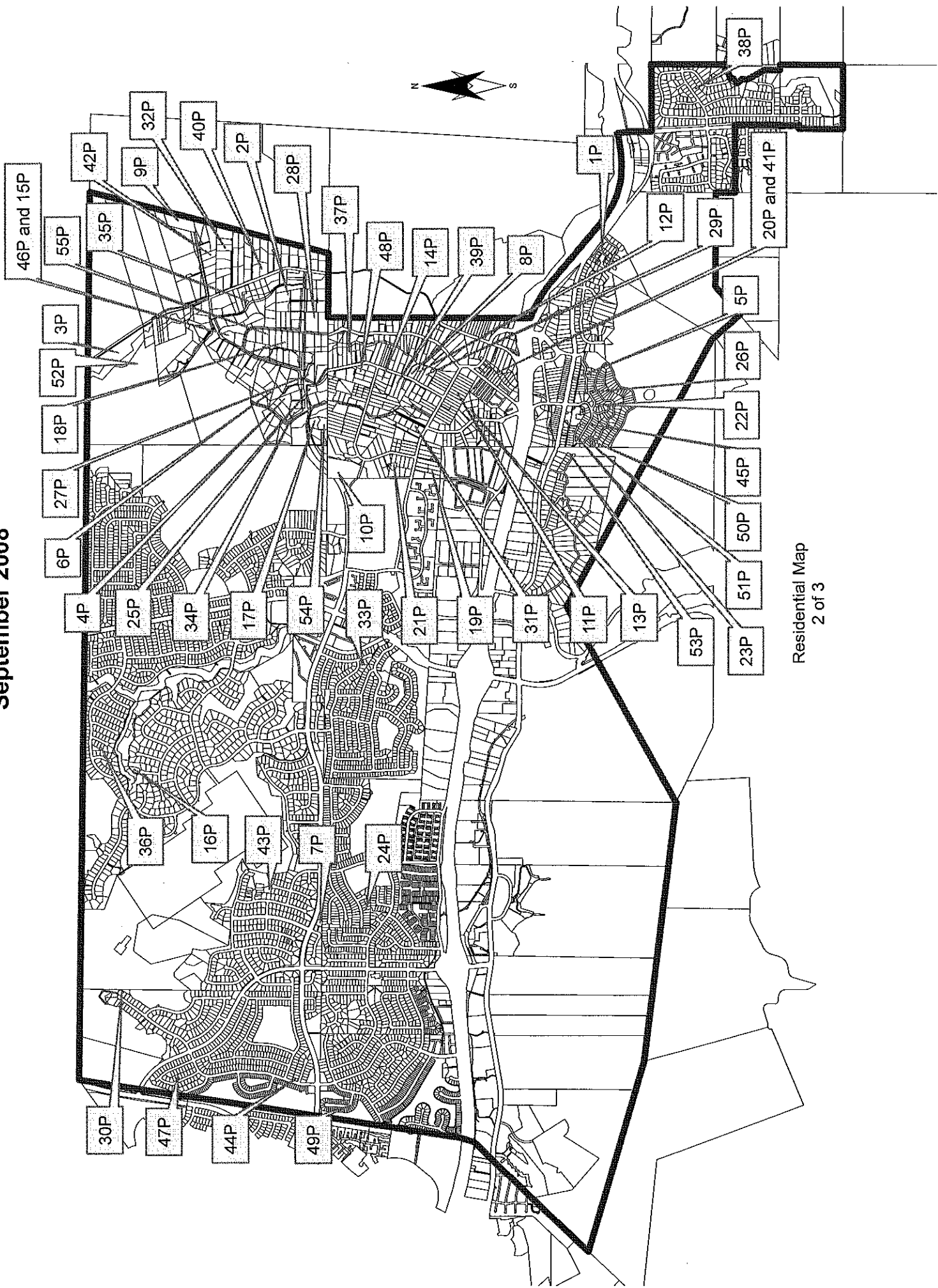

Completed Projects
September 2008

